

- LEGEND:**
- GROUNDWATER WELL/SPRING
 - GSI WELL/SPRING
 - SEPTIC TANK
 -
 -
 -
 - PROPOSED DEVELOPMENT BOUNDARY
 -



T:\MGTO337 - Ten-T Priority Route - Donegal\Phase 3\EMEIAR Drawings\10.0 Land and Soil Section 1\TT_MGT0337-RPS-P3-S1-DR-Z-EN0310 - Wells&Springs - Drawings - SS - P04.dwg



NOTES
 DO NOT SCALE, use figured dimensions only.
 All levels are referred to Ordnance Survey Datum, Mean Head.
 This drawing is the property of the Donegal County Council. It is a confidential document and must not be copied, used, or its contents divulged without prior written consent. This document should not be relied on or used in circumstances other than those for which it was originally prepared. RPS / Barry Transportation accepts no responsibility for this document to any other party other than the party by whom it was commissioned.

Rev.	Date	Drawn	Description	Chk'd	Appr.
P01	24.02.26	BH	Issue for Planning	KC	GMCE

Project Title: TEN-T Priority Route Improvement Project, Donegal Section 1 - N15/N13 Ballybofey / Stranorlar Urban Region		Status: A03
Drawing Title: Section 1 - Groundwater Wells & Springs		Rev: P01
Designed: JOC	Date: MAR 2025	EIAR Drawing Identifier: 10.24
Drawn: EG	Scale @ A1: 1:2500	File Identifier: TT_MGT0337-RPS-P3-S1-DR-Z-EN0310
Approved: GMCE	@ A3: 1:5000	Sheet: 01 of 08
Checked: KC		

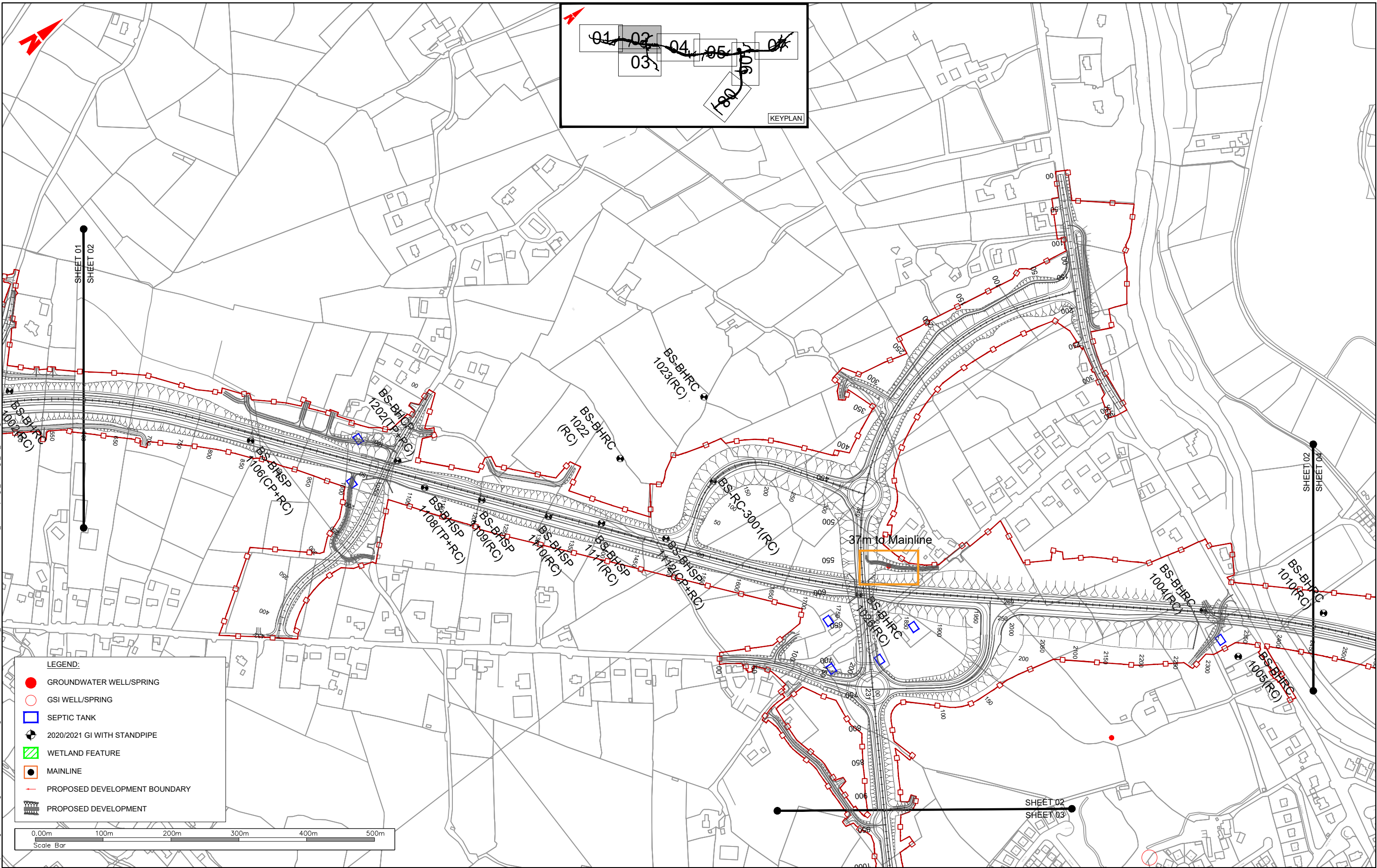

T:\MGT0337 - Ten-T Priority Route Imp - Donegal\8.0 Drawings\Phase 3\EMEIAR Drawings\10.0 Land and Soil Section 1\TT_MGT0337-RPS-P3-S1-DR-Z-EN0310 - Wells&Springs - Drawings - SS_P04.dwg



NOTES

DO NOT SCALE, use figured dimensions only.

All levels are referred to Ordnance Survey Datum, Malin Head.

This drawing is the property of the Donegal County Council. It is a confidential document and must not be copied, used, or its contents divulged without prior written consent. This document should not be relied on or used in circumstances other than those for which it was originally prepared. RPS / Barry Transportation accepts no responsibility for this document to any other party other than the party by whom it was commissioned.

Rev.	Date	Drawn	Description	Chk'd	Appr.
P01	24.02.26	BH	Issue for Planning	KC	GMCE

Project Title: TEN-T Priority Route Improvement Project, Donegal Section 1 - N15/N13 Ballybofey / Stranorlar Urban Region		Status: A03
Drawing Title: Section 1 - Groundwater Wells & Springs		Rev: P01
Designed: JOC	Date: MAR 2025	EIAR Drawing Identifier: 10.24
Drawn: EG	Scale @ A1: 1:2500	File Identifier: TT_MGT0337-RPS-P3-S1-DR-Z-EN0310
Approved: GMCE	@ A3: 1:5000	Sheet: 02 of 08
Checked: KC		

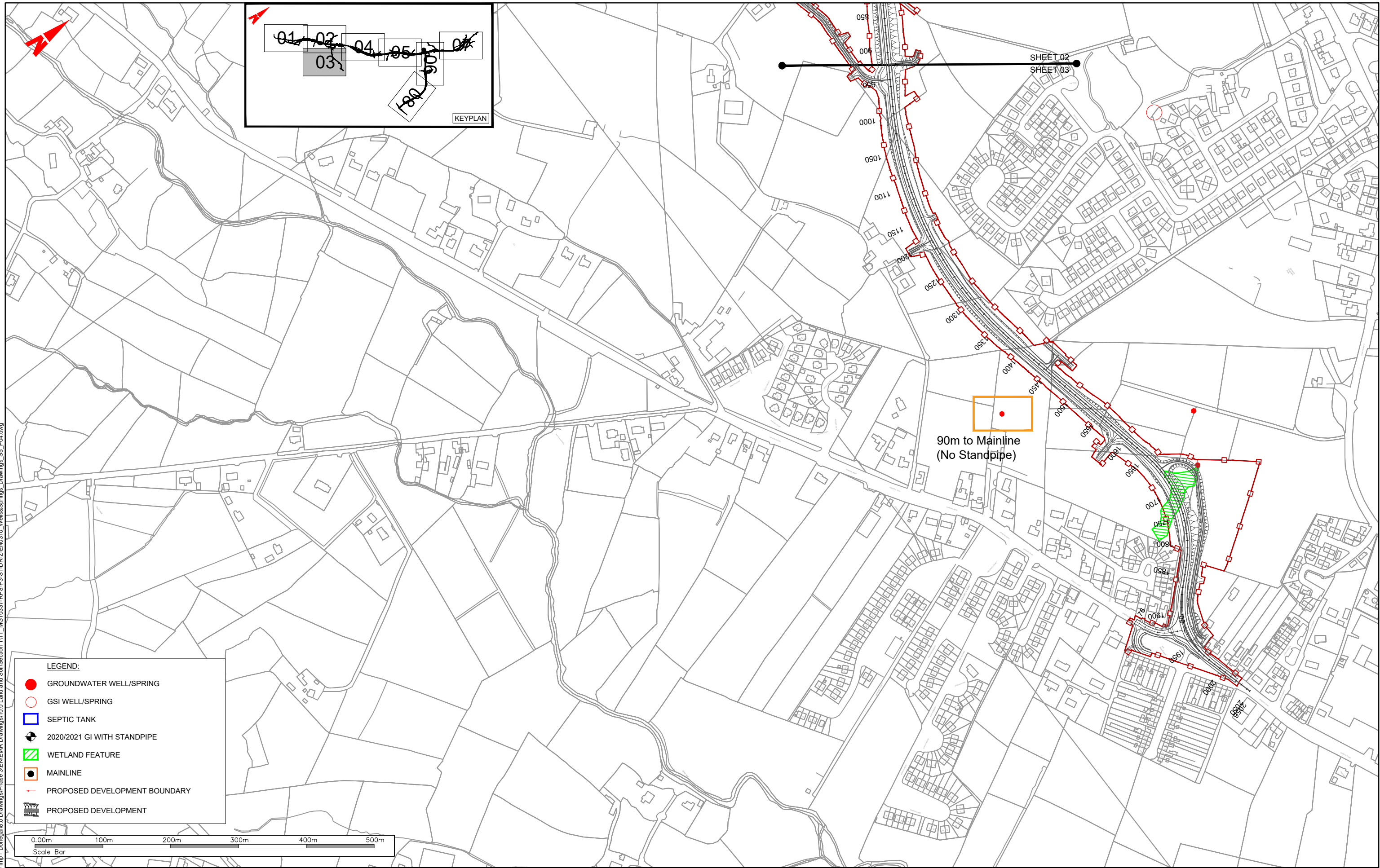

- LEGEND:**
- GROUNDWATER WELL/SPRING
 - GSI WELL/SPRING
 - SEPTIC TANK
 - 2020/2021 GI WITH STANDPIPE
 - WETLAND FEATURE
 - MAINLINE
 - PROPOSED DEVELOPMENT BOUNDARY
 - PROPOSED DEVELOPMENT

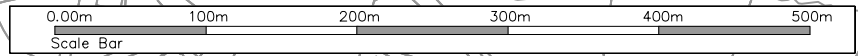

NOTES
 DO NOT SCALE, use figured dimensions only.
 All levels are referred to Ordnance Survey Datum, Main Head.
 This drawing is the property of the Donegal County Council. It is a confidential document and must not be copied, used, or its contents divulged without prior written consent. This document should not be relied on or used in circumstances other than those for which it was originally prepared. RPS / Barry Transportation accepts no responsibility for this document to any other party other than the party by whom it was commissioned.

Rev.	Date	Drawn	Description	Chk'd	Appr.
P01	24.02.26	BH	Issue for Planning	KC	GMCE

Project Title: TEN-T Priority Route Improvement Project, Donegal Section 1 - N15/N13 Ballybofey / Stranorlar Urban Region		Status: A03
Drawing Title: Section 1 - Groundwater Wells & Springs		Rev: P01
Designed: JOC	Date: MAR 2025	EIAR Drawing Identifier: 10.24
Drawn: EG	Scale @ A1: 1:2500	File Identifier: TT_MGT0337-RPS-P3-S1-DR-Z-EN0310
Approved: GMCE	@ A3: 1:5000	Sheet: 03 of 08
Checked: KC		

T:\MGT0337 - Ten-T Priority Route Imp - Donegal\0 Drawings\Phase 3\EMEIAR Drawings\10.0 Land and Soil Section 1\TT_MGT0337-RPS-P3-S1-DR-Z-EN0310 - Wells&Springs Drawings_SS_P04.dwg

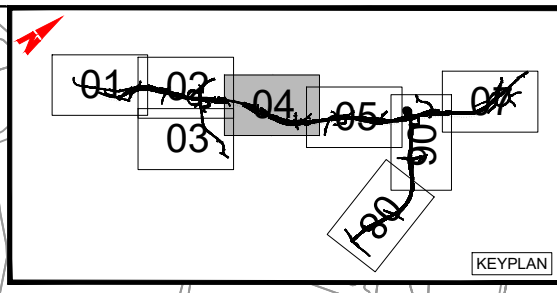
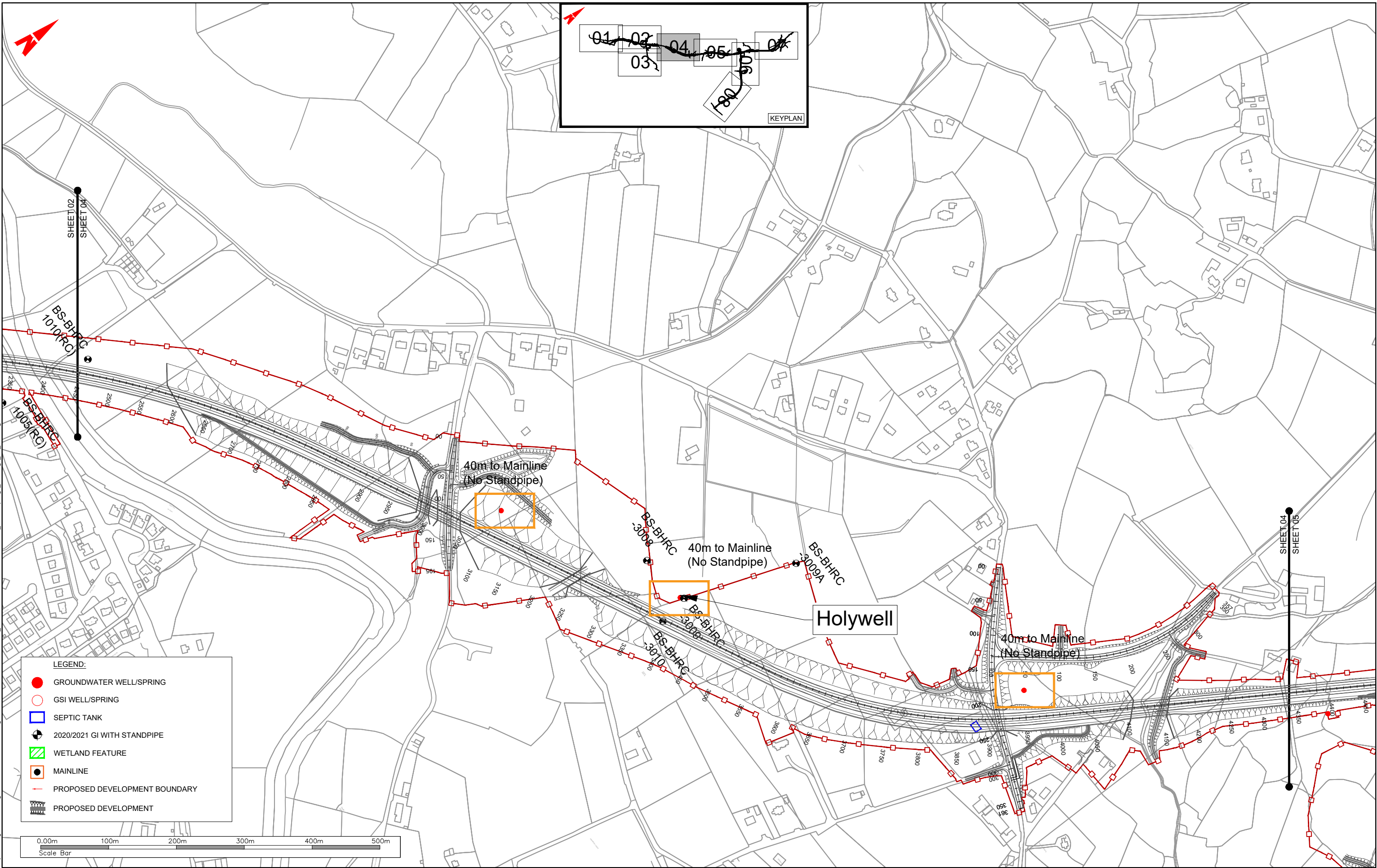

- LEGEND:**
- GROUNDWATER WELL/SPRING
 - GSI WELL/SPRING
 - SEPTIC TANK
 - 2020/2021 GI WITH STANDPIPE
 - WETLAND FEATURE
 - MAINLINE
 - PROPOSED DEVELOPMENT BOUNDARY
 - PROPOSED DEVELOPMENT



NOTES
 DO NOT SCALE, use figured dimensions only.
 All levels are referred to Ordnance Survey Datum, Main Head.
 This drawing is the property of the Donegal County Council. It is a confidential document and must not be copied, used, or its contents divulged without prior written consent. This document should not be relied on or used in circumstances other than those for which it was originally prepared. RPS / Barry Transportation accepts no responsibility for this document to any other party other than the party by whom it was commissioned.

Rev.	Date	Drawn	Description	Chk'd	Appr.
P01	24.02.26	BH	Issue for Planning	KC	GMCE

Project Title: TEN-T Priority Route Improvement Project, Donegal Section 1 - N15/N13 Ballybofey / Stranorlar Urban Region		Status: A03
Drawing Title: Section 1 - Groundwater Wells & Springs		Rev: P01
Designed: JOC	Date: MAR 2025	EIAR Drawing Identifier: 10.24
Drawn: EG	Scale @ A1: 1:2500	File Identifier: TT_MGT0337-RPS-P3-S1-DR-Z-EN0310
Approved: GMcE	@ A3: 1:5000	
Checked: KC	Sheet: 04 of 08	

T:\MGT0337 - Ten-T Priority Route Imp - Donegal\8.0 Drawings\Phase 3\EIAR Drawings\10.0 Land and Soil Section 1\TT_MGT0337-RPS-P3-S1-DR-Z-EN0310 - Wells&Springs - Drawings - SS_P04.dwg

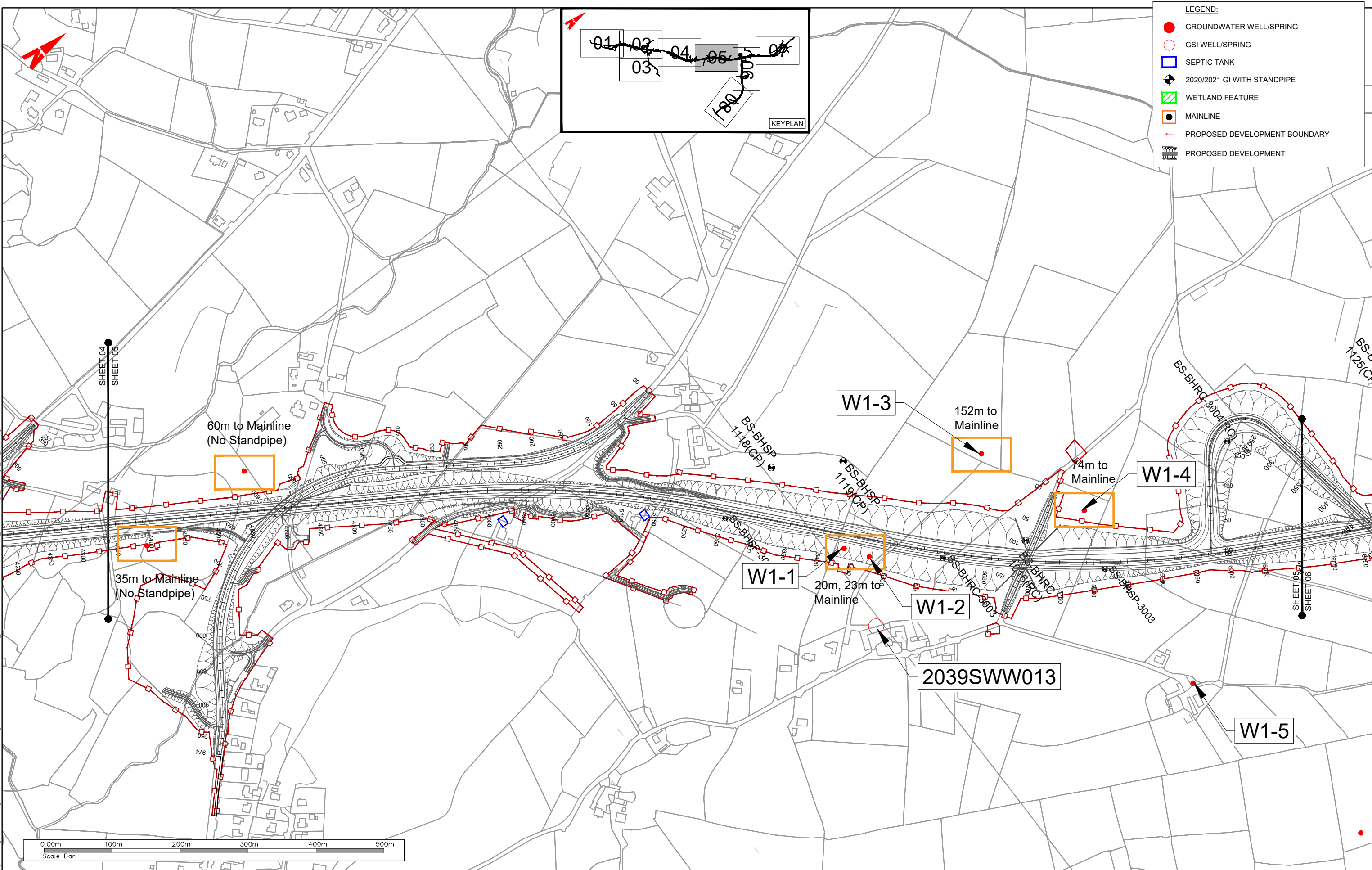

LEGEND:

- GROUNDWATER WELL/SPRING
- GSI WELL/SPRING
- SEPTIC TANK
- 2020/2021 GI WITH STANDPIPE
- ▨ WETLAND FEATURE
- MAINLINE
- PROPOSED DEVELOPMENT BOUNDARY
- ▨ PROPOSED DEVELOPMENT

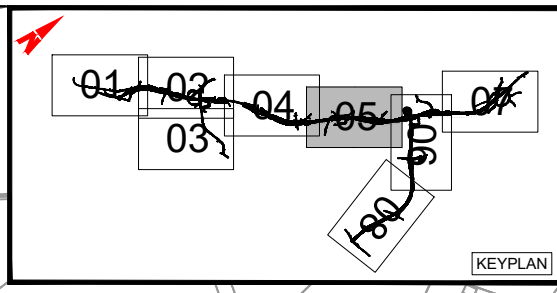

T:\MG0337 - Ten-T Priority Route Imp - Donegal\Phase 3\EMEIAR Drawings\10.0 Land and Soil Section 1\TT_MGT0337-RPS-P3-S1-DR-Z-EN0310 - Wells&Springs Drawings_SS_P04.dwg

Bonnagar Iompar Éireann
 Transpórt Infrastructure Ireland
 Rialtas na hÉireann
 Government of Ireland
 Tionscadal Éireann
 Project Ireland
 2024

Donegal
 NRI
 Oifis Dochara Thairneora
 Dhún na nGall
 Comhairle Contae
 Dhún na nGall
 Donegal County Council

RPS BARRY
 TRANSPORTATION

NOTES
 DO NOT SCALE, use figured dimensions only.
 All levels are referred to Ordnance Survey Datum, Main Head.
 This drawing is the property of the Donegal County Council. It is a confidential document and must not be copied, used, or its contents divulged without prior written consent. This document should not be relied on or used in circumstances other than those for which it was originally prepared. RPS / Barry Transportation accepts no responsibility for this document to any other party other than the party by whom it was commissioned.

Rev.	Date	Drawn	Description	Chk'd	Appr.
P01	24.02.26	BH	Issue for Planning	KC	GMcE

Project Title: TEN-T Priority Route Improvement Project, Donegal Section 1 - N15/N13 Ballybofey / Stranorlar Urban Region		Status: A03
Drawing Title: Section 1 - Groundwater Wells & Springs		Rev: P01
Designed: JOC	Date: MAR 2025	EIAR Drawing Identifier: 10.24
Drawn: EG	Scale @ A1: 1:2500	File Identifier: TT_MGT0337-RPS-P3-S1-DR-Z-EN0310
Approved: GMcE	@ A3: 1:5000	
Checked: KC	Sheet: 05 of 08	

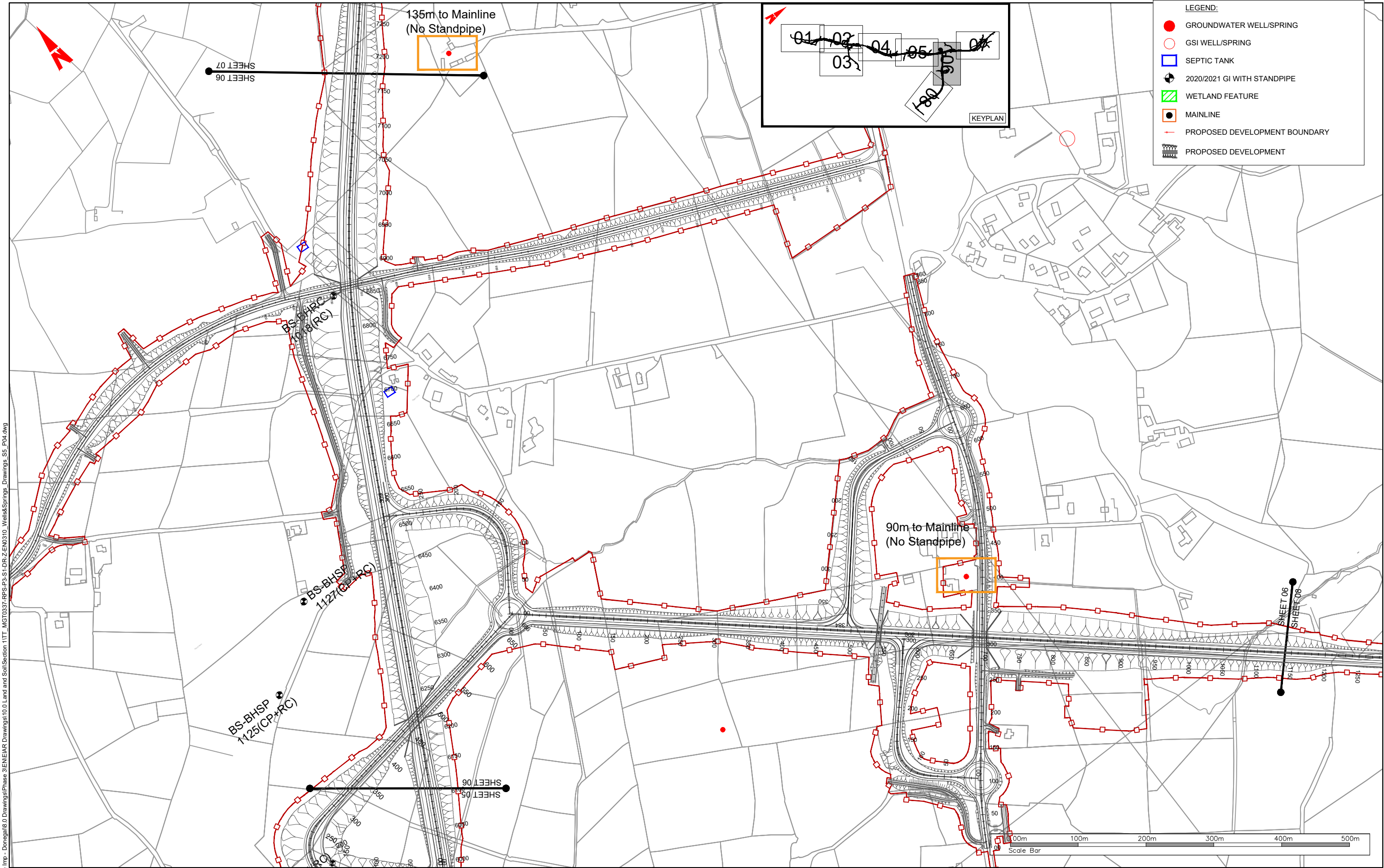

- LEGEND:**
- GROUNDWATER WELL/SPRING
 - GSI WELL/SPRING
 - SEPTIC TANK
 -
 - ▨ WETLAND FEATURE
 - MAINLINE
 - PROPOSED DEVELOPMENT BOUNDARY
 -

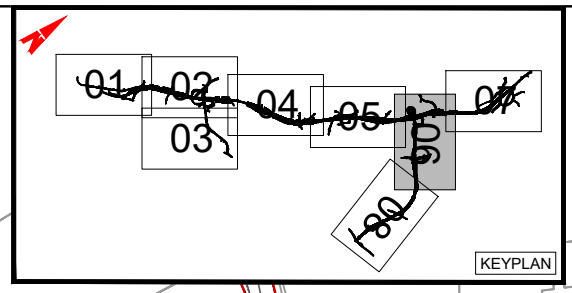

T:\MGT0337 - Ten-T Priority Route - Donegal\8.0 Drawings\Phase 3\EMEIAR Drawings\10.0 Land and Soil Section 1\TT_MGT0337-RPS-P3-S1-DR-Z-EN0310 - Wells&Springs - Drawings_SS_P04.dwg



NOTES
 DO NOT SCALE, use figured dimensions only.
 All levels are referred to Ordnance Survey Datum, Main Head.
 This drawing is the property of the Donegal County Council. It is a confidential document and must not be copied, used, or its contents divulged without prior written consent. This document should not be relied on or used in circumstances other than those for which it was originally prepared. RPS / Barry Transportation accepts no responsibility for this document to any other party other than the party by whom it was commissioned.

Rev.	Date	Drawn	Description	Chk'd	Appr.
P01	24.02.26	BH	Issue for Planning	KC	GMCE

Project Title: TEN-T Priority Route Improvement Project, Donegal Section 1 - N15/N13 Ballybofey / Stranorlar Urban Region		Status: A03
Drawing Title: Section 1 - Groundwater Wells & Springs		Rev: P01
Designed: JOC	Date: MAR 2025	EIAR Drawing Identifier: 10.24
Drawn: EG	Scale @ A1: 1:2500	File Identifier: TT_MGT0337-RPS-P3-S1-DR-Z-EN0310
Approved: GMcE	@ A3: 1:5000	
Checked: KC	Sheet: 06 of 08	

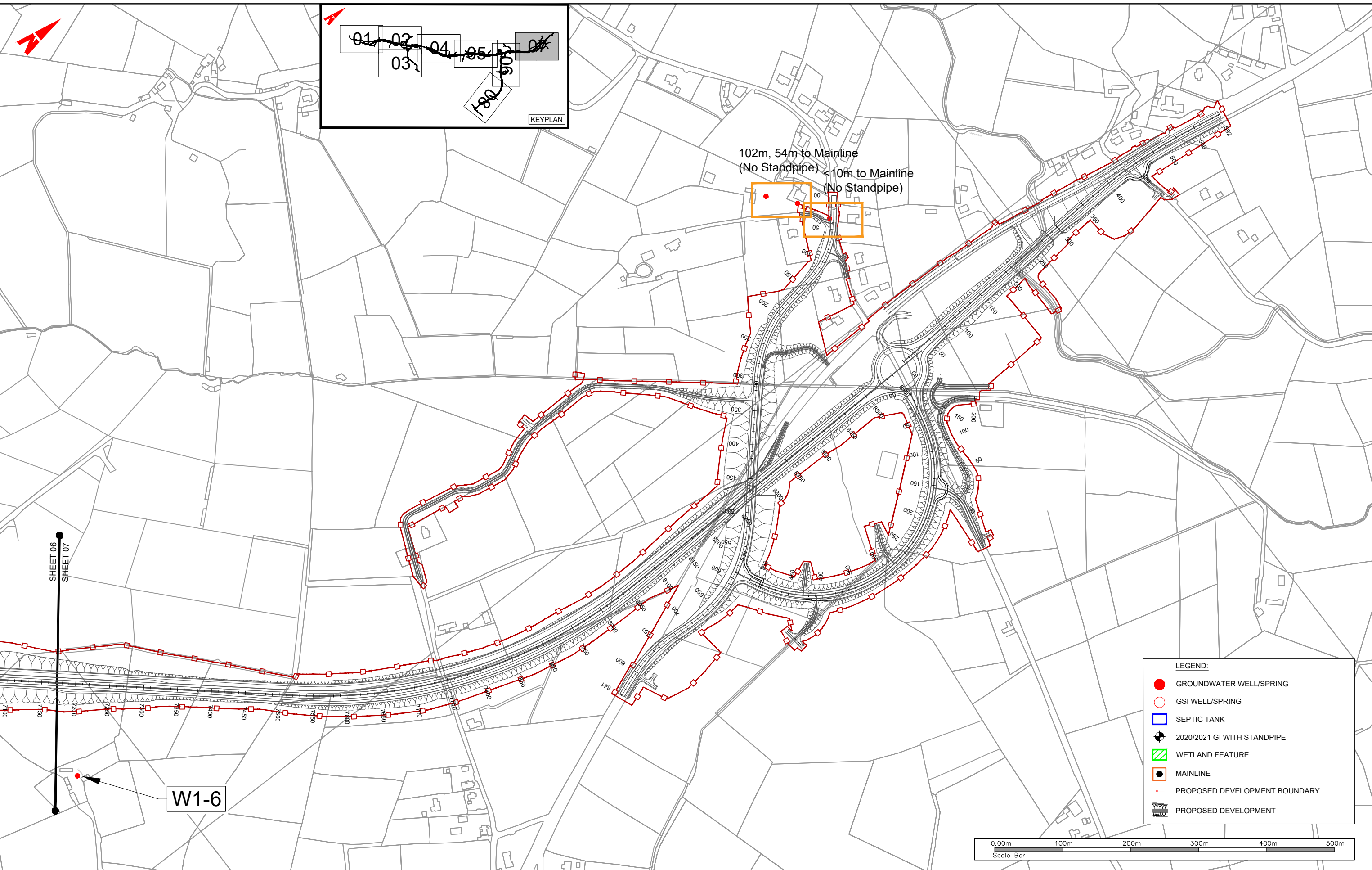

T:\MGT0337 - Ten-T Priority Route Imp - Donegal\18.0 Drawings\Phase 3\EMEIAR Drawings\10.0 Land and Soil Section 1\TT_MGT0337-RPS-P3-S1-DR-Z-EN0310 - Wells&Springs - Drawings - SS - P04.dwg



NOTES
DO NOT SCALE, use figured dimensions only.
All levels are referred to Ordnance Survey Datum, Malin Head.
This drawing is the property of the Donegal County Council. It is a confidential document and must not be copied, used, or its contents divulged without prior written consent. This document should not be relied on or used in circumstances other than those for which it was originally prepared. RPS / Barry Transportation accepts no responsibility for this document to any other party other than the party by whom it was commissioned.

Rev.	Date	Drawn	Description	Chk'd	Appr.
P01	24.02.26	BH	Issue for Planning	KC	GMCE

Project Title: TEN-T Priority Route Improvement Project, Donegal Section 1 - N15/N13 Ballybofey / Stranorlar Urban Region		Status: A03
Drawing Title: Section 1 - Groundwater Wells & Springs		Rev: P01
Designed: JOC	Date: MAR 2025	EIAR Drawing Identifier: 10.24
Drawn: EG	Scale @ A1: 1:2500	File Identifier: TT_MGT0337-RPS-P3-S1-DR-Z-EN0310
Approved: GMcE	@ A3: 1:5000	
Checked: KC	Sheet: 07 of 08	

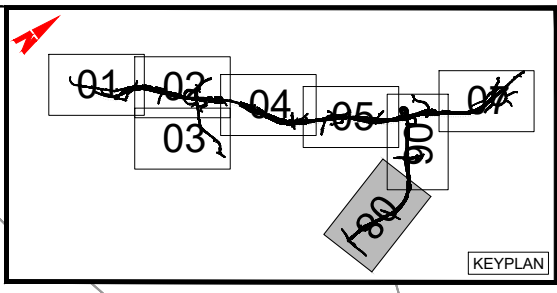
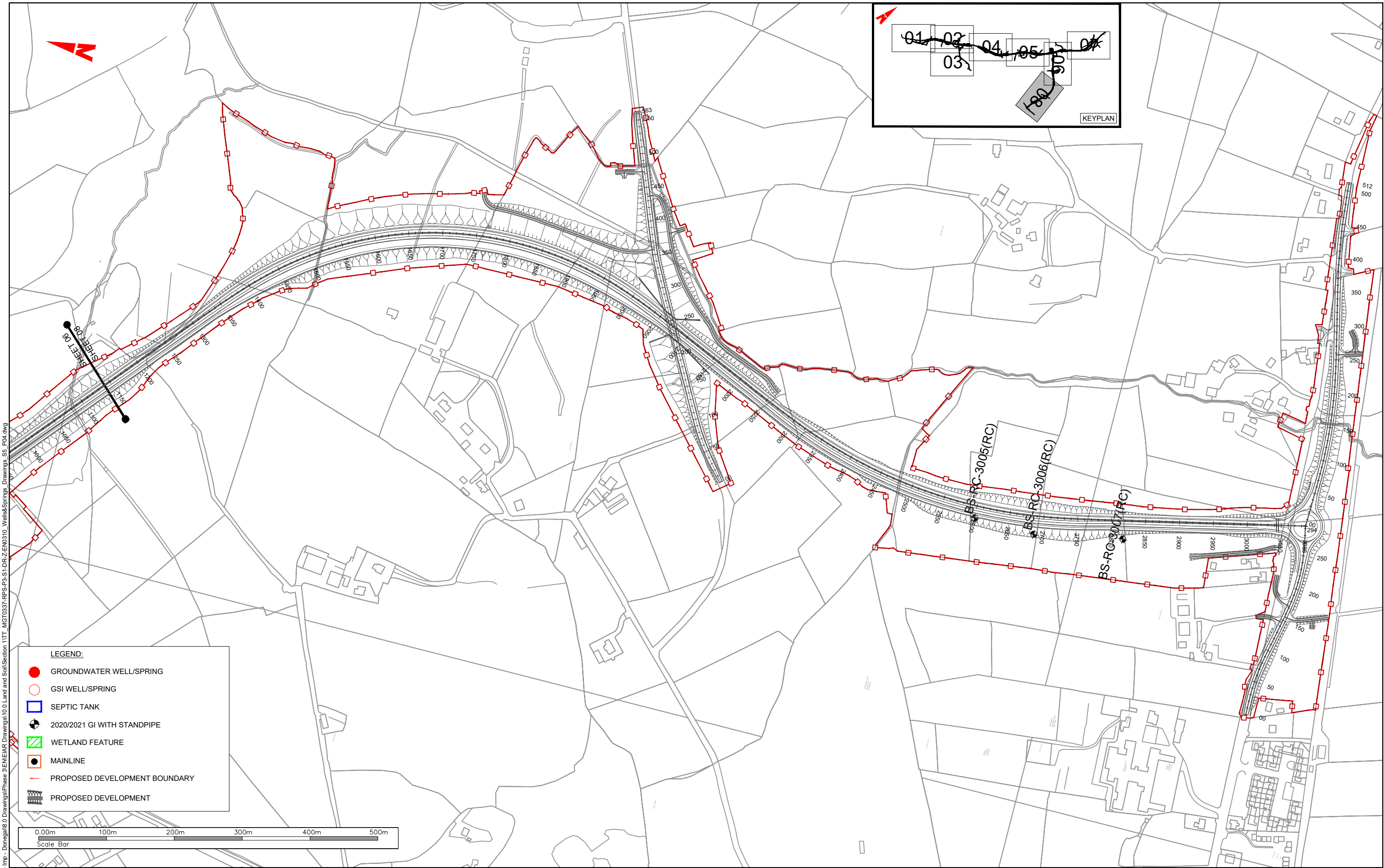

- LEGEND:**
- GROUNDWATER WELL/SPRING
 - GSI WELL/SPRING
 - SEPTIC TANK
 - 2020/2021 GI WITH STANDPIPE
 - WETLAND FEATURE
 - MAINLINE
 - PROPOSED DEVELOPMENT BOUNDARY
 - PROPOSED DEVELOPMENT



T:\MGTO337 - Ten-T Priority Route Imp - Donegal\8.0 Drawings\Phase 3\EMEAR Drawings\10.0 Land and Soil\Section 1\TT_MGT0337-RPS-P3-S1-DR-Z-EN0310 - Wells&Springs Drawings_SS_P04.dwg



NOTES
 DO NOT SCALE, use figured dimensions only.
 All levels are referred to Ordnance Survey Datum, Malin Head.
 This drawing is the property of the Donegal County Council. It is a confidential document and must not be copied, used, or its contents divulged without prior written consent. This document should not be relied on or used in circumstances other than those for which it was originally prepared. RPS / Barry Transportation accepts no responsibility for this document to any other party other than the party by whom it was commissioned.

Rev.	Date	Drawn	Description	Chk'd	Appr.
P01	24.02.26	BH	Issue for Planning	KC	GMCE

Project Title: TEN-T Priority Route Improvement Project, Donegal Section 1 - N15/N13 Ballybofey / Stranorlar Urban Region		Status: A03
Drawing Title: Section 1 - Groundwater Wells & Springs		Rev: P01
Designed: JOC	Date: MAR 2025	EIAR Drawing Identifier: 10.24
Drawn: EG	Scale @ A1: 1:2500	File Identifier: TT_MGT0337-RPS-P3-S1-DR-Z-EN0310
Approved: GMCE	@ A3: 1:5000	Sheet: 08 of 08
Checked: KC		