

LEGEND:

PROPOSED DEVELOPMENT BOUNDARY		PROPOSED IRISH WATER DIVERSIONS FOR WATERMAIN	
PROPOSED DEVELOPMENT		EXISTING WATERMAIN / SS GRAVITY MAIN TO BE MADE REDUNDANT	
EXISTING WATERMAIN		DIVERSION START / END	
EXISTING WATERMAIN NON-SERVICE LINE			
EXISTING WATERMAIN PRESSURE ZONE			
EXISTING SS GRAVITY MAIN			
CONFLICTS IDENTIFIED			

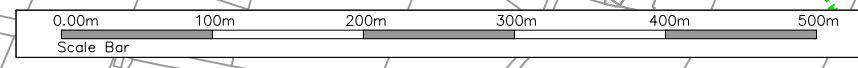

T:\MGTO337 - Ten-T Priority Route Imp - Donegal\8.0 Drawings\Phase 3\UTTT_MGTO337-RPS-P3-S1-DR-C-UT1003 Proposed Irish Water Diversion.dwg

NOTES
 DO NOT SCALE, use figured dimensions only.
 All levels are referred to Ordnance Survey Datum, Mean Head.
 This drawing is the property of the Donegal County Council. It is a confidential document and must not be copied, used, or its contents divulged without prior written consent. This document should not be relied on or used in circumstances other than those for which it was originally prepared. RPS / Barry Transportation accepts no responsibility for this document to any other party other than the party by whom it was commissioned.

Rev.	Date	Drawn	Description	Chk'd	Appr.
P01	04.11.25	MC	ISSUE FOR PLANNING	PS	EC

Project Title: TEN-T Priority Route Improvement Project, Donegal Section 1 - N15/N13 Ballybofey / Stranorlar Urban Region		Status: A3
Drawing Title: PROPOSED IRISH WATER DIVERSION		Rev: P01
Designed: CD	Date: NOV 2025	EIAR Drawing Identifier: EIAR DRAWING 16.10
Drawn: MC	Scale @ A1: 1:2500	File Identifier: TT_MGTO337-RPS-P3-S1-DR-C-UT1003
Approved: EC	@ A3: 1:5000	
Checked: PS	Sheet: 01 of 08	

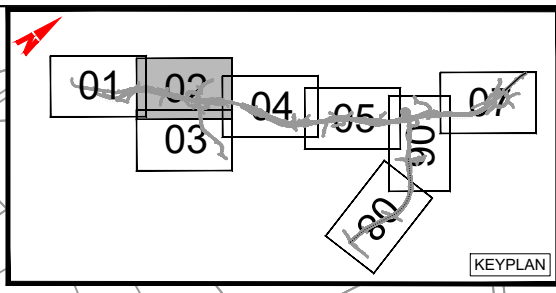
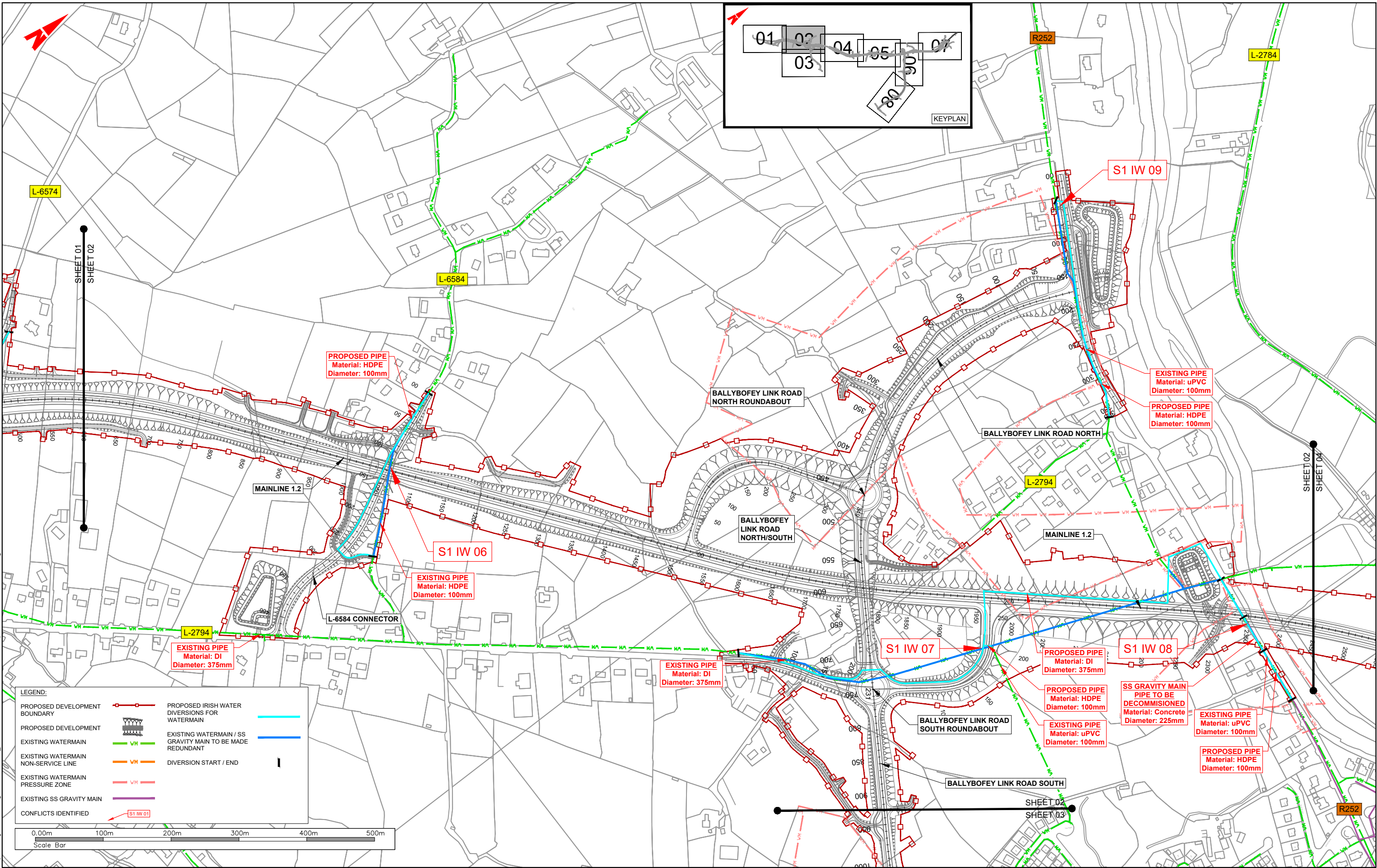

LEGEND:

PROPOSED DEVELOPMENT BOUNDARY	PROPOSED IRISH WATER DIVERSIONS FOR WATERMAIN	EXISTING WATERMAIN / SS GRAVITY MAIN TO BE MADE REDUNDANT
PROPOSED DEVELOPMENT	EXISTING WATERMAIN / SS GRAVITY MAIN TO BE MADE REDUNDANT	DIVERSION START / END
EXISTING WATERMAIN	EXISTING WATERMAIN / SS GRAVITY MAIN TO BE MADE REDUNDANT	
EXISTING WATERMAIN NON-SERVICE LINE	DIVERSION START / END	
EXISTING WATERMAIN PRESSURE ZONE		
EXISTING SS GRAVITY MAIN		
CONFLICTS IDENTIFIED		



T:\MGT0337 - Ten-T Priority Route Improvement Phase 3\UTTT_MGT0337-RPS-P3-S1-DR-C-UT1003 Proposed Irish Water Diversion.dwg



NOTES
 DO NOT SCALE, use figured dimensions only.
 All levels are referred to Ordnance Survey Datum, Main Head.
 This drawing is the property of the Donegal County Council. It is a confidential document and must not be copied, used, or its contents divulged without prior written consent. This document should not be relied on or used in circumstances other than those for which it was originally prepared. RPS / Barry Transportation accepts no responsibility for this document to any other party other than the party by whom it was commissioned.

Rev.	Date	Drawn	Description	Chk'd	Appr.
P01	04.11.25	MC	ISSUE FOR PLANNING	PS	EC

Project Title: TEN-T Priority Route Improvement Project, Donegal Section 1 - N15/N13 Ballybofeigh / Stranorlar Urban Region		Status: A3
Drawing Title: PROPOSED IRISH WATER DIVERSION		Rev: P01
Designed: CD	Date: NOV 2025	EIAR Drawing Identifier: EIAR DRAWING 16.10
Drawn: MC	Scale @ A1: 1:2500	File Identifier: TT_MGT0337-RPS-P3-S1-DR-C-UT1003
Approved: EC	@ A3: 1:5000	
Checked: PS	Sheet: 02 of 08	

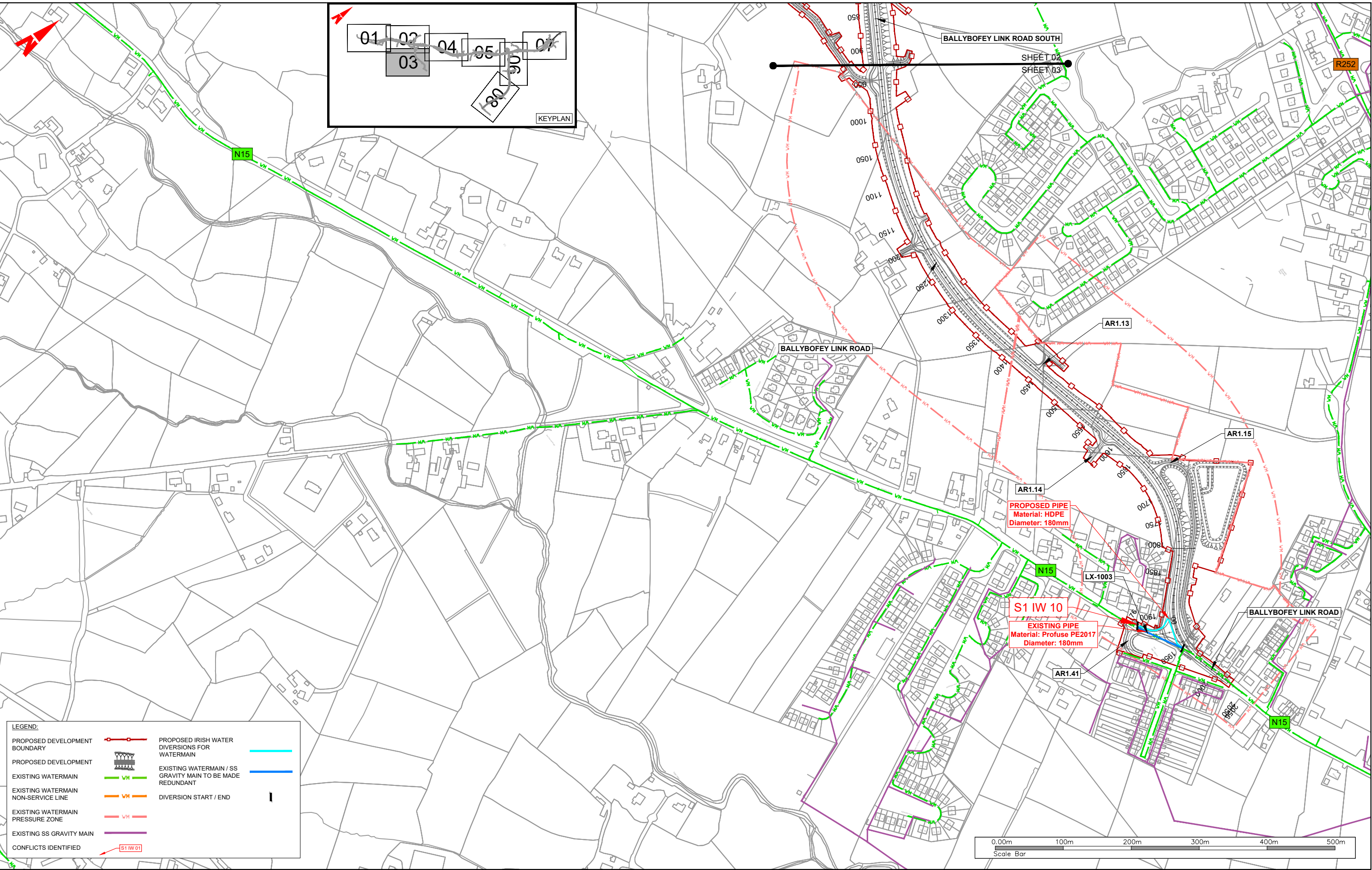

T:\MGT0337 - Ten-T Priority Route Imp - Donegal\8.0 Drawings\Phase 3\UTTT_MGT0337-RPS-P3-S1-DR-C-UT1003 Proposed Irish Water Diversion.dwg

Bonneagar Iompair Éireann
Transport Infrastructure Ireland

Riailtas na hÉireann
Government of Ireland

Tionscadal Éireann
Project Ireland
2040

Donegal
Comhairle Contae
Dhún na nGall
Donegal County Council

RPS BARRY
TRANSPORTATION

NOTES

DO NOT SCALE, use figured dimensions only.

All levels are referred to Ordnance Survey Datum, Mean Head.

This drawing is the property of the Donegal County Council. It is a confidential document and must not be copied, used, or its contents divulged without prior written consent. This document should not be relied on or used in circumstances other than those for which it was originally prepared. RPS / Barry Transportation accepts no responsibility for this document to any other party other than the party by whom it was commissioned.

Rev.	Date	Drawn	Description	Chk'd	Appr.
P01	04.11.25	MC	ISSUE FOR PLANNING	PS	EC

Project Title: TEN-T Priority Route Improvement Project, Donegal Section 1 - N15/N13 Ballybofeigh / Stranorlar Urban Region		Status: A3
Drawing Title: PROPOSED IRISH WATER DIVERSION		Rev: P01
Designed: CD	Date: NOV 2025	EIAR Drawing Identifier: EIAR DRAWING 16.10
Drawn: MC	Scale @ A1: 1:2500	File Identifier: TT_MGT0337-RPS-P3-S1-DR-C-UT1003
Approved: EC	@ A3: 1:5000	
Checked: PS	Sheet: 03 of 08	

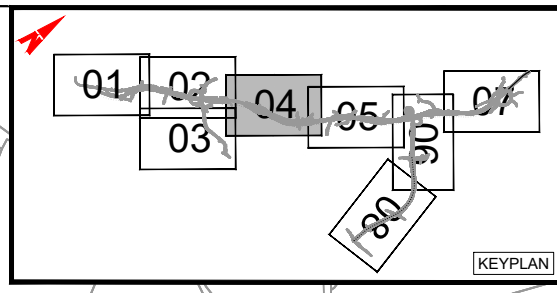
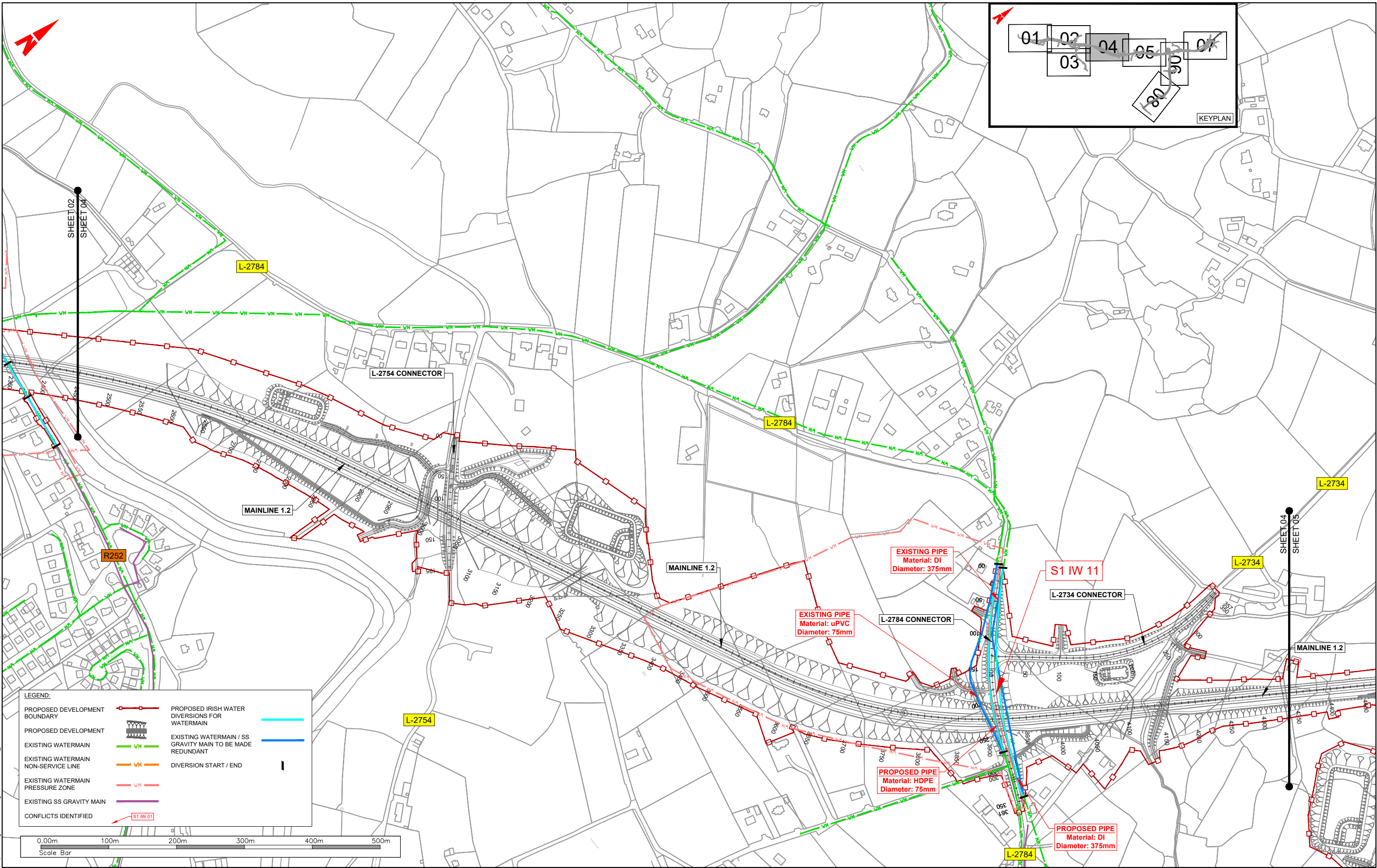

LEGEND:

PROPOSED DEVELOPMENT BOUNDARY	PROPOSED IRISH WATER DIVERSIONS FOR WATERMAIN	EXISTING WATERMAIN / SS GRAVITY MAIN TO BE MADE REDUNDANT
PROPOSED DEVELOPMENT	EXISTING WATERMAIN / SS GRAVITY MAIN TO BE MADE REDUNDANT	EXISTING WATERMAIN NON-SERVICE LINE
EXISTING WATERMAIN	EXISTING WATERMAIN NON-SERVICE LINE	EXISTING WATERMAIN PRESSURE ZONE
EXISTING WATERMAIN NON-SERVICE LINE	DIVERSION START / END	EXISTING SS GRAVITY MAIN
EXISTING WATERMAIN PRESSURE ZONE	DIVERSION START / END	CONFLICTS IDENTIFIED
EXISTING SS GRAVITY MAIN		
CONFLICTS IDENTIFIED		



T:\MGT0337 - Ten-T Priority Route Imp - Donegal\0 Drawings\Phase 3\UT11_MGT0337-RPS-P3-S1-DR-C-UT1003 Proposed Irish Water Diversion.dwg



NOTES
 DO NOT SCALE, use figured dimensions only.
 All levels are referred to Ordnance Survey Datum, Main Head.
 This drawing is the property of the Donegal County Council. It is a confidential document and must not be copied, used, or its contents divulged without prior written consent. This document should not be relied on or used in circumstances other than those for which it was originally prepared. RPS / Barry Transportation accepts no responsibility for this document to any other party other than the party by whom it was commissioned.

Rev.	Date	Drawn	Description	Chk'd	Appr.
P01	04.11.25	MC	ISSUE FOR PLANNING	PS	EC

Project Title: TEN-T Priority Route Improvement Project, Donegal Section 1 - N15/N13 Ballybofey / Stranorlar Urban Region		Status: A3
Drawing Title: PROPOSED IRISH WATER DIVERSION		Rev: P01
Designed: CD	Date: NOV 2025	EIAR Drawing Identifier: EIAR DRAWING 16.10
Drawn: MC	Scale @ A1: 1:2500	File Identifier: TT_MGT0337-RPS-P3-S1-DR-C-UT1003
Approved: EC	@ A3: 1:5000	
Checked: PS	Sheet: 04 of 08	

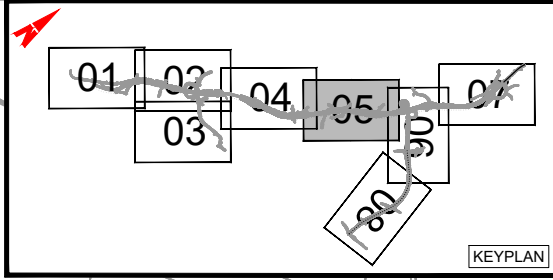
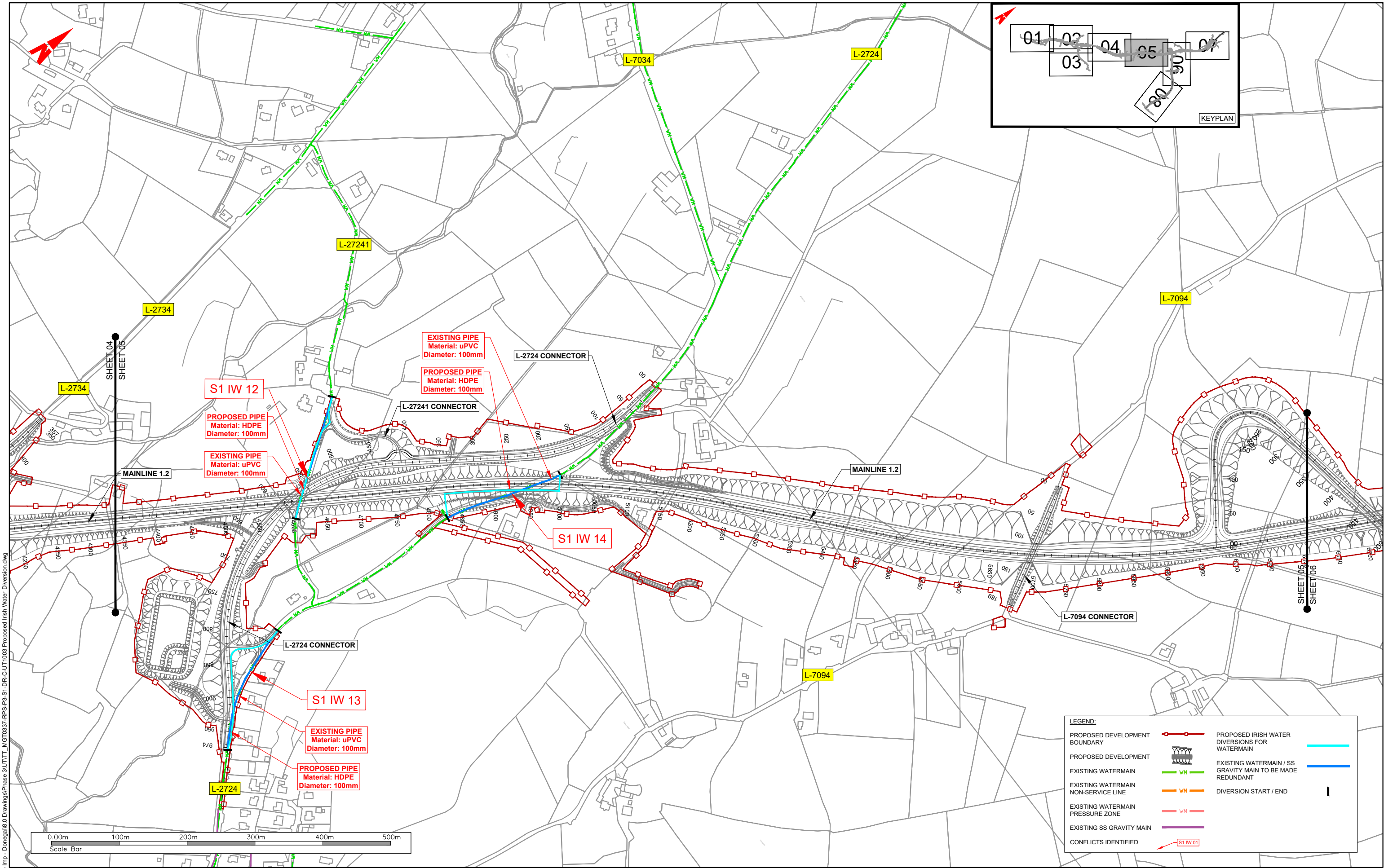

T:\MGT0337 - Ten-T Priority Route Imp - Donegal\8.0 Drawings\Phase 3\UTTT_MGT0337-RPS-P3-S1-DR-C-UT1003 Proposed Irish Water Diversion.dwg

LEGEND:

PROPOSED DEVELOPMENT BOUNDARY		PROPOSED IRISH WATER DIVERSIONS FOR WATERMAIN	
PROPOSED DEVELOPMENT		EXISTING WATERMAIN / SS GRAVITY MAIN TO BE MADE REDUNDANT	
EXISTING WATERMAIN		EXISTING WATERMAIN NON-SERVICE LINE	
EXISTING WATERMAIN PRESSURE ZONE		EXISTING SS GRAVITY MAIN	
EXISTING SS GRAVITY MAIN		CONFLICTS IDENTIFIED	



NOTES
 DO NOT SCALE, use figured dimensions only.
 All levels are referred to Ordnance Survey Datum, Main Head.
 This drawing is the property of the Donegal County Council. It is a confidential document and must not be copied, used, or its contents divulged without prior written consent. This document should not be relied on or used in circumstances other than those for which it was originally prepared. RPS / Barry Transportation accepts no responsibility for this document to any other party other than the party by whom it was commissioned.

Rev.	Date	Drawn	Description	Chk'd	Appr.
P01	04.11.25	MC	ISSUE FOR PLANNING	PS	EC

Project Title: TEN-T Priority Route Improvement Project, Donegal Section 1 - N15/N13 Ballybofey / Stranorlar Urban Region		Status: A3
Drawing Title: PROPOSED IRISH WATER DIVERSION		Rev: P01
Designed: CD	Date: NOV 2025	EIAR Drawing Identifier: EIAIR DRAWING 16.10
Drawn: MC	Scale @ A1: 1:2500	File Identifier: TT_MGT0337-RPS-P3-S1-DR-C-UT1003
Approved: EC	@ A3: 1:5000	
Checked: PS	Sheet: 05 of 08	

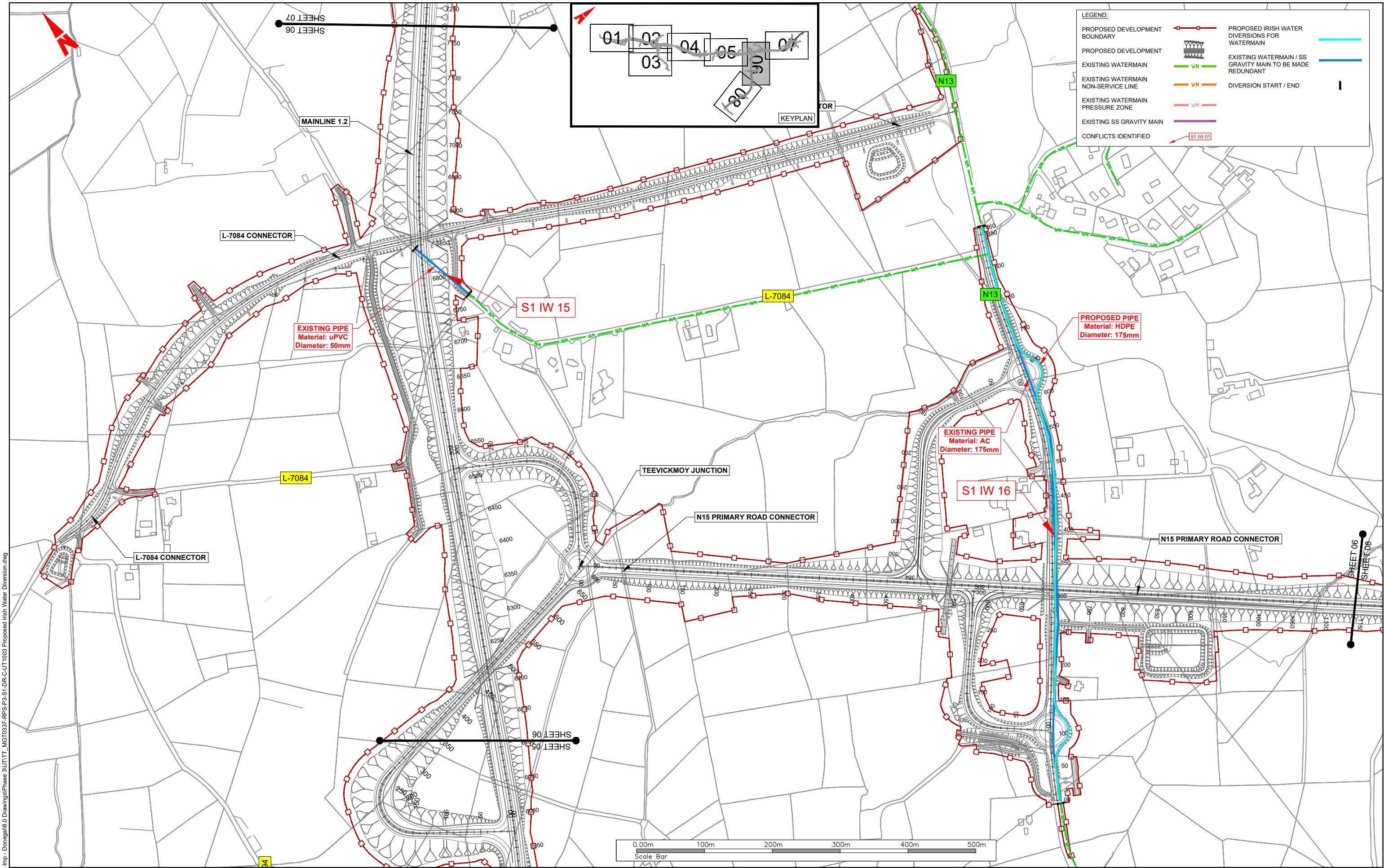

LEGEND:

PROPOSED DEVELOPMENT BOUNDARY		PROPOSED IRISH WATER DIVERSIONS FOR WATERMAIN	
PROPOSED DEVELOPMENT		EXISTING WATERMAIN / SS GRAVITY MAIN TO BE MADE REDUNDANT	
EXISTING WATERMAIN		EXISTING WATERMAIN / SS GRAVITY MAIN TO BE MADE REDUNDANT	
EXISTING WATERMAIN NON-SERVICE LINE		DIVERSION START / END	
EXISTING WATERMAIN PRESSURE ZONE			
EXISTING SS GRAVITY MAIN			
CONFLICTS IDENTIFIED			

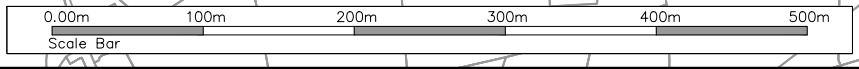
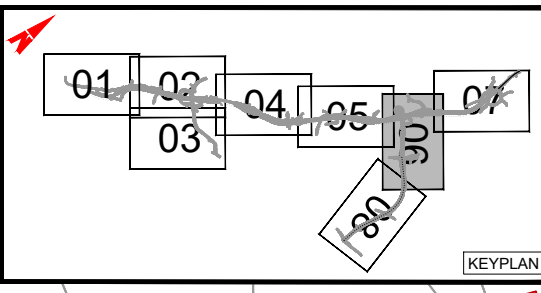

T:\MGT0337 - Ten-T Priority Route Imp - Donegal\8.0 Drawings\Phase 3\UTTT_MGT0337-RPS-P3-S1-DR-C-UT1003 Proposed Irish Water Diversion.dwg

NOTES
 DO NOT SCALE, use figured dimensions only.
 All levels are referred to Ordnance Survey Datum, Main Head.
 This drawing is the property of the Donegal County Council. It is a confidential document and must not be copied, used, or its contents divulged without prior written consent. This document should not be relied on or used in circumstances other than those for which it was originally prepared. RPS / Barry Transportation accepts no responsibility for this document to any other party other than the party by whom it was commissioned.

Rev.	Date	Drawn	Description	Chk'd	Appr.
P01	04.11.25	MC	ISSUE FOR PLANNING	PS	EC

Project Title: TEN-T Priority Route Improvement Project, Donegal Section 1 - N15/N13 Ballybofey / Stranorlar Urban Region		Status: A3
Drawing Title: PROPOSED IRISH WATER DIVERSION		Rev: P01
Designed: CD	Date: NOV 2025	EIAR Drawing Identifier: EIAR DRAWING 16.10
Drawn: MC	Scale @ A1: 1:2500	File Identifier: TT_MGT0337-RPS-P3-S1-DR-C-UT1003
Approved: EC	@ A3: 1:5000	
Checked: PS	Sheet: 06 of 08	

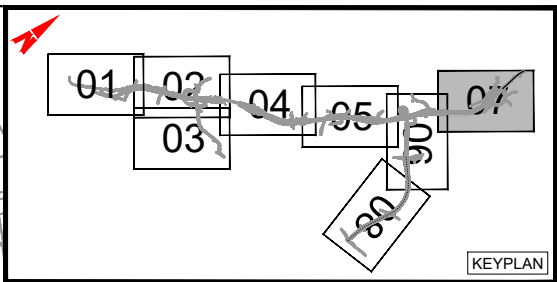
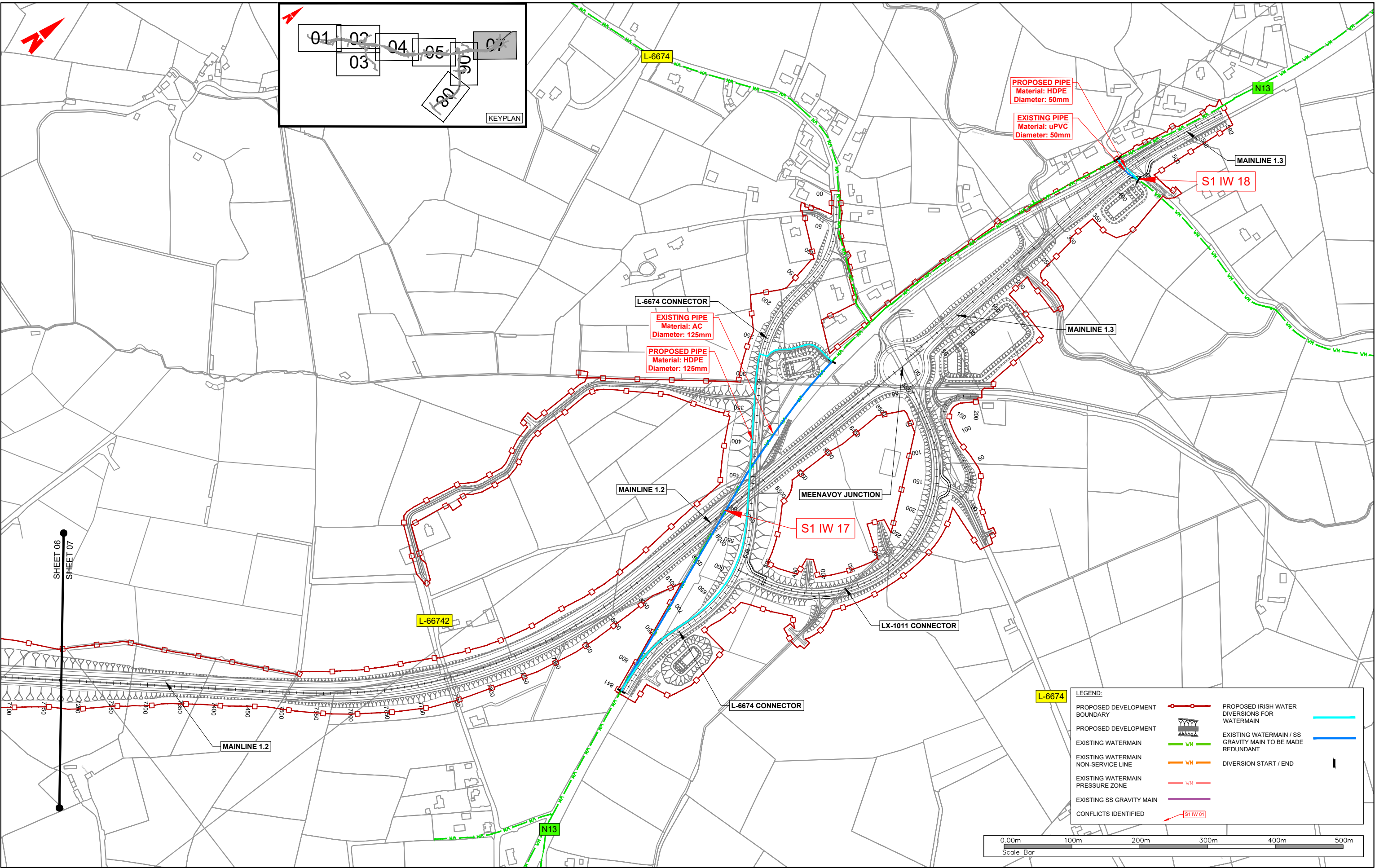

PROPOSED PIPE
Material: HDPE
Diameter: 50mm

EXISTING PIPE
Material: uPVC
Diameter: 50mm

L-6674 CONNECTOR

EXISTING PIPE
Material: AC
Diameter: 125mm

PROPOSED PIPE
Material: HDPE
Diameter: 125mm

LEGEND:

PROPOSED DEVELOPMENT BOUNDARY		PROPOSED IRISH WATER DIVERSIONS FOR WATERMAIN	
PROPOSED DEVELOPMENT		EXISTING WATERMAIN / SS GRAVITY MAIN TO BE MADE REDUNDANT	
EXISTING WATERMAIN		DIVERSION START / END	
EXISTING WATERMAIN NON-SERVICE LINE		CONFLICTS IDENTIFIED	
EXISTING WATERMAIN PRESSURE ZONE			
EXISTING SS GRAVITY MAIN			
CONFLICTS IDENTIFIED			

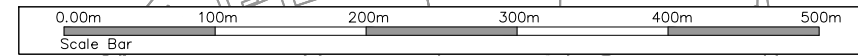

T:\MGT0337 - Ten-T Priority Route Imp - Donegal\8.0 Drawings\Phase 3\UTTT_MGT0337-RPS-P3-S1-DR-C-UT1003 Proposed Irish Water Diversion.dwg

SHEET 06
SHEET 07



NOTES

DO NOT SCALE, use figured dimensions only.

All levels are referred to Ordnance Survey Datum, Main Head.

This drawing is the property of the Donegal County Council. It is a confidential document and must not be copied, used, or its contents divulged without prior written consent. This document should not be relied on or used in circumstances other than those for which it was originally prepared. RPS / Barry Transportation accepts no responsibility for this document to any other party other than the party by whom it was commissioned.

Rev.	Date	Drawn	Description	Chk'd	Appr.
P01	04.11.25	MC	ISSUE FOR PLANNING	PS	EC

Project Title: TEN-T Priority Route Improvement Project, Donegal Section 1 - N15/N13 Ballybofey / Stranorlar Urban Region		Status: A3
Drawing Title: PROPOSED IRISH WATER DIVERSION		Rev: P01
Designed: CD	Date: NOV 2025	EIAR Drawing Identifier: EIAR DRAWING 16.10
Drawn: MC	Scale @ A1: 1:2500	File Identifier: TT_MGT0337-RPS-P3-S1-DR-C-UT1003
Approved: EC	@ A3: 1:5000	
Checked: PS	Sheet: 07 of 08	

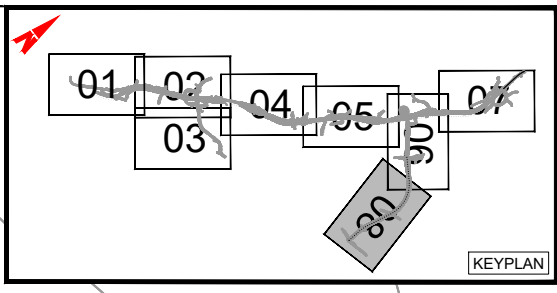
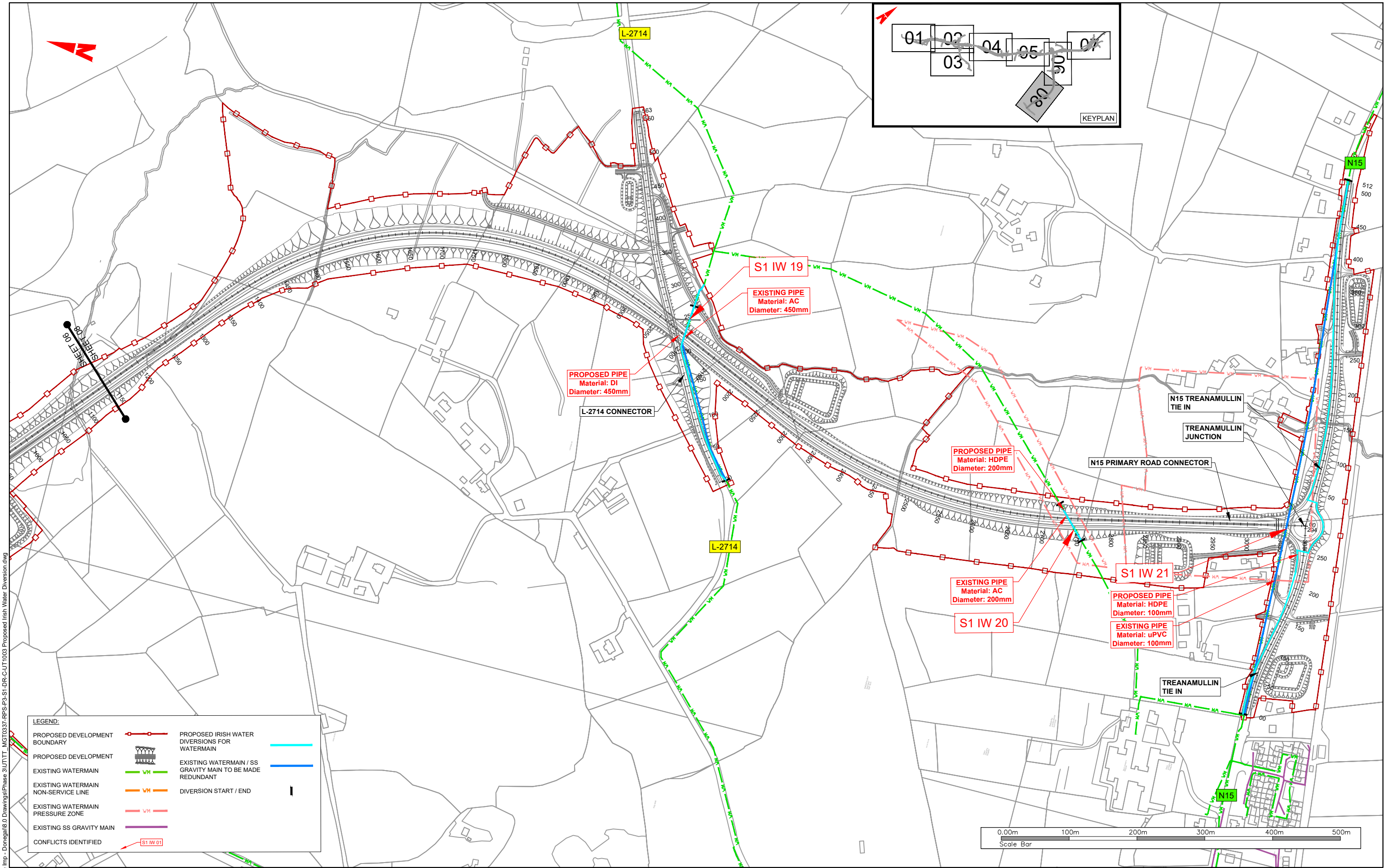

LEGEND:

PROPOSED DEVELOPMENT BOUNDARY		PROPOSED IRISH WATER DIVERSIONS FOR WATERMAIN	
PROPOSED DEVELOPMENT		EXISTING WATERMAIN / SS GRAVITY MAIN TO BE MADE REDUNDANT	
EXISTING WATERMAIN		DIVERSION START / END	
EXISTING WATERMAIN NON-SERVICE LINE			
EXISTING WATERMAIN PRESSURE ZONE			
EXISTING SS GRAVITY MAIN			
CONFLICTS IDENTIFIED			

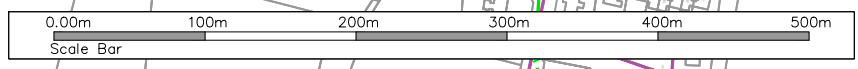

T:\MGT0337 - Ten-T Priority Route Imp - Donegal\8.0 Drawings\Phase 3\UTTT_MGT0337-RPS-P3-S1-DR-C-UT1003 Proposed Irish Water Diversion.dwg



NOTES
 DO NOT SCALE, use figured dimensions only.
 All levels are referred to Ordnance Survey Datum, Mean Head.
 This drawing is the property of the Donegal County Council. It is a confidential document and must not be copied, used, or its contents divulged without prior written consent. This document should not be relied on or used in circumstances other than those for which it was originally prepared. RPS / Barry Transportation accepts no responsibility for this document to any other party other than the party by whom it was commissioned.

Rev.	Date	Drawn	Description	Chk'd	Appr.
P01	04.11.25	MC	ISSUE FOR PLANNING	PS	EC

Project Title: TEN-T Priority Route Improvement Project, Donegal Section 1 - N15/N13 Ballybofey / Stranorlar Urban Region		Status: A3
Drawing Title: PROPOSED IRISH WATER DIVERSION		Rev: P01
Designed: CD	Date: NOV 2025	EIAR Drawing Identifier: EIAR DRAWING 16.10
Drawn: MC	Scale @ A1: 1:2500	File Identifier: TT_MGT0337-RPS-P3-S1-DR-C-UT1003
Approved: EC	@ A3: 1:5000	
Checked: PS	Sheet: 08 of 08	