

**LEGEND:**

- PROPOSED DEVELOPMENT BOUNDARY
- PROPOSED DESIGN
- EXISTING WATERMAIN
- EXISTING WATERMAIN LATERAL CONNECTIONS
- EXISTING GRAVITY SEWER
- PROPOSED WATER DIVERSION
- CONFLICTS IDENTIFIED
- EXISTING WATERMAINS/ SS TO BE MADE REDUNDANT
- EXISTING WATERMAINS TO BE PROTECTED
- DIVERSION START/ END

\legis\racine\localbu\_mens\UBB\0 - Projects\Dublin\Projects\Halcrow\Barry\16 Projects\Y16112 - TEN-T Priority Route Improvement Project Donegal\Civil\CAD\WIP\Prelim Design\CIV\DWG\A5\TT\_Y16112-BT-1A-HUT-S3-DR-CU-27053\_Proposed\_Diversions\_Irish\_Water.dwg

CYAL50441196  
© Taite Éireann - Surveying

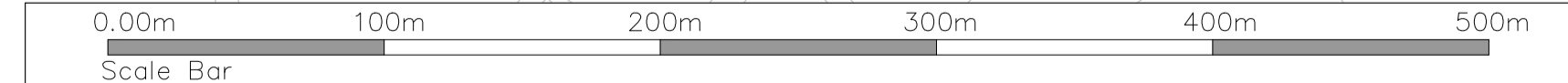

**Notes**  
 DO NOT SCALE. Use figured dimensions only. All levels are referred to Ordnance Survey Datum, Main Head.  
 This drawing is the property of Donegal County Council. It is a confidential document and must not be copied, used, or its contents divulged without prior written consent. This document should not be relied on or used in circumstances other than those for which it was originally prepared. Barry Transportation accepts no responsibility for this document to any other party other than the party by whom it was commissioned.

Rev.	Date	Drawn	Description	Chk'd	Appr.
P01	12.11.25	MG	ISSUE FOR PLANNING	JMM	ED

Project Title: TEN-T PRIORITY ROUTE IMPROVEMENT PROJECT DONEGAL Section 3 - N14 Manorcunningham to Lifford/Strabane/AS Link		Status: A3
Drawing Title: Proposed Diversions Irish Water		Rev: P01
Designed: JMM	Date: NOV 2025	EIAR Drawing Identifier:
Drawn: MG	Scale @ A1: 2500	EIAR DRAWING 16.12
Approved: ED	@ A3: 1:5000	File Identifier:
Checked: JMM	Sheet: 1 OF 10	TT_Y16112-BT-1A-HUT-S3-DR-CU-27053



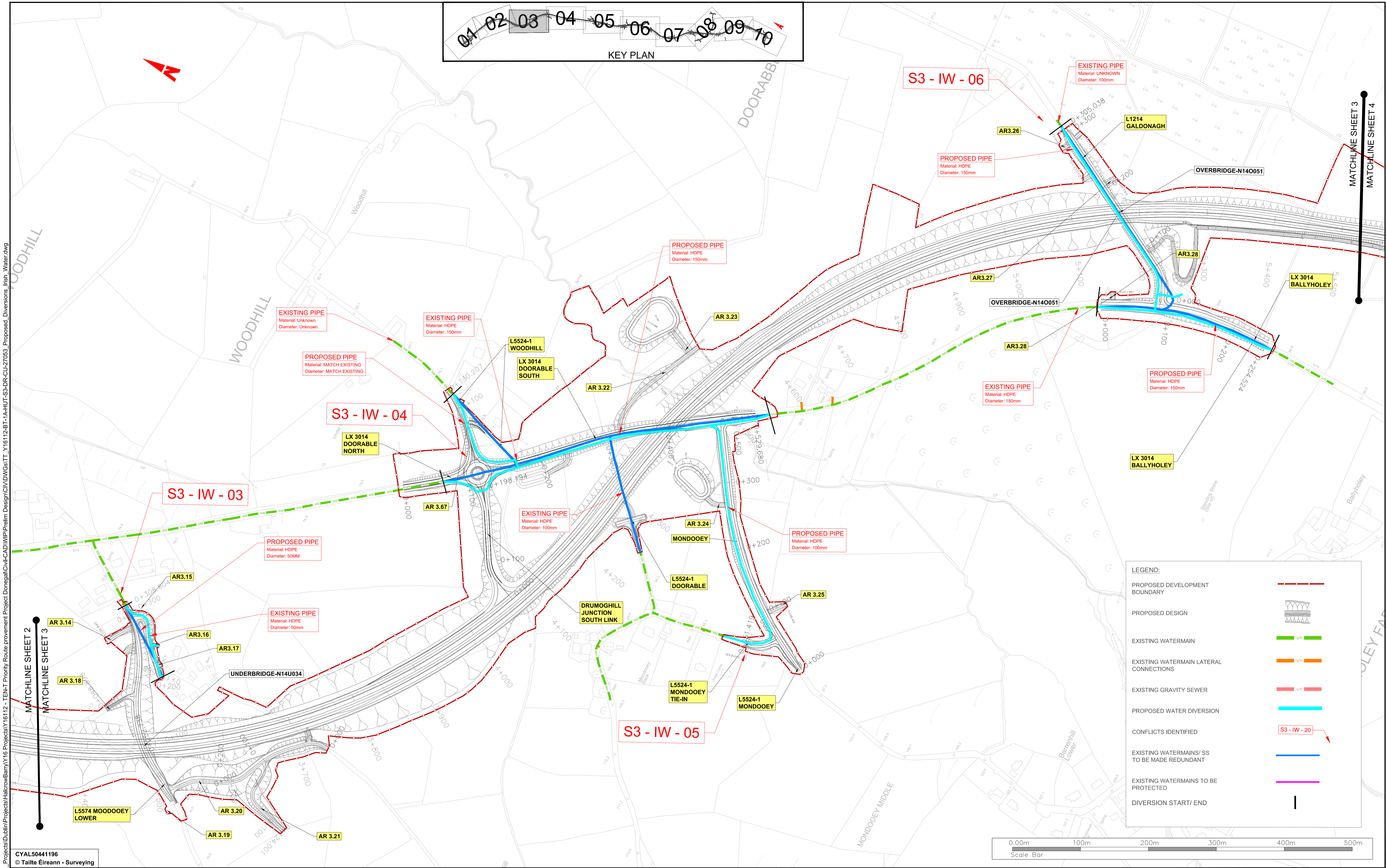
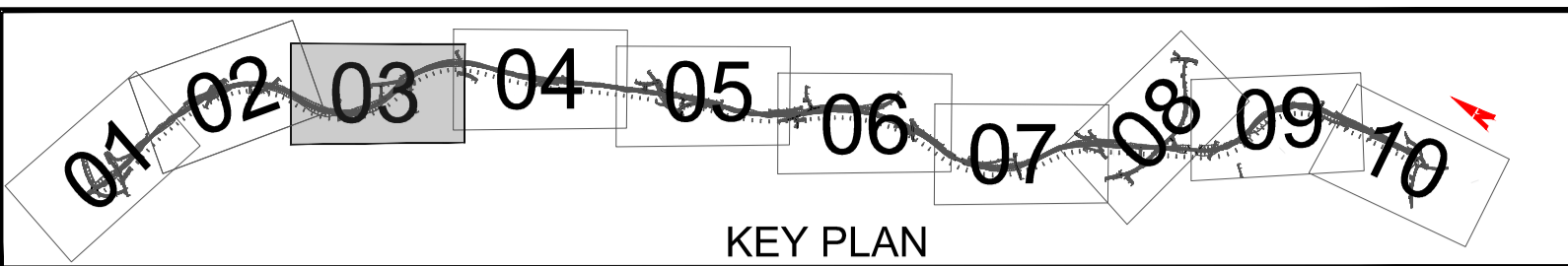

LEGEND:

PROPOSED DEVELOPMENT BOUNDARY	
PROPOSED DESIGN	
EXISTING WATERMAIN	
EXISTING WATERMAIN LATERAL CONNECTIONS	
EXISTING GRAVITY SEWER	
PROPOSED WATER DIVERSION	
CONFLICTS IDENTIFIED	
EXISTING WATERMAINS/ SS TO BE MADE REDUNDANT	
EXISTING WATERMAINS TO BE PROTECTED	
DIVERSION START/ END	

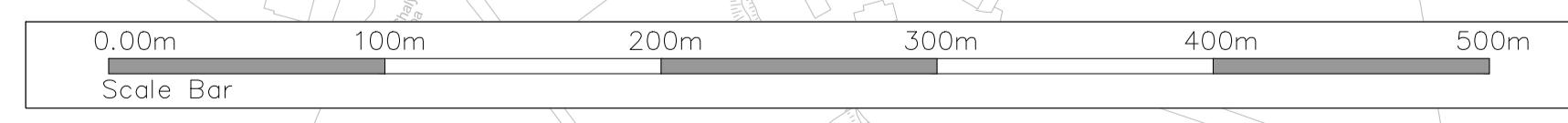

CYAL50441196  
© Taitte Éireann - Surveying



Notes  
DO NOT SCALE. Use figured dimensions only. All levels are referred to Ordnance Survey Datum, Malin Head.  
This drawing is the property of Donegal County Council. It is a confidential document and must not be copied, used, or its contents divulged without prior written consent. This document should not be relied on or used in circumstances other than those for which it was originally prepared. Barry Transportation accepts no responsibility for this document to any other party other than the party by whom it was commissioned.

Rev.	Date	Drawn	Description	Chk'd	Appr.
P01	12.11.25	MG	ISSUE FOR PLANNING	JMM	ED

Project Title:	TEN-T PRIORITY ROUTE IMPROVEMENT PROJECT DONEGAL Section 3 - N14 Manor Cunninghamham to Lifford/Strabane/AS Link			Status:	A3
Drawing Title:	Proposed Diversions Irish Water			Rev:	P01
Designed:	JMM	Date:	NOV 2025	EIAR Drawing Identifier:	
Drawn:	MG	Scale:	@ A1:2500	EIAR Drawing Identifier:	16.12
Approved:	ED	Scale:	@ A3:1:5000	File Identifier:	TT_Y16112-BT-1A-HUT-S3-DR-CU-27053
Checked:	JMM	Sheet:	3 OF 10		

\legis\racine\local\bu\_mens\lib\0 - Projects\Dublin\Projects\Halcrow\Barry\16 Projects\Y16112-BT-1A-HUT-S3-DR-CU-27053\_Prelim Design\CIV\DWG\ITTT\_Y16112-BT-1A-HUT-S3-DR-CU-27053\_Proposed\_Diversions\_Irish\_Water.dwg

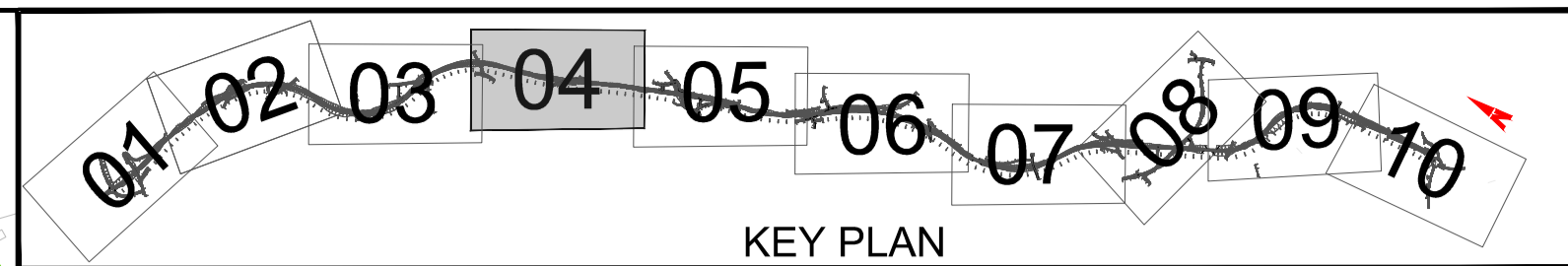
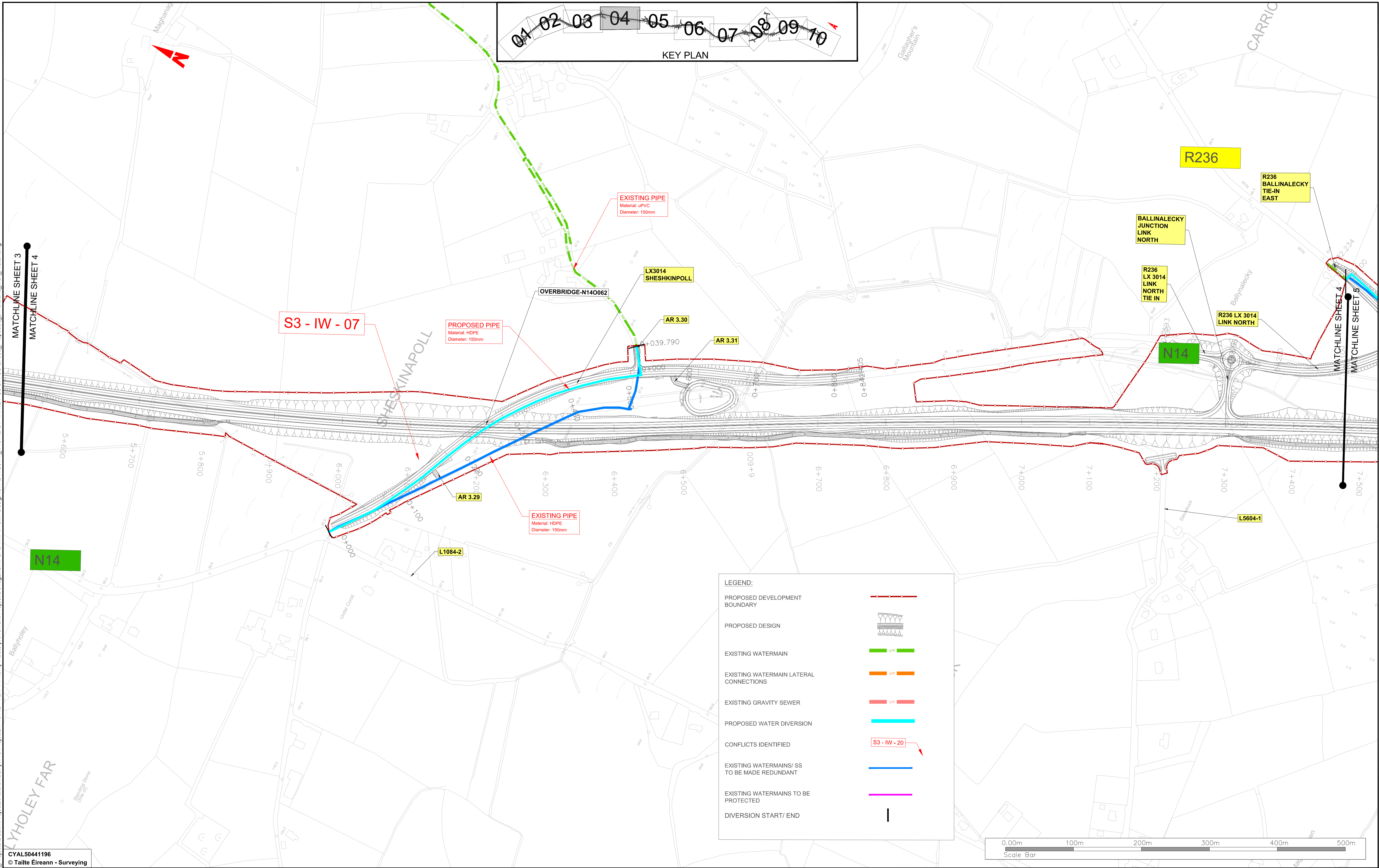

**LEGEND:**

PROPOSED DEVELOPMENT BOUNDARY	
PROPOSED DESIGN	
EXISTING WATERMAIN	
EXISTING WATERMAIN LATERAL CONNECTIONS	
EXISTING GRAVITY SEWER	
PROPOSED WATER DIVERSION	
CONFLICTS IDENTIFIED	
EXISTING WATERMANS/ SS TO BE MADE REDUNDANT	
EXISTING WATERMANS TO BE PROTECTED	
DIVERSION START/ END	

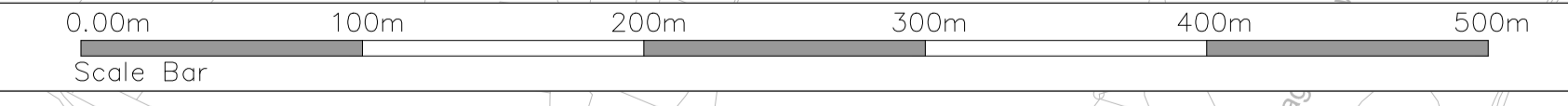

CYAL50441196  
© Talte Éireann - Surveying



**Notes**  
 DO NOT SCALE. Use figured dimensions only. All levels are referred to Ordnance Survey Datum, Mean Head.  
 This drawing is the property of Donegal County Council. It is a confidential document and must not be copied, used, or its contents divulged without prior written consent. This document should not be relied on or used in circumstances other than those for which it was originally prepared. Barry Transportation accepts no responsibility for this document to any other party other than the party by whom it was commissioned.

Rev.	Date	Drawn	Description	Chk'd	Appr.
P01	12.11.25	MG	ISSUE FOR PLANNING	JMM	ED

Project Title: TEN-T PRIORITY ROUTE IMPROVEMENT PROJECT DONEGAL Section 3 - N14 Manor Cunninghamham to Lifford/Strabane/AS Link		Status: A3	
Drawing Title: Proposed Diversions Irish Water		Rev: P01	
Designed: JMM	Date: NOV 2025	EIAR Drawing Identifier:	
Drawn: MG	Scale @ A1: 2500	EIAR DRAWING 16.12	
Approved: ED	@ A3: 1:5000	File Identifier:	
Checked: JMM	Sheet: 4 OF 10	TT_Y16112-BT-1A-HUT-S3-DR-CU-27053	

V:\gis\racine\local\bu\_mens\UBB\0 - Projects\Dublin\Projects\Halcrow\Barry\16 Projects\Y16112 - TEN-T Priority Route Improvement Project Donegal\Civil-CAD\WIP\Preim Design\CIV\DWG\GTT\_Y16112-BT-1A-HUT-S3-DR-CU-27053\_Proposed\_Diversions\_Irish\_Water.dwg

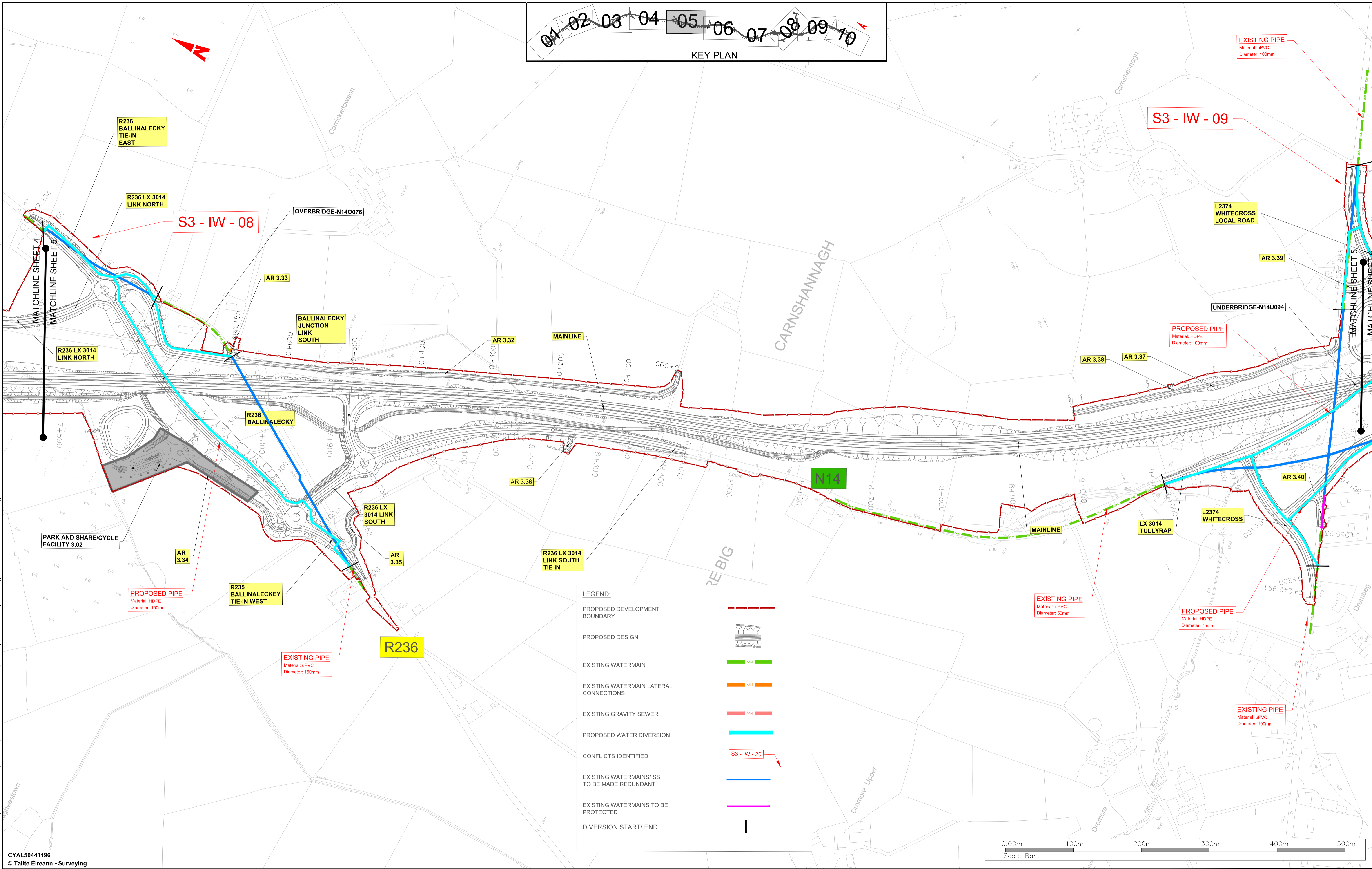
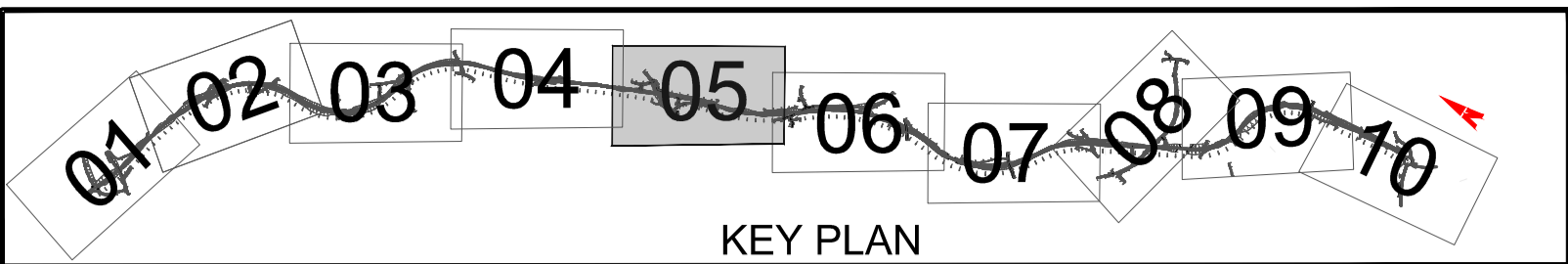

CYAL50441196  
© Taitte Éireann - Surveying

Notes  
DO NOT SCALE. Use figured dimensions only. All levels are referred to Ordnance Survey Datum, Mean Head.  
This drawing is the property of Donegal County Council. It is a confidential document and must not be copied, used, or its contents divulged without prior written consent. This document should not be relied on or used in circumstances other than those for which it was originally prepared. Barry Transportation accepts no responsibility for this document to any other party other than the party by whom it was commissioned.

Rev.	Date	Drawn	Description	Chk'd	Appr.
P01	12.11.25	MG	ISSUE FOR PLANNING	JMM	ED

Project Title: TEN-T PRIORITY ROUTE IMPROVEMENT PROJECT DONEGAL Section 3 - N14 Manorcunningham to Lifford/Strabane/AS Link		Drawing Title: Proposed Diversions Irish Water		Scale: A3:1:5000	Sheet: 5 OF 10
Designed: JMM	Date: NOV 2025	EIA Drawing Identifier: EIA Drawing 16.12		File Identifier: TT_Y16112-BT-1A-HUT-S3-DR-CU-27053	Rev: A3
Drawn: MG	Scale @ A1:1:2500				Rev: P01
Approved: ED	@ A3:1:5000				
Checked: JMM	Sheet: 5 OF 10				

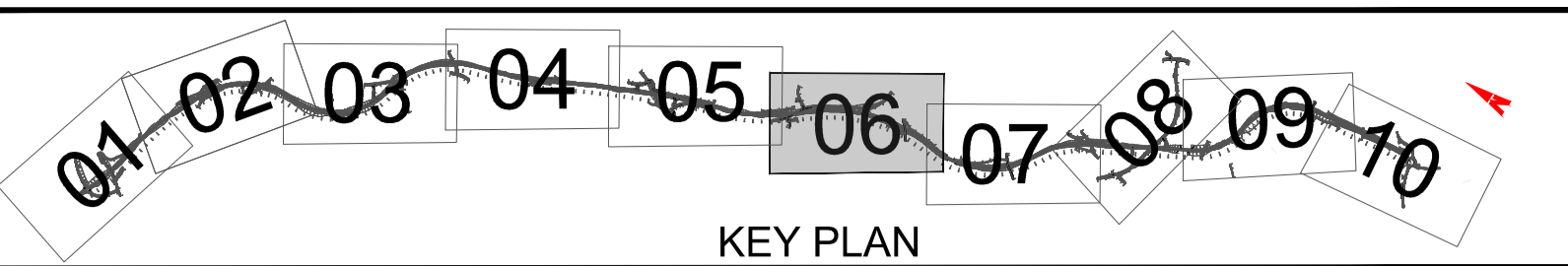
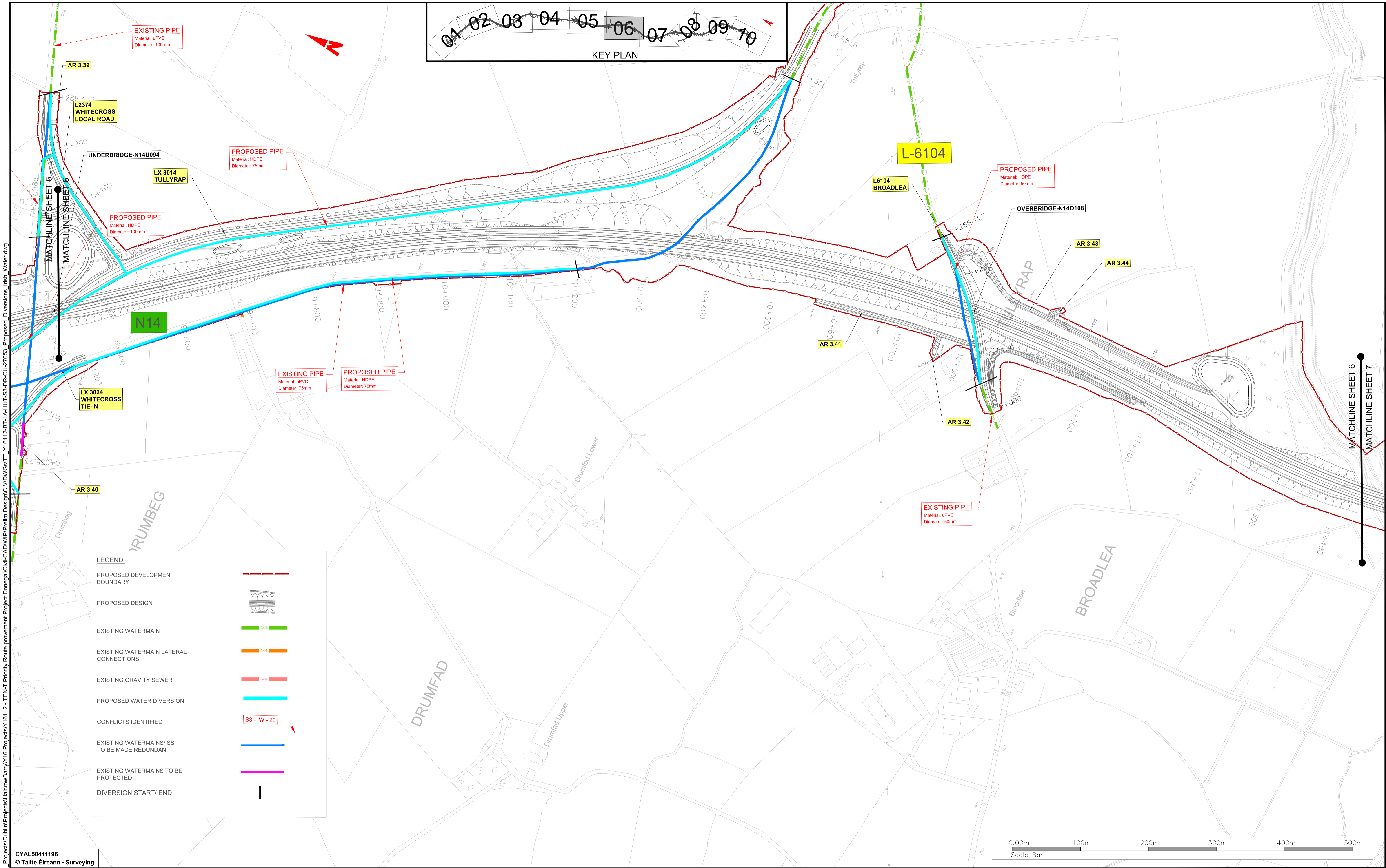

**LEGEND:**

PROPOSED DEVELOPMENT BOUNDARY	
PROPOSED DESIGN	
EXISTING WATERMAIN	
EXISTING WATERMAIN LATERAL CONNECTIONS	
EXISTING GRAVITY SEWER	
PROPOSED WATER DIVERSION	
CONFLICTS IDENTIFIED	
EXISTING WATERMAINS/ SS TO BE MADE REDUNDANT	
EXISTING WATERMAINS TO BE PROTECTED	
DIVERSION START/ END	

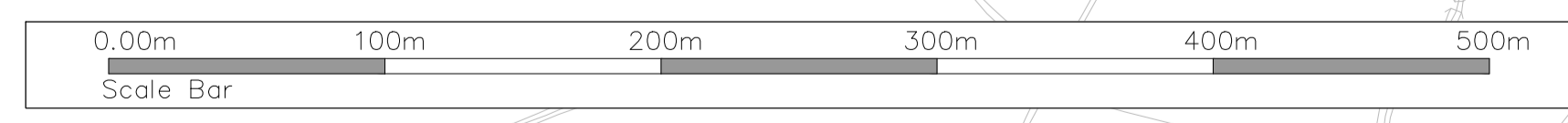

CYAL50441196  
© Taite Éireann - Surveying



**Notes**  
DO NOT SCALE. Use figured dimensions only. All levels are referred to Ordnance Survey Datum, Mean Head.  
This drawing is the property of Donegal County Council. It is a confidential document and must not be copied, used, or its contents divulged without prior written consent. This document should not be relied on or used in circumstances other than those for which it was originally prepared. Barry Transportation accepts no responsibility for this document to any other party other than the party by whom it was commissioned.

Rev.	Date	Drawn	Description	Chk'd	Appr.
P01	12.11.25	MG	ISSUE FOR PLANNING	JMM	ED

Project Title: TEN-T PRIORITY ROUTE IMPROVEMENT PROJECT DONEGAL Section 3 - N14 Manor Cunningham to Lifford/Strabane/AS Link		Drawing Title: Proposed Diversions Irish Water		Status: A3
Designed: JMM	Date: NOV 2025	EIA Drawing Identifier: EIA Drawing 16.12		Rev: P01
Drawn: MG	Scale @ A1: 2500	File Identifier: TT_Y16112-BT-1A-HUT-S3-DR-CU-27053		
Approved: ED	@ A3: 1:5000			
Checked: JMM	Sheet: 6 OF 10			

V:\gis\racine\local\bu\_mens\UBS\0 - Projects\Dublin\Projects\Halcrow\Barr\Y16 Projects\Y16112-BT-1A-HUT-S3-DR-CU-27053\_Proposed\_Diversions\_Irish\_Water.dwg

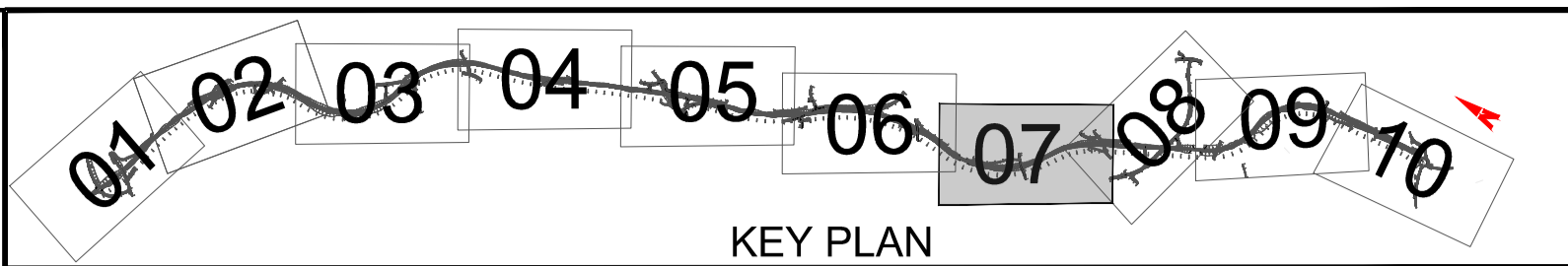

**LEGEND:**

- PROPOSED DEVELOPMENT BOUNDARY
- PROPOSED DESIGN
- EXISTING WATERMAIN
- EXISTING WATERMAIN LATERAL CONNECTIONS
- EXISTING GRAVITY SEWER
- PROPOSED WATER DIVERSION
- CONFLICTS IDENTIFIED S3 - IW - 20
- EXISTING WATERMAINS/ SS TO BE MADE REDUNDANT
- EXISTING WATERMAINS TO BE PROTECTED
- DIVERSION START/ END

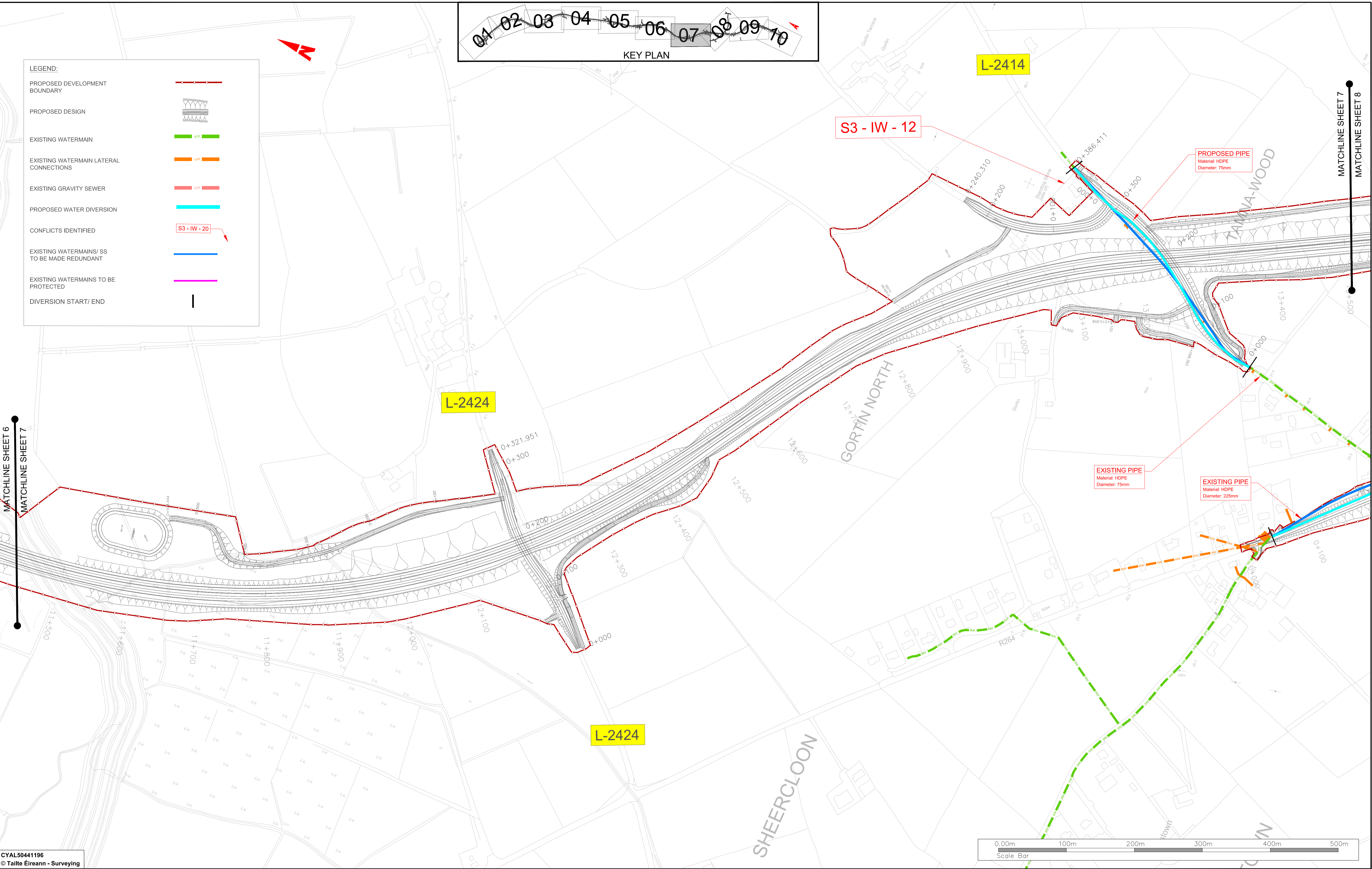

MATCHLINE SHEET 6  
MATCHLINE SHEET 7

MATCHLINE SHEET 7  
MATCHLINE SHEET 8

CYAL50441196  
© Taite Éireann - Surveying

**Notes**  
DO NOT SCALE. Use figured dimensions only. All levels are referred to Ordnance Survey Datum, Mean Head.  
This drawing is the property of Donegal County Council. It is a confidential document and must not be copied, used, or its contents divulged without prior written consent. This document should not be relied on or used in circumstances other than those for which it was originally prepared. Barry Transportation accepts no responsibility for this document to any other party other than the party by whom it was commissioned.

Rev.	Date	Drawn	Description	Chk'd	Appr.
P01	12.11.25	MG	ISSUE FOR PLANNING	JMM	ED

**Project Title:** TEN-T PRIORITY ROUTE IMPROVEMENT PROJECT DONEGAL Section 3 - N14 Manor Cunninghamham to Lifford/Strabane/AS Link

**Drawing Title:** Proposed Diversions Irish Water

**Status:** A3

**Designed:** JMM **Date:** NOV 2025 **EIAR Drawing Identifier:**

**Drawn:** MG **Scale @ A1:** 2500 **EIAR DRAWING 16.12**

**Approved:** ED **@ A3:** 1:5000 **File Identifier:** TT\_Y16112-BT-1A-HUT-S3-DR-CU-27053

**Checked:** JMM **Sheet:** 7 OF 10

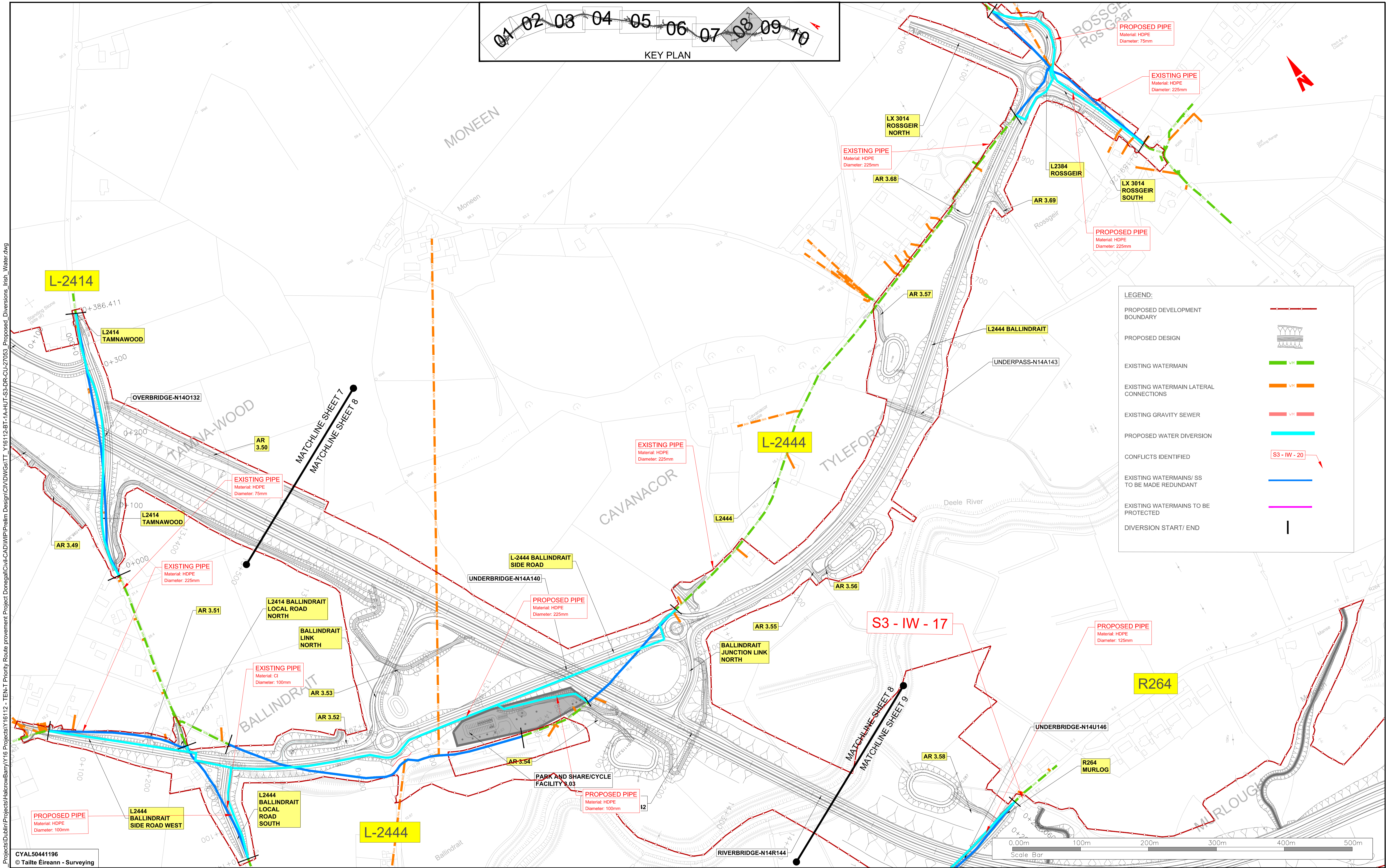
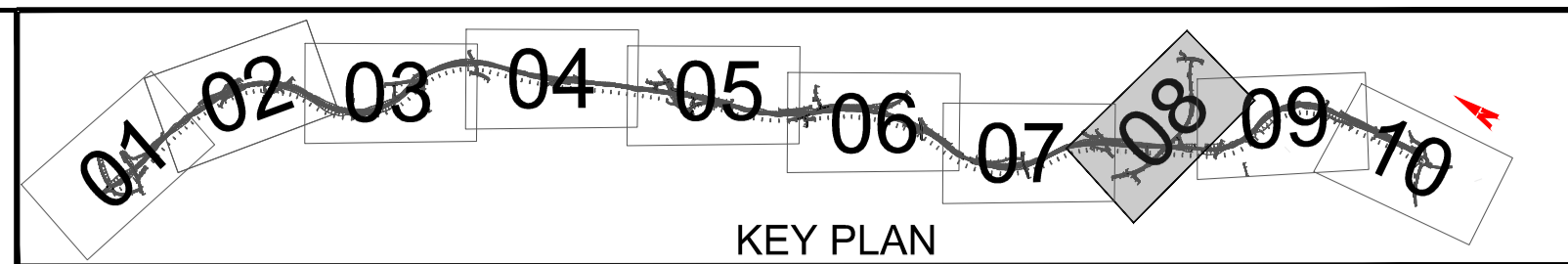

**LEGEND:**

- PROPOSED DEVELOPMENT BOUNDARY
- PROPOSED DESIGN
- EXISTING WATERMAIN
- EXISTING WATERMAIN LATERAL CONNECTIONS
- EXISTING GRAVITY SEWER
- PROPOSED WATER DIVERSION
- CONFLICTS IDENTIFIED
- EXISTING WATERMAINS/ SS TO BE MADE REDUNDANT
- EXISTING WATERMAINS TO BE PROTECTED
- DIVERSION START/ END



CYAL50441196  
© Taite Éireann - Surveying



**Notes**  
DO NOT SCALE. Use figured dimensions only. All levels are referred to Ordnance Survey Datum, Malin Head.  
This drawing is the property of Donegal County Council. It is a confidential document and must not be copied, used, or its contents divulged without prior written consent. This document should not be relied on or used in circumstances other than those for which it was originally prepared. Barry Transportation accepts no responsibility for this document to any other party other than the party by whom it was commissioned.

Rev.	Date	Drawn	Description	Chk'd	Appr.
P01	12.11.25	MG	ISSUE FOR PLANNING	JMM	ED

Project Title: TEN-T PRIORITY ROUTE IMPROVEMENT PROJECT DONEGAL Section 3 - N14 Manor Cunninghamham to Lifford/Strabane/AS Link		Status: A3
Drawing Title: Proposed Diversions Irish Water		Rev: P01
Designed: JMM	Date: NOV 2025	EIAR Drawing Identifier:
Drawn: MG	Scale @ A1: 2500	EIAR DRAWING 16.12
Approved: ED	@ A3: 1:5000	File Identifier:
Checked: JMM	Sheet: 8 OF 10	TT_Y16112-BT-1A-HUT-S3-DR-CU-27053

\\egis.racine.local\bu\_mens\UBB\0 - Projects\Dublin\Projects\Halcrow\Barry\16 Projects\Y16112 - TEN-T Priority Route Improvement Project Donegal\Civil-CAD\WIP\Prelim Design\CIVIL\DWG\G1TT\_Y16112-BT-1A-HUT-S3-DR-CU-27053\_Proposed\_Diversions\_Irish\_Water.dwg

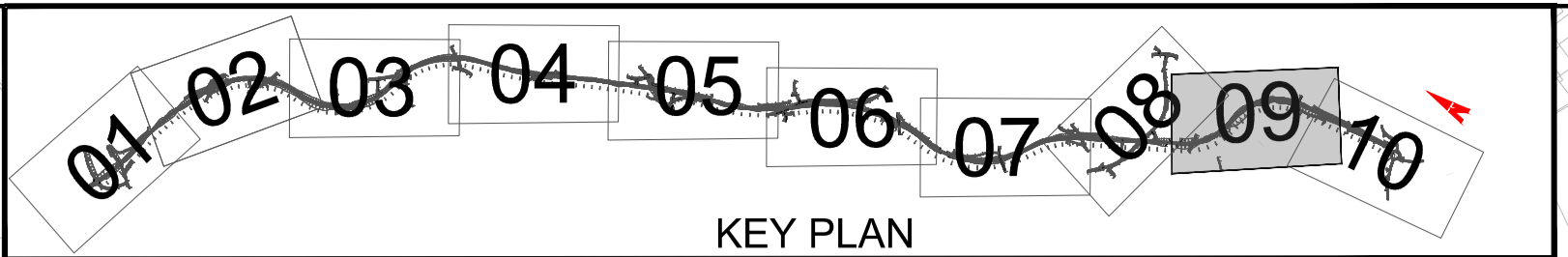
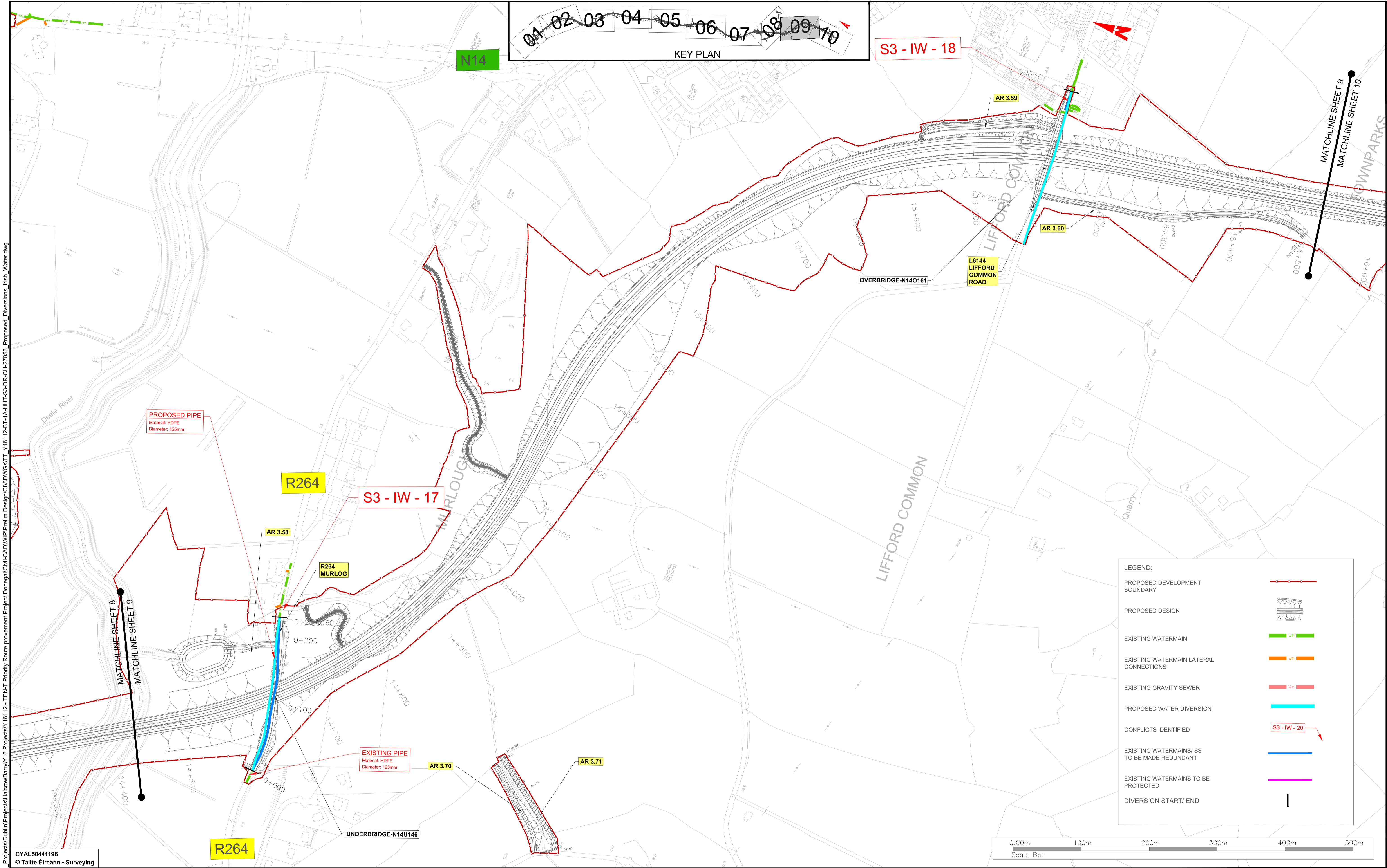

LEGEND:

PROPOSED DEVELOPMENT BOUNDARY	
PROPOSED DESIGN	
EXISTING WATERMAIN	
EXISTING WATERMAIN LATERAL CONNECTIONS	
EXISTING GRAVITY SEWER	
PROPOSED WATER DIVERSION	
CONFLICTS IDENTIFIED	
EXISTING WATERMAINS/ SS TO BE MADE REDUNDANT	
EXISTING WATERMAINS TO BE PROTECTED	
DIVERSION START/ END	

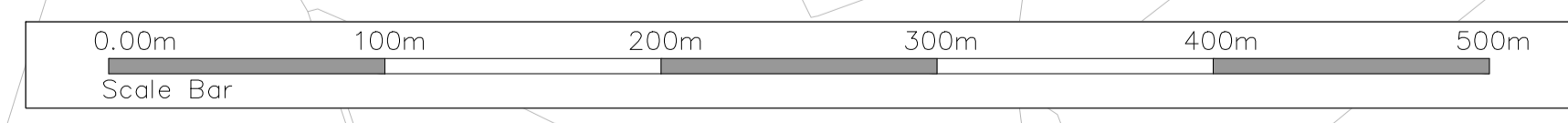

CYAL50441196  
© Taite Éireann - Surveying

Notes  
DO NOT SCALE. Use figured dimensions only. All levels are referred to Ordnance Survey Datum, Mean Head.  
This drawing is the property of Donegal County Council. It is a confidential document and must not be copied, used, or its contents divulged without prior written consent. This document should not be relied on or used in circumstances other than those for which it was originally prepared. Barry Transportation accepts no responsibility for this document to any other party other than the party by whom it was commissioned.

Rev.	Date	Drawn	Description	Ch'kd	Appr.
P01	12.11.25	MG	ISSUE FOR PLANNING	JMM	ED

Project Title: TEN-T PRIORITY ROUTE IMPROVEMENT PROJECT DONEGAL Section 3 - N14 Manor Cunninghamham to Lifford/Strabane/AS Link		Status: A3	
Drawing Title: Proposed Diversions Irish Water		Rev: P01	
Designed: JMM	Date: NOV 2025	EIAR Drawing Identifier:	
Drawn: MG	Scale @ A1: 2500	EIAR DRAWING 16.12	
Approved: ED	@ A3: 1:5000	File Identifier:	
Checked: JMM	Sheet: 9 OF 10	TT_Y16112-BT-1A-HUT-S3-DR-CU-27053	

Legis.racine.localbu\_mens\UBS\0 - Projects\Dublin\Projects\Halcrow\Y16 Projects\Y16112 - TEN-T Priority Route Improvement Project Donegal\Civil-CAD\WIP\Preim Design\CIV\DWG\Gst\TT\_Y16112-BT-1A-HUT-S3-DR-CU-27053\_Proposed\_Diversions\_Irish\_Water.dwg

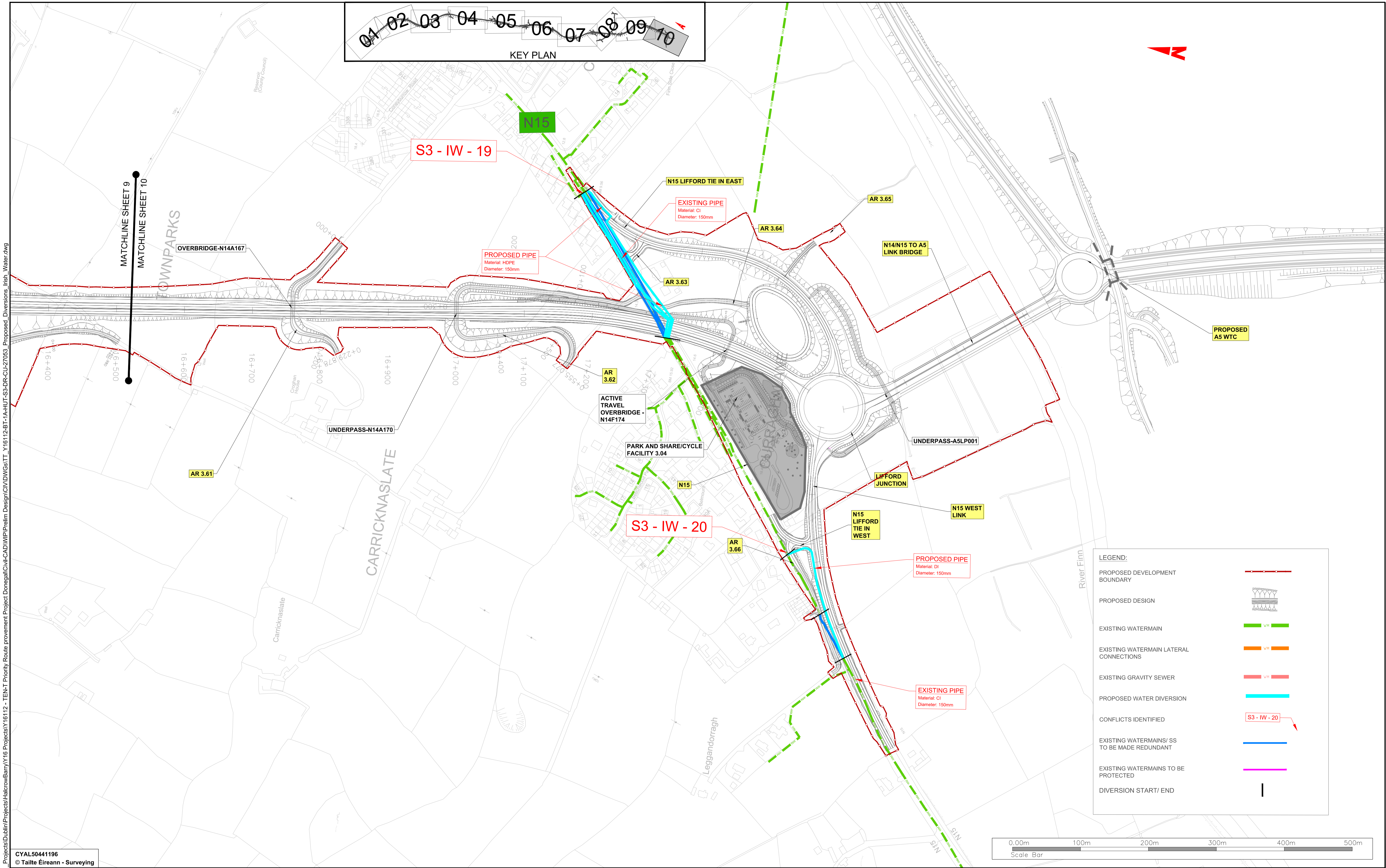
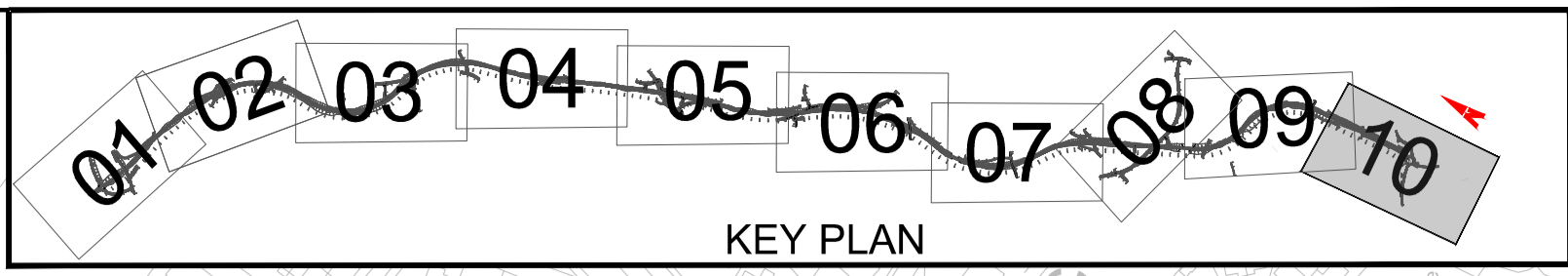

**LEGEND:**

PROPOSED DEVELOPMENT BOUNDARY	
PROPOSED DESIGN	
EXISTING WATERMAIN	
EXISTING WATERMAIN LATERAL CONNECTIONS	
EXISTING GRAVITY SEWER	
PROPOSED WATER DIVERSION	
CONFLICTS IDENTIFIED	
EXISTING WATERMAINS/ SS TO BE MADE REDUNDANT	
EXISTING WATERMAINS TO BE PROTECTED	
DIVERSION START/ END	

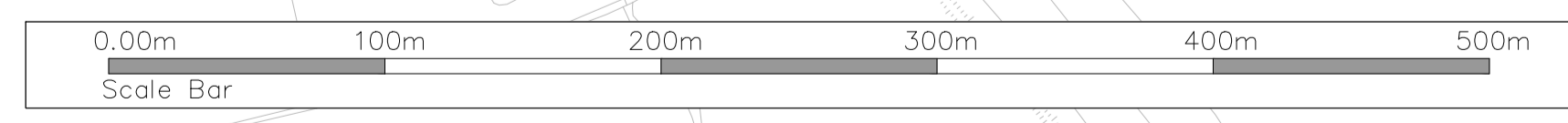

CYAL50441196  
© Taite Éireann - Surveying



**Notes**  
DO NOT SCALE. Use figured dimensions only. All levels are referred to Ordnance Survey Datum, Mean Head.  
This drawing is the property of Donegal County Council. It is a confidential document and must not be copied, used, or its contents divulged without prior written consent. This document should not be relied on or used in circumstances other than those for which it was originally prepared. Barry Transportation accepts no responsibility for this document to any other party other than the party by whom it was commissioned.

Rev.	Date	Drawn	Description	Chk'd	Appr.
P01	12.11.25	MG	ISSUE FOR PLANNING	JMM	ED

Project Title: TEN-T PRIORITY ROUTE IMPROVEMENT PROJECT DONEGAL Section 3 - N14 Manor Cunninghamham to Lifford/Strabane/A5 Link		Status: A3
Drawing Title: Proposed Diversions Irish Water		Rev: P01
Designed: JMM	Date: NOV 2025	EIAR Drawing Identifier:
Drawn: MG	Scale @ A1: 2500	EIAR DRAWING 16.12
Approved: ED	@ A3: 1:5000	File Identifier:
Checked: JMM	Sheet: 10 OF 10	TT_Y16112-BT-1A-HUT-S3-DR-CU-27053

V:\gis\racine\local\bu\_mens\UBS\0\_P\Projects\Dublin\Projects\Halcrow\Barry\16 Projects\Y16112-BT-1A-HUT-S3-DR-CU-27053\_P\Proposed\_Diversions\_Irish\_Water.dwg