

- LEGEND:**
- PROPOSED DEVELOPMENT
 - PROPOSED DEVELOPMENT BOUNDARY
 - EXISTING EIR UNDERGROUND
 - EXISTING EIR AERIAL
 - PROPOSED EIR DIVERSIONS
 - EIR EXISTING POLES
 - EIR EXISTING TESTED POLES
 - PROPOSED EIR POLES

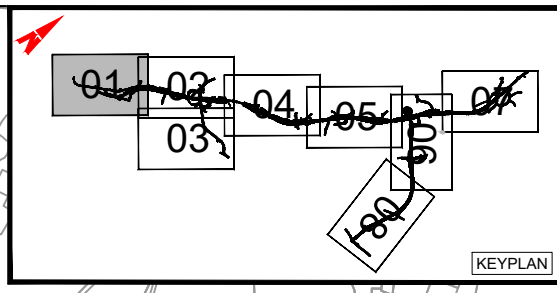

SHEET 01
SHEET 02

T:\MGT0337 - Ten-T Priority Route Imp - Donegal\0 Drawings\Phase 3\UTTT_MGT0337-RPS-P3-S1-DR-C-UT1005 Proposed EIR Diversion.dwg

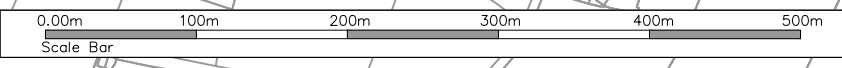

NOTES
 DO NOT SCALE, use figured dimensions only.
 All levels are referred to Ordnance Survey Datum, Mean Head.
 This drawing is the property of the Donegal County Council. It is a confidential document and must not be copied, used, or its contents divulged without prior written consent. This document should not be relied on or used in circumstances other than those for which it was originally prepared. RPS / Barry Transportation accepts no responsibility for this document to any other party other than the party by whom it was commissioned.

Rev.	Date	Drawn	Description	Chk'd	Appr.
P01	04.11.25	MC	ISSUE FOR PLANNING	PS	EC

Project Title: TEN-T Priority Route Improvement Project, Donegal Section 1 - N15/N13 Ballybofey / Stranorlar Urban Region		Status: A3
Drawing Title: PROPOSED EIR DIVERSIONS		Rev: P01
Designed: SS	Date: NOV 2025	EIAR Drawing Identifier: EIAR DRAWING 16.15
Drawn: MC	Scale @ A1: 1:2500	File Identifier: TT_MGT0337-RPS-P3-S1-DR-C-UT1005
Approved: EC	@ A3: 1:5000	
Checked: PS	Sheet: 01 of 08	

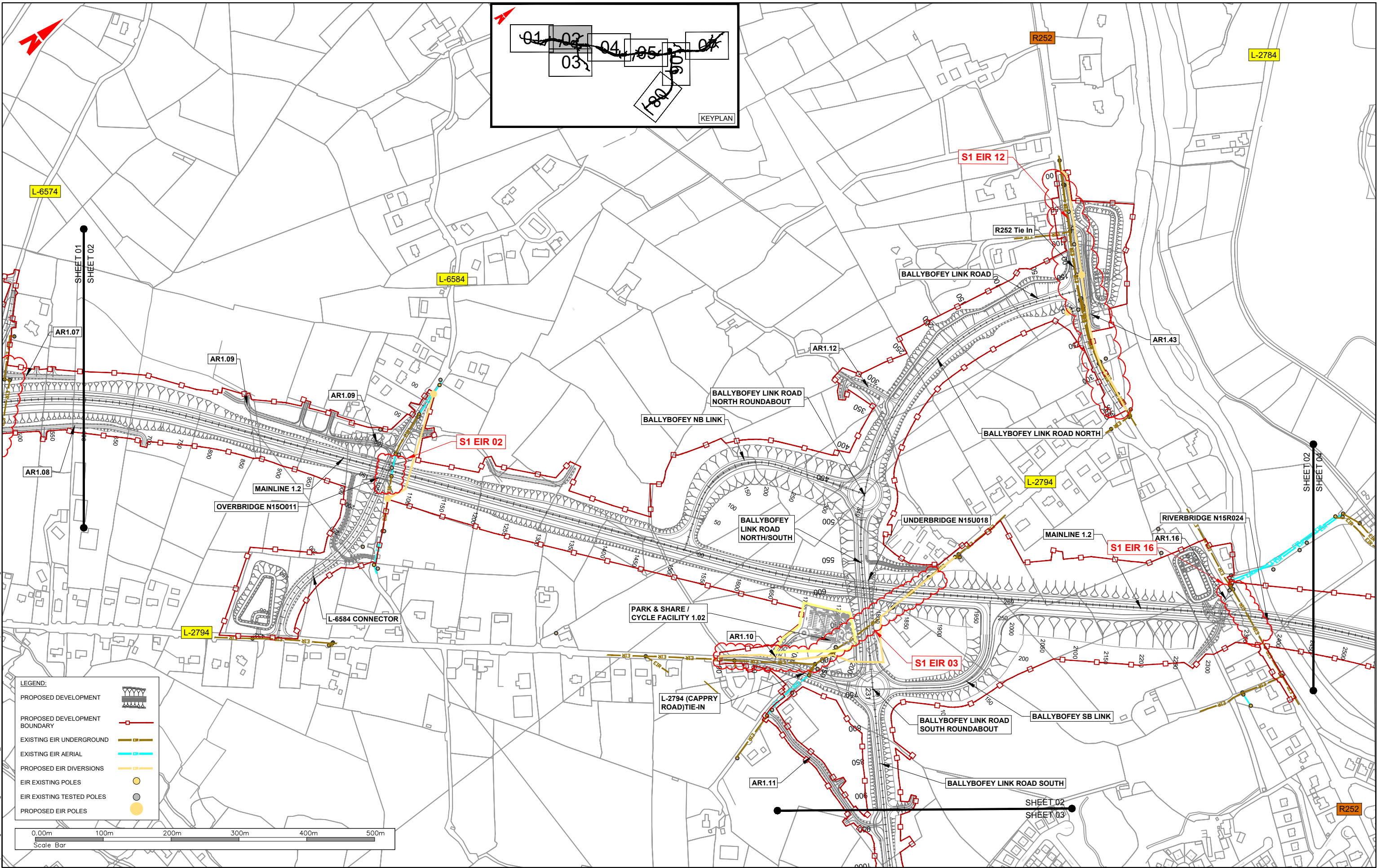

- LEGEND:**
- PROPOSED DEVELOPMENT
 - PROPOSED DEVELOPMENT BOUNDARY
 - EXISTING EIR UNDERGROUND
 - EXISTING EIR AERIAL
 - PROPOSED EIR DIVERSIONS
 - EIR EXISTING POLES
 - EIR EXISTING TESTED POLES
 - PROPOSED EIR POLES

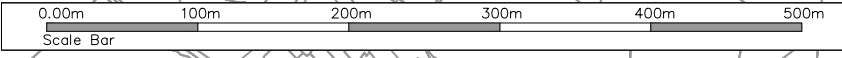

NOTES
 DO NOT SCALE, use figured dimensions only.
 All levels are referred to Ordnance Survey Datum, Mean Head.
 This drawing is the property of the Donegal County Council. It is a confidential document and must not be copied, used, or its contents divulged without prior written consent. This document should not be relied on or used in circumstances other than those for which it was originally prepared. RPS / Barry Transportation accepts no responsibility for this document to any other party other than the party by whom it was commissioned.

Rev.	Date	Drawn	Description	Chk'd	Appr.
P01	04.11.25	MC	ISSUE FOR PLANNING	PS	EC

Project Title: TEN-T Priority Route Improvement Project, Donegal Section 1 - N15/N13 Ballybofeiy / Stranorlar Urban Region		Status: A3
Drawing Title: PROPOSED EIR DIVERSIONS		Rev: P01
Designed: SS	Date: NOV 2025	EIAR Drawing Identifier: EIAR DRAWING 16.15
Drawn: MC	Scale @ A1: 1:2500	File Identifier: TT_MGT0337-RPS-P3-S1-DR-C-UT1005
Approved: EC	@ A3: 1:5000	
Checked: PS	Sheet: 02 of 08	

T:\MGT0337 - Ten-T Priority Route Imp - Donegal\8.0 Drawings\Phase 3\UTTT_MGT0337-RPS-P3-S1-DR-C-UT1005 Proposed EIR Diversion.dwg

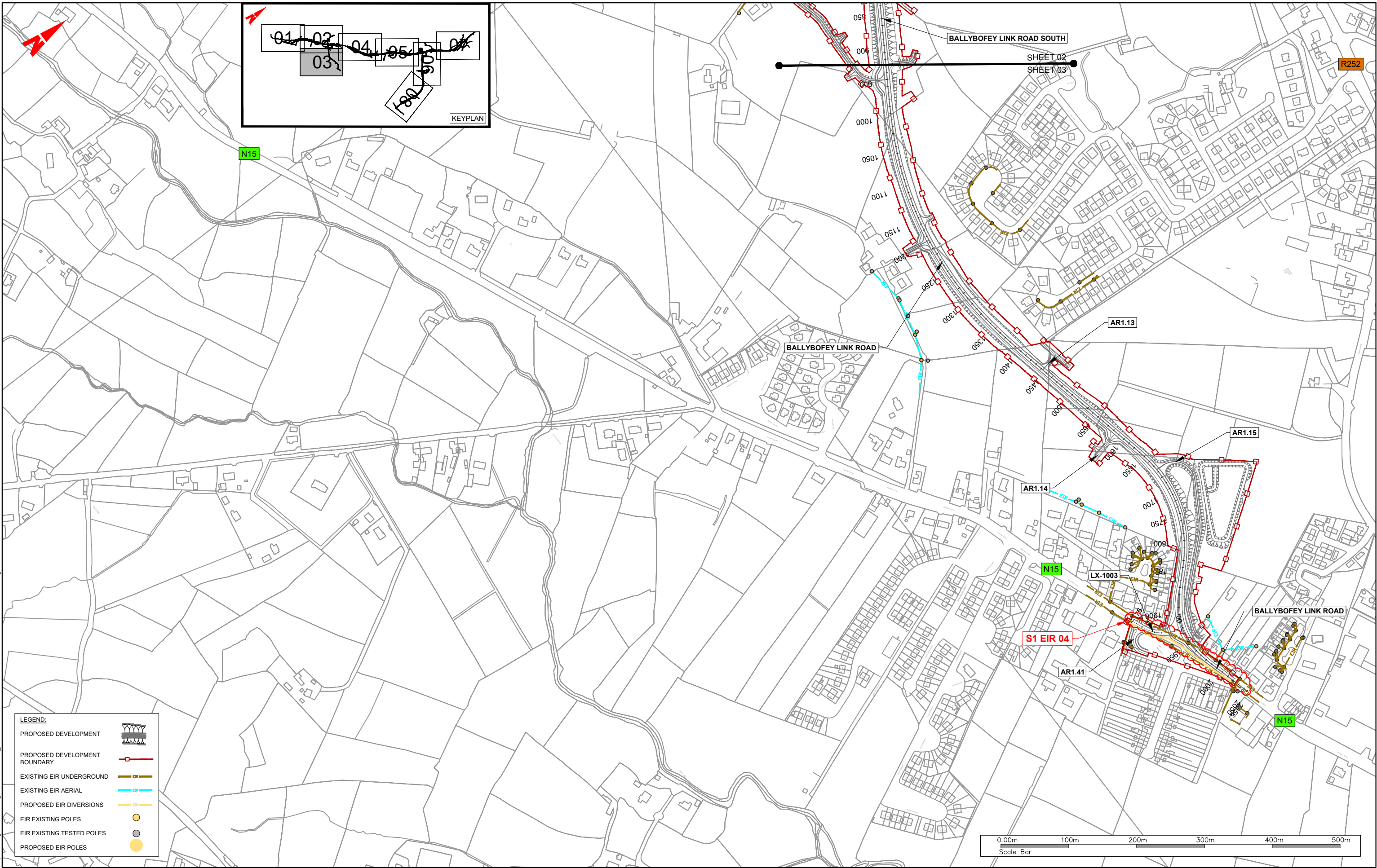

LEGEND:

PROPOSED DEVELOPMENT	
PROPOSED DEVELOPMENT BOUNDARY	
EXISTING EIR UNDERGROUND	
EXISTING EIR AERIAL	
PROPOSED EIR DIVERSIONS	
EIR EXISTING POLES	
EIR EXISTING TESTED POLES	
PROPOSED EIR POLES	

NOTES
 DO NOT SCALE, use figured dimensions only.
 All levels are referred to Ordnance Survey Datum, Main Head.
 This drawing is the property of the Donegal County Council. It is a confidential document and must not be copied, used, or its contents divulged without prior written consent. This document should not be relied on or used in circumstances other than those for which it was originally prepared. RPS / Barry Transportation accepts no responsibility for this document to any other party other than the party by whom it was commissioned.

Rev.	Date	Drawn	Description	Chk'd	Appr.
P01	04.11.25	MC	ISSUE FOR PLANNING	PS	EC

Project Title: TEN-T Priority Route Improvement Project, Donegal Section 1 - N15/N13 Ballybofey / Stranorlar Urban Region		Status: A3
Drawing Title: PROPOSED EIR DIVERSIONS		Rev: P01
Designed: SS	Date: NOV 2025	EIAR Drawing Identifier: EIAR DRAWING 16.15
Drawn: MC	Scale @ A1: 1:2500	File Identifier: TT_MGT0337-RPS-P3-S1-DR-C-UT1005
Approved: EC	@ A3: 1:5000	
Checked: PS	Sheet: 03 of 08	

T:\MGT0337 - Ten-T Priority Route Imp - Donegal\8.0 Drawings\Phase 3\UTTT_MGT0337-RPS-P3-S1-DR-C-UT1005 Proposed EIR Diversion.dwg



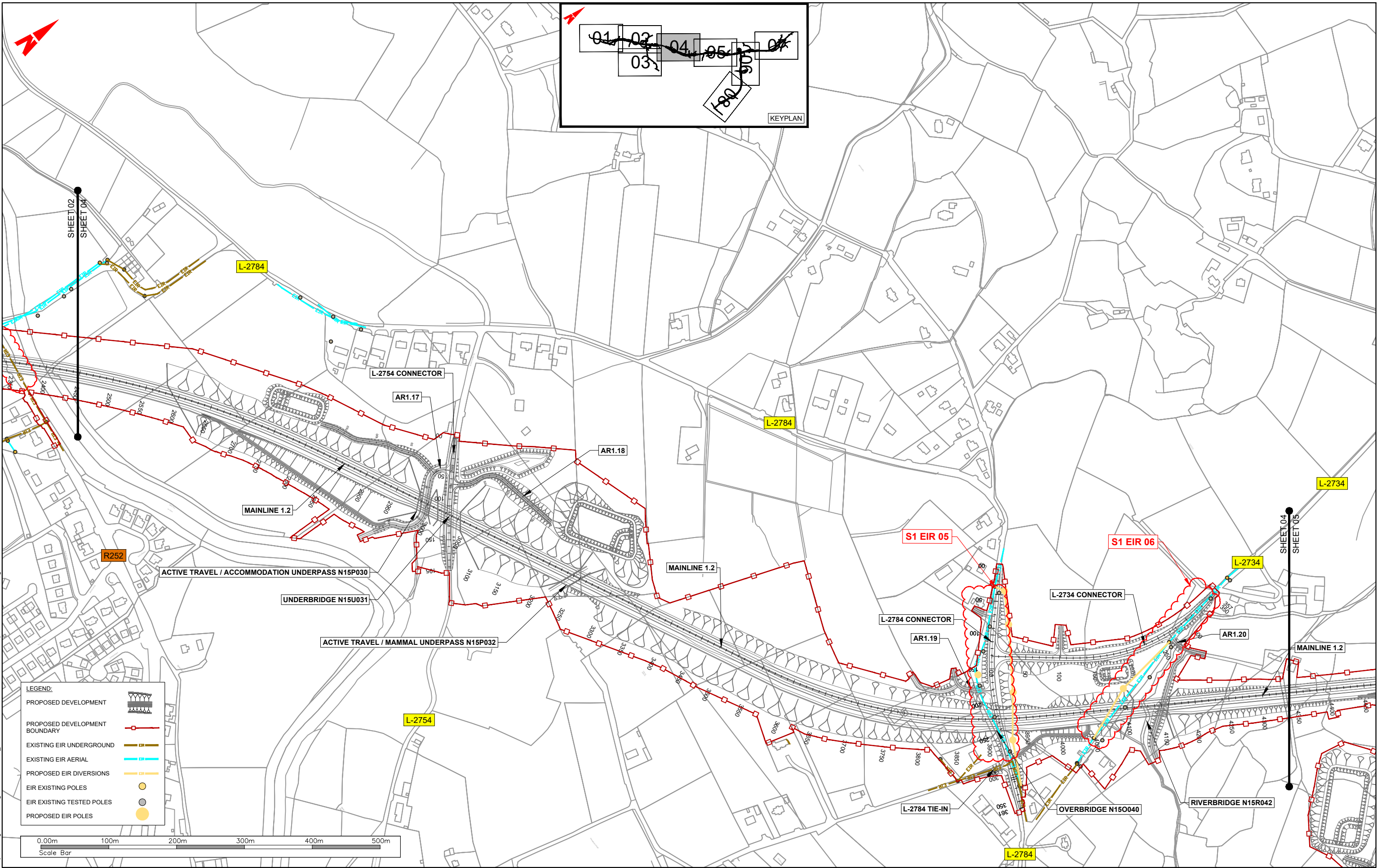

T:\MGT0337 - Ten-T Priority Route Imp - Donegal\0 Drawings\Phase 3\UTTT_MGT0337-RPS-P3-S1-DR-C-UT1005 Proposed EIR Diversion.dwg

NOTES
 DO NOT SCALE, use figured dimensions only.
 All levels are referred to Ordnance Survey Datum, Main Head.
 This drawing is the property of the Donegal County Council. It is a confidential document and must not be copied, used, or its contents divulged without prior written consent. This document should not be relied on or used in circumstances other than those for which it was originally prepared. RPS / Barry Transportation accepts no responsibility for this document to any other party other than the party by whom it was commissioned.

Rev.	Date	Drawn	Description	Chk'd	Appr.
P01	04.11.25	MC	ISSUE FOR PLANNING	PS	EC

Project Title: TEN-T Priority Route Improvement Project, Donegal Section 1 - N15/N13 Ballybofey / Stranorlar Urban Region		Status: A3
Drawing Title: PROPOSED EIR DIVERSIONS		Rev: P01
Designed: SS	Date: NOV 2025	EIAR Drawing Identifier: EIAR DRAWING 16.15
Drawn: MC	Scale @ A1: 1:2500	File Identifier: TT_MGT0337-RPS-P3-S1-DR-C-UT1005
Approved: EC	@ A3: 1:5000	
Checked: PS	Sheet: 04 of 08	

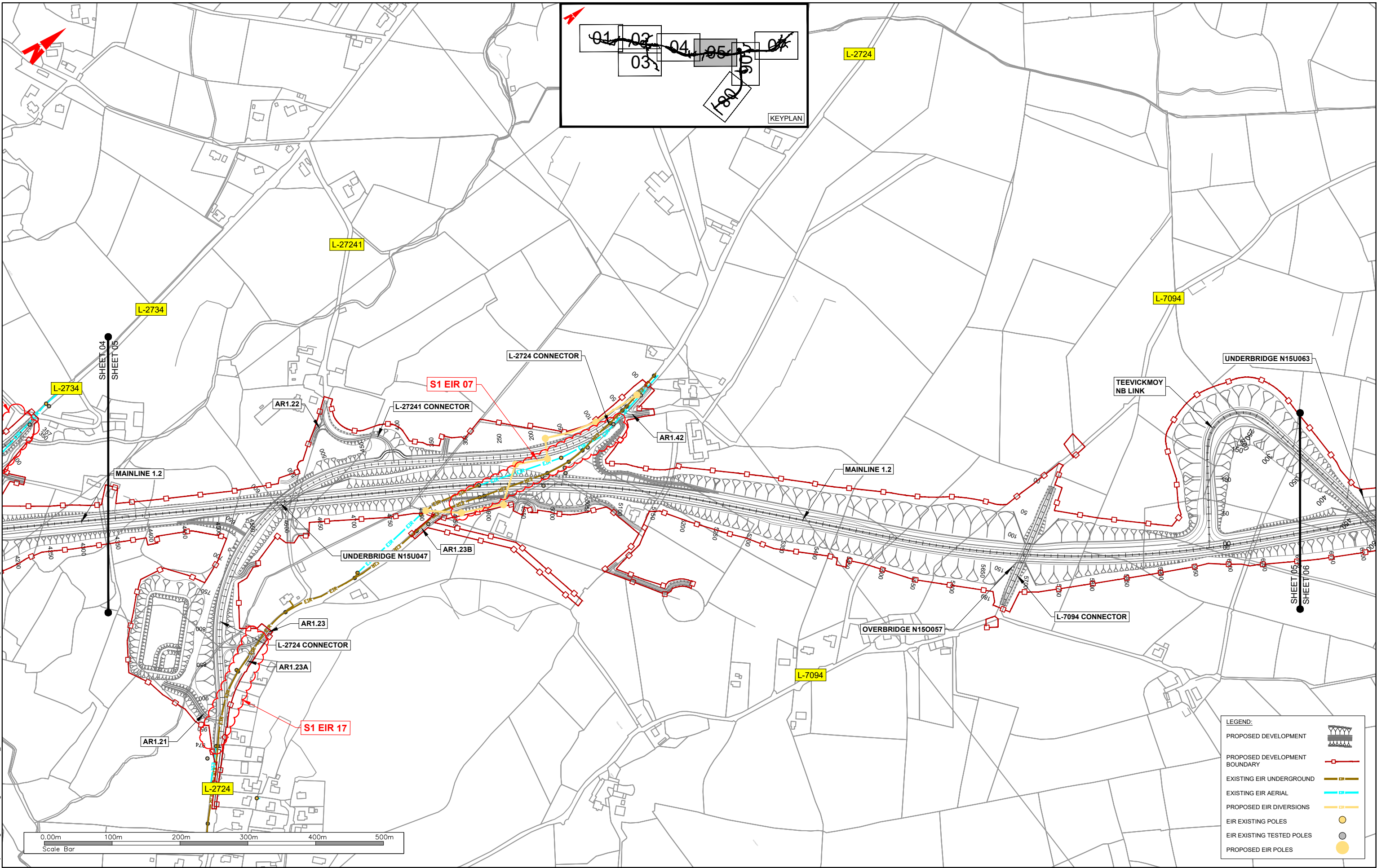

LEGEND:

PROPOSED DEVELOPMENT	
PROPOSED DEVELOPMENT BOUNDARY	
EXISTING EIR UNDERGROUND	
EXISTING EIR AERIAL	
PROPOSED EIR DIVERSIONS	
EIR EXISTING POLES	
EIR EXISTING TESTED POLES	
PROPOSED EIR POLES	

NOTES
 DO NOT SCALE, use figured dimensions only.
 All levels are referred to Ordnance Survey Datum, Main Head.
 This drawing is the property of the Donegal County Council. It is a confidential document and must not be copied, used, or its contents divulged without prior written consent. This document should not be relied on or used in circumstances other than those for which it was originally prepared. RPS / Barry Transportation accepts no responsibility for this document to any other party other than the party by whom it was commissioned.

Rev.	Date	Drawn	Description	Chk'd	Appr.
P01	04.11.25	MC	ISSUE FOR PLANNING	PS	EC

Project Title: TEN-T Priority Route Improvement Project, Donegal Section 1 - N15/N13 Ballybofey / Stranorlar Urban Region		Status: A3
Drawing Title: PROPOSED EIR DIVERSIONS		Rev: P01
Designed: SS	Date: NOV 2025	EIAR Drawing Identifier: EIAR DRAWING 16.15
Drawn: MC	Scale @ A1: 1:2500	File Identifier: TT_MGT0337-RPS-P3-S1-DR-C-UT1005
Approved: EC	@ A3: 1:5000	
Checked: PS	Sheet: 05 of 08	

T:\MGT0337 - Ten-T Priority Route Imp - Donegal\0 Drawings\Phase 3\UTTT_MGT0337-RPS-P3-S1-DR-C-UT1005 Proposed EIR Diversion.dwg



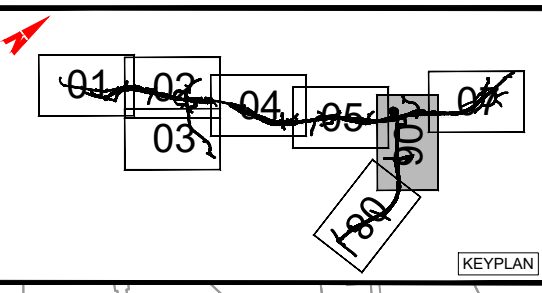
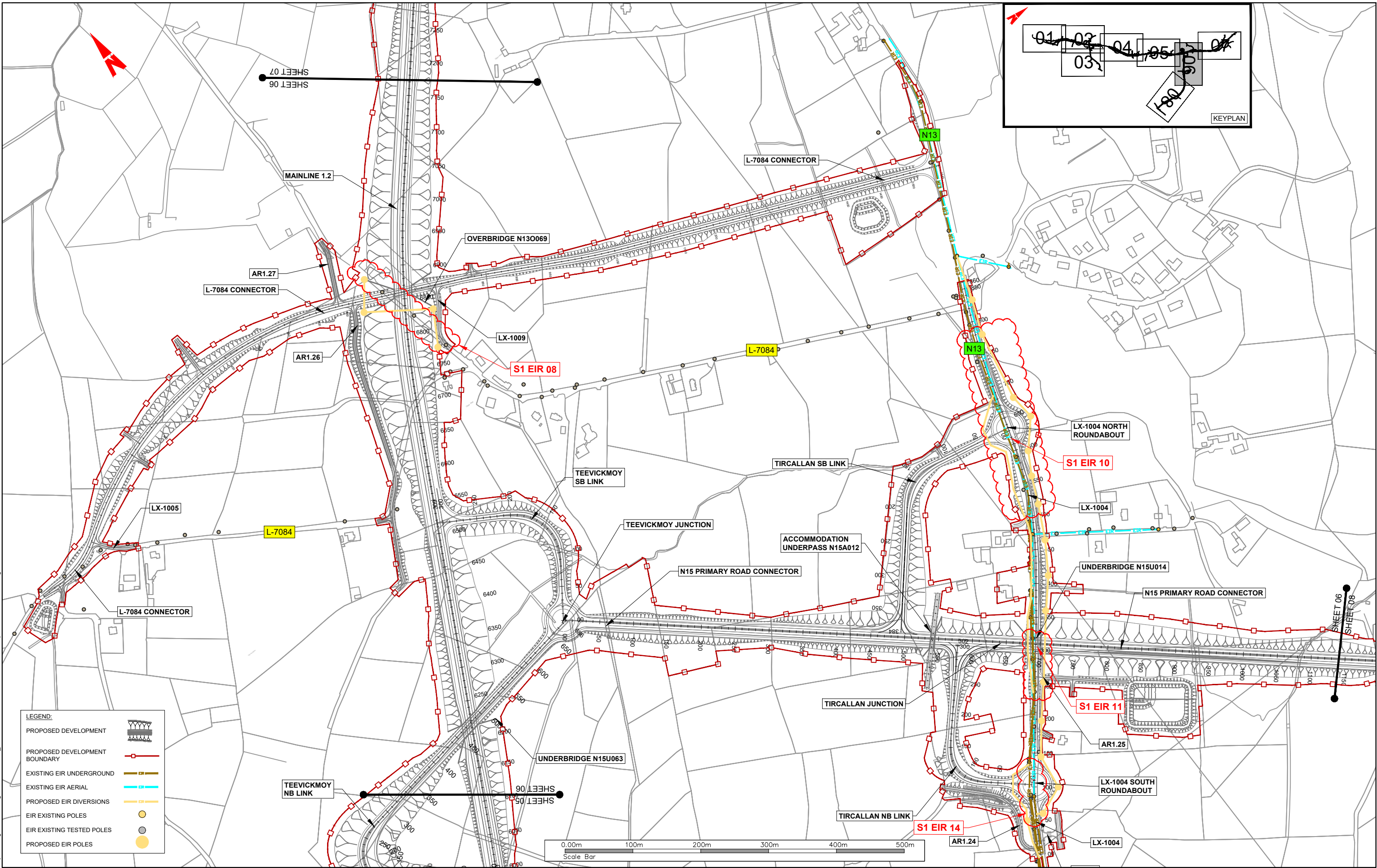

LEGEND:

PROPOSED DEVELOPMENT	
PROPOSED DEVELOPMENT BOUNDARY	
EXISTING EIR UNDERGROUND	
EXISTING EIR AERIAL	
PROPOSED EIR DIVERSIONS	
EIR EXISTING POLES	
EIR EXISTING TESTED POLES	
PROPOSED EIR POLES	



T:\MGT0337 - Ten-T Priority Route Imp - Donegal\0 Drawings\Phase 3\UTTT_MGT0337-RPS-P3-S1-DR-C-UT1005 Proposed EIR Diversion.dwg

NOTES
 DO NOT SCALE, use figured dimensions only.
 All levels are referred to Ordnance Survey Datum, Main Head.
 This drawing is the property of the Donegal County Council. It is a confidential document and must not be copied, used, or its contents divulged without prior written consent. This document should not be relied on or used in circumstances other than those for which it was originally prepared. RPS / Barry Transportation accepts no responsibility for this document to any other party other than the party by whom it was commissioned.

Rev.	Date	Drawn	Description	Chk'd	Appr.
P01	04.11.25	MC	ISSUE FOR PLANNING	PS	EC

Project Title: TEN-T Priority Route Improvement Project, Donegal Section 1 - N15/N13 Ballybofey / Stranorlar Urban Region		Status: A3
Drawing Title: PROPOSED EIR DIVERSIONS		Rev: P01
Designed: SS	Date: NOV 2025	EIAR Drawing Identifier: EIAR DRAWING 16.15
Drawn: MC	Scale @ A1: 1:2500	File Identifier: TT_MGT0337-RPS-P3-S1-DR-C-UT1005
Approved: EC	@ A3: 1:5000	
Checked: PS	Sheet: 06 of 08	

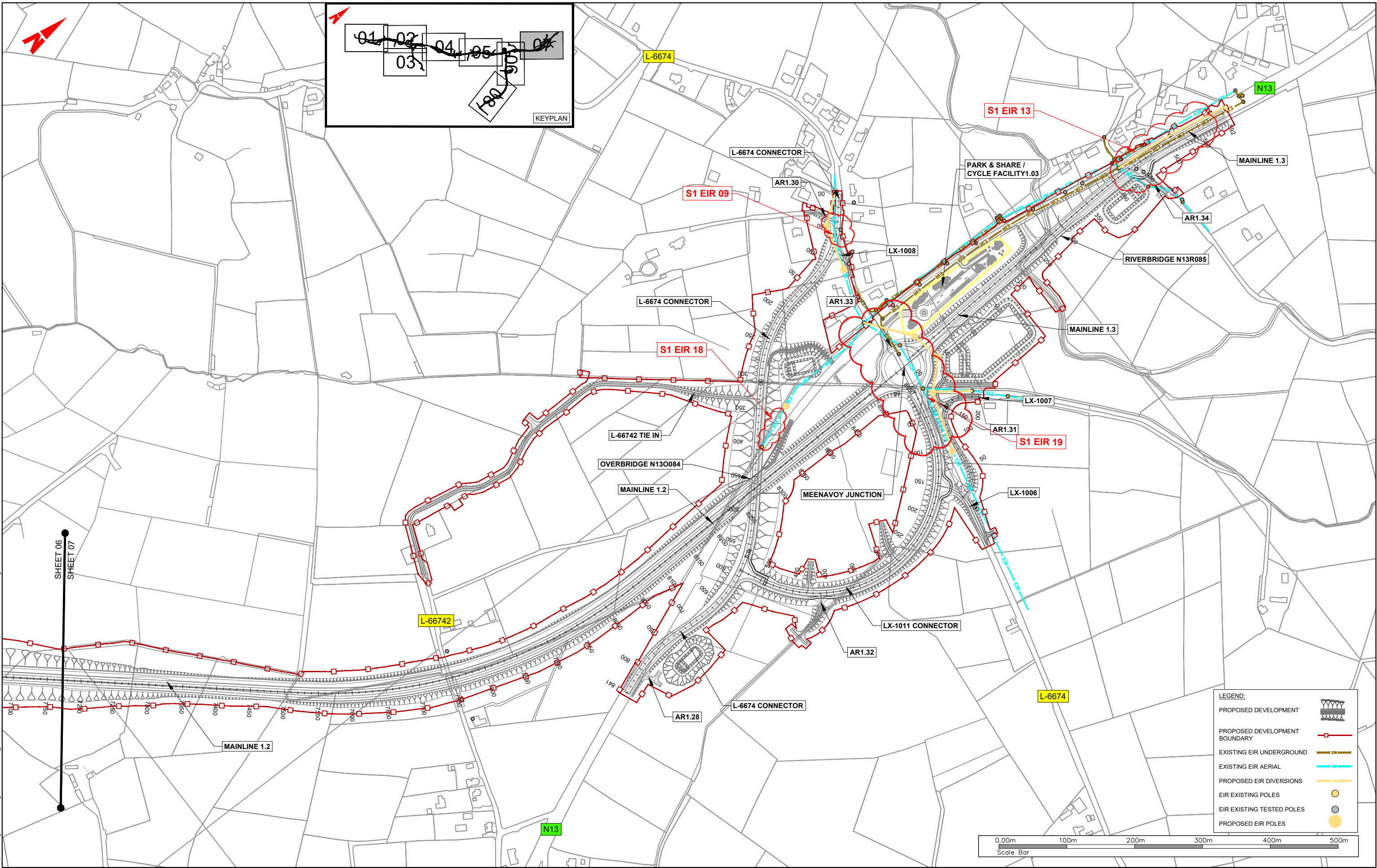

LEGEND:

- PROPOSED DEVELOPMENT
- PROPOSED DEVELOPMENT BOUNDARY
- EXISTING EIR UNDERGROUND
- EXISTING EIR AERIAL
- PROPOSED EIR DIVERSIONS
- EIR EXISTING POLES
- EIR EXISTING TESTED POLES
- PROPOSED EIR POLES

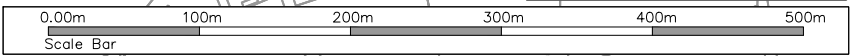

T:\MGT0337 - Ten-T Priority Route Imp - Donegal\18.0 Drawings\Phase 3\UTTT_MGT0337-RPS-P3-S1-DR-C-UT1005 Proposed EIR Diversion.dwg

SHEET 06
SHEET 07

NOTES
DO NOT SCALE, use figured dimensions only.
All levels are referred to Ordnance Survey Datum, Main Head.
This drawing is the property of the Donegal County Council. It is a confidential document and must not be copied, used, or its contents divulged without prior written consent. This document should not be relied on or used in circumstances other than those for which it was originally prepared. RPS / Barry Transportation accepts no responsibility for this document to any other party other than the party by whom it was commissioned.

Rev.	Date	Drawn	Description	Chk'd	Appr.
P01	04.11.25	MC	ISSUE FOR PLANNING	PS	EC

Project Title: TEN-T Priority Route Improvement Project, Donegal Section 1 - N15/N13 Ballybofey / Stranorlar Urban Region		Status: A3
Drawing Title: PROPOSED EIR DIVERSIONS		Rev: P01
Designed: SS	Date: NOV 2025	EIAR Drawing Identifier: EIAR DRAWING 16.15
Drawn: MC	Scale @ A1: 1:2500	File Identifier: TT_MGT0337-RPS-P3-S1-DR-C-UT1005
Approved: EC	@ A3: 1:5000	
Checked: PS	Sheet: 07 of 08	

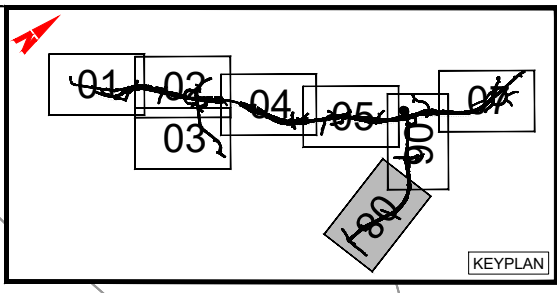
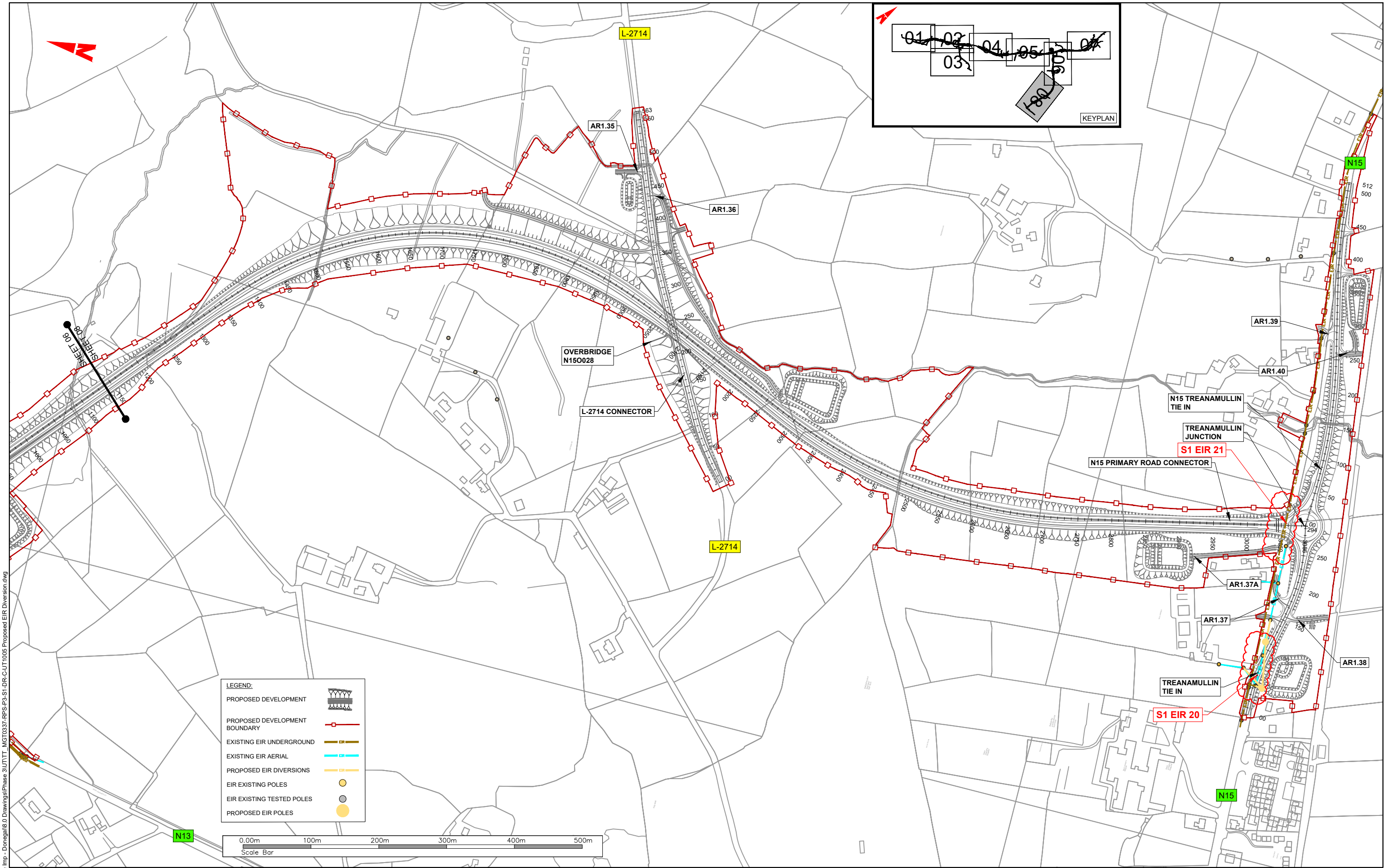

- LEGEND:**
- PROPOSED DEVELOPMENT
 - PROPOSED DEVELOPMENT BOUNDARY
 - EXISTING EIR UNDERGROUND
 - EXISTING EIR AERIAL
 - PROPOSED EIR DIVERSIONS
 - EIR EXISTING POLES
 - EIR EXISTING TESTED POLES
 - PROPOSED EIR POLES

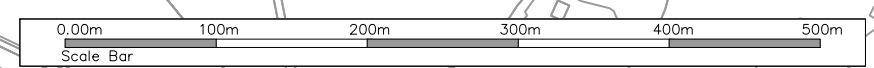

T:\MGT0337 - Ten-T Priority Route Imp - Donegal\8.0 Drawings\Phase 3\UTTT_MGT0337-RPS-P3-S1-DR-C-UT1005 Proposed EIR Diversion.dwg



NOTES
 DO NOT SCALE, use figured dimensions only.
 All levels are referred to Ordnance Survey Datum, Mean Head.
 This drawing is the property of the Donegal County Council. It is a confidential document and must not be copied, used, or its contents divulged without prior written consent. This document should not be relied on or used in circumstances other than those for which it was originally prepared. RPS / Barry Transportation accepts no responsibility for this document to any other party other than the party by whom it was commissioned.

Rev.	Date	Drawn	Description	Chk'd	Appr.
P01	04.11.25	MC	ISSUE FOR PLANNING	PS	EC

Project Title: TEN-T Priority Route Improvement Project, Donegal Section 1 - N15/N13 Ballybofey / Stranorlar Urban Region		Status: A3
Drawing Title: PROPOSED EIR DIVERSIONS		Rev: P01
Designed: SS	Date: NOV 2025	EIAR Drawing Identifier: EIAR DRAWING 16.15
Drawn: MC	Scale @ A1: 1:2500	File Identifier: TT_MGT0337-RPS-P3-S1-DR-C-UT1005
Approved: EC	@ A3: 1:5000	
Checked: PS	Sheet: 08 of 08	