

**LEGEND:**

- 500m BUFFER
- PROPERTY REFERENCE (XX)
- PRE-ESTABLISHMENT IMPACT (Yellow box)
- POST-ESTABLISHMENT IMPACT (Cyan box)
- ACTIVE TRAVEL NETWORK (Orange line)
- PROPOSED DEVELOPMENT BOUNDARY (Red line)
- STRUCTURE (Pink symbol)
- DRAINAGE POND (Blue symbol)
- PARK AND SHARE / CYCLE SITE (Green symbol)
- CONSTRUCTION COMPOUND (Blue symbol)
- FLOOD COMPENSATION AREA (Green symbol)
- INPERCEPTIBLE TO NOT SIGNIFICANT (Yellow box)
- NOT SIGNIFICANT TO SLIGHT (Cyan box)
- SLIGHT TO MODERATE (Blue box)
- MODERATE TO SIGNIFICANT (Dark Blue box)
- VERY SIGNIFICANT TO PROFOUND (Red box)
- PROPERTY LOCATION (Green dot)
- PROPOSED ROAD DEVELOPMENT (Grey line)

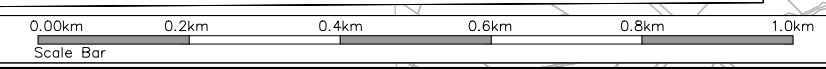

T:\MGT0337 - Ten-T Priority Route Imp - Donegal\8.0 Drawings\Phase 2\EMEAR Drawings\18.0 Landscape and Visual\TT\_MGT0337-RPS-P3-S2-DR-Z-EN-1205 Residential Visual Impact Assessment Section 2.dwg

**NOTES**  
 DO NOT SCALE, use figured dimensions only.  
 All levels are referred to Ordnance Survey Datum, Mean Head.  
 This drawing is the property of the Donegal County Council. It is a confidential document and must not be copied, used, or its contents divulged without prior written consent. This document should not be relied on or used in circumstances other than those for which it was originally prepared. RPS / Barry Transportation accepts no responsibility for this document to any other party other than the party by whom it was commissioned.

Rev.	Date	Drawn	Description	Chk'd	Appr.
P01	10.11.25	CD	ISSUE FOR PLANNING	SA	GMCE

Project Title: TEN-T Priority Route Improvement Project, Donegal Section 2 - N56/N13 Letterkenny to Manorcunningham

Drawing Title: Residential Visual Impact Assessment Section 2

Status: A3

Designed: CM Date: NOV 2025 EIA Drawing Identifier: EIA DRAWING 18.14

Drawn: CD Scale @ A1: 1:2500 @ A3: 1:5000 File Identifier: TT\_MGT0337-RPS-P3-S2-DR-Z-EN-1205

Approved: GMCE

Checked: SA Sheet: 01 of 03

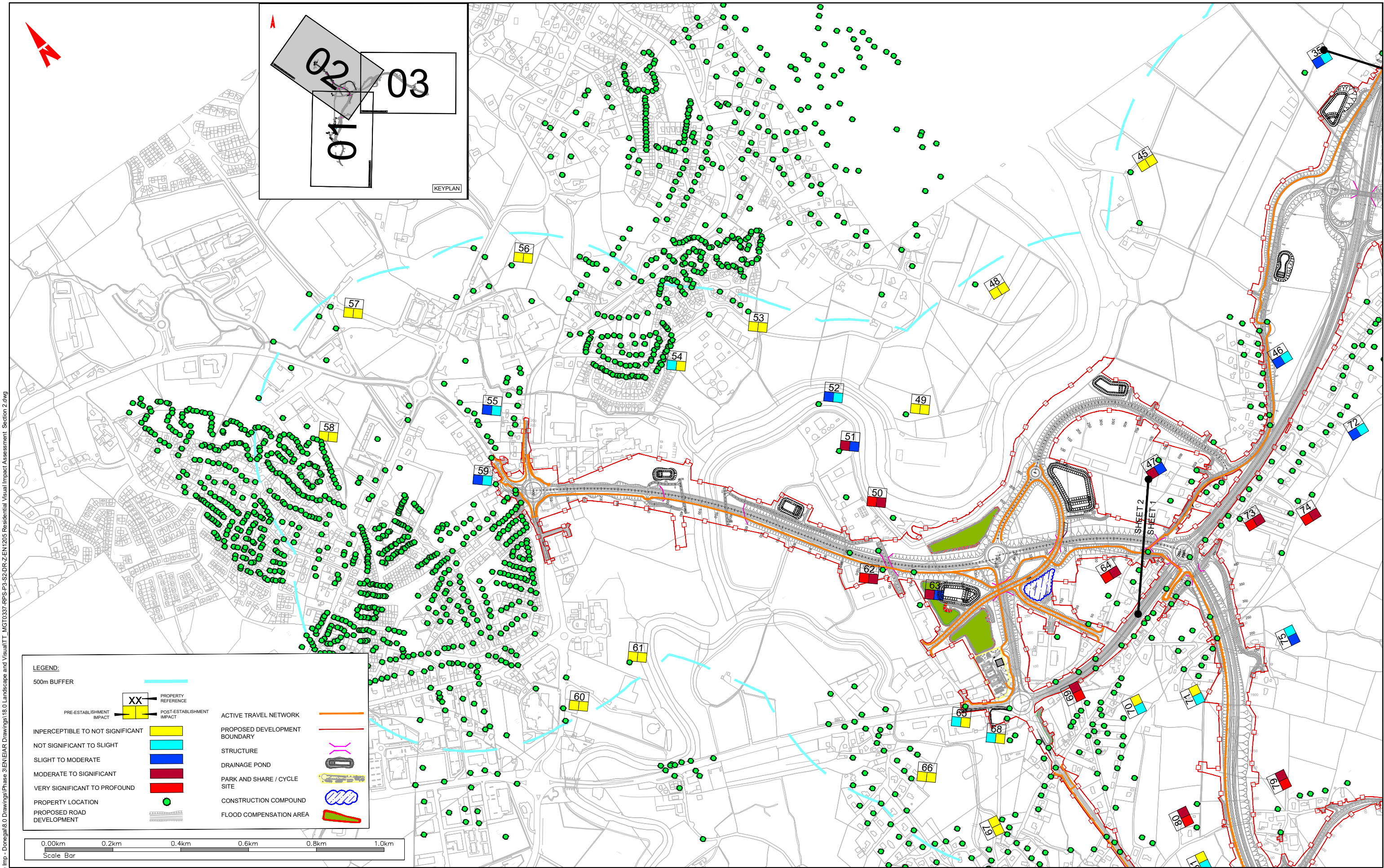

**LEGEND:**

500m BUFFER

PROPERTY REFERENCE

PRE-ESTABLISHMENT IMPACT

POST-ESTABLISHMENT IMPACT

ACTIVE TRAVEL NETWORK

PROPOSED DEVELOPMENT BOUNDARY

STRUCTURE

DRAINAGE POND

PARK AND SHARE / CYCLE SITE

CONSTRUCTION COMPOUND

FLOOD COMPENSATION AREA

PROPERTY LOCATION

PROPOSED ROAD DEVELOPMENT

0.00km 0.2km 0.4km 0.6km 0.8km 1.0km

Scale Bar

T:\MGT0337 - Ten-T Priority Route Imp - Donegal\8.0 Drawings\Phase 2\EMIA\Drawings\18.0 Landscape and Visual\TT\_MGT0337-RPS-P3-S2-DR-Z-EN-1205 Residential Visual Impact Assessment Section 2.dwg

**NOTES**

DO NOT SCALE, use figured dimensions only.

All levels are referred to Ordnance Survey Datum, Mean Head.

This drawing is the property of the Donegal County Council. It is a confidential document and must not be copied, used, or its contents divulged without prior written consent. This document should not be relied on or used in circumstances other than those for which it was originally prepared. RPS / Barry Transportation accepts no responsibility for this document to any other party other than the party by whom it was commissioned.

Rev.	Date	Drawn	Description	Chk'd	Appr.
P01	10.11.25	CD	ISSUE FOR PLANNING	SA	GMCE

Project Title: TEN-T Priority Route Improvement Project, Donegal Section 2 - N56/N13 Letterkenny to Manorcunningham		Status: A3
Drawing Title: Residential Visual Impact Assessment Section 2		Rev: P01
Designed: CM	Date: NOV 2025	EIAR Drawing Identifier: EIAR DRAWING 18.14
Drawn: CD	Scale @ A1: 1:2500	File Identifier: TT_MGT0337-RPS-P3-S2-DR-Z-EN-1205
Approved: GMCE	@ A3: 1:5000	
Checked: SA	Sheet: 02 of 03	

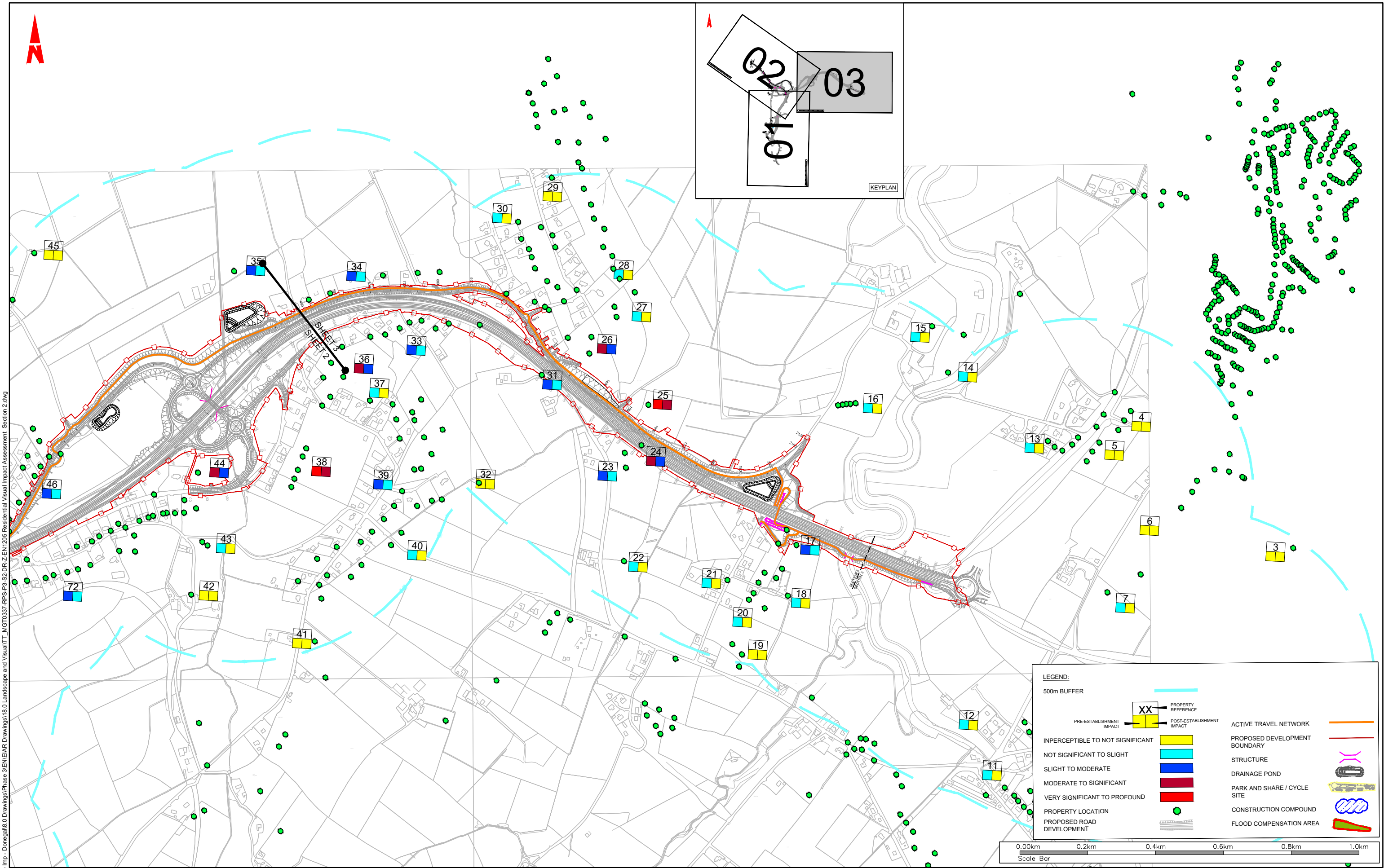
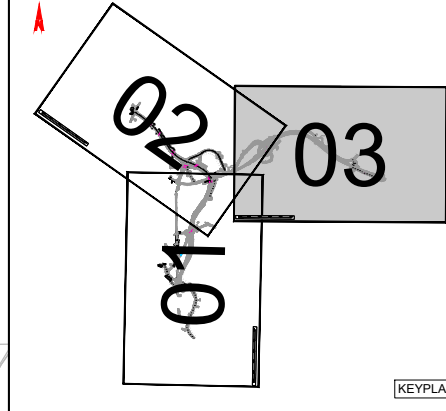

**LEGEND:**

- 500m BUFFER
- PROPERTY REFERENCE (XX)
- PRE-ESTABLISHMENT IMPACT (Yellow square)
- POST-ESTABLISHMENT IMPACT (Cyan square)
- ACTIVE TRAVEL NETWORK (Orange line)
- PROPOSED DEVELOPMENT BOUNDARY (Red line)
- STRUCTURE (Pink dashed line)
- DRAINAGE POND (Black oval)
- PARK AND SHARE / CYCLE SITE (Yellow dashed line)
- CONSTRUCTION COMPOUND (Blue wavy line)
- FLOOD COMPENSATION AREA (Green triangle)
- INPERCEPTIBLE TO NOT SIGNIFICANT (Yellow square)
- NOT SIGNIFICANT TO SLIGHT (Cyan square)
- SLIGHT TO MODERATE (Blue square)
- MODERATE TO SIGNIFICANT (Red square)
- VERY SIGNIFICANT TO PROFOUND (Red square)
- PROPERTY LOCATION (Green dot)
- PROPOSED ROAD DEVELOPMENT (Grey line)

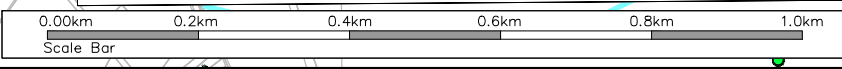

T:\MGT0337 - Ten-T Priority Route Imp - Donegal\8.0 Drawings\Phase 2\EMIA\Drawings\18.0 Landscape and Visual\TT\_MGT0337-RPS-P3-S2-DR-Z-EN-1205 Residential Visual Impact Assessment Section 2.dwg

**NOTES**  
 DO NOT SCALE, use figured dimensions only.  
 All levels are referred to Ordnance Survey Datum, Mean Head.  
 This drawing is the property of the Donegal County Council. It is a confidential document and must not be copied, used, or its contents divulged without prior written consent. This document should not be relied on or used in circumstances other than those for which it was originally prepared. RPS / Barry Transportation accepts no responsibility for this document to any other party other than the party by whom it was commissioned.

Rev.	Date	Drawn	Description	Chk'd	Appr.
P01	10.11.25	CD	ISSUE FOR PLANNING	SA	GMCE

Project Title: TEN-T Priority Route Improvement Project, Donegal Section 2 - N56/N13 Letterkenny to Manorcunningham		Status: A3
Drawing Title: Residential Visual Impact Assessment Section 2		Rev: P01
Designed: CM	Date: NOV 2025	EIAR Drawing Identifier: EIAR DRAWING 18.14
Drawn: CD	Scale @ A1: 1:2500	File Identifier: TT_MGT0337-RPS-P3-S2-DR-Z-EN-1205
Approved: GMCE	@ A3: 1:5000	
Checked: SA	Sheet: 03 of 03	