

PLAN SCALE 1:2500 @ A1; 1:5000 @ A3

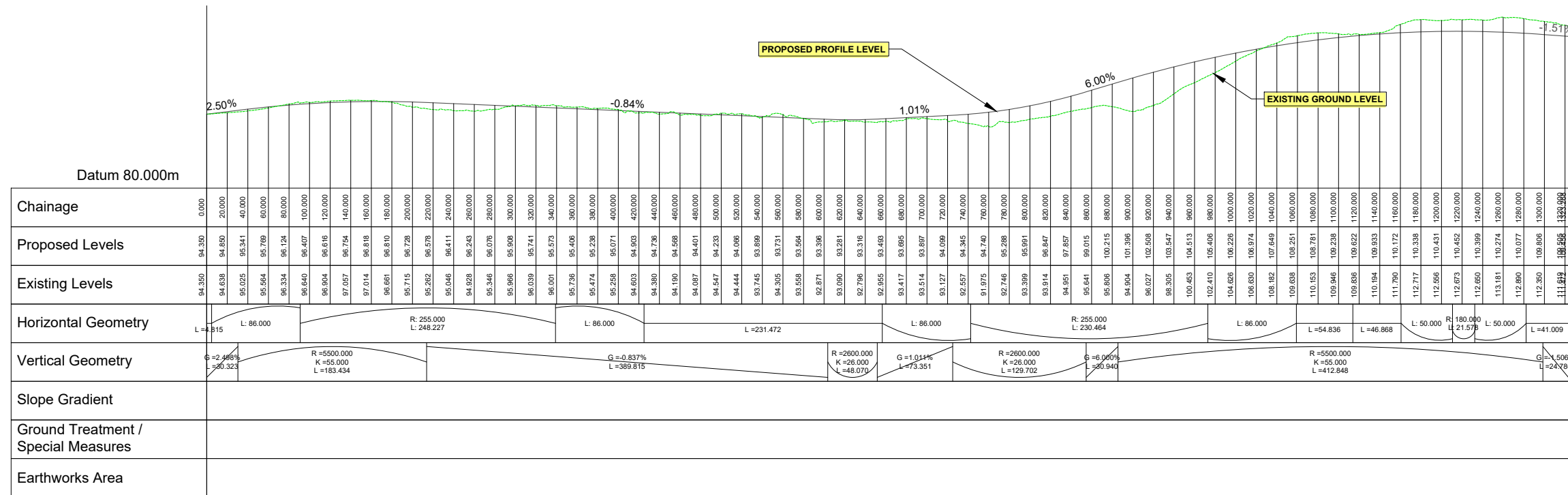

SR_PN13 - 0+250
SCALE: H 1:2500, V 1:500. **L-1064 CONNECTOR**

| Datum 90.000m | |
|-------------------------------------|----------|
| Chainage | 0.000 |
| Proposed Levels | 109.511 |
| Existing Levels | 109.938 |
| Horizontal Geometry | L=73.037 |
| Vertical Geometry | |
| Slope Gradient | |
| Ground Treatment / Special Measures | |
| Earthworks Area | |

SR_PN13 - 0+250_0+930
SCALE: H 1:2500, V 1:500. **L-5794 TIE-IN**

PROFILE VERTICAL SCALE 1:500 @ A1; 1:1000 @ A3
HORIZONTAL SCALE 1:2500 @ A1; 1:5000 @ A3

NOTES
DO NOT SCALE, use figured dimensions only.
All levels are referred to Ordnance Survey Datum, Mean Head.
This drawing is the property of the Donegal County Council. It is a confidential document and must not be copied, used, or its contents divulged without prior written consent. This document should not be relied on or used in circumstances other than those for which it was originally prepared. RPS / Barry Transportation accepts no responsibility for this document to any other party other than the party by whom it was commissioned.

| Rev. | Date | Drawn | Description | Chk'd | Appr. |
|------|----------|-------|--------------------|-------|-------|
| P01 | 04.11.25 | CS | ISSUE FOR PLANNING | RC | EC |

Project Title: TEN-T Priority Route Improvement Project, Donegal Section 2 - N56/N13 Letterkenny to Manorcunningham

Drawing Title: PROPOSED ROAD DEVELOPMENT SIDE ROAD PLAN & PROFILES

Designed: PS
Drawn: MC
Approved: EC
Checked: RC

Date: NOV 2025
Scale @ A1: As Shown
@ A3: As Shown
Sheet: 01 of 10

EIAR Drawing Identifier: EIAR DRAWING 4.8
File Identifier: TT_MGT0337-RPS-P3-S2-DR-C-SR0001

Status: A3
Rev: P01

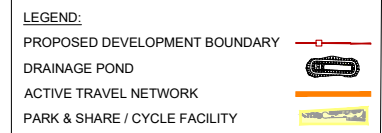
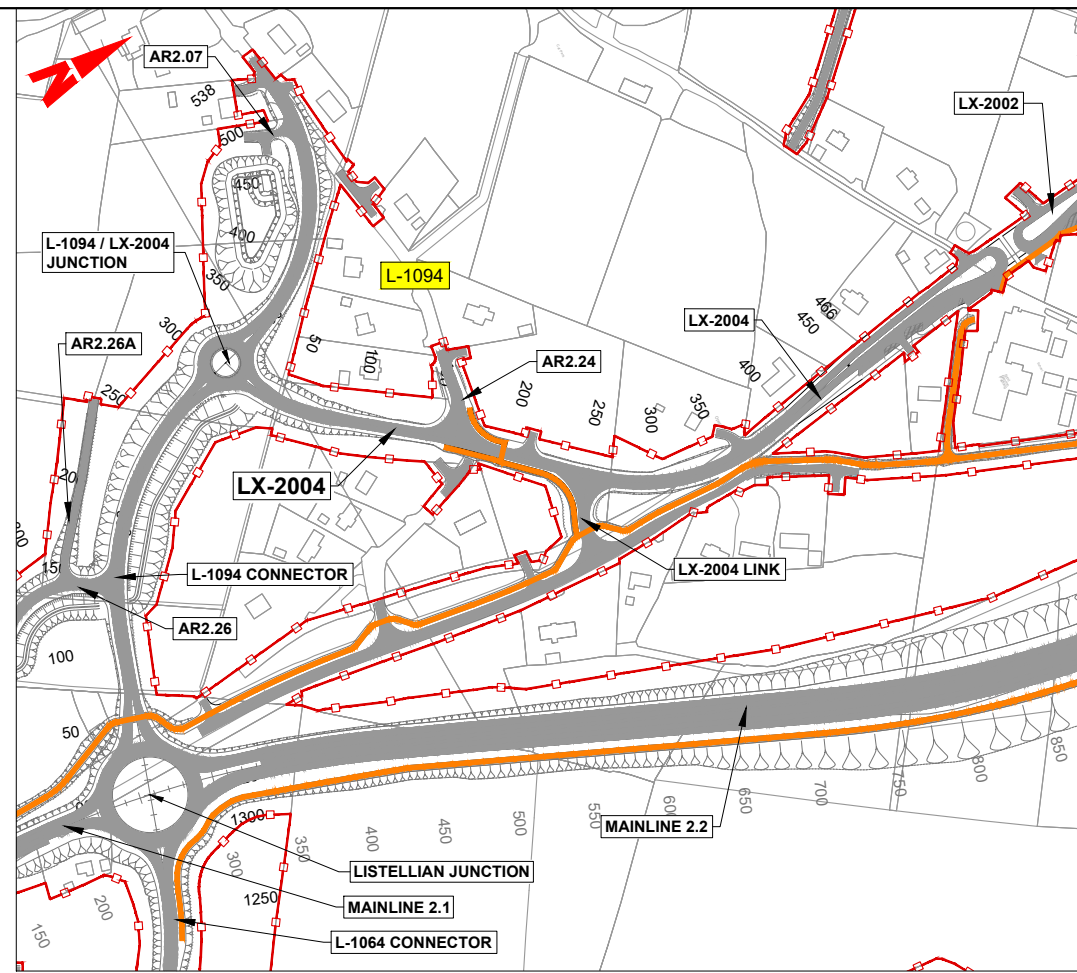
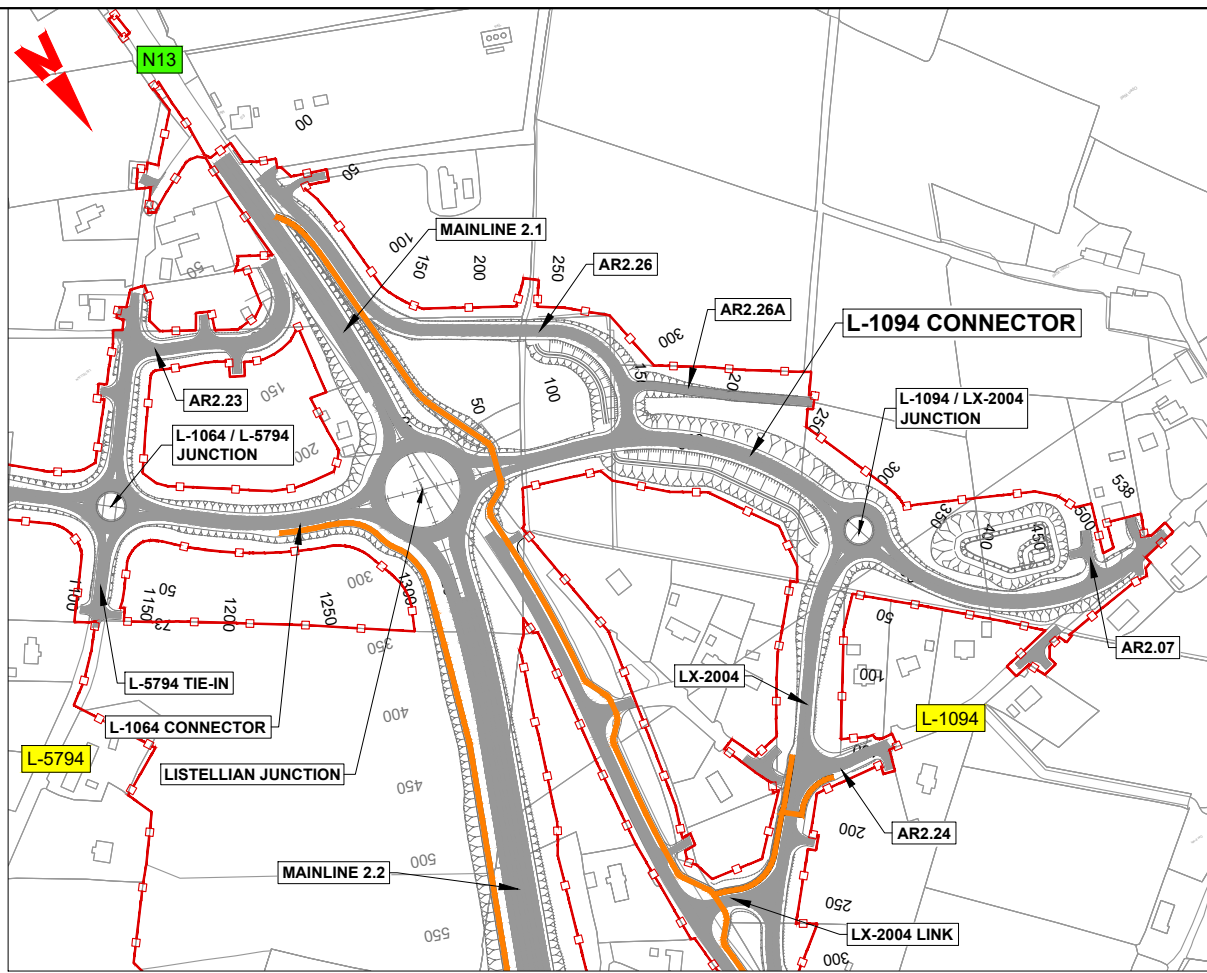

PLANS SCALE 1:2500 @ A1; 1:5000 @ A3

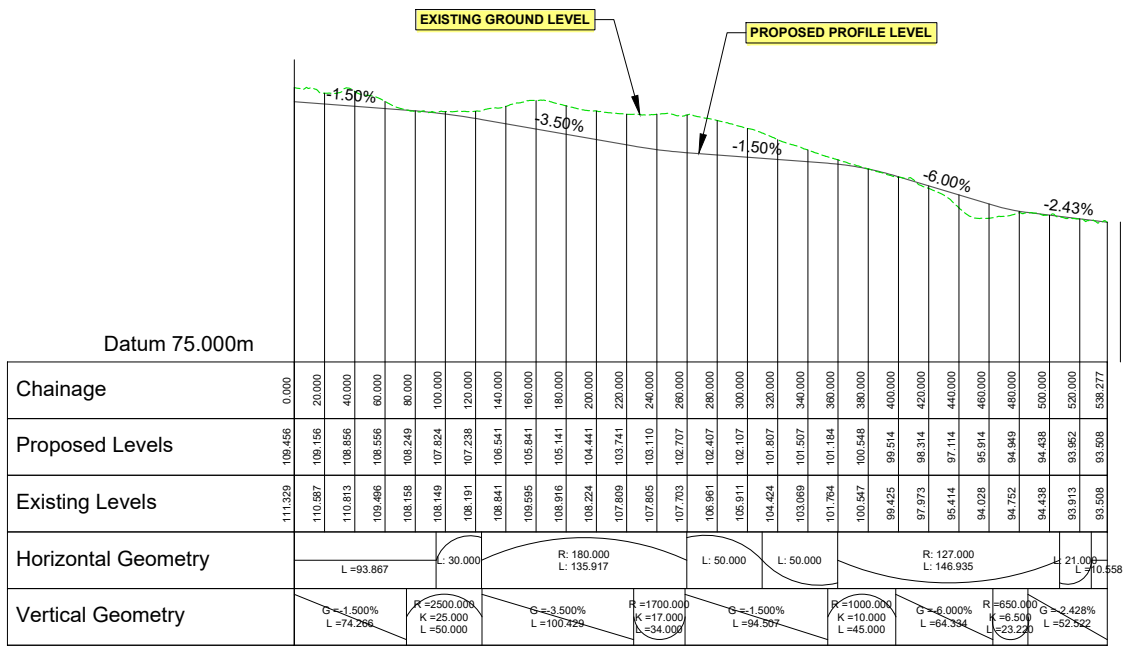

L-1094 CONNECTOR

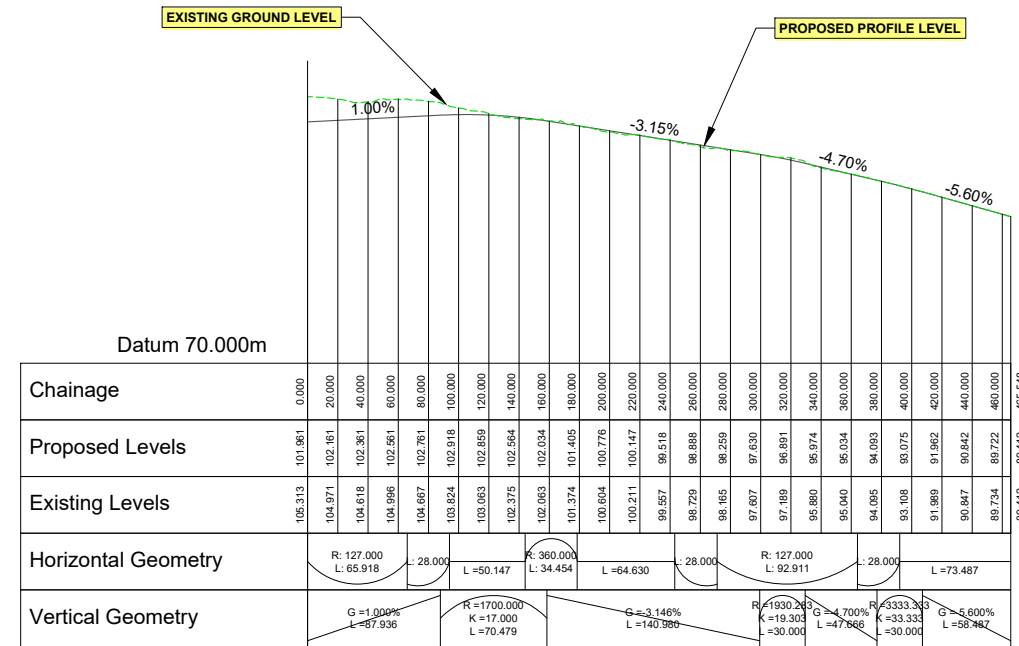

LX-2004

PROFILE VERTICAL SCALE 1:500 @ A1; 1:1000 @ A3
 HORIZONTAL SCALE 1:2500 @ A1; 1:5000 @ A3



NOTES
 DO NOT SCALE, use figured dimensions only.
 All levels are referred to Ordnance Survey Datum, Mean Head.
 This drawing is the property of the Donegal County Council. It is a confidential document and must not be copied, used, or its contents divulged without prior written consent. This document should not be relied on or used in circumstances other than those for which it was originally prepared. RPS / Barry Transportation accepts no responsibility for this document to any other party other than the party by whom it was commissioned.

| Rev. | Date | Drawn | Description | Chk'd | Appr. |
|------|----------|-------|--------------------|-------|-------|
| P01 | 04.11.25 | CS | ISSUE FOR PLANNING | RC | EC |

| | | |
|---------------------------------------------------------------------------------------------------------------------|----------------------|---------------------------------------------------|
| Project Title: TEN-T Priority Route Improvement Project, Donegal Section 2 - N56/N13 Letterkenny to Manorcunningham | | Status: A3 |
| Drawing Title: PROPOSED ROAD DEVELOPMENT SIDE ROAD PLAN & PROFILES | | Rev: P01 |
| Designed: PS | Date: NOV 2025 | EIAR Drawing Identifier: EIAR DRAWING 4.8 |
| Drawn: MC | Scale @ A1: As Shown | File Identifier: TT_MGT0337-RPS-P3-S2-DR-C-SR0001 |
| Approved: EC | @ A3: As Shown | Sheet: 02 of 10 |
| Checked: RC | | |

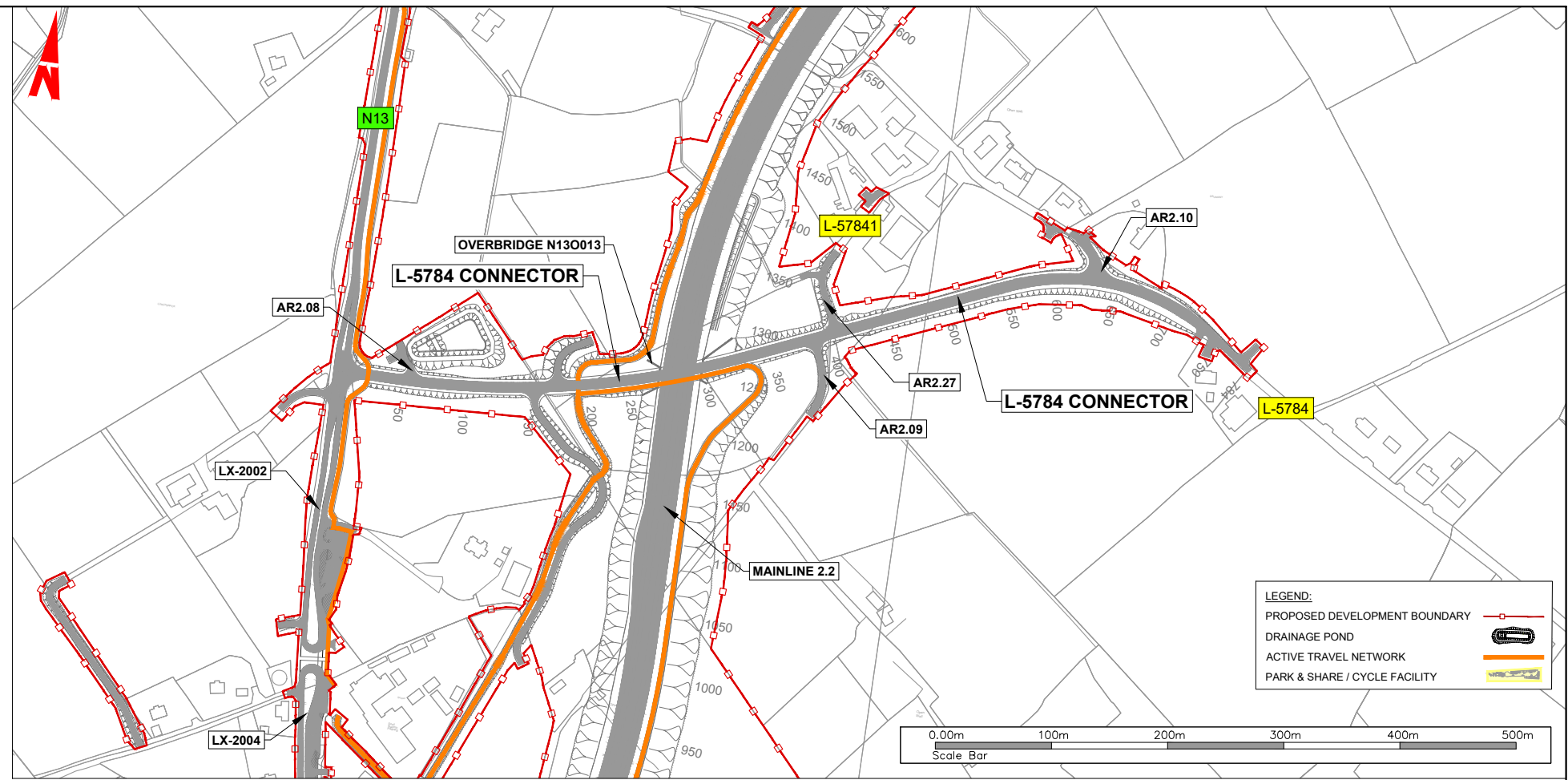
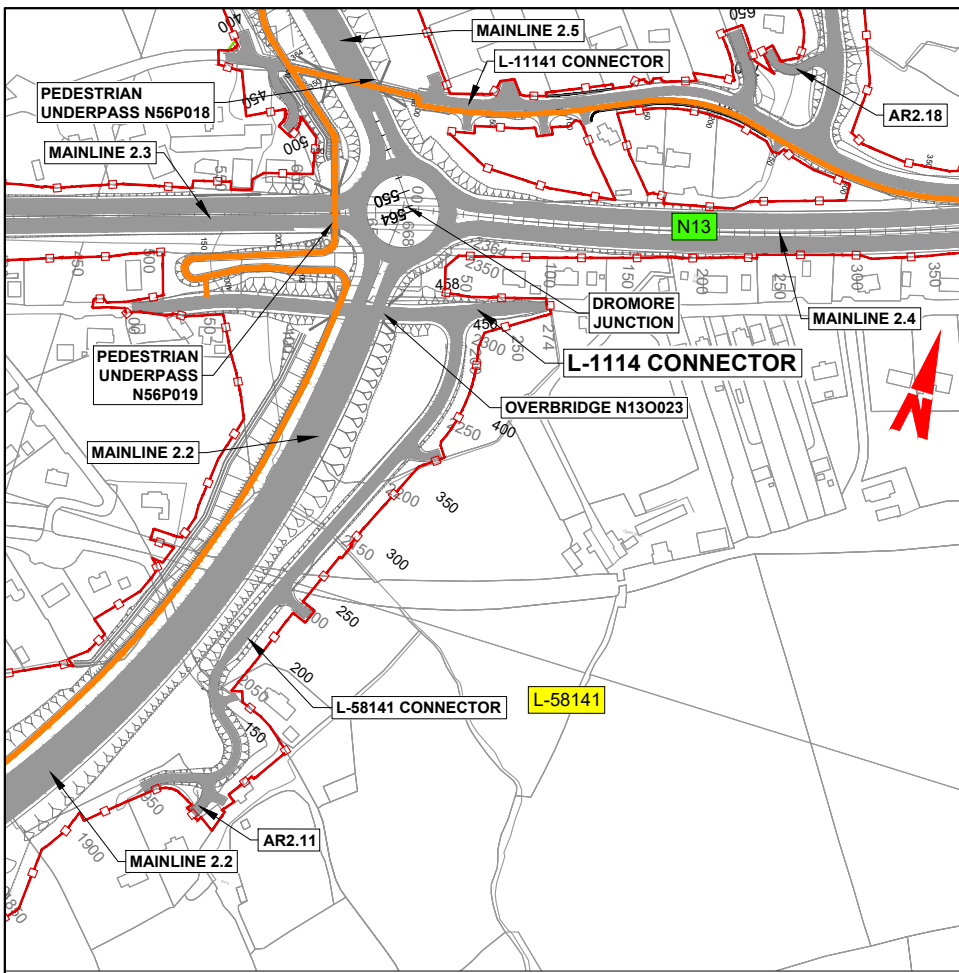

PLANS SCALE 1:2500 @ A1; 1:5000 @ A3

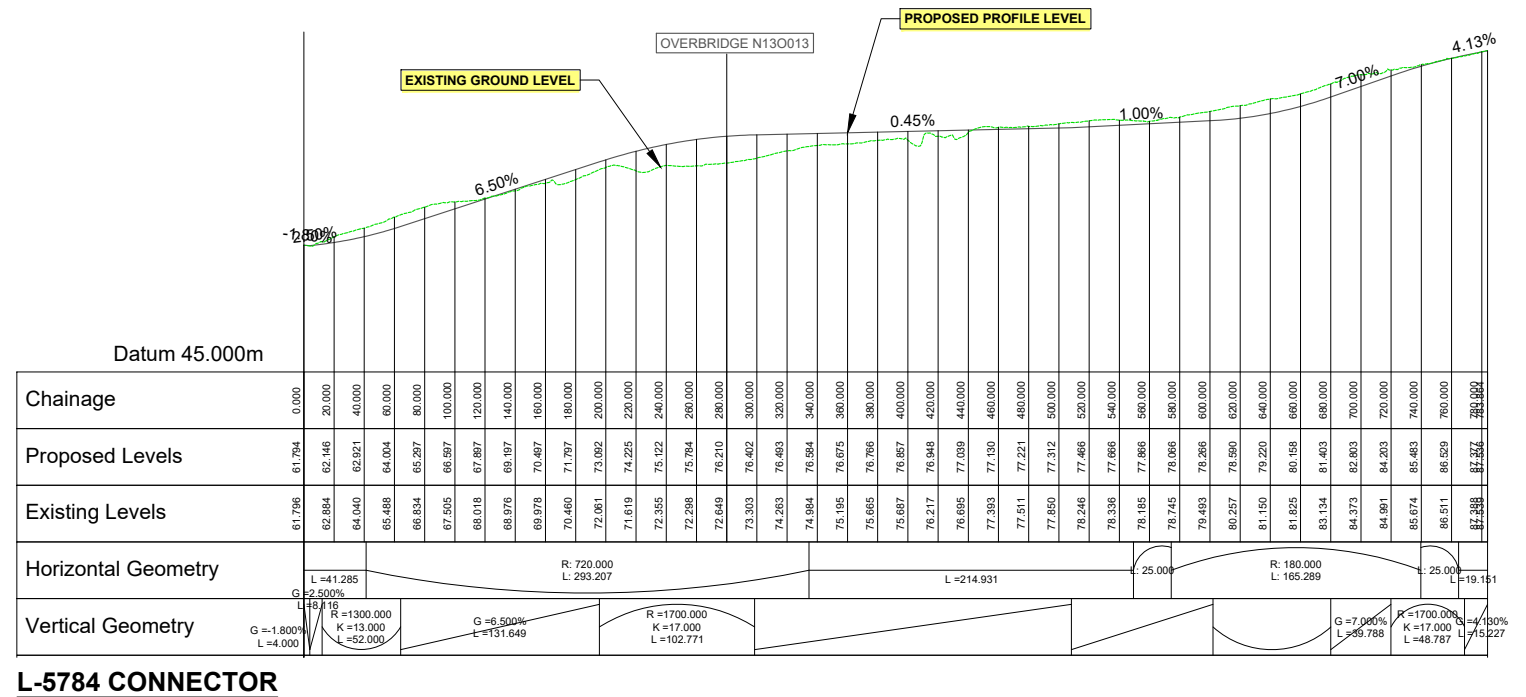
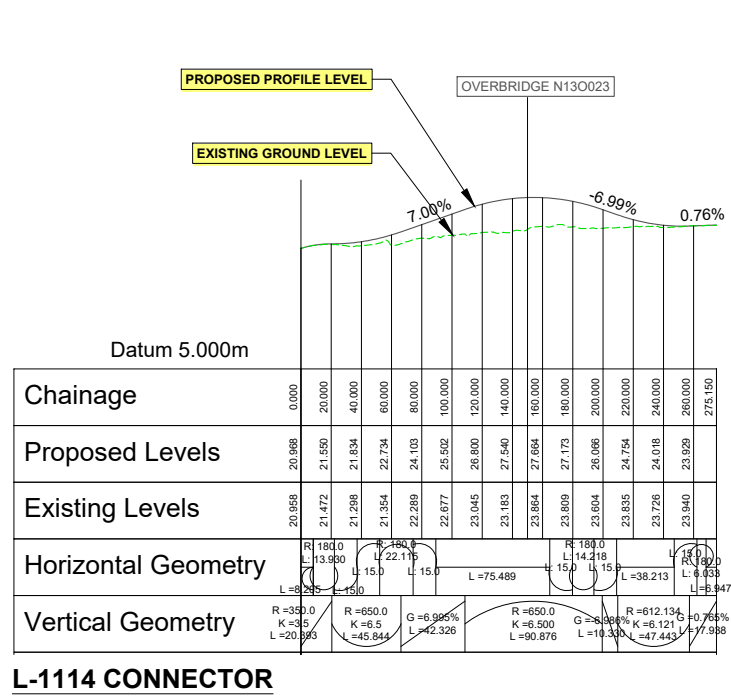

PROFILE VERTICAL SCALE 1:500 @ A1; 1:1000 @ A3
HORIZONTAL SCALE 1:2500 @ A1; 1:5000 @ A3

I:\MGAL-W-BT-P-F01\Work - Transport\MG0337 - Ten-T Priority Route Imp - Donegal\8.0 Drawings\Phase 3\SRITT - MG10337-RPS-P3-S2-DR-C-SR0001 Side Road Plan & Profile.dwg

NOTES
DO NOT SCALE, use figured dimensions only.
All levels are referred to Ordnance Survey Datum, Mean Head.
This drawing is the property of the Donegal County Council. It is a confidential document and must not be copied, used, or its contents divulged without prior written consent. This document should not be relied on or used in circumstances other than those for which it was originally prepared. RPS / Barry Transportation accepts no responsibility for this document to any other party other than the party by whom it was commissioned.

| Rev. | Date | Drawn | Description | Chk'd | Appr. |
|------|----------|-------|--------------------|-------|-------|
| P01 | 04.11.25 | CS | ISSUE FOR PLANNING | RC | EC |

Project Title: TEN-T Priority Route Improvement Project, Donegal Section 2 - N56/N13 Letterkenny to Manorcunningham

Drawing Title: PROPOSED ROAD DEVELOPMENT SIDE ROAD PLAN & PROFILES

Scale: @ A1: As Shown @ A3: As Shown

Date: NOV 2025

Designed: PS

Drawn: MC

Approved: EC

Checked: RC

Sheet: 03 of 10

EIAR Drawing Identifier: EIAR DRAWING 4.8

File Identifier: TT_MGT0337-RPS-P3-S2-DR-C-SR0001

Status: A3

Rev: P01

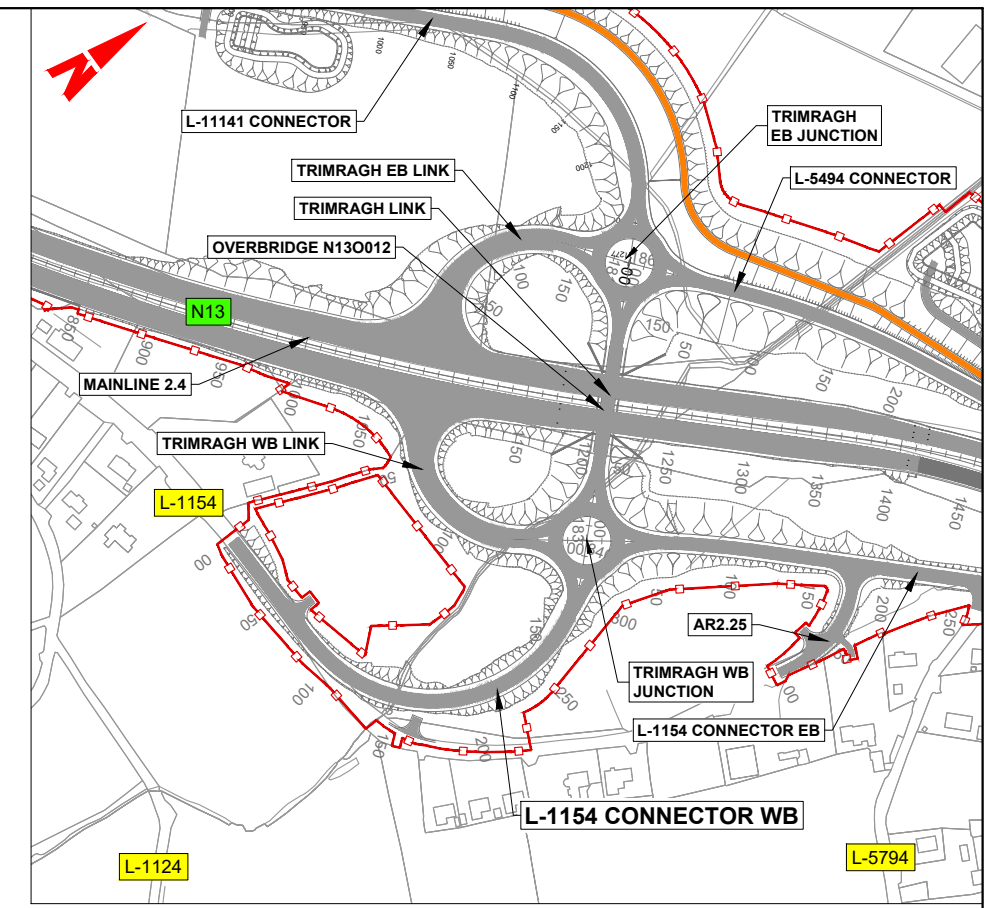
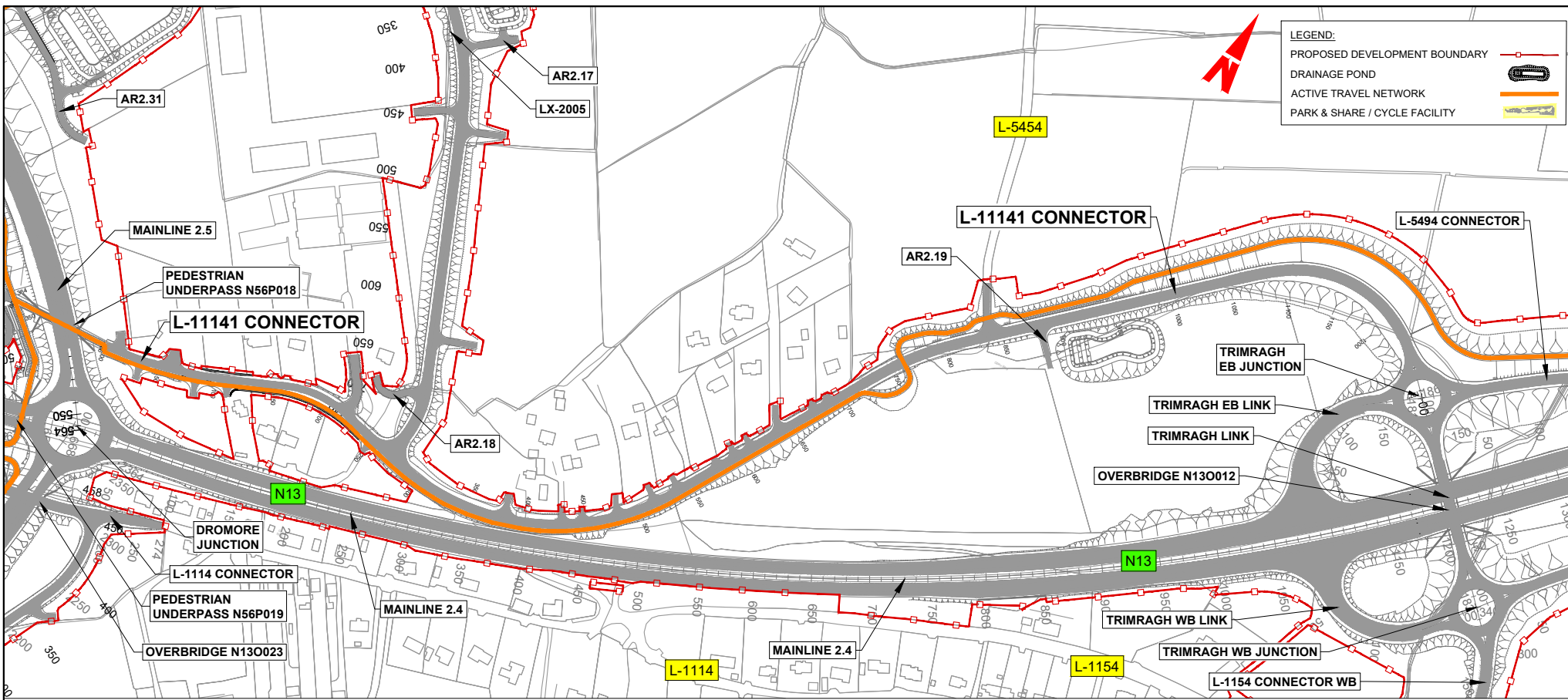

PLANS SCALE 1:2500 @ A1; 1:5000 @ A3

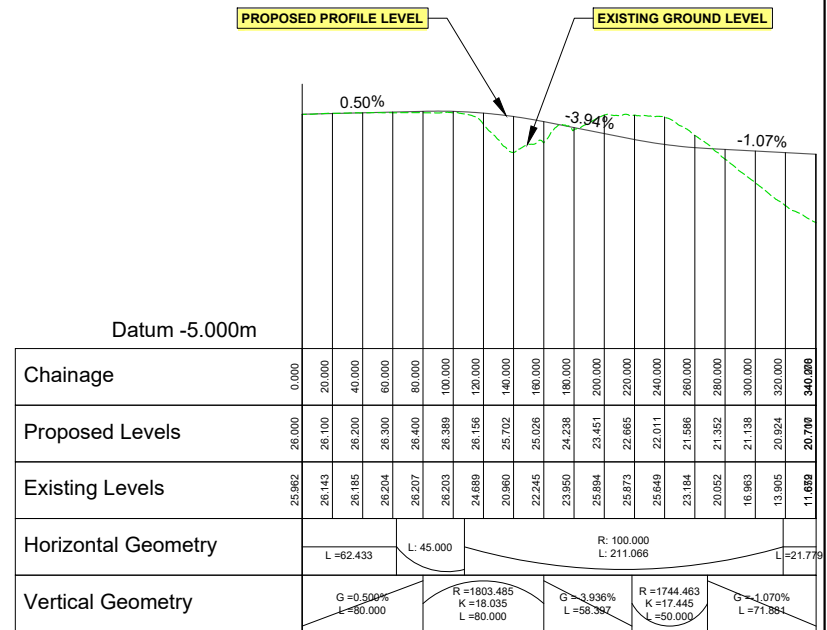
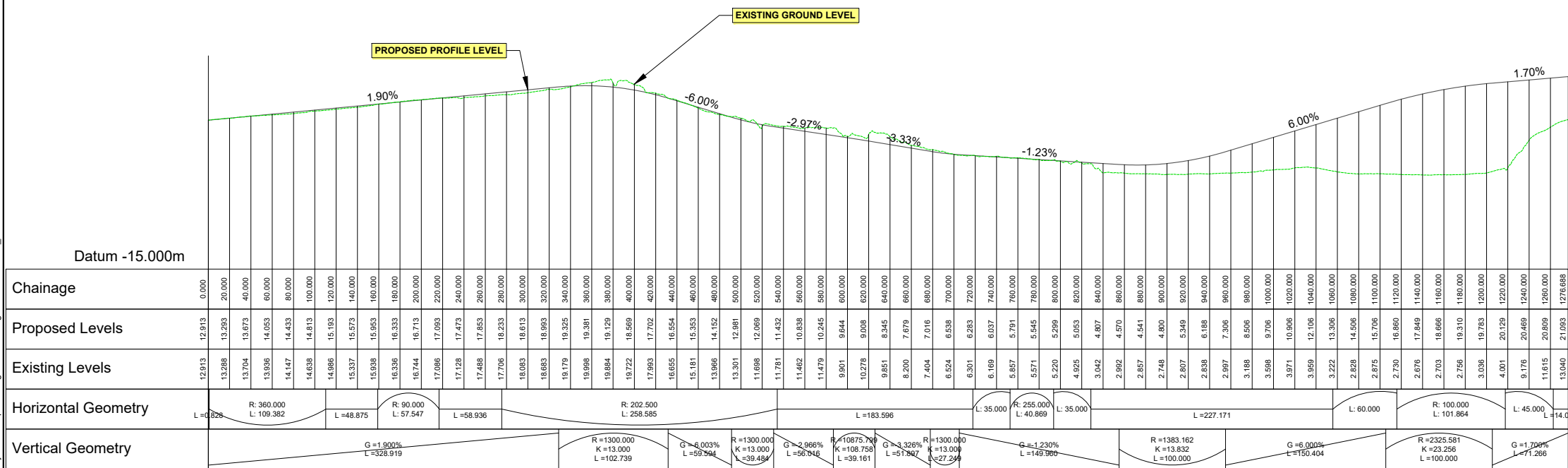
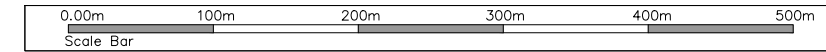

L-11141 CONNECTOR

L-1154 CONNECTOR WB

PROFILE VERTICAL SCALE 1:500 @ A1; 1:1000 @ A3
HORIZONTAL SCALE 1:2500 @ A1; 1:5000 @ A3



NOTES
DO NOT SCALE, use figured dimensions only.
All levels are referred to Ordnance Survey Datum, Mean Head.
This drawing is the property of the Donegal County Council. It is a confidential document and must not be copied, used, or its contents divulged without prior written consent. This document should not be relied on or used in circumstances other than those for which it was originally prepared. RPS / Barry Transportation accepts no responsibility for this document to any other party other than the party by whom it was commissioned.

| Rev. | Date | Drawn | Description | Chk'd | Appr. |
|------|----------|-------|--------------------|-------|-------|
| P01 | 04.11.25 | CS | ISSUE FOR PLANNING | RC | EC |

| | | |
|---------------------------------------------------------------------------------------------------------------------|----------------------|---------------------------------------------------|
| Project Title: TEN-T Priority Route Improvement Project, Donegal Section 2 - N56/N13 Letterkenny to Manorcunningham | | Status: A3 |
| Drawing Title: PROPOSED ROAD DEVELOPMENT SIDE ROAD PLAN & PROFILES | | Rev: P01 |
| Designed: PS | Date: NOV 2025 | EIAR Drawing Identifier: EIAR DRAWING 4.8 |
| Drawn: MC | Scale @ A1: As Shown | File Identifier: TT_MGT0337-RPS-P3-S2-DR-C-SR0001 |
| Approved: EC | @ A3: As Shown | |
| Checked: RC | Sheet: 04 of 10 | |

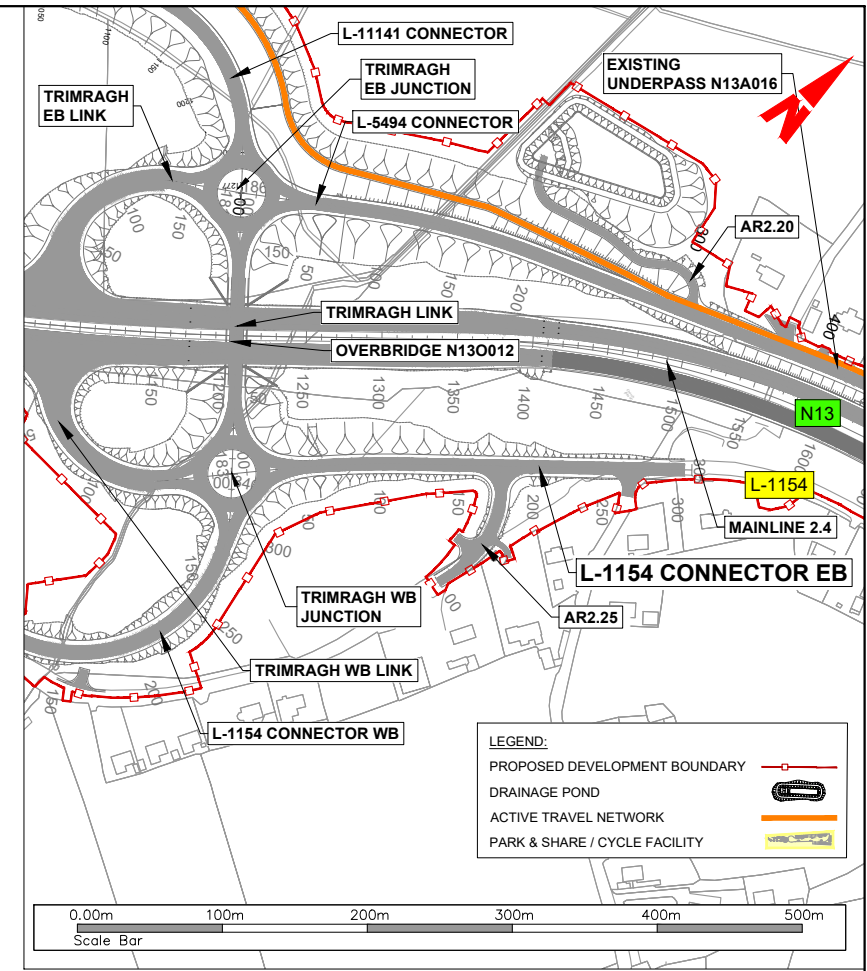
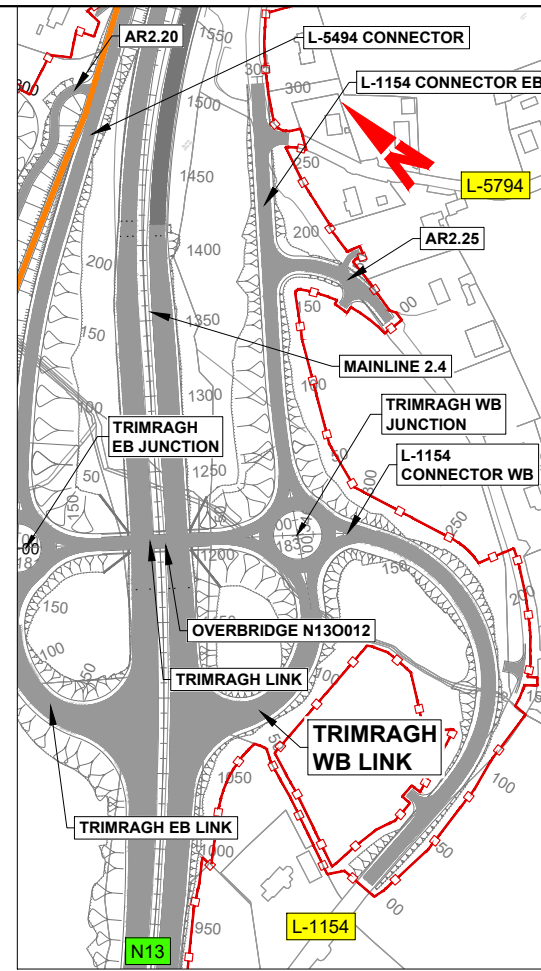
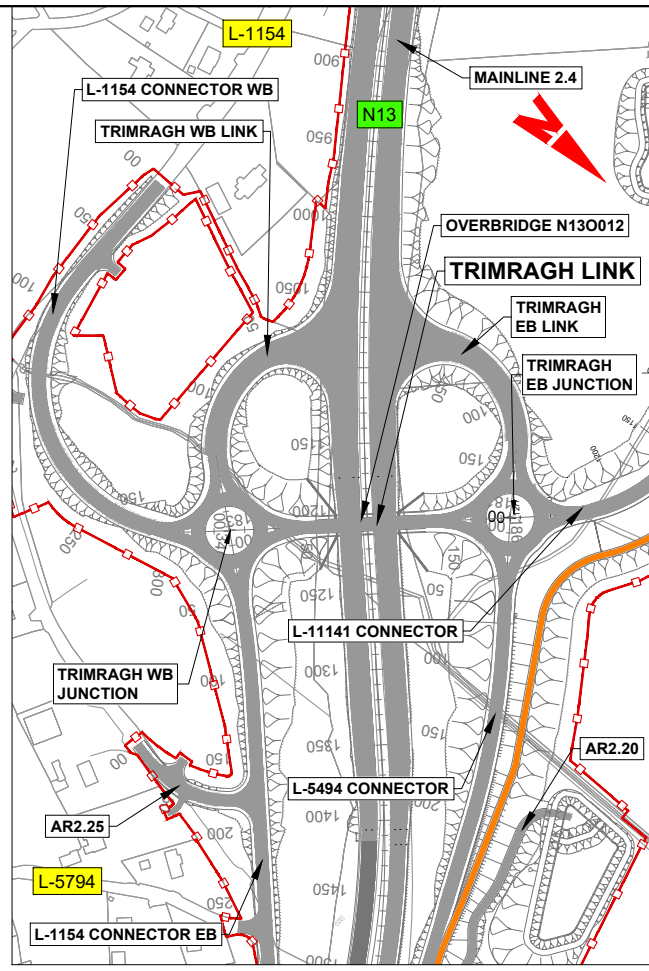
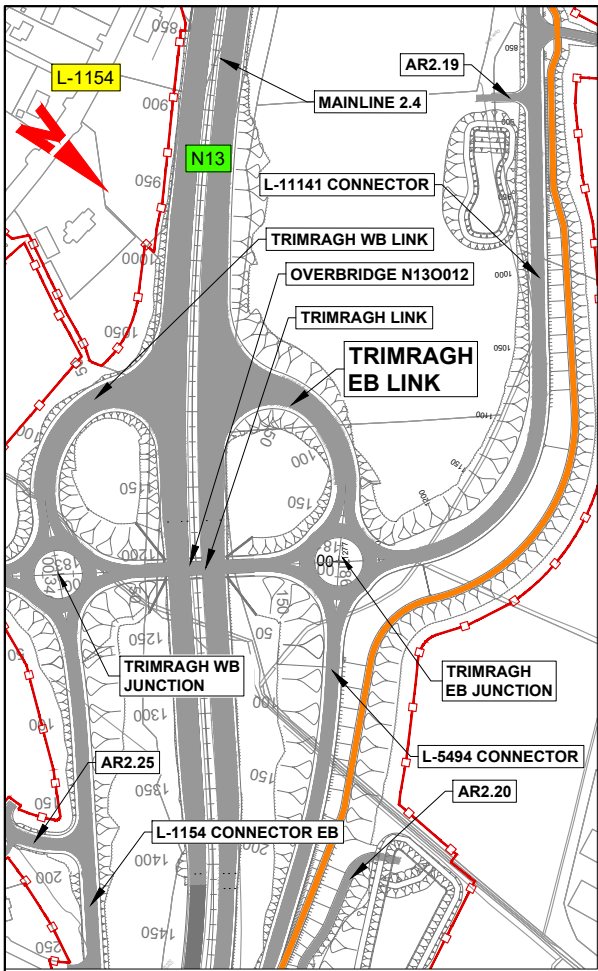

PLANS SCALE 1:2500 @ A1; 1:5000 @ A3

10GALW-BT-P-F01Work - TransportMGT0337 - Ten-T Priority Route Imp - DonegalRPS-P3-S2-DR-C-SR0001 Side Road Plan & Profile.dwg

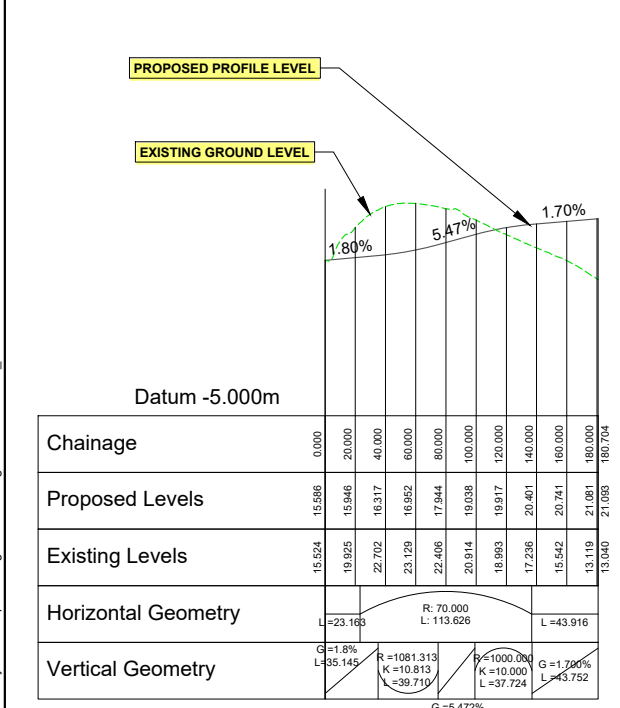

TRIMRAGH EB LINK

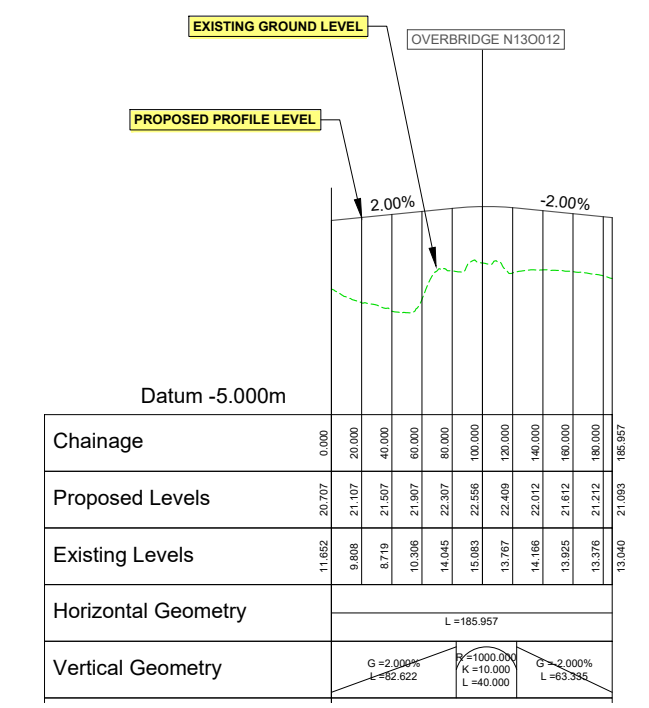

TRIMRAGH LINK

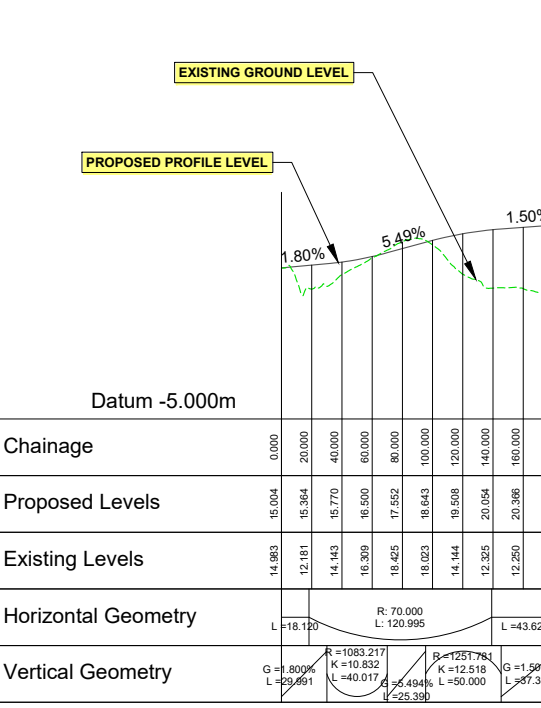

TRIMRAGH WB LINK

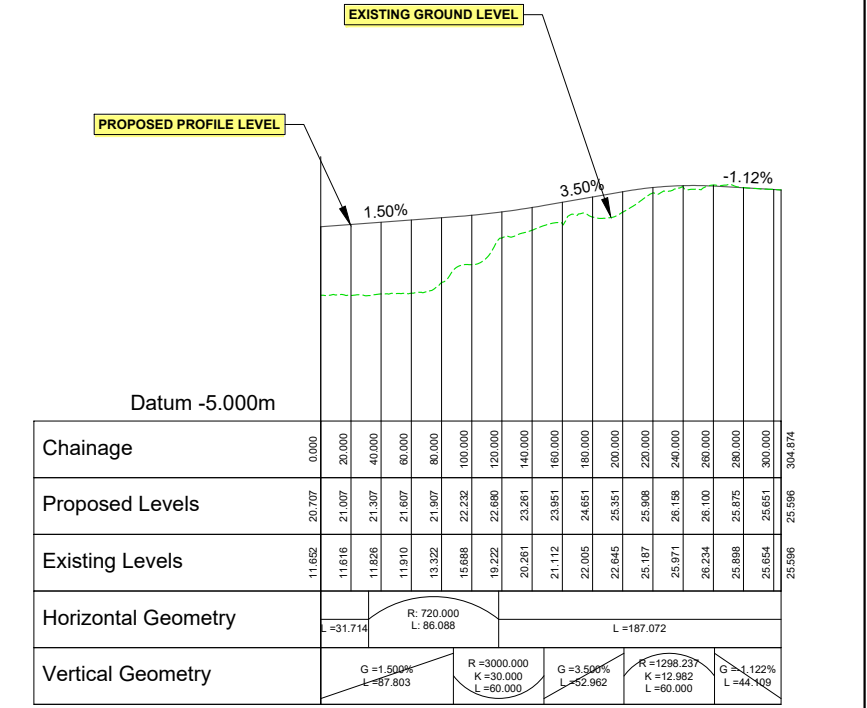

L-1154 CONNECTOR EB

PROFILE VERTICAL SCALE 1:500 @ A1; 1:1000 @ A3 HORIZONTAL SCALE 1:2500 @ A1; 1:5000 @ A3

Logos for TII (Transport Infrastructure Ireland), European Union, and Donegal County Council. Text: Rialtas na hÉireann Government of Ireland, 2040, Donegal County Council, Comhairle Contae Dhún na nGall.

Logos for Donegal County Council and RPS BARRY. Text: Donegal County Council, Comhairle Contae Dhún na nGall, RPS BARRY TRANSPORTATION.

Logos for RPS BARRY and Donegal County Council. Text: RPS BARRY TRANSPORTATION, Donegal County Council, Comhairle Contae Dhún na nGall.

NOTES
DO NOT SCALE, use figured dimensions only.
All levels are referred to Ordnance Survey Datum, Malin Head.
This drawing is the property of the Donegal County Council. It is a confidential document and must not be copied, used, or its contents divulged without prior written consent. This document should not be relied on or used in circumstances other than those for which it was originally prepared. RPS / Barry Transportation accepts no responsibility for this document to any other party other than the party by whom it was commissioned.

| Rev. | Date | Drawn | Description | Chk'd | Appr. |
|------|----------|-------|--------------------|-------|-------|
| P01 | 04.11.25 | CS | ISSUE FOR PLANNING | RC | EC |

Project Title: TEN-T Priority Route Improvement Project, Donegal Section 2 - N56/N13 Letterkenny to Manorcunningham
Drawing Title: PROPOSED ROAD DEVELOPMENT SIDE ROAD PLAN & PROFILES
Status: A3
Designed: PS
Drawn: MC
Approved: EC
Checked: RC
Date: NOV 2025
Scale @ A1: As Shown
Scale @ A3: As Shown
Sheet: 05 of 10
EIA Drawing Identifier: EIA DRAWING 4.8
File Identifier: TT_MGT0337-RPS-P3-S2-DR-C-SR0001
Rev: P01

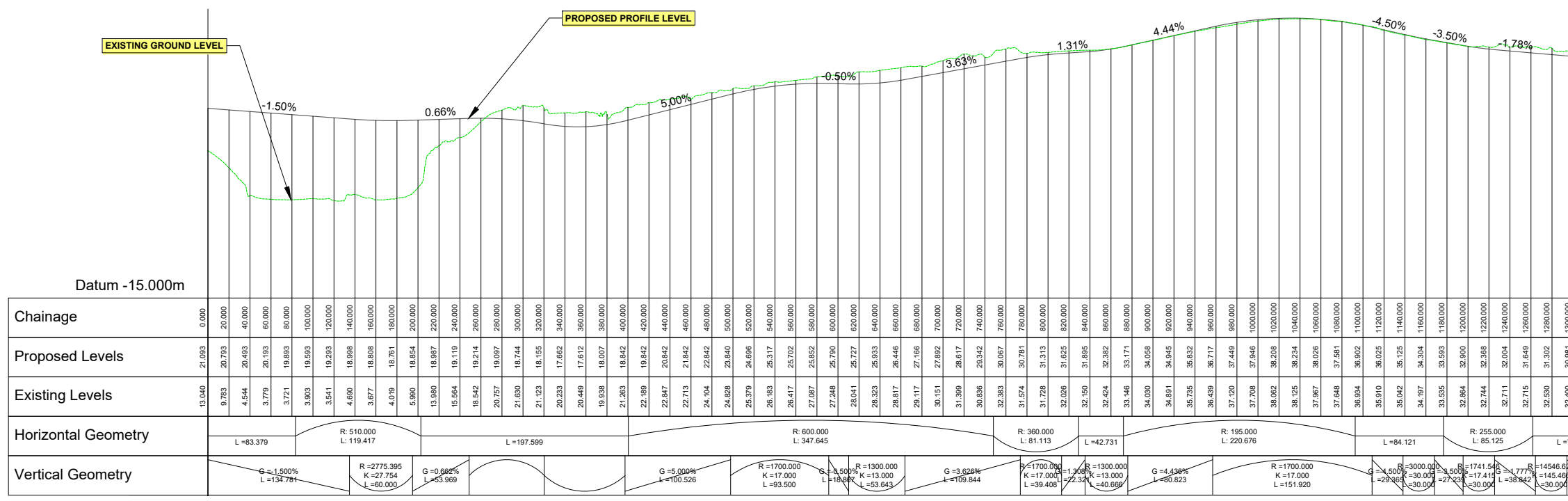
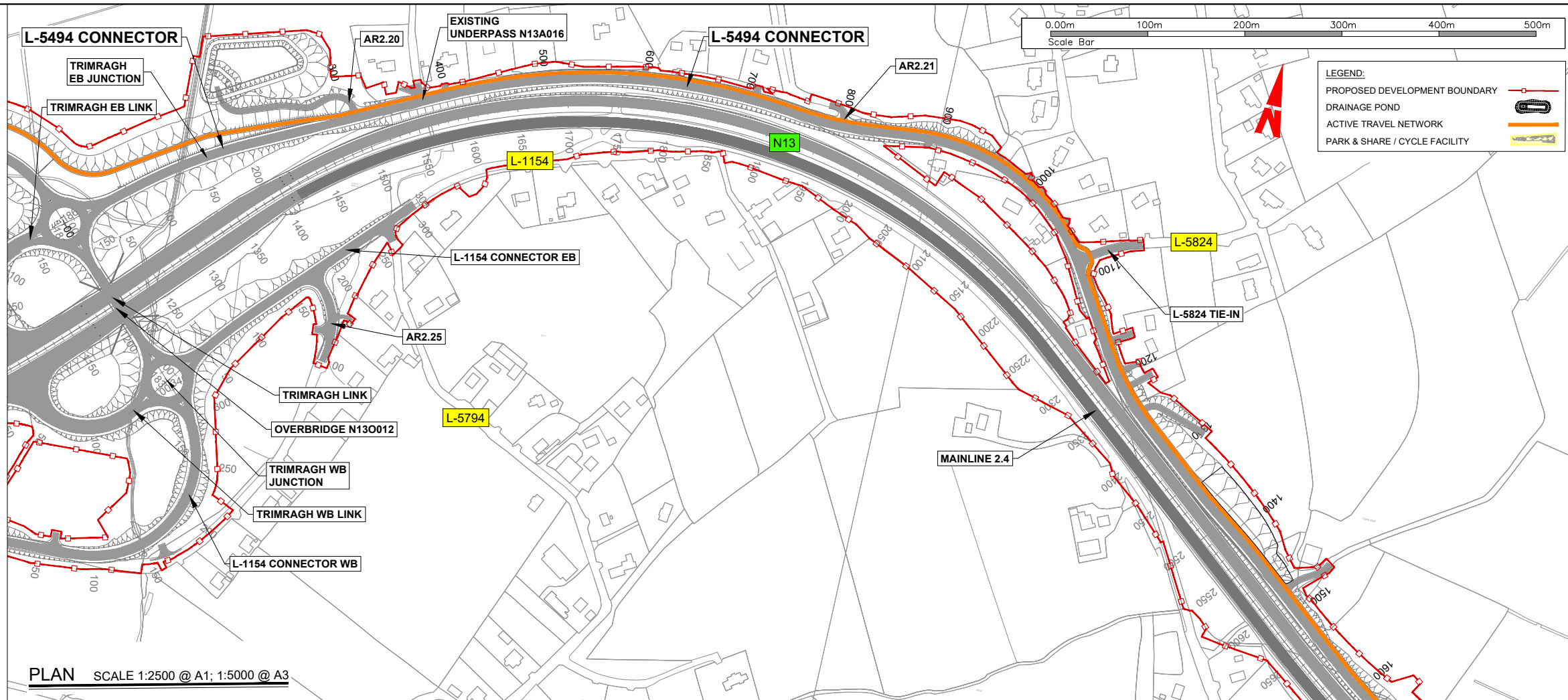

L-5494 CONNECTOR

VERTICAL SCALE 1:500 @ A1; 1:1000 @ A3
 PROFILE HORIZONTAL SCALE 1:2500 @ A1; 1:5000 @ A3

I:\GALV-BTP-F01\Work - Transport\MG10337 - Ten-T Priority Route Imp - Donegal\Phase 3\SRIT - MG10337-RPS-P3-S2-DR-C-SR0001 Side Road Plan & Profile.dwg



NOTES
 DO NOT SCALE, use figured dimensions only.
 All levels are referred to Ordnance Survey Datum, Mean Head.
 This drawing is the property of the Donegal County Council. It is a confidential document and must not be copied, used, or its contents divulged without prior written consent. This document should not be relied on or used in circumstances other than those for which it was originally prepared. RPS / Barry Transportation accepts no responsibility for this document to any other party other than the party by whom it was commissioned.

| Rev. | Date | Drawn | Description | Ch'd | Appr. |
|------|----------|-------|--------------------|------|-------|
| P01 | 04.11.25 | CS | ISSUE FOR PLANNING | RC | EC |

| | | |
|---------------------------------------------------------------------------------------------------------------------|----------------------|---------------------------------------------------|
| Project Title: TEN-T Priority Route Improvement Project, Donegal Section 2 - N56/N13 Letterkenny to Manorcunningham | | Status: A3 |
| Drawing Title: PROPOSED ROAD DEVELOPMENT SIDE ROAD PLAN & PROFILES | | Rev: P01 |
| Designed: PS | Date: NOV 2025 | EIAR Drawing Identifier: EIAR DRAWING 4.8 |
| Drawn: MC | Scale @ A1: As Shown | File Identifier: TT_MGT0337-RPS-P3-S2-DR-C-SR0001 |
| Approved: EC | @ A3: As Shown | Sheet: 06 of 10 |
| Checked: RC | | |

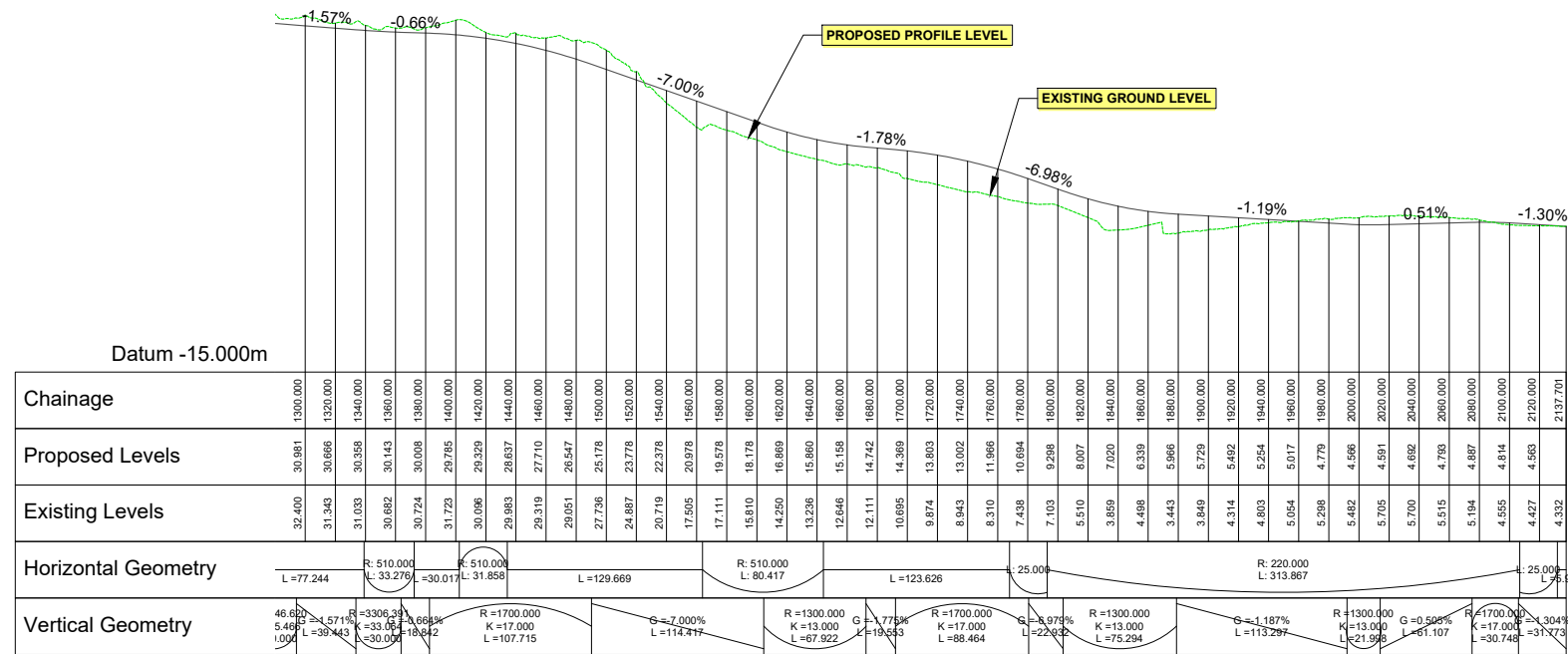
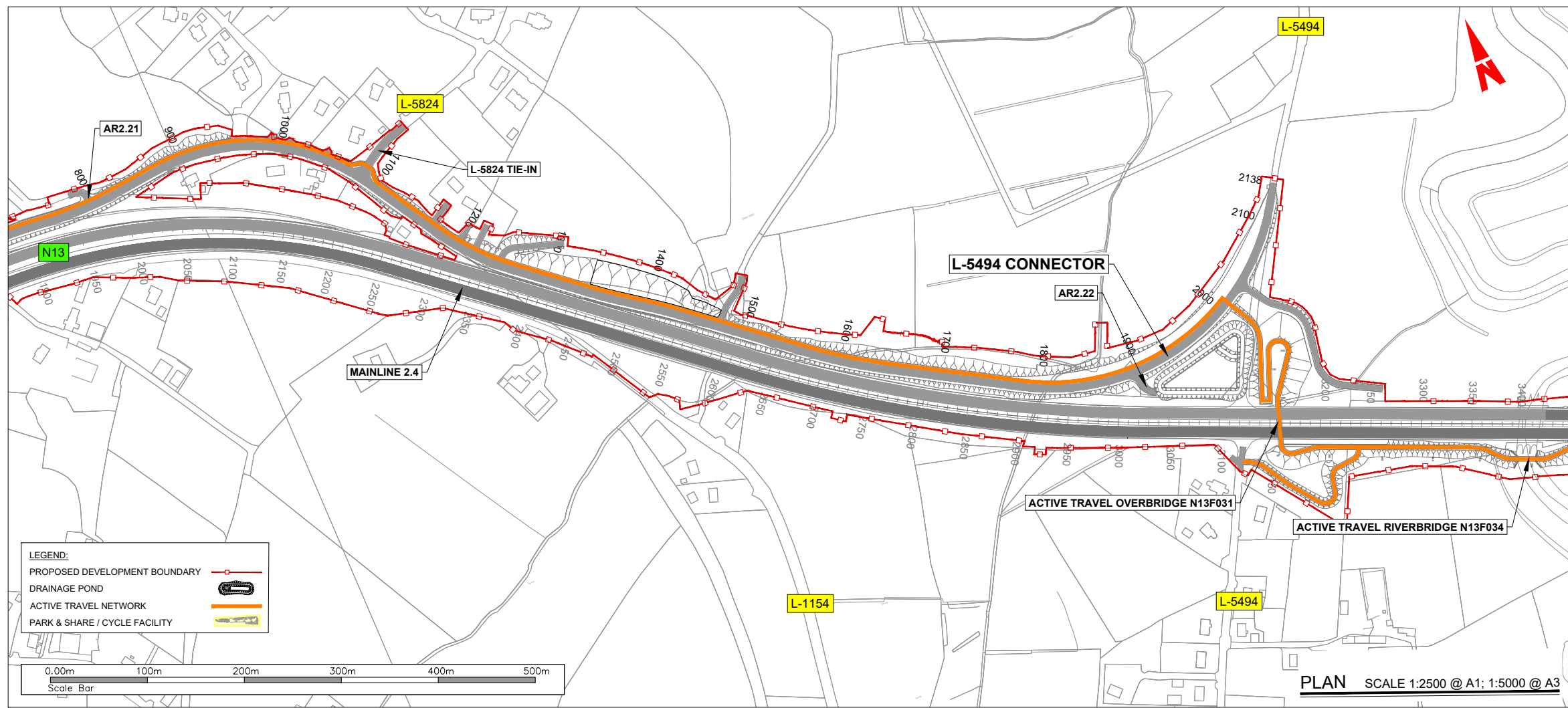

PROFILE VERTICAL SCALE 1:500 @ A1; 1:1000 @ A3
HORIZONTAL SCALE 1:2500 @ A1; 1:5000 @ A3



NOTES
DO NOT SCALE, use figured dimensions only.
All levels are referred to Ordnance Survey Datum, Main Head.
This drawing is the property of the Donegal County Council. It is a confidential document and must not be copied, used, or its contents divulged without prior written consent. This document should not be relied on or used in circumstances other than those for which it was originally prepared. RPS / Barry Transportation accepts no responsibility for this document to any other party other than the party by whom it was commissioned.

| Rev. | Date | Drawn | Description | Chk'd | Appr. |
|------|----------|-------|--------------------|-------|-------|
| P01 | 04.11.25 | CS | ISSUE FOR PLANNING | RC | EC |

| | | |
|---------------------------------------------------------------------------------------------------------------------|----------------------|-----------------------------------------------------------|
| Project Title: TEN-T Priority Route Improvement Project, Donegal Section 2 - N56/N13 Letterkenny to Manorcunningham | | Status: A3 |
| Drawing Title: PROPOSED ROAD DEVELOPMENT SIDE ROAD PLAN & PROFILES | | Rev: P01 |
| Designed: PS | Date: NOV 2025 | EIAR Drawing Identifier: TT_MGT0337-RPS-P3-S2-DR-C-SR0001 |
| Drawn: MC | Scale @ A1: As Shown | EIAR Drawing Identifier: EIAR DRAWING 4.8 |
| Approved: EC | @ A3: As Shown | File Identifier: TT_MGT0337-RPS-P3-S2-DR-C-SR0001 |
| Checked: RC | Sheet: 07 of 10 | |

I:\GALW-BT-P-F01\Work - Transport\MGT0337 - Ten-T Priority Route Imp - Donegal\0. Drawings\Phase 3\SRIT - MG10337-RPS-P3-S2-DR-C-SR0001 Side Road Plan & Profile.dwg

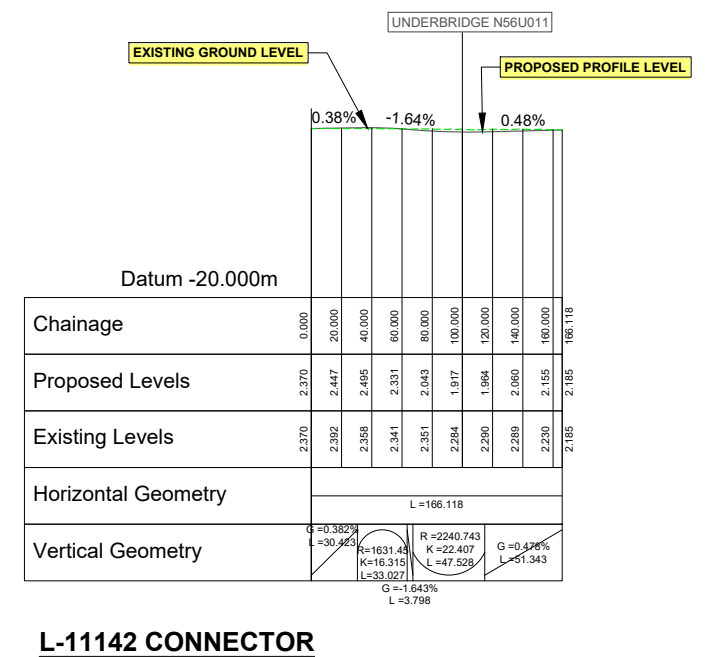
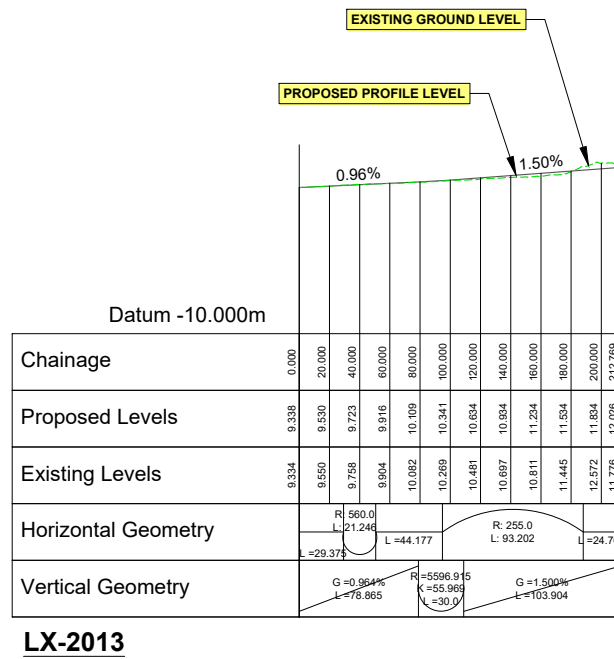
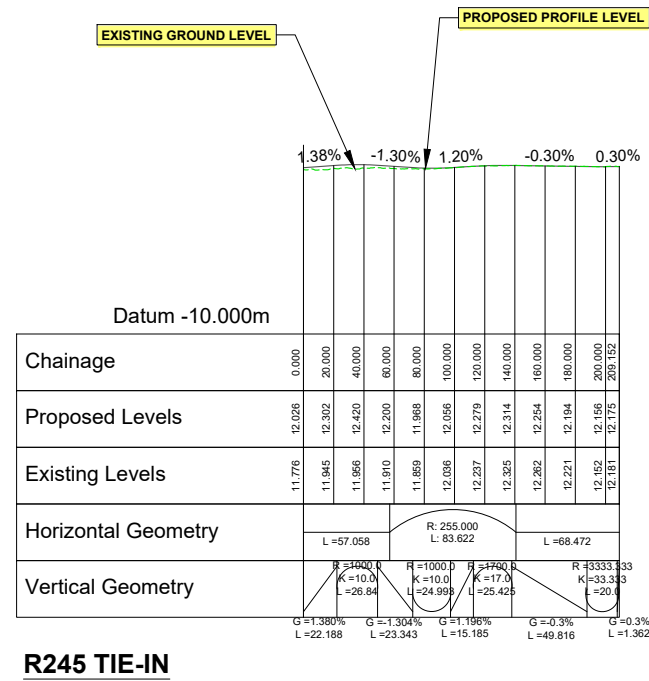
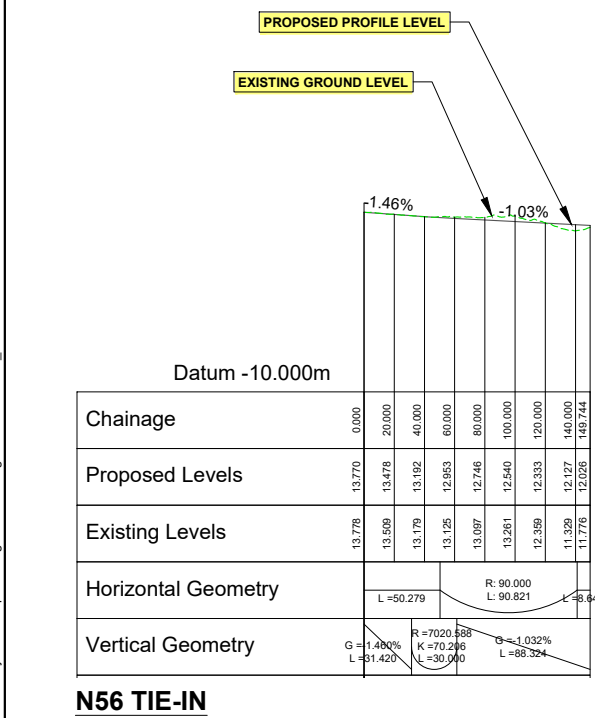
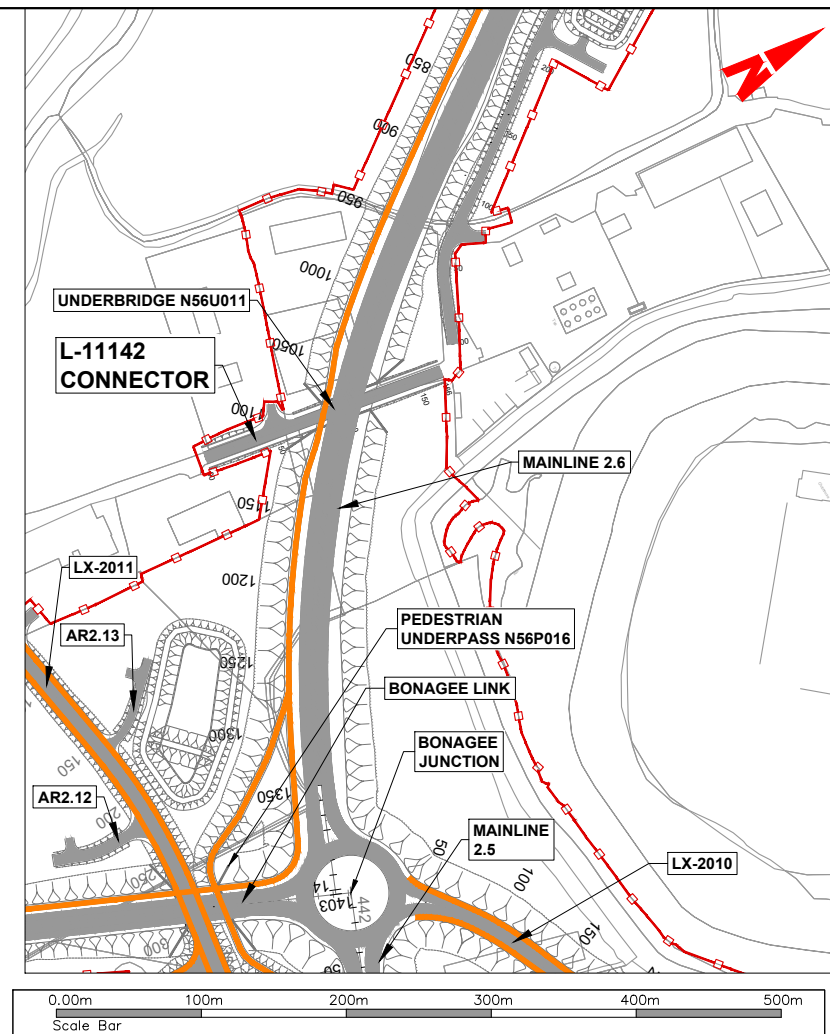
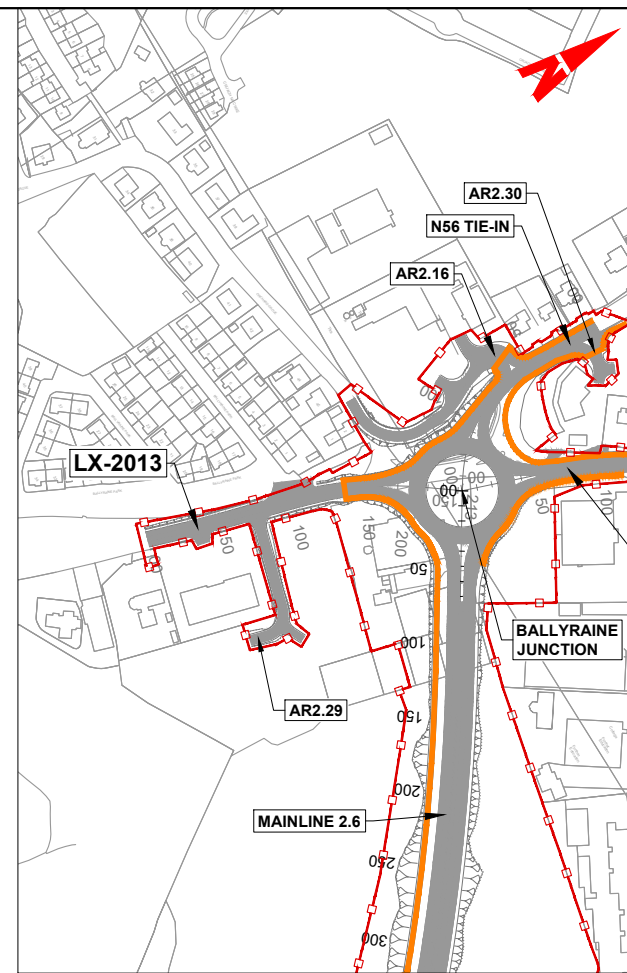
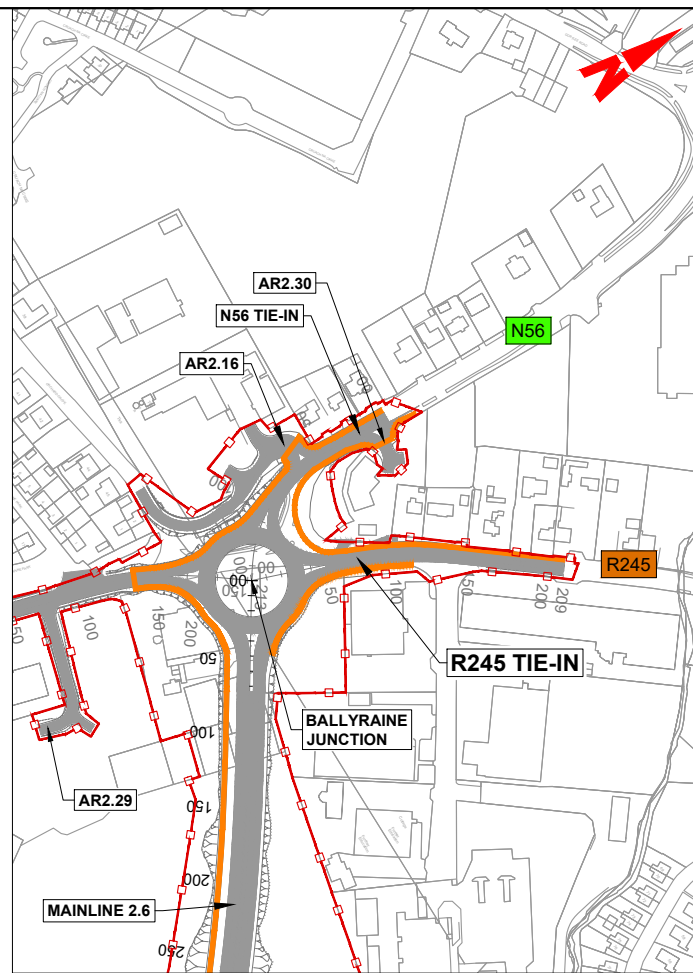
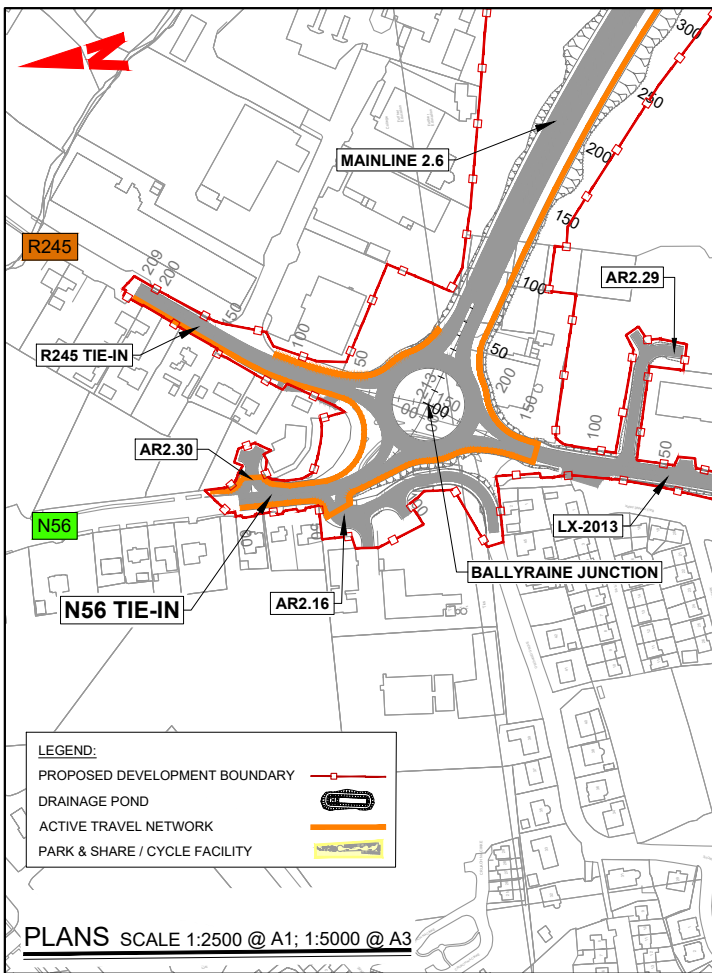

PROFILE VERTICAL SCALE 1:500 @ A1; 1:1000 @ A3
 HORIZONTAL SCALE 1:2500 @ A1; 1:5000 @ A3

IGALW-BTP-F01Work - TransportMGT0337 - Ten-T Priority Route Imp - Donegal Phase 3/SRIT - MGT0337-RPS-P3-S2-DR-C-SR0001 Side Road Plan & Profile.dwg

NOTES
 DO NOT SCALE, use figured dimensions only.
 All levels are referred to Ordnance Survey Datum, Mean Head.
 This drawing is the property of the Donegal County Council. It is a confidential document and must not be copied, used, or its contents divulged without prior written consent. This document should not be relied on or used in circumstances other than those for which it was originally prepared. RPS / Barry Transportation accepts no responsibility for this document to any other party other than the party by whom it was commissioned.

| Rev. | Date | Drawn | Description | Chk'd | Appr. |
|------|----------|-------|--------------------|-------|-------|
| P01 | 04.11.25 | CS | ISSUE FOR PLANNING | RC | EC |

| | | |
|---------------------------------------------------------------------------------------------------------------------|-------------------------------------|---------------------------------------------------|
| Project Title: TEN-T Priority Route Improvement Project, Donegal Section 2 - N56/N13 Letterkenny to Manorcunningham | | Status: A3 |
| Drawing Title: PROPOSED ROAD DEVELOPMENT SIDE ROAD PLAN & PROFILES | | Rev: P01 |
| Designed: PS | Date: NOV 2025 | EIAR Drawing Identifier: EIAR DRAWING 4.8 |
| Drawn: MC | Scale @ A1: As Shown @ A3: As Shown | File Identifier: TT_MGT0337-RPS-P3-S2-DR-C-SR0001 |
| Approved: EC | Sheet: 08 of 10 | |
| Checked: RC | | |

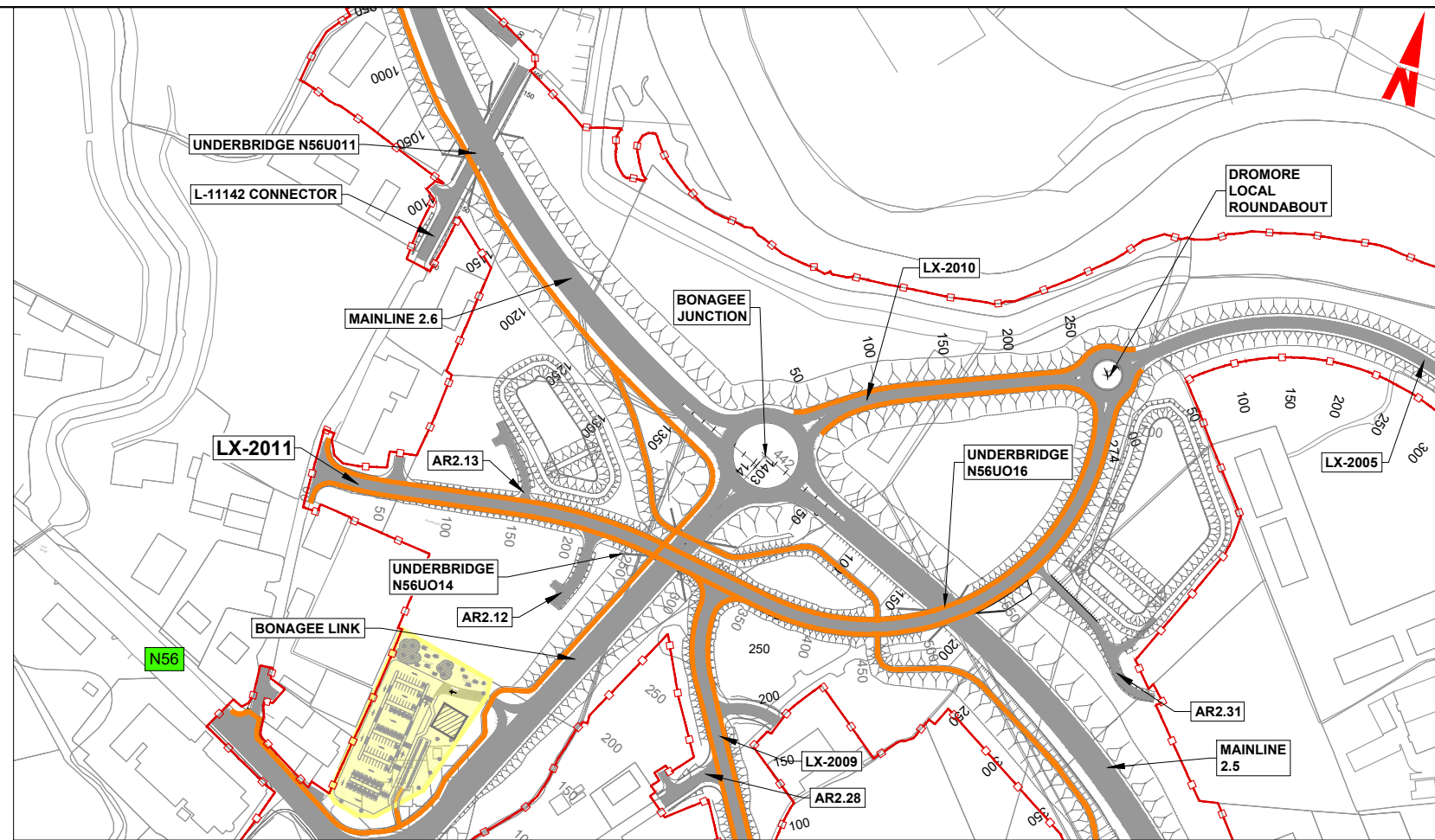

PLANS SCALE 1:2500 @ A1; 1:5000 @ A3

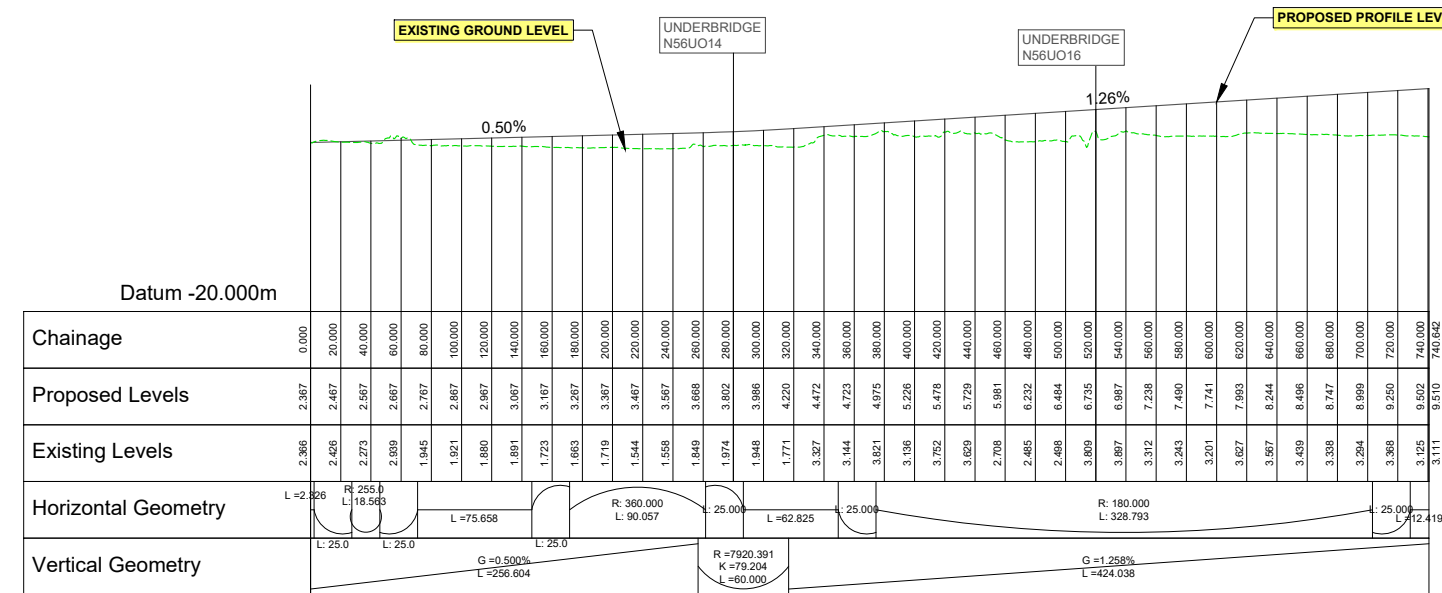

LX-2011

PROFILE VERTICAL SCALE 1:500 @ A1; 1:1000 @ A3
HORIZONTAL SCALE 1:2500 @ A1; 1:5000 @ A3

I:\GALW-BT-P-F01\Work - Transport\MGT0337 - Ten-T Priority Route Imp - Donegal\0. Drawings\Phase 3\SRIT - MG10337-RPS-P3-S2-DR-C-SR0001 - Side Road Plan & Profile.dwg

NOTES
DO NOT SCALE, use figured dimensions only.
All levels are referred to Ordnance Survey Datum, Mean Head.
This drawing is the property of the Donegal County Council. It is a confidential document and must not be copied, used, or its contents divulged without prior written consent. This document should not be relied on or used in circumstances other than those for which it was originally prepared. RPS / Barry Transportation accepts no responsibility for this document to any other party other than the party by whom it was commissioned.

| Rev. | Date | Drawn | Description | Chk'd | Appr. |
|------|----------|-------|--------------------|-------|-------|
| P01 | 04.11.25 | CS | ISSUE FOR PLANNING | RC | EC |

| | | |
|---------------------------------------------------------------------------------------------------------------------|----------------------|---------------------------------------------------|
| Project Title: TEN-T Priority Route Improvement Project, Donegal Section 2 - N56/N13 Letterkenny to Manorcunningham | | Status: A3 |
| Drawing Title: PROPOSED ROAD DEVELOPMENT SIDE ROAD PLAN & PROFILES | | Rev: P01 |
| Designed: PS | Date: NOV 2025 | EIAR Drawing Identifier: EIAR DRAWING 4.8 |
| Drawn: MC | Scale @ A1: As Shown | File Identifier: TT_MGT0337-RPS-P3-S2-DR-C-SR0001 |
| Approved: EC | @ A3: As Shown | |
| Checked: RC | Sheet: 09 of 10 | |

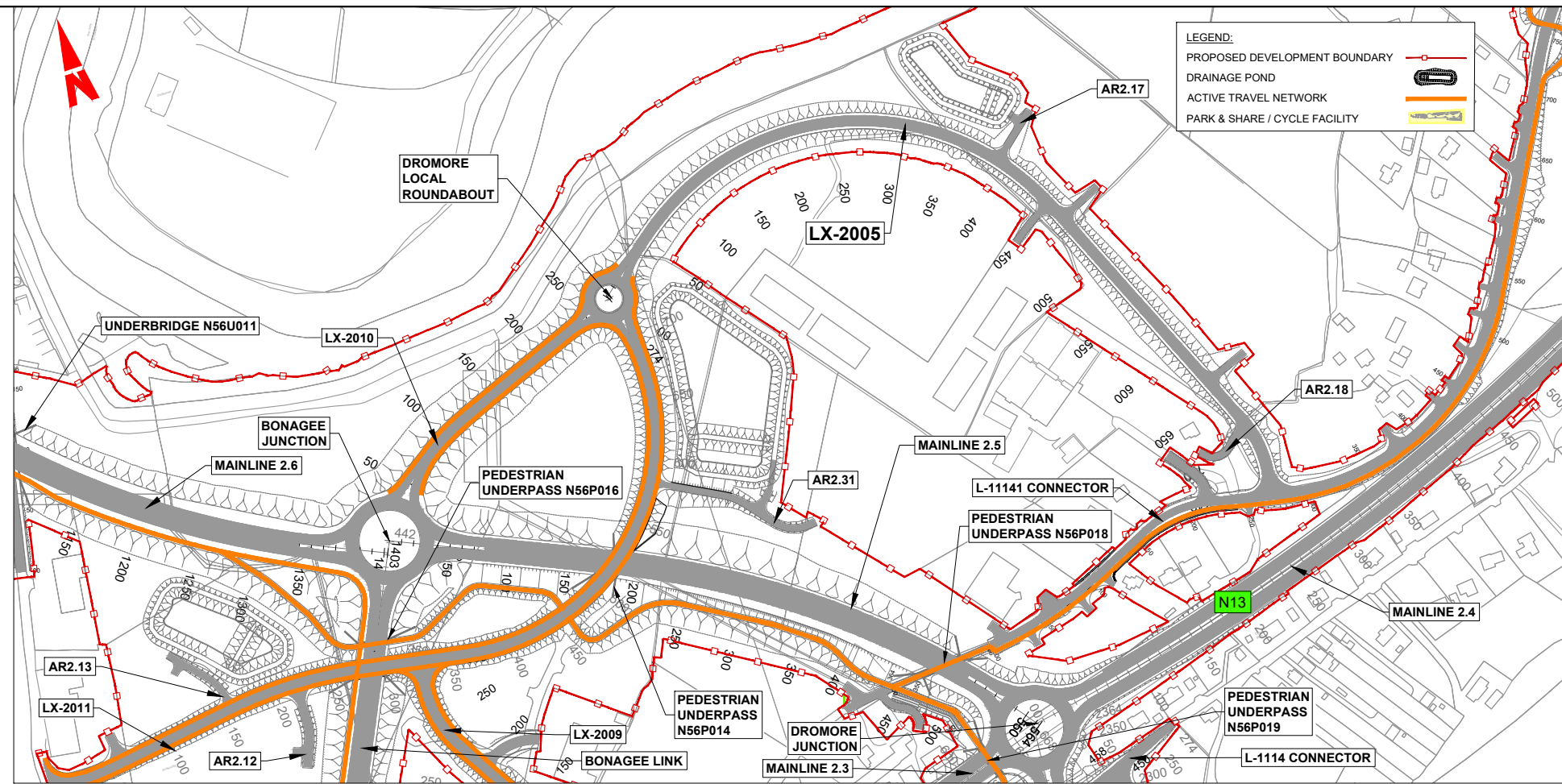
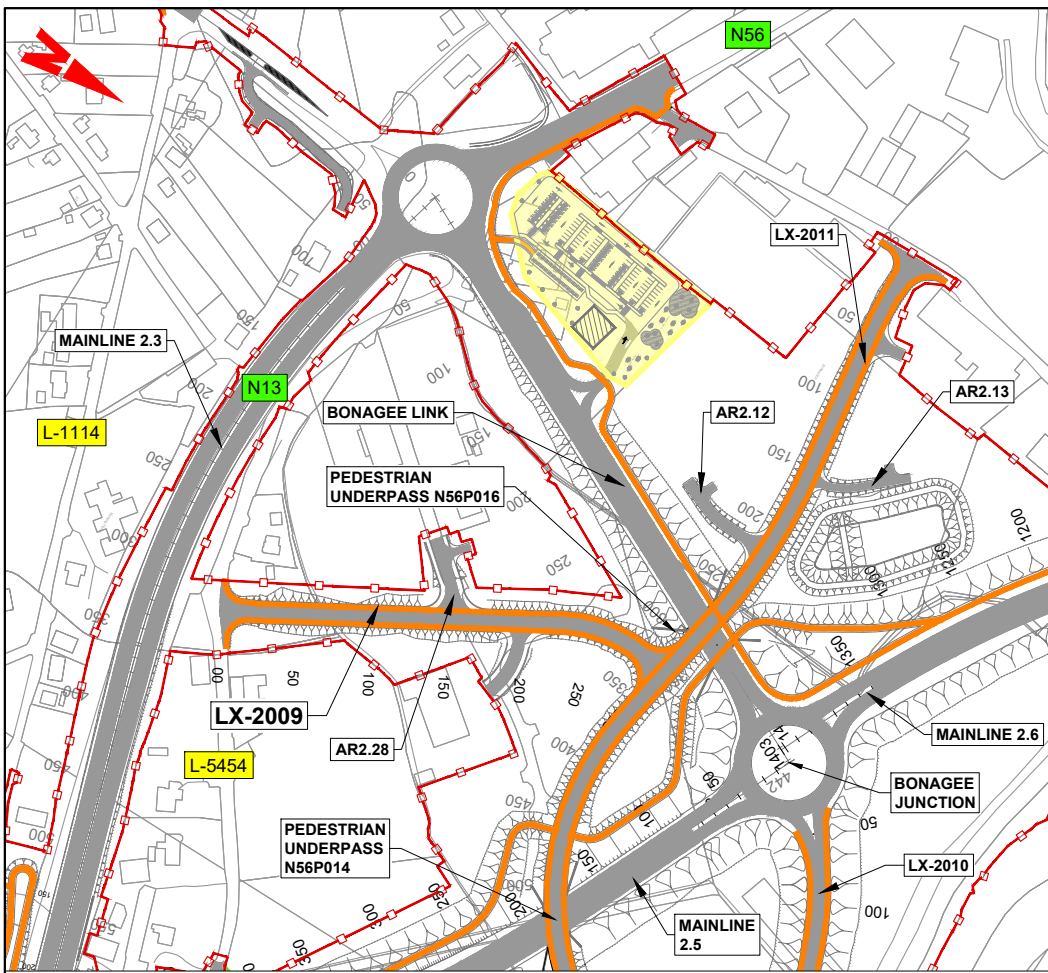

PLANS SCALE 1:2500 @ A1; 1:5000 @ A3

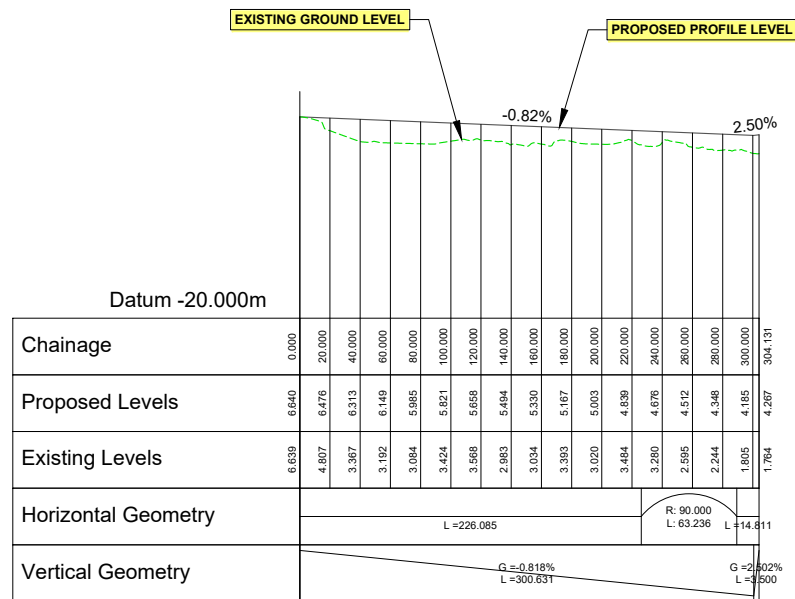

LX-2009

PROFILE VERTICAL SCALE 1:500 @ A1; 1:1000 @ A3
HORIZONTAL SCALE 1:2500 @ A1; 1:5000 @ A3

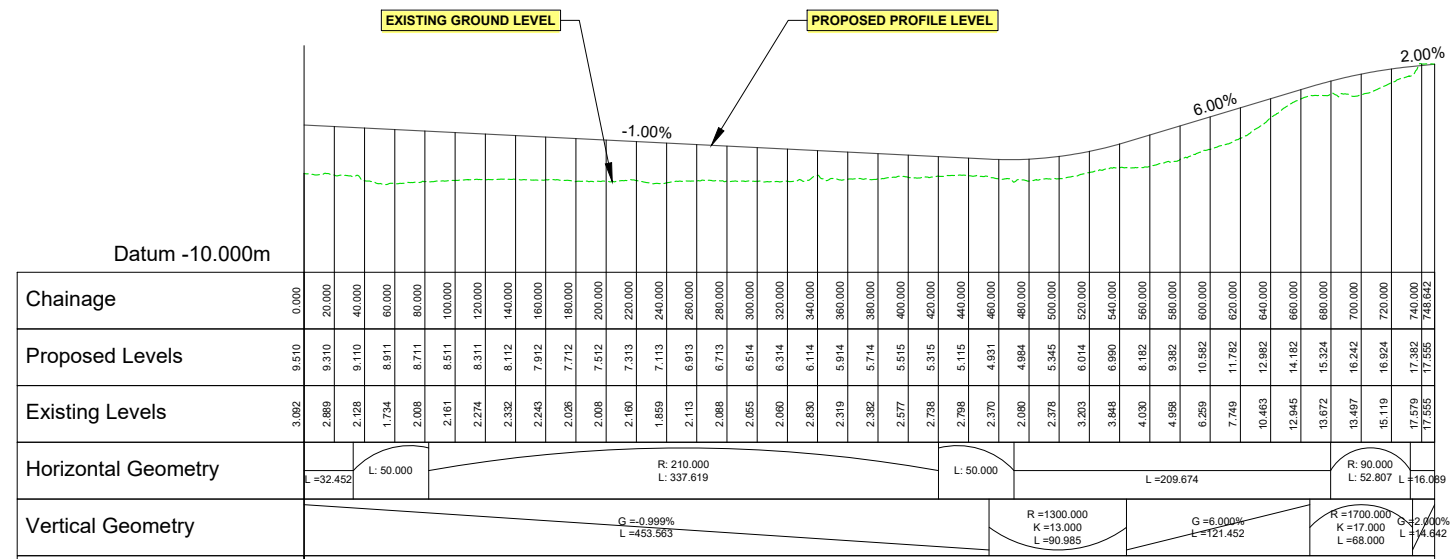

LX-2005

NOTES
DO NOT SCALE, use figured dimensions only.
All levels are referred to Ordnance Survey Datum, Main Head.
This drawing is the property of the Donegal County Council. It is a confidential document and must not be copied, used, or its contents divulged without prior written consent. This document should not be relied on or used in circumstances other than those for which it was originally prepared. RPS / Barry Transportation accepts no responsibility for this document to any other party other than the party by whom it was commissioned.

| Rev. | Date | Drawn | Description | Chk'd | Appr. |
|------|----------|-------|--------------------|-------|-------|
| P01 | 04.11.25 | CS | ISSUE FOR PLANNING | RC | EC |

Project Title: TEN-T Priority Route Improvement Project, Donegal Section 2 - N56/N13 Letterkenny to Manorcunningham

Drawing Title: PROPOSED ROAD DEVELOPMENT SIDE ROAD PLAN & PROFILES

Status: A3

Designed: PS
Drawn: MC
Approved: EC
Checked: RC

Date: NOV 2025
Scale @ A1: As Shown
@ A3: As Shown

Sheet: 10 of 10

EIAR Drawing Identifier: EIAR DRAWING 4.8
File Identifier: TT_MGT0337-RPS-P3-S2-DR-C-SR0001

Rev: P01