

SECTION 1 PARK AND SHARE / CYCLE FACILITY 1.03

SECTION 1 PARK AND SHARE / CYCLE FACILITY 1.02

SECTION 1 PARK AND SHARE / CYCLE FACILITY 1.01

LEGEND:

- PARK & SHARE / CYCLE FACILITY
- DRAINAGE POND
- PROPOSED DEVELOPMENT BOUNDARY
- PROPOSED ACTIVE TRAVEL NETWORK

T:\MGT0337 - Ten-T Priority Route Imp - Donegal\8.0 Drawings\Phase 3\DGITT_MGT0337-RPS-P3-S1-DR-C-DG0019 Park and Share Cycle Facility.dwg

NOTES
 DO NOT SCALE, use figured dimensions only.
 All levels are referred to Ordnance Survey Datum, Mean Head.
 This drawing is the property of the Donegal County Council. It is a confidential document and must not be copied, used, or its contents divulged without prior written consent. This document should not be relied on or used in circumstances other than those for which it was originally prepared. RPS / Barry Transportation accepts no responsibility for this document to any other party other than the party by whom it was commissioned.

Rev.	Date	Drawn	Description	Chk'd	Appr.
P01	28.10.25	DL	ISSUE FOR PLANNING	MC	EC

Project Title: TEN-T Priority Route Improvement Project, Donegal Section 1 - N15/N13 Ballybofey / Stranorlar Urban Region		Status: A3
Drawing Title: PARK AND SHARE / CYCLE FACILITY PLAN		Rev: P01
Designed: SS	Date: OCT 2025	EIAR Drawing Identifier: EIAIAR DRAWING 4.50
Drawn: DL	Scale @ A1: NTS	File Identifier: TT_MGT0337-RPS-P3-S1-DR-C-DG0019
Approved: EC	@ A3: NTS	Sheet: 01 of 04
Checked: MC	Sheet: 01 of 04	

SECTION 1 PARK AND SHARE / CYCLE FACILITY 1.01

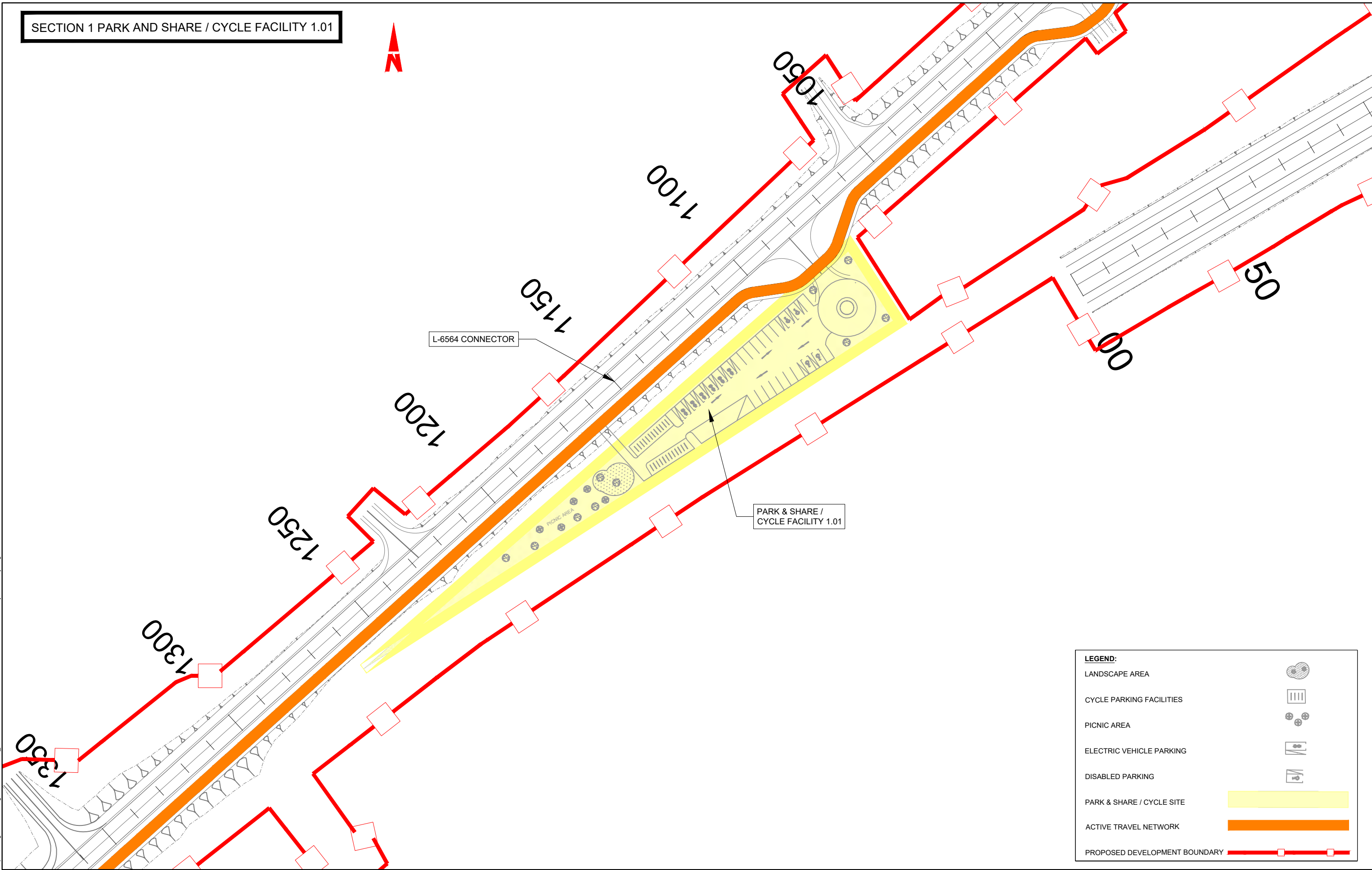

LEGEND:

- LANDSCAPE AREA
- CYCLE PARKING FACILITIES
- PICNIC AREA
- ELECTRIC VEHICLE PARKING
- DISABLED PARKING
- PARK & SHARE / CYCLE SITE
- ACTIVE TRAVEL NETWORK
- PROPOSED DEVELOPMENT BOUNDARY

NOTES
 DO NOT SCALE, use figured dimensions only.
 All levels are referred to Ordnance Survey Datum, Malin Head.
 This drawing is the property of the Donegal County Council. It is a confidential document and must not be copied, used, or its contents divulged without prior written consent. This document should not be relied on or used in circumstances other than those for which it was originally prepared. RPS / Barry Transportation accepts no responsibility for this document to any other party other than the party by whom it was commissioned.

Rev.	Date	Drawn	Description	Chk'd	Appr.
P01	28.10.25	DL	ISSUE FOR PLANNING	MC	EC

Project Title: TEN-T Priority Route Improvement Project, Donegal Section 1 - N15/N13 Ballybofey / Stranorlar Urban Region		Status: A3
Drawing Title: PARK AND SHARE / CYCLE FACILITY PLAN		Rev: P01
Designed: SS	Date: OCT 2025	EIAR Drawing Identifier:
Drawn: DL	Scale @ A1: 1:500	EIAR DRAWING 4.50
Approved: EC	@ A3: 1:1000	File Identifier:
Checked: MC	Sheet: 02 of 04	TT_MGT0337-RPS-P3-S1-DR-C-DG0019

T:\MGT0337 - Ten-T Priority Route Imp - Donegal\8.0 Drawings\Phase 3\DGITT_MGT0337-RPS-P3-S1-DR-C-DG0019 Park and Share Cycle Facility.dwg

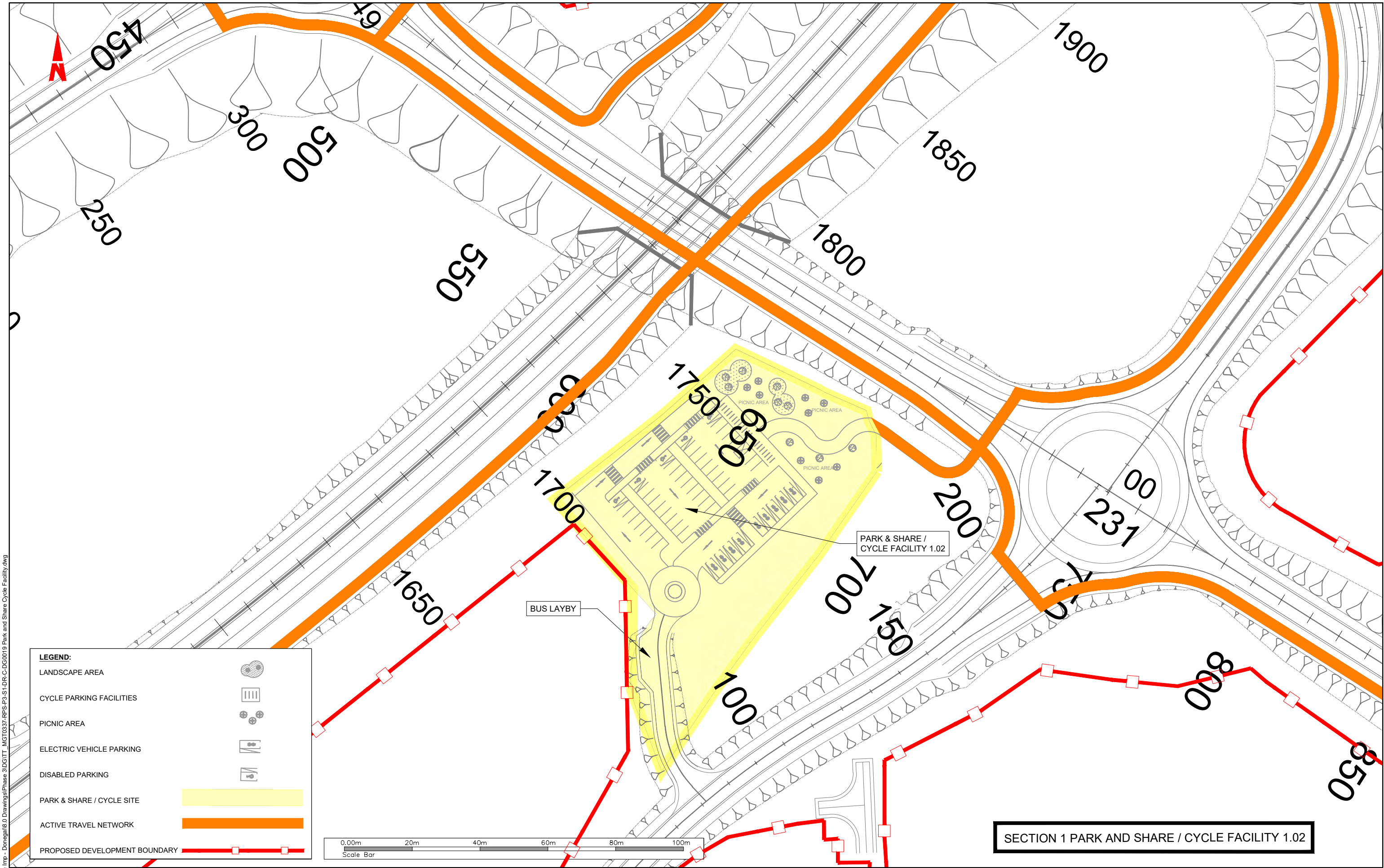

LEGEND:

- LANDSCAPE AREA
- CYCLE PARKING FACILITIES
- PICNIC AREA
- ELECTRIC VEHICLE PARKING
- DISABLED PARKING
- PARK & SHARE / CYCLE SITE
- ACTIVE TRAVEL NETWORK
- PROPOSED DEVELOPMENT BOUNDARY

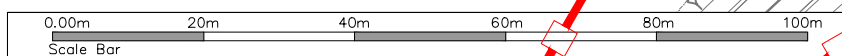

SECTION 1 PARK AND SHARE / CYCLE FACILITY 1.02

T:\MGT0337 - Ten-T Priority Route Imp - Donegal\8.0 Drawings\Phase 3\DGTT_MGT0337-RPS-P3-S1-DR-C-DG0019 Park and Share Cycle Facility.dwg

NOTES
 DO NOT SCALE, use figured dimensions only.
 All levels are referred to Ordnance Survey Datum, Malin Head.
 This drawing is the property of the Donegal County Council. It is a confidential document and must not be copied, used, or its contents divulged without prior written consent. This document should not be relied on or used in circumstances other than those for which it was originally prepared. RPS / Barry Transportation accepts no responsibility for this document to any other party other than the party by whom it was commissioned.

Rev.	Date	Drawn	Description	Chk'd	Appr.
P01	28.10.25	DL	ISSUE FOR PLANNING	MC	EC

Project Title: TEN-T Priority Route Improvement Project, Donegal Section 1 - N15/N13 Ballybofey / Stranorlar Urban Region		Status: A3
Drawing Title: PARK AND SHARE / CYCLE FACILITY PLAN		Rev: P01
Designed: SS	Date: OCT 2025	EIAR Drawing Identifier: EIA DRAWING 4.50
Drawn: DL	Scale @ A1: 1:500	File Identifier: TT_MGT0337-RPS-P3-S1-DR-C-DG0019
Approved: EC	@ A3: 1:1000	
Checked: MC	Sheet: 03 of 04	

SECTION 1 PARK AND SHARE / CYCLE FACILITY 1.03

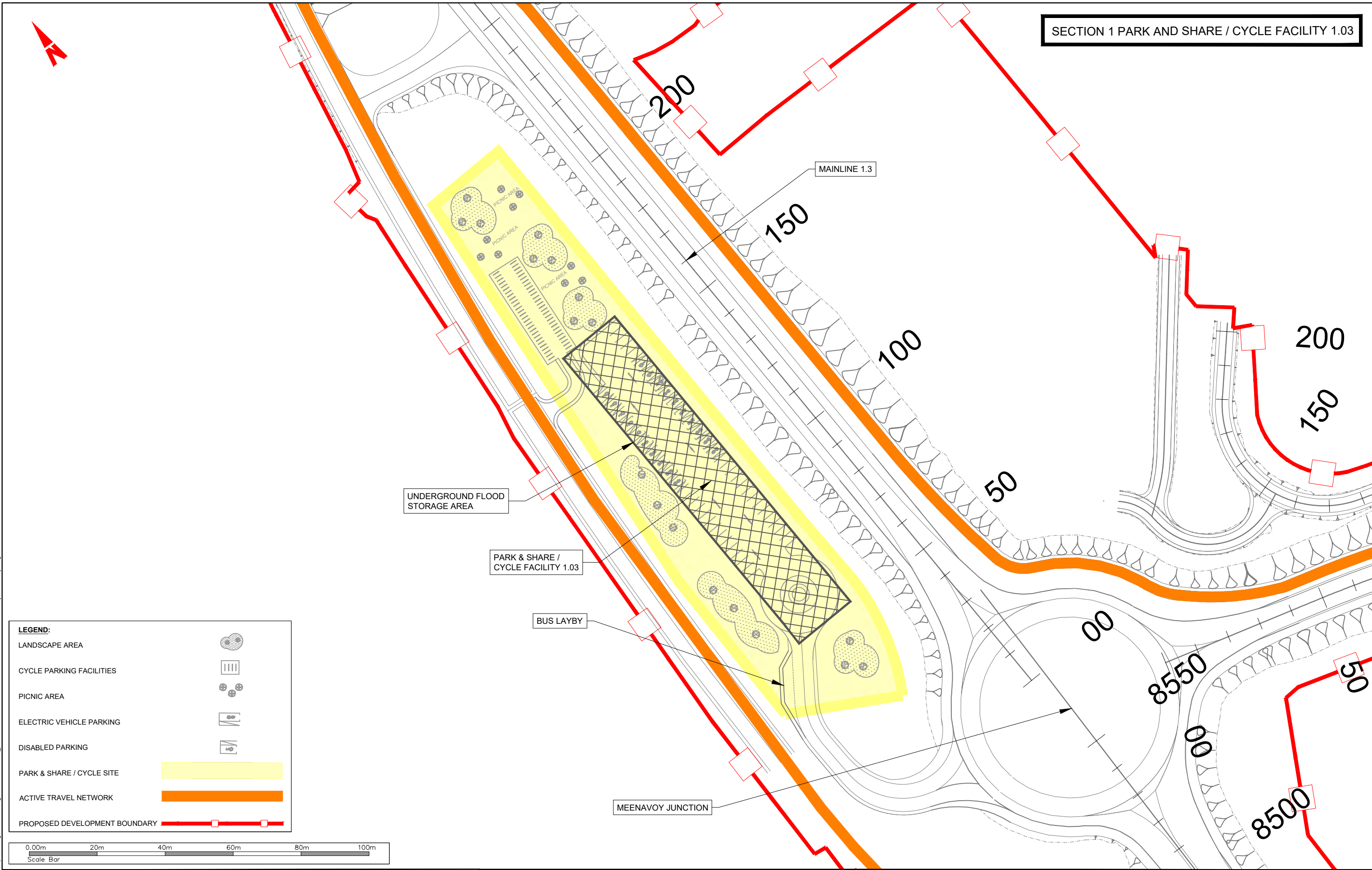

LEGEND:

- LANDSCAPE AREA
- CYCLE PARKING FACILITIES
- PICNIC AREA
- ELECTRIC VEHICLE PARKING
- DISABLED PARKING
- PARK & SHARE / CYCLE SITE
- ACTIVE TRAVEL NETWORK
- PROPOSED DEVELOPMENT BOUNDARY



T:\MGT0337 - Ten-T Priority Route Imp - Donegal\8.0 Drawings\Phase 3\DGTT_MGT0337-RPS-P3-S1-DR-C-DG0019 Park and Share Cycle Facility.dwg

Rialtas na hÉireann
Government of Ireland
2040

Comhairle Contae
Dhún na nGall
Donegal County Council

NOTES
DO NOT SCALE, use figured dimensions only.
All levels are referred to Ordnance Survey Datum, Malin Head.
This drawing is the property of the Donegal County Council. It is a confidential document and must not be copied, used, or its contents divulged without prior written consent. This document should not be relied on or used in circumstances other than those for which it was originally prepared. RPS / Barry Transportation accepts no responsibility for this document to any other party other than the party by whom it was commissioned.

Rev.	Date	Drawn	Description	Chk'd	Appr.
P01	28.10.25	DL	ISSUE FOR PLANNING	MC	EC

Project Title: TEN-T Priority Route Improvement Project, Donegal Section 1 - N15/N13 Ballybofey / Stranorlar Urban Region		Status: A3
Drawing Title: PARK AND SHARE / CYCLE FACILITY PLAN		Rev: P01
Designed: SS	Date: OCT 2025	EIAR Drawing Identifier: EIA1R DRAWING 4.50
Drawn: DL	Scale @ A1: 1:500	File Identifier: TT_MGT0337-RPS-P3-S1-DR-C-DG0019
Approved: EC	@ A3: 1:1000	
Checked: MC	Sheet: 04 of 04	