

SECTION 3 PARK AND SHARE/CYCLE FACILITY 3.02

SECTION 3 PARK AND SHARE/CYCLE FACILITY 3.01

SECTION 3 PARK AND SHARE/CYCLE FACILITY 3.03

SECTION 3 PARK AND SHARE/CYCLE FACILITY 3.04

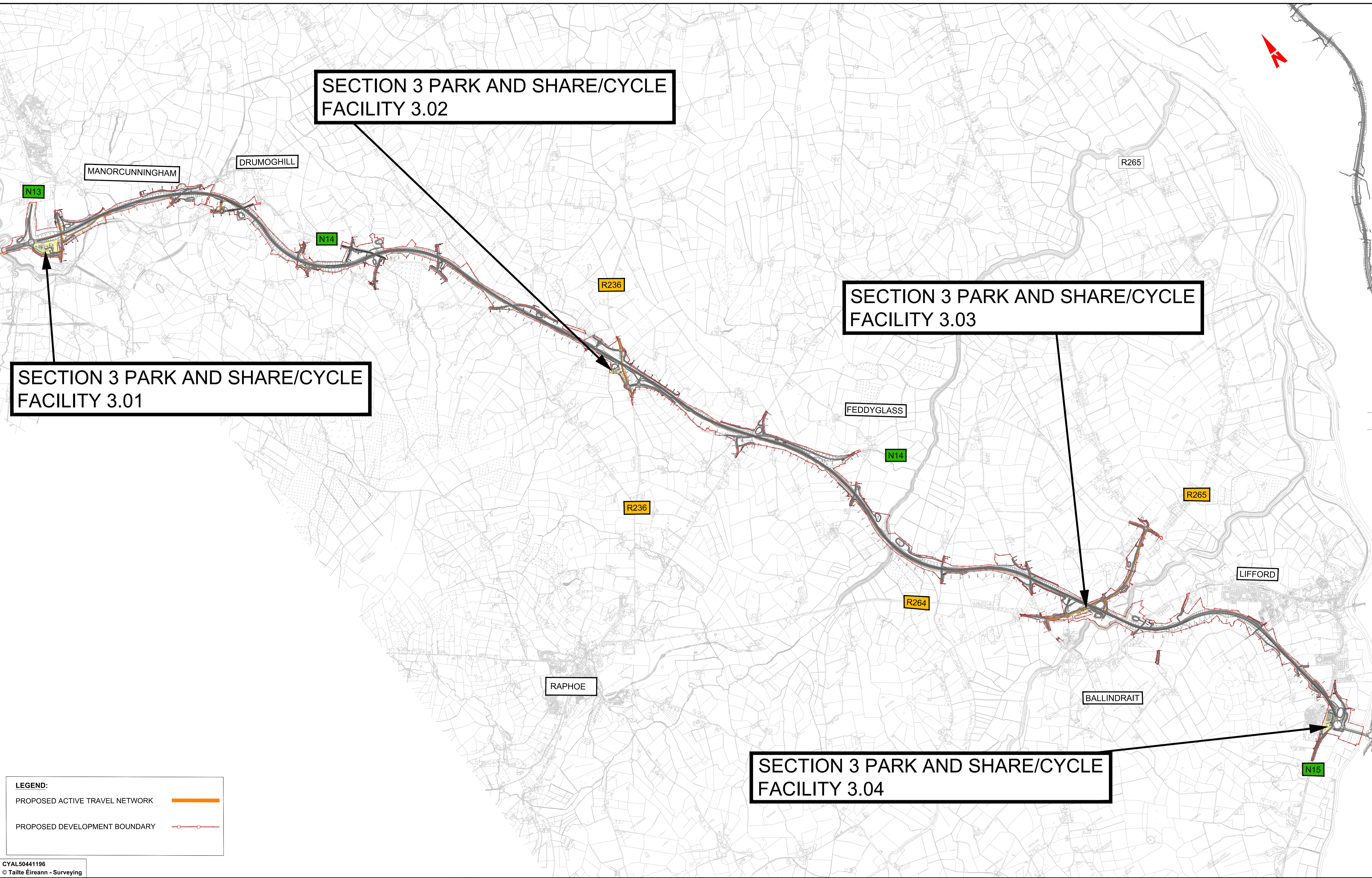

LEGEND:

PROPOSED ACTIVE TRAVEL NETWORK —

PROPOSED DEVELOPMENT BOUNDARY - - -

CYAL50441196
© Tailte Éireann - Surveying

Notes
DO NOT SCALE. Use figured dimensions only. All levels are referred to Ordnance Survey Datum, Mean Head.
This drawing is the property of Donegal County Council. It is a confidential document and must not be copied, used, or its contents divulged without prior written consent. This document should not be relied on or used in circumstances other than those for which it was originally prepared. Barry Transportation accepts no responsibility for this document to any other party other than the party by whom it was commissioned.

Rev.	Date	Drawn	Description	Chk'd	Appr.
P01	18.12.25	MG	ISSUE FOR PLANNING	JMM	ED

Project Title: TEN-T PRIORITY ROUTE IMPROVEMENT PROJECT DONEGAL
Section 3 - N14 Manorcunningham to Lifford/ Strabane / A5 Link

Drawing Title: Park and Share/Cycle Facility Location Plan

Designed: JMM Date: DEC 2025 EIA Drawing Identifier: EIA Drawing 4.52
 Drawn: MG Scale @ A1: 1:40000 @ A3: 1:80000 File Identifier: TT_Y16112-BT-1A-HKF-S3-DR-Z-11042
 Approved: ED Checked: JMM Sheet: 1 of 5

Status: A3
Rev: P01

legis.racine.localbu_mens\BIB\0_P\Projects\Donegal\Projects\Halcrow\Barry\16 Projects\Y16112 - TEN-T Priority Route Improvement Project Donegal\Civil\CAD\WIP\Prelim Design\CIV\DWG\ITTT_Y16112-BT-1A-HKF-S3-DR-Z-11042_NMU_Facilities.dwg

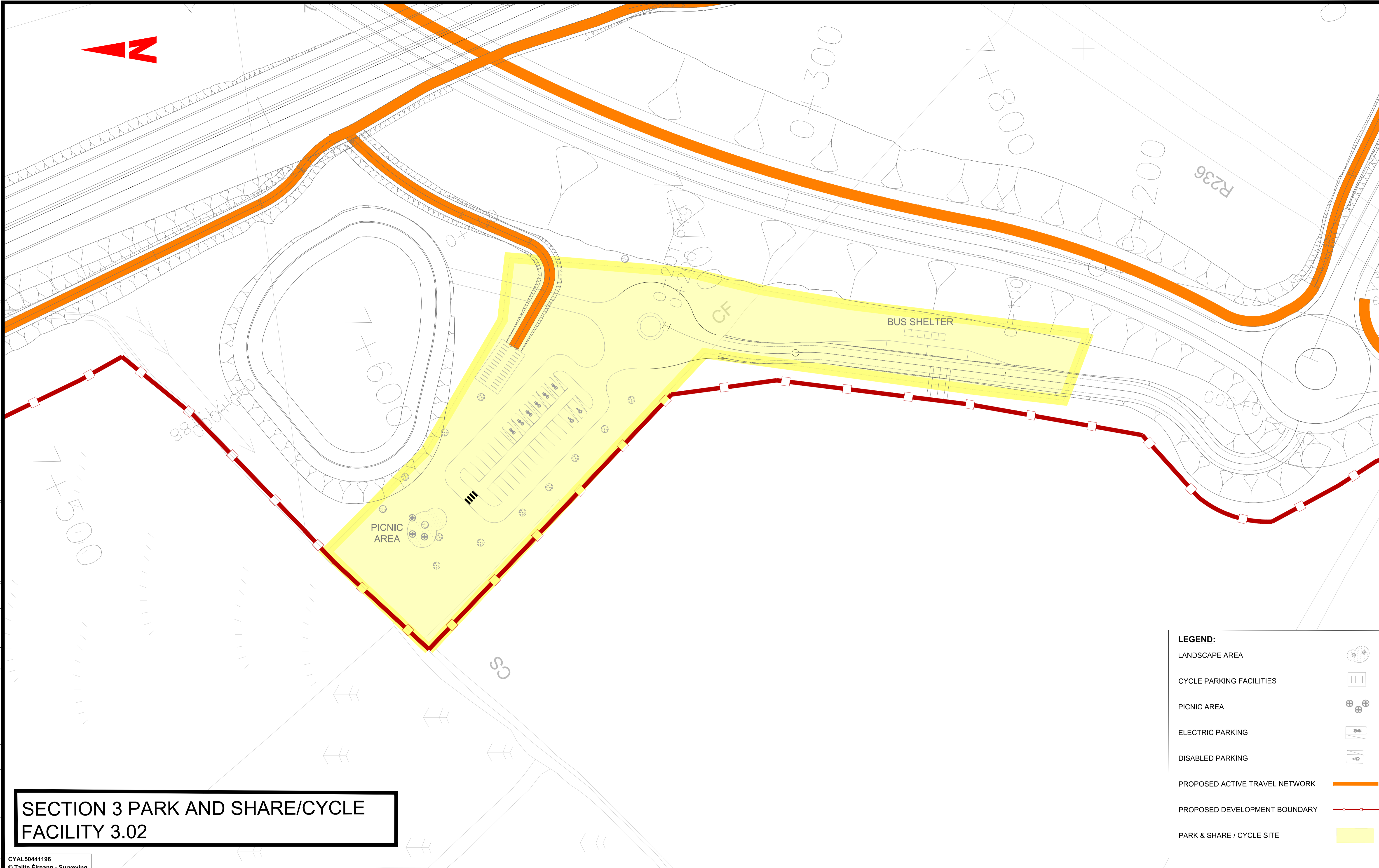
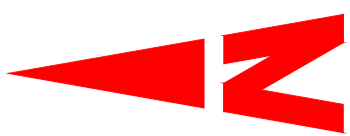

SECTION 3 PARK AND SHARE/CYCLE FACILITY 3.02

LEGEND:

- LANDSCAPE AREA
- CYCLE PARKING FACILITIES
- PICNIC AREA
- ELECTRIC PARKING
- DISABLED PARKING
- PROPOSED ACTIVE TRAVEL NETWORK
- PROPOSED DEVELOPMENT BOUNDARY
- PARK & SHARE / CYCLE SITE

CYAL50441196
© Talite Éireann - Surveying

TIONSCADAL ÉIREANN
Project Ireland 2040

Donegal
NRO
Comhairle Contae Dhún na nGall
Donegal County Council

RPS BARRY
TRANSPORTATION

Notes
DO NOT SCALE, use figured dimensions only. All levels are referred to Ordnance Survey Datum, Mean Head.
This drawing is the property of Donegal County Council. It is a confidential document and must not be copied, used, or its contents divulged without prior written consent. This document should not be relied on or used in circumstances other than those for which it was originally prepared. Barry Transportation accepts no responsibility for this document to any other party other than the party by whom it was commissioned.

Rev.	Date	Drawn	Description	Chk'd	Appr.
P01	18.12.25	MG	ISSUE FOR PLANNING	JMM	ED

Project Title: TEN-T PRIORITY ROUTE IMPROVEMENT PROJECT DONEGAL Section 3 - N14 Manorcunningham to Lifford/ Strabane / A5 Link			Status:
Drawing Title: Park and Share/Cycle Facility 2			A3
Designed: JMM	Date: DEC 2025	EIAR Drawing Identifier:	Rev:
Drawn: MG	Scale @ A1: 1:500	EIAR Drawing 4.52	P01
Approved: ED	@ A3: 1:1000	File Identifier:	
Checked: JMM	Sheet: 3 of 5	TT_Y16112-BT-1A-HKF-S3-DR-Z-11042	

Vegis.racine.localbu_mens\BBS\01_P\Projects\Donegal\Projects\Halcrow\Barr\Y16_P\Projects\Y16112 - TEN-T Priority Route Improvement Project Donegal\Civil\DWG\Set\TT_Y16112-BT-1A-HKF-S3-DR-Z-11042_NMU_Facilities.dwg

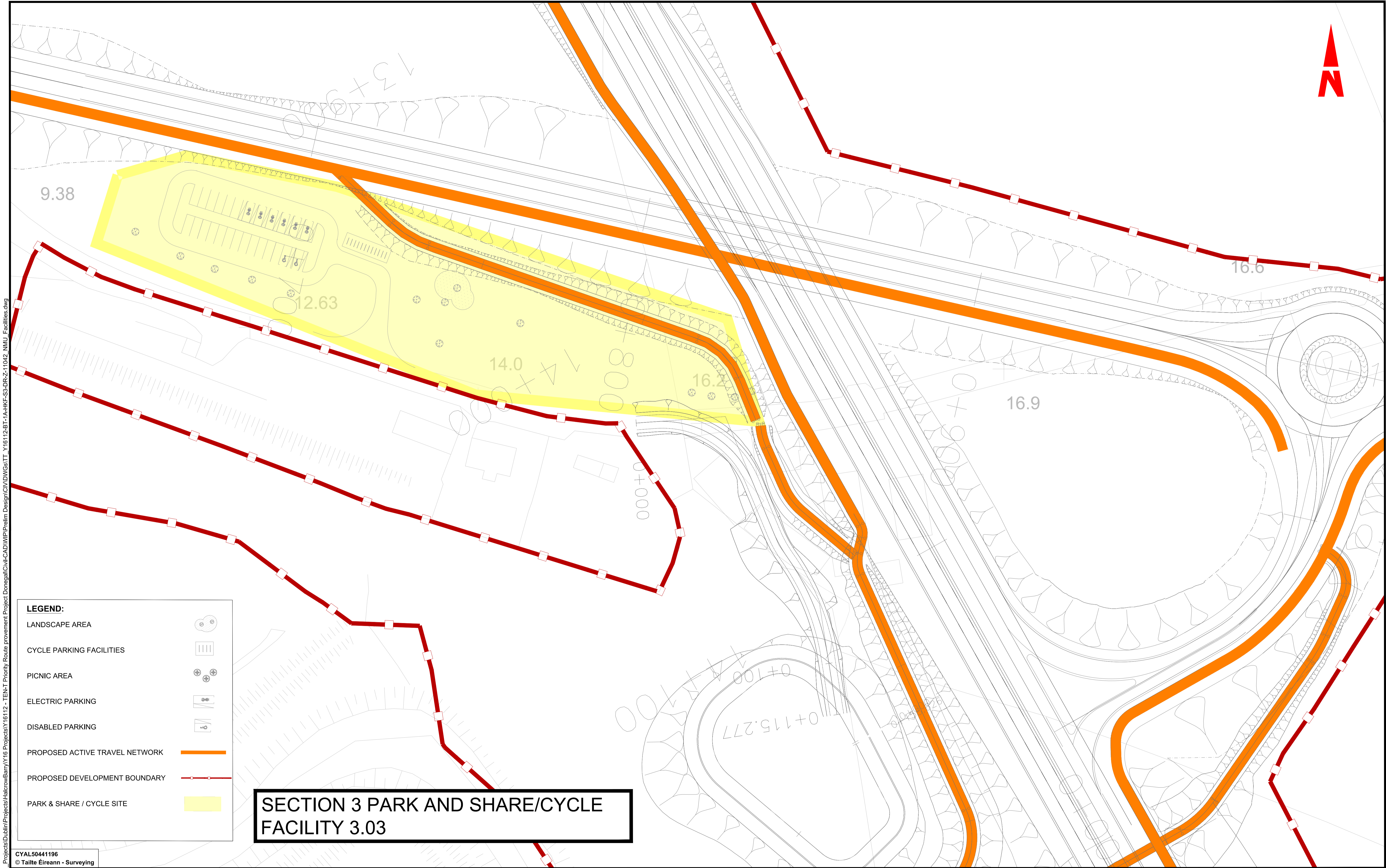

LEGEND:

LANDSCAPE AREA	
CYCLE PARKING FACILITIES	
PICNIC AREA	
ELECTRIC PARKING	
DISABLED PARKING	
PROPOSED ACTIVE TRAVEL NETWORK	
PROPOSED DEVELOPMENT BOUNDARY	
PARK & SHARE / CYCLE SITE	

SECTION 3 PARK AND SHARE/CYCLE FACILITY 3.03

CYAL50441196
© Tailte Éireann - Surveying



Notes
DO NOT SCALE. Use figured dimensions only. All levels are referred to Ordnance Survey Datum, Mean Head.
This drawing is the property of Donegal County Council. It is a confidential document and must not be copied, used, or its contents divulged without prior written consent. This document should not be relied on or used in circumstances other than those for which it was originally prepared. Barry Transportation accepts no responsibility for this document to any other party other than the party by whom it was commissioned.

Rev.	Date	Drawn	Description	Chk'd	Appr.
P01	18.12.25	MG	ISSUE FOR PLANNING	JMM	ED

Project Title: TEN-T PRIORITY ROUTE IMPROVEMENT PROJECT DONEGAL Section 3 - N14 Manorcunningham to Lifford/ Strabane / A5 Link		
Drawing Title: Park and Share / Cycle Facility 3		Status: A3
Designed: JMM	Date: DEC 2025	EIAR Drawing Identifier:
Drawn: MG	Scale @ A1: 1:500	EIAR Drawing 4.52
Approved: ED	@ A3: 1:1000	File Identifier:
Checked: JMM	Sheet: 4 of 5	TT_Y16112-BT-1A-HKF-S3-DR-Z-11042
Rev:	P01	

Vegis.racine.localbu_mens\BIB\0 - Projects\Dublin\Projects\Halcrow\Barry\16 Projects\Y16112 - TEN-T Priority Route Improvement Project Donegal\Civil-CAD\WIP\Preim Design\CIV\DWG\Set\TT_Y16112-BT-1A-HKF-S3-DR-Z-11042 - NMU_Facilities.dwg

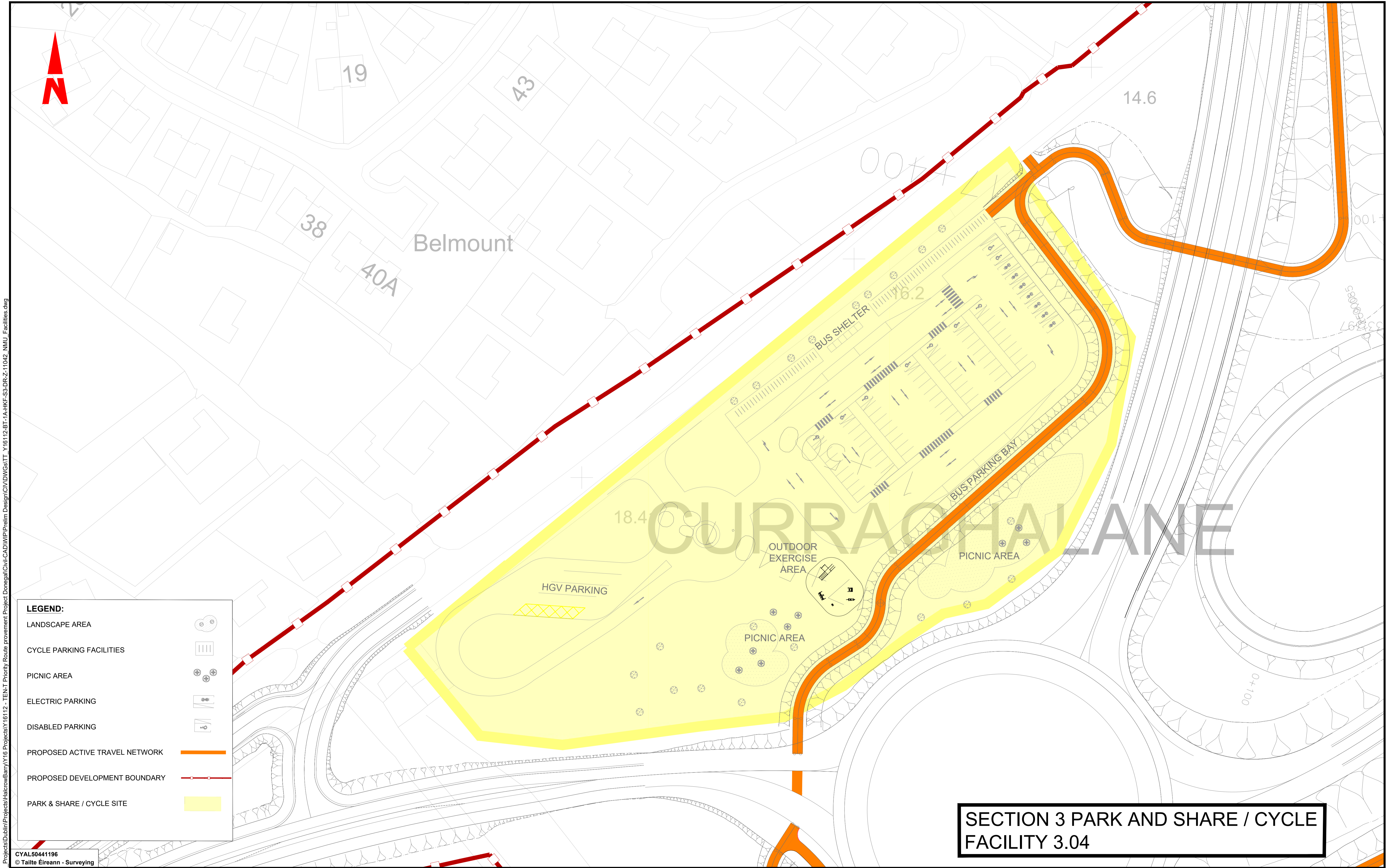

LEGEND:

LANDSCAPE AREA	
CYCLE PARKING FACILITIES	
PICNIC AREA	
ELECTRIC PARKING	
DISABLED PARKING	
PROPOSED ACTIVE TRAVEL NETWORK	
PROPOSED DEVELOPMENT BOUNDARY	
PARK & SHARE / CYCLE SITE	

SECTION 3 PARK AND SHARE / CYCLE FACILITY 3.04

CYAL50441196
© Taitte Éireann - Surveying



Notes
DO NOT SCALE. Use figured dimensions only. All levels are referred to Ordnance Survey Datum, Mean Head.
This drawing is the property of Donegal County Council. It is a confidential document and must not be copied, used, or its contents divulged without prior written consent. This document should not be relied on or used in circumstances other than those for which it was originally prepared. Barry Transportation accepts no responsibility for this document to any other party other than the party by whom it was commissioned.

Rev.	Date	Drawn	Description	Chk'd	Appr.
P01	18.12.25	MG	ISSUE FOR PLANNING	JMM	ED

Project Title: TEN-T PRIORITY ROUTE IMPROVEMENT PROJECT DONEGAL Section 3 - N14 Manorcunningham to Lifford/ Strabane / A5 Link		
Drawing Title: Park and Share / Cycle Facility 4		Status: A3
Designed: JMM	Date: DEC 2025	EIAR Drawing Identifier:
Drawn: MG	Scale @ A1: 1:500	EIAR Drawing 4.52
Approved: ED	@ A3: 1:1000	File Identifier:
Checked: JMM	Sheet: 5 of 5	TT_Y16112-BT-1A-HKF-S3-DR-Z-11042

Legis.racine.local\bu_mens\BIB\0 - Projects\Dublin\Projects\Halcrow\Barry\16 Projects\Y16112 - TEN-T Priority Route Improvement Project Donegal\Civil\CAD\WIP\Preim Design\CIV\DWG\GatTT_Y16112-BT-1A-HKF-S3-DR-Z-11042 - NMU - Facilities.dwg