

\legis\racine\local\bu_mens\BIB\01_P\Projects\Dublin\Projects\Halcrow\Bary\16 Projects\Y16112-BT-1A-SBR-S3-DR-S-17503.dwg

- NOTES:**
- LEVELS IN METERS TO MALIN HEAD
 - CO-ORDINATES TO IRISH TRANSVERSE MERCATOR (ITM)
- LEGEND:**
- C.P.O. BOUNDARY —
 - SPECIAL AREA OR CONSERVATION BOUNDARY (S.A.C.) - - -

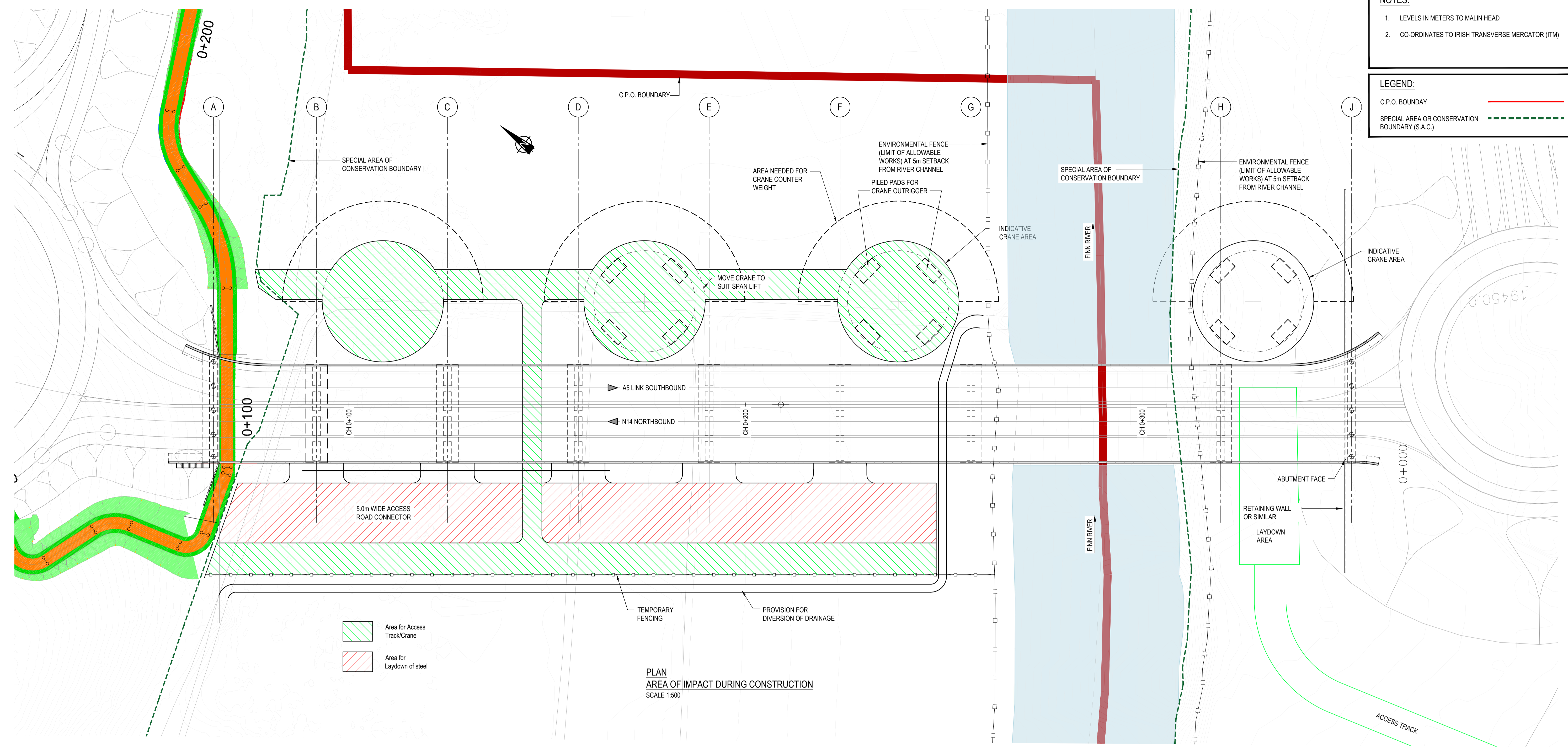

PLAN
AREA OF IMPACT DURING CONSTRUCTION
SCALE 1:500

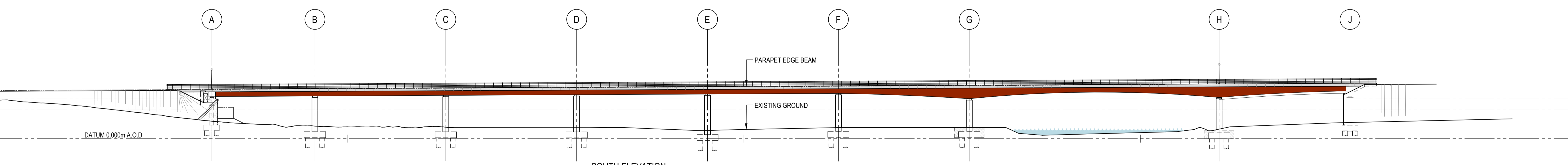

SOUTH ELEVATION
STAGE 11 - REMOVE HAULAGE ROUTE, CONSTRUCT WING WALLS, PARAPET UPSTANDS AND FINISHES
SCALE 1:500

CYAL50419116
© Talte Éireann - Surveying

Notes
DO NOT SCALE, use figured dimensions only. All levels are referred to Ordnance Survey Datum, Malin Head.
This drawing is the property of Donegal County Council. It is a confidential document and must not be copied, used, or its contents divulged without prior written consent. This document should not be relied on or used in circumstances other than those for which it was originally prepared. Barry Transportation accepts no responsibility for this document to any other party other than the party by whom it was commissioned.

Rev.	Date	Drawn	Description	Chk'd	Appr.
P01	01/12/25	WS	ISSUE FOR PLANNING	MB	WL

Project Title: TEN-T Priority Route Improvement Project, Donegal		Status: A3	
Section 3 - N14 Manorcunningham to Lifford/Strabane/A5 Link		Rev: P01	
Drawing Title: N14-N15 TO A5 LINK - RIVER FINN CROSSING (REF N14R175) CONSTRUCTIVE METHOD			
Designed: MB	Date: December 2025	NIS Drawing Identifier: NIS Drawing 25	
Drawn: WS	Scale @ A1: AS SHOWN	File Identifier: TT_Y16112-BT-1A-SBR-S3-DR-S-17503	
Approved: WL	@ A3: AS SHOWN		
Checked: MB	Sheet:		