

\regis\racine\local\bu_mens\UBB\0 - Projects\Dublin\Projects\Halcrow\Barry\16 Projects\Y16112 - TEN-T Priority Route Improvement Project Donegal\Civil-CAD\WIP\Preim Design\CIV\DWG\ATT_Y16112-BT-1A-HDR-S3-DR-CD-05120_Drainage.dwg

CYAL50419116
© Taite Éireann - Surveying

- LEGEND**
- PROPOSED DEVELOPMENT BOUNDARY
 - INFILTRATION BASIN / ATTENUATION POND
 - CROSS DRAIN
 - ▶▶▶▶▶ SURFACE WATER CHANNEL COLLECTION NETWORK
 - ▶▶▶▶▶ OPEN DRAIN (USED AS CUT OFF DRAIN)
 - CULVERT
 - INFILTRATION TRENCHES
 - ▶▶▶▶▶ CARRIER PIPE
 - ▶▶▶▶▶ FILTER DRAIN
 - ▶▶▶▶▶ KERBING DRAINAGE (KERBS AND GULLIES OR DRAINAGE KERB BLOCKS)
 - ▶▶▶▶▶ WATERCOURSE DIVERSION
 - FLOOD COMPENSATION AREAS



Notes
 DO NOT SCALE. Use figured dimensions only. All levels are referred to Ordnance Survey Datum, Main Head.
 This drawing is the property of Donegal County Council. It is a confidential document and must not be copied, used, or its contents divulged without prior written consent. This document should not be relied on or used in circumstances other than those for which it was originally prepared. Barry Transportation accepts no responsibility for this document to any other party other than the party by whom it was commissioned.

Rev.	Date	Drawn	Description	Chk'd	Appr.
P01	17.11.25	MG	ISSUE FOR PLANNING	JMM	ED

Project Title: TEN-T PRIORITY ROUTE IMPROVEMENT PROJECT DONEGAL Section 3 - N14 Manorcunningham to Lifford/Strabane/A5 Link		Status: A3	
Drawing Title: Proposed Drainage Layout		Rev: P01	
Designed: JMM	Date: NOV 2025	NIS Drawing Identifier:	
Drawn: MG	Scale @ A1: 1:2500	NIS Drawing 35	
Approved: ED	@ A3: 1:5000	File Identifier:	
Checked: JMM	Sheet: 1 OF 10	TT_Y16112-BT-1A-HDR-S3-DR-CD-05120	

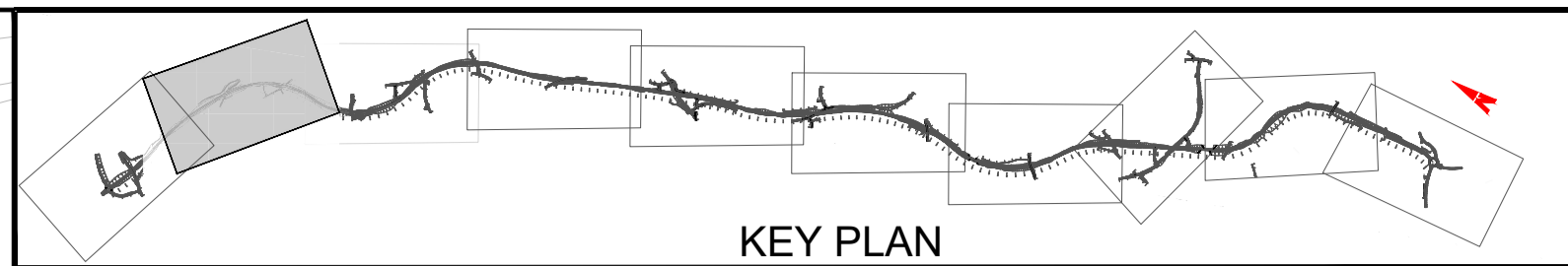
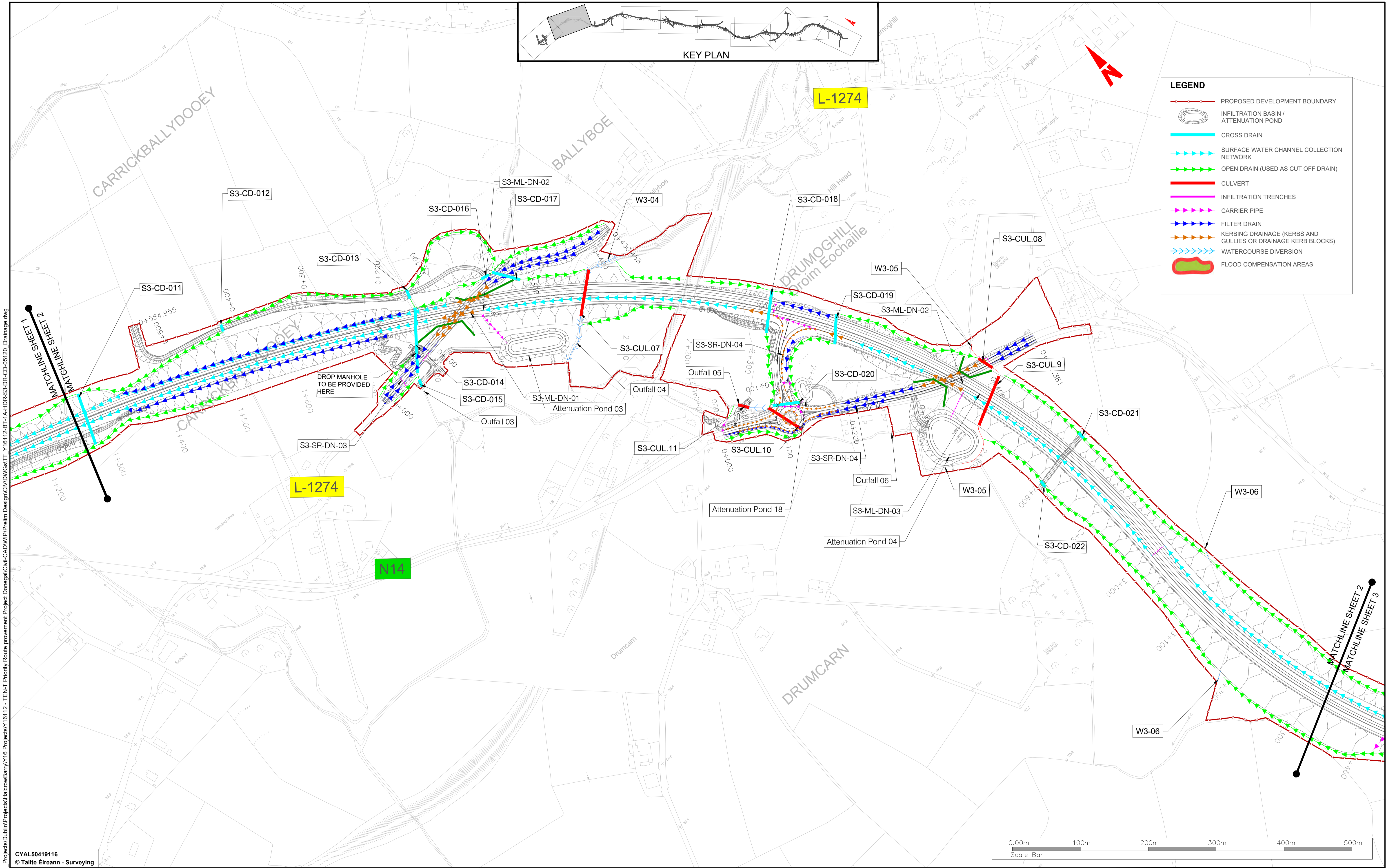

- LEGEND**
- PROPOSED DEVELOPMENT BOUNDARY
 - INFILTRATION BASIN / ATTENUATION POND
 - CROSS DRAIN
 - ▶▶▶▶ SURFACE WATER CHANNEL COLLECTION NETWORK
 - ▶▶▶▶ OPEN DRAIN (USED AS CUT OFF DRAIN)
 - CULVERT
 - INFILTRATION TRENCHES
 - ▶▶▶▶ CARRIER PIPE
 - ▶▶▶▶ FILTER DRAIN
 - ▶▶▶▶ KERBING DRAINAGE (KERBS AND GULLIES OR DRAINAGE KERB BLOCKS)
 - ▶▶▶▶ WATERCOURSE DIVERSION
 - FLOOD COMPENSATION AREAS

CYAL50419116 © Taitte Éireann - Surveying

CYAL50419116
© Taitte Éireann - Surveying



Notes
DO NOT SCALE. Use figured dimensions only. All levels are referred to Ordnance Survey Datum, Main Head.
This drawing is the property of Donegal County Council. It is a confidential document and must not be copied, used, or its contents divulged without prior written consent. This document should not be relied on or used in circumstances other than those for which it was originally prepared. Barry Transportation accepts no responsibility for this document to any other party other than the party by whom it was commissioned.

Rev.	Date	Drawn	Description	Chk'd	Appr.
P01	17.11.25	MG	ISSUE FOR PLANNING	JMM	ED

Project Title: TEN-T PRIORITY ROUTE IMPROVEMENT PROJECT DONEGAL Section 3 - N14 Manorcunningham to Lifford/Strabane/A5 Link		Status: A3	
Drawing Title: Proposed Drainage Layout		Rev: P01	
Designed: JMM	Date: NOV 2025	NIS Drawing Identifier:	
Drawn: MG	Scale @ A1: 1:2500	NIS Drawing 35	
Approved: ED	@ A3: 1:5000	File Identifier:	
Checked: JMM	Sheet: 2 OF 10	TT_Y16112-BT-1A-HDR-S3-DR-CD-05120	

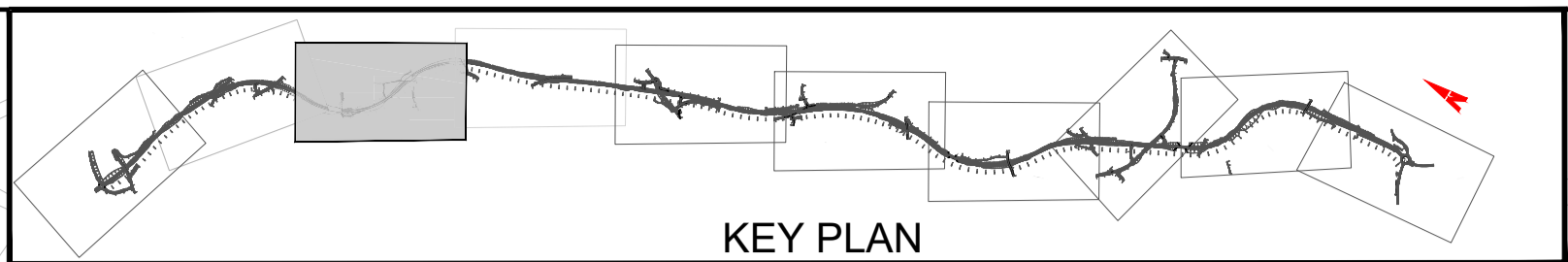
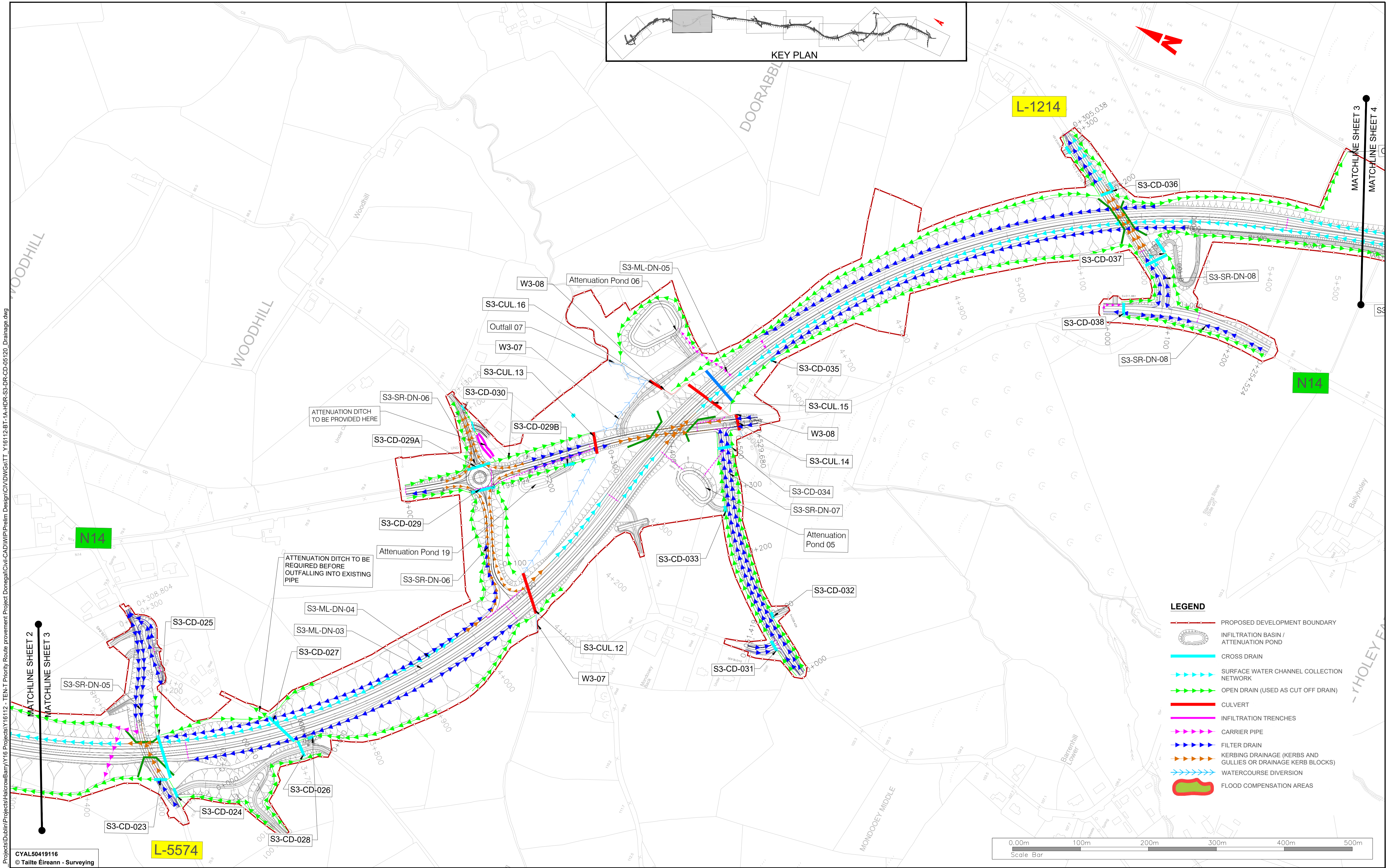

- LEGEND**
- PROPOSED DEVELOPMENT BOUNDARY
 - INFILTRATION BASIN / ATTENUATION POND
 - CROSS DRAIN
 - ▶▶▶▶▶ SURFACE WATER CHANNEL COLLECTION NETWORK
 - ▶▶▶▶▶ OPEN DRAIN (USED AS CUT OFF DRAIN)
 - CULVERT
 - ▶▶▶▶▶ INFILTRATION TRENCHES
 - ▶▶▶▶▶ CARRIER PIPE
 - ▶▶▶▶▶ FILTER DRAIN
 - ▶▶▶▶▶ KERBING DRAINAGE (KERBS AND GULLIES OR DRAINAGE KERB BLOCKS)
 - ▶▶▶▶▶ WATERCOURSE DIVERSION
 - FLOOD COMPENSATION AREAS

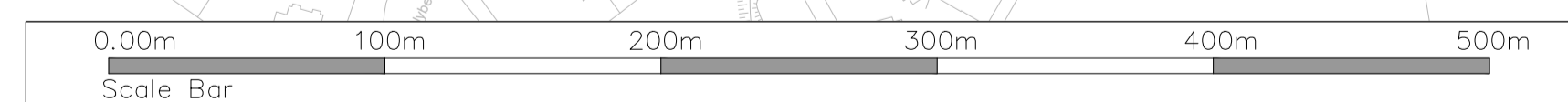

CYAL50419116
© Taitte Éireann - Surveying

Notes
DO NOT SCALE. Use figured dimensions only. All levels are referred to Ordnance Survey Datum, Mean Head.
This drawing is the property of Donegal County Council. It is a confidential document and must not be copied, used, or its contents divulged without prior written consent. This document should not be relied on or used in circumstances other than those for which it was originally prepared. Barry Transportation accepts no responsibility for this document to any other party other than the party by whom it was commissioned.

Rev.	Date	Drawn	Description	Chk'd	Appr.
P01	17.11.25	MG	ISSUE FOR PLANNING	JMM	ED

Project Title: TEN-T PRIORITY ROUTE IMPROVEMENT PROJECT DONEGAL Section 3 - N14 Manorunningham to Lifford/Strabane/A5 Link		Status: A3
Drawing Title: Proposed Drainage Layout		Rev: P01
Designed: JMM	Date: NOV 2025	NIS Drawing Identifier:
Drawn: MG	Scale @ A1: 1:2500	NIS Drawing 35
Approved: ED	@ A3: 1:5000	File Identifier:
Checked: JMM	Sheet: 3 OF 10	TT_Y16112-BT-1A-HDR-S3-DR-CD-05120

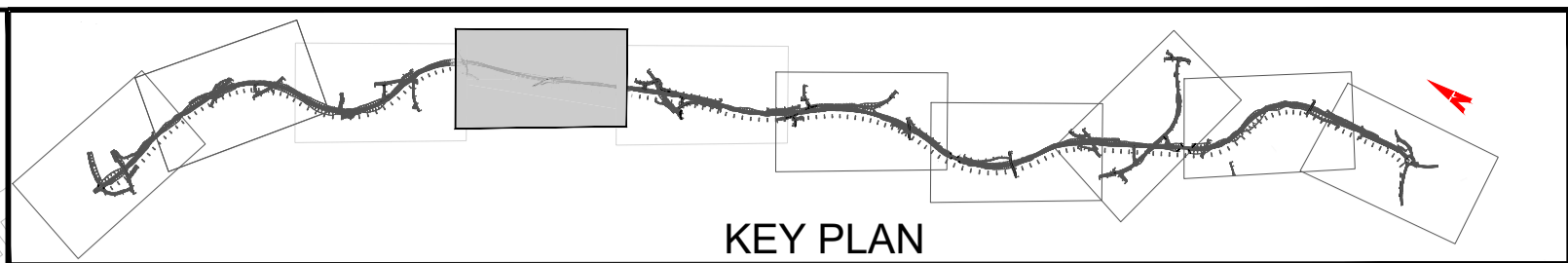
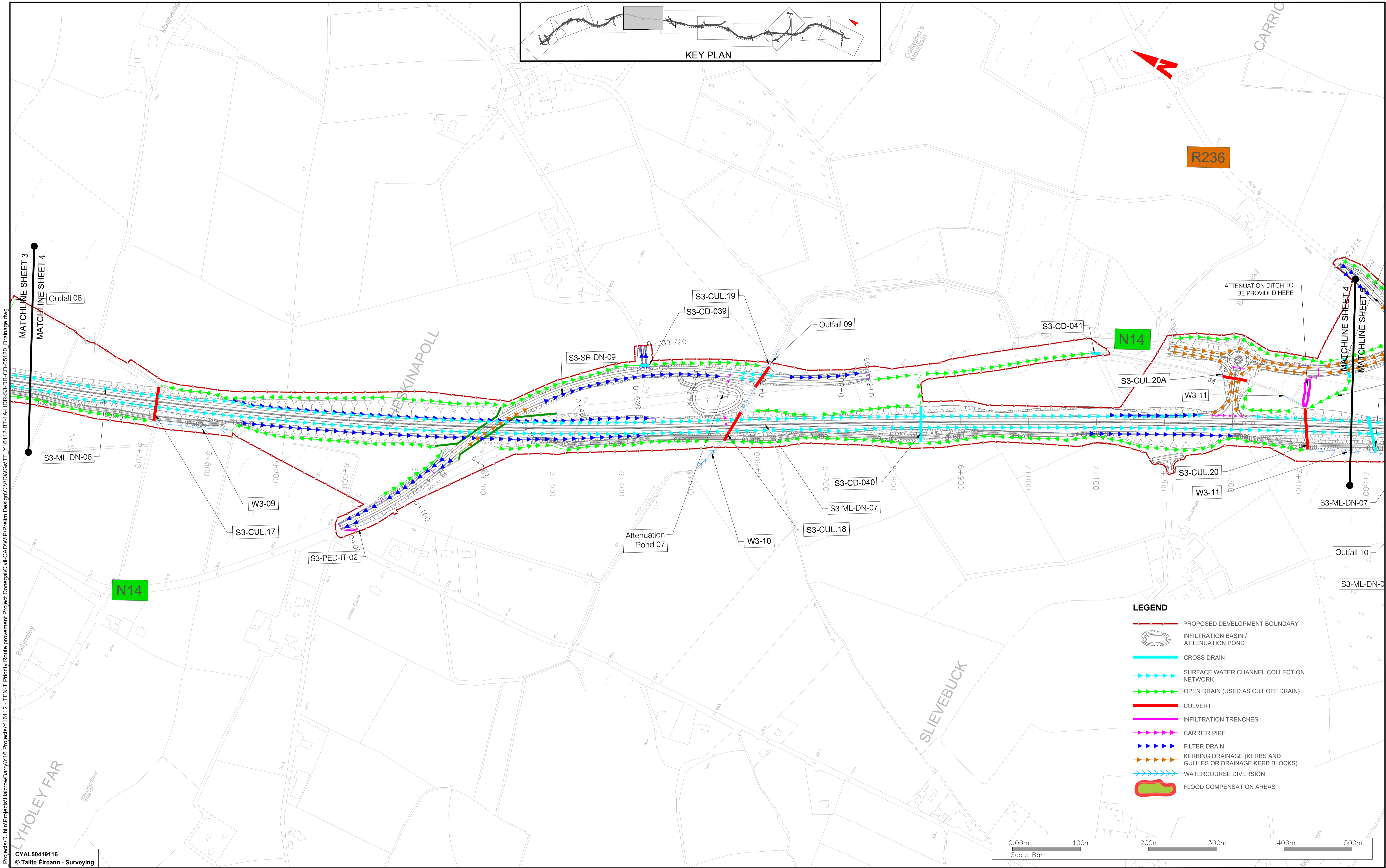

- LEGEND**
- PROPOSED DEVELOPMENT BOUNDARY
 - INFILTRATION BASIN / ATTENUATION POND
 - CROSS DRAIN
 - ▶▶▶▶▶ SURFACE WATER CHANNEL COLLECTION NETWORK
 - ▶▶▶▶▶ OPEN DRAIN (USED AS CUT OFF DRAIN)
 - CULVERT
 - ▶▶▶▶▶ INFILTRATION TRENCHES
 - CARRIER PIPE
 - ▶▶▶▶▶ FILTER DRAIN
 - ▶▶▶▶▶ KERBING DRAINAGE (KERBS AND GULLIES OR DRAINAGE KERB BLOCKS)
 - ▶▶▶▶▶ WATERCOURSE DIVERSION
 - ◻ FLOOD COMPENSATION AREAS

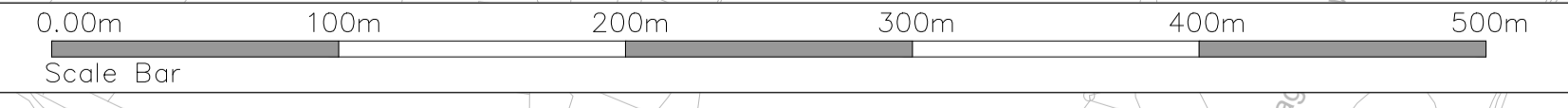

CYAL50419116
© Taite Éireann - Surveying



Notes
DO NOT SCALE. Use figured dimensions only. All levels are referred to Ordnance Survey Datum, Mean Head.
This drawing is the property of Donegal County Council. It is a confidential document and must not be copied, used, or its contents divulged without prior written consent. This document should not be relied on or used in circumstances other than those for which it was originally prepared. Barry Transportation accepts no responsibility for this document to any other party other than the party by whom it was commissioned.

Rev.	Date	Drawn	Description	Chk'd	Appr.
P01	17.11.25	MG	ISSUE FOR PLANNING	JMM	ED

Project Title: TEN-T PRIORITY ROUTE IMPROVEMENT PROJECT DONEGAL Section 3 - N14 Manorunningham to Lifford/Strabane/A5 Link		Status: A3	
Drawing Title: Proposed Drainage Layout		Rev: P01	
Designed: JMM	Date: NOV 2025	NIS Drawing Identifier: NIS Drawing 35	
Drawn: MG	Scale @ A1: 1:2500	File Identifier: TT_Y16112-BT-1A-HDR-S3-DR-CD-05120	
Approved: ED	@ A3: 1:5000		
Checked: JMM	Sheet: 4 OF 10		

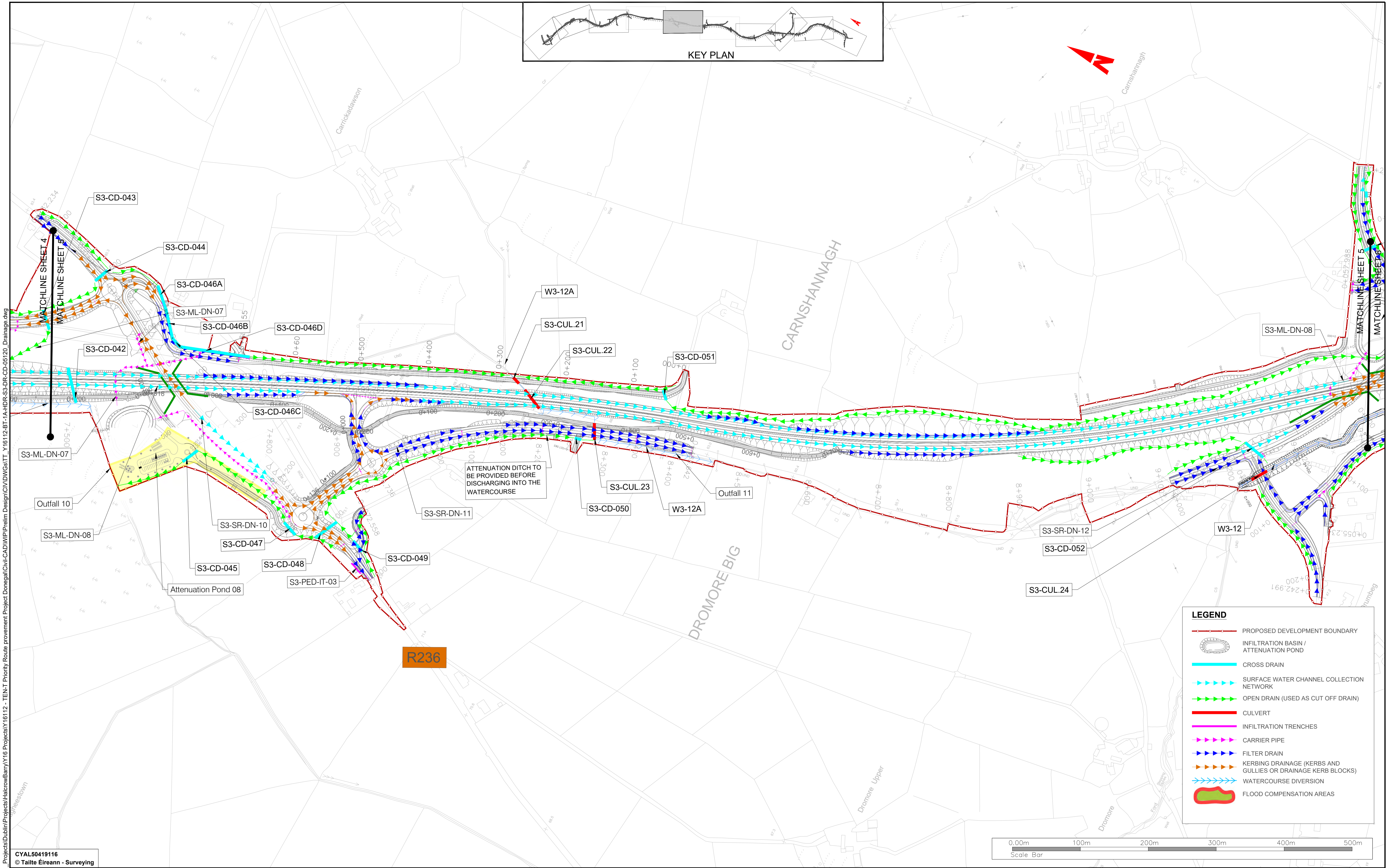
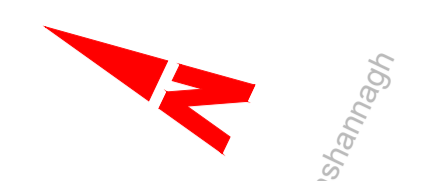
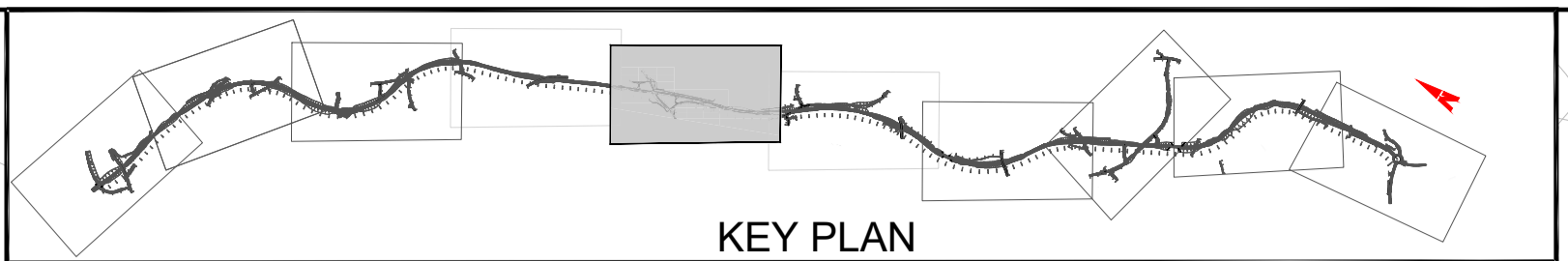

LEGEND

- PROPOSED DEVELOPMENT BOUNDARY
- INFILTRATION BASIN / ATTENUATION POND
- CROSS DRAIN
- SURFACE WATER CHANNEL COLLECTION NETWORK
- OPEN DRAIN (USED AS CUT OFF DRAIN)
- CULVERT
- INFILTRATION TRENCHES
- CARRIER PIPE
- FILTER DRAIN
- KERBING DRAINAGE (KERBS AND GULLIES OR DRAINAGE KERB BLOCKS)
- WATERCOURSE DIVERSION
- FLOOD COMPENSATION AREAS



CYAL50419116
© Taite Éireann - Surveying

Notes
DO NOT SCALE. Use figured dimensions only. All levels are referred to Ordnance Survey Datum, Main Head.
This drawing is the property of Donegal County Council. It is a confidential document and must not be copied, used, or its contents divulged without prior written consent. This document should not be relied on or used in circumstances other than those for which it was originally prepared. Barry Transportation accepts no responsibility for this document to any other party other than the party by whom it was commissioned.

Rev.	Date	Drawn	Description	Chk'd	Appr.
P01	17.11.25	MG	ISSUE FOR PLANNING	JMM	ED

Project Title: TEN-T PRIORITY ROUTE IMPROVEMENT PROJECT DONEGAL
Section 3 - N14 Manorcunningham to Lifford/Strabane/A5 Link

Drawing Title: Proposed Drainage Layout

Designed: JMM **Date:** NOV 2025 **NIS Drawing Identifier:** NIS Drawing 35

Drawn: MG **Scale @ A1:** 1:2500 **File Identifier:** TT_Y16112-BT-1A-HDR-S3-DR-CD-05120

Approved: ED **@ A3:** 1:5000

Checked: JMM **Sheet:** 5 OF 10

Status: A3
Rev: P01

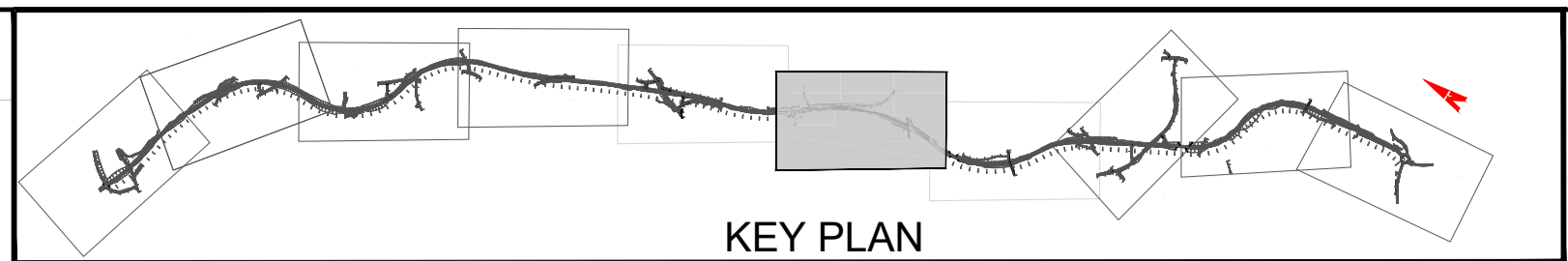
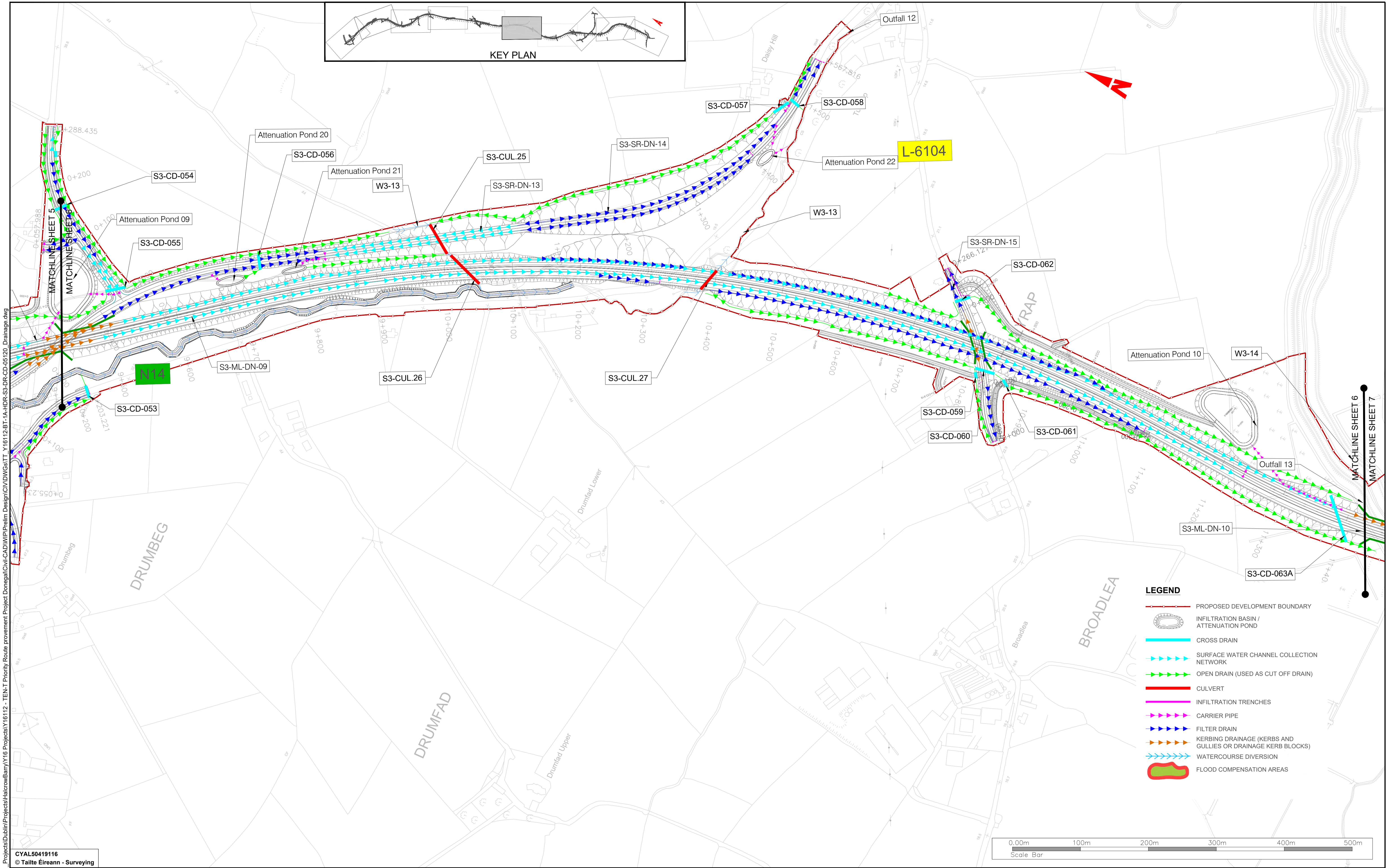

- LEGEND**
- PROPOSED DEVELOPMENT BOUNDARY
 - INFILTRATION BASIN / ATTENUATION POND
 - CROSS DRAIN
 - SURFACE WATER CHANNEL COLLECTION NETWORK
 - OPEN DRAIN (USED AS CUT OFF DRAIN)
 - CULVERT
 - INFILTRATION TRENCHES
 - CARRIER PIPE
 - FILTER DRAIN
 - KERBING DRAINAGE (KERBS AND GULLIES OR DRAINAGE KERB BLOCKS)
 - WATERCOURSE DIVERSION
 - FLOOD COMPENSATION AREAS

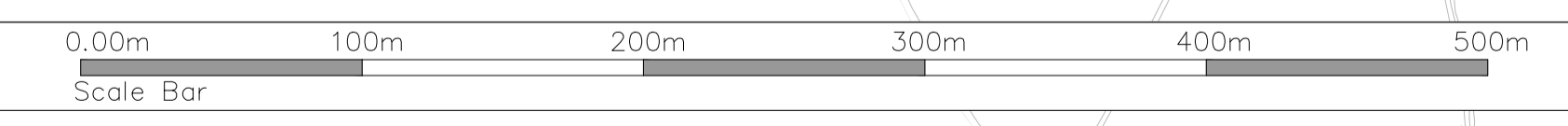

CYAL50419116
© Taitte Éireann - Surveying



Notes
DO NOT SCALE. Use figured dimensions only. All levels are referred to Ordnance Survey Datum, Main Head.
This drawing is the property of Donegal County Council. It is a confidential document and must not be copied, used, or its contents divulged without prior written consent. This document should not be relied on or used in circumstances other than those for which it was originally prepared. Barry Transportation accepts no responsibility for this document to any other party other than the party by whom it was commissioned.

Rev.	Date	Drawn	Description	Chk'd	Appr.
P01	17.11.25	MG	ISSUE FOR PLANNING	JMM	ED

Project Title: TEN-T PRIORITY ROUTE IMPROVEMENT PROJECT DONEGAL		Status: A3	
Section 3 - N14 Manorunningham to Lifford/Strabane/A5 Link		Rev: P01	
Drawing Title: Proposed Drainage Layout			
Designed: JMM	Date: NOV 2025	NIS Drawing Identifier:	
Drawn: MG	Scale @ A1: 1:2500	NIS Drawing 35	
Approved: ED	@ A3: 1:5000	File Identifier:	
Checked: JMM	Sheet: 6 OF 10	TT_Y16112-BT-1A-HDR-S3-DR-CD-05120	

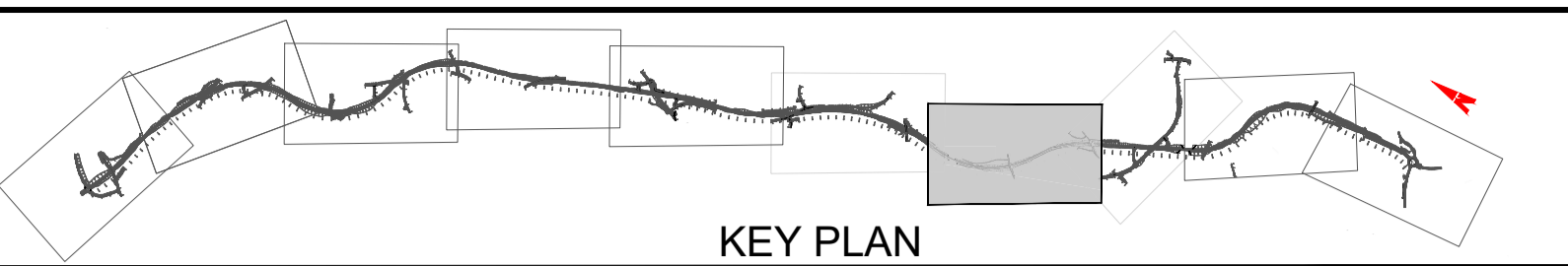
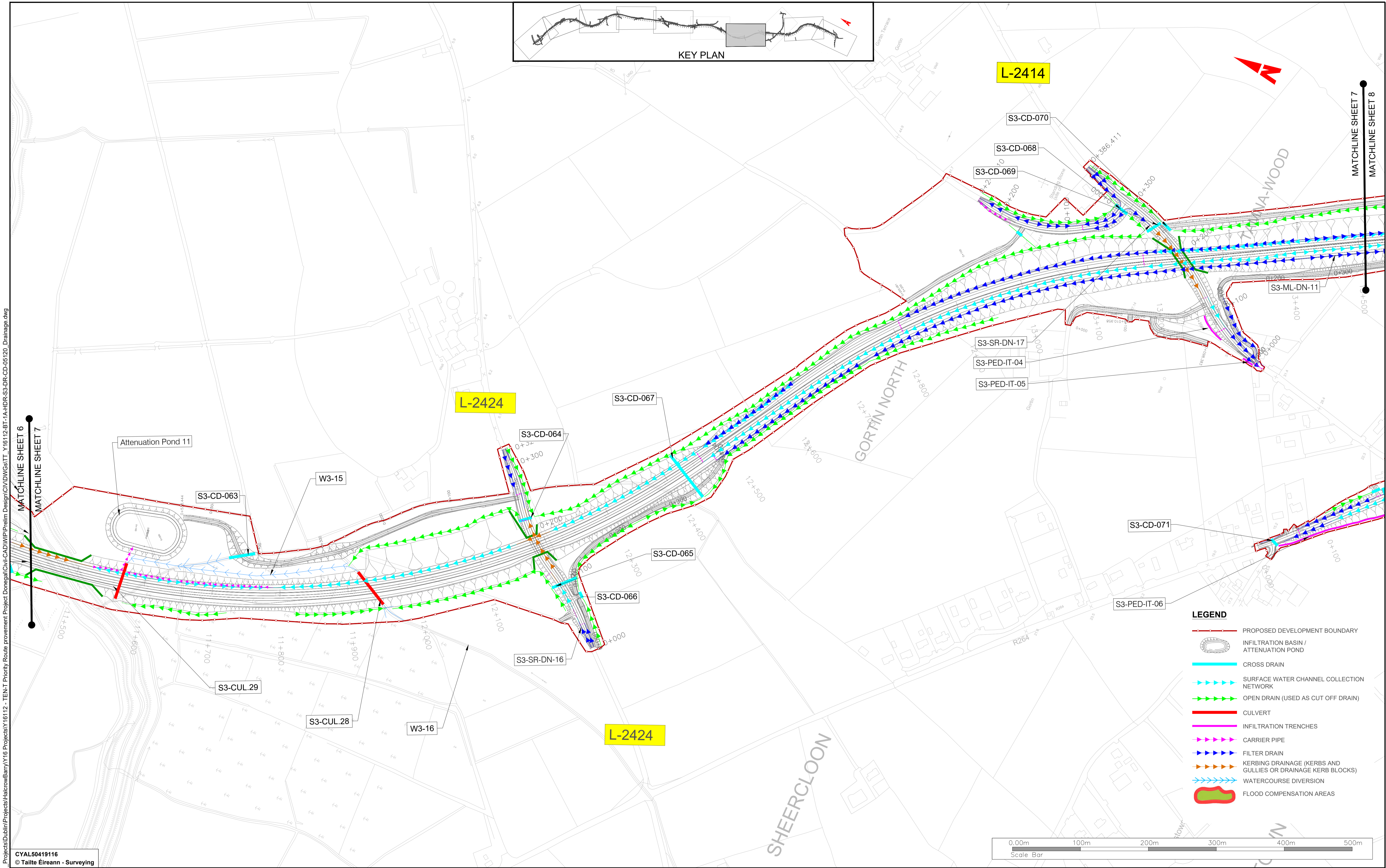

- LEGEND**
- PROPOSED DEVELOPMENT BOUNDARY
 - INFILTRATION BASIN / ATTENUATION POND
 - CROSS DRAIN
 - SURFACE WATER CHANNEL COLLECTION NETWORK
 - OPEN DRAIN (USED AS CUT OFF DRAIN)
 - CULVERT
 - INFILTRATION TRENCHES
 - CARRIER PIPE
 - FILTER DRAIN
 - KERBING DRAINAGE (KERBS AND GULLIES OR DRAINAGE KERB BLOCKS)
 - WATERCOURSE DIVERSION
 - FLOOD COMPENSATION AREAS

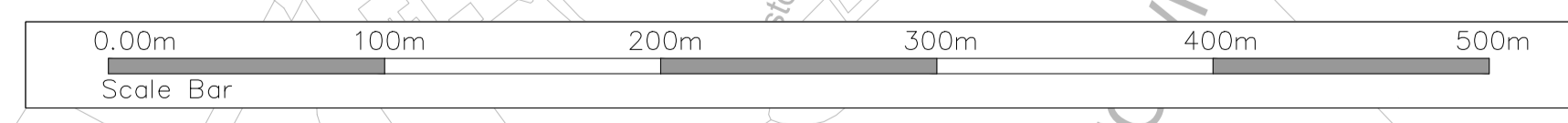

CYAL50419116
© Taité Éireann - Surveying



Notes
DO NOT SCALE. Use figured dimensions only. All levels are referred to Ordnance Survey Datum, Main Head.
This drawing is the property of Donegal County Council. It is a confidential document and must not be copied, used, or its contents divulged without prior written consent. This document should not be relied on or used in circumstances other than those for which it was originally prepared. Barry Transportation accepts no responsibility for this document to any other party other than the party by whom it was commissioned.

Rev.	Date	Drawn	Description	Chk'd	Appr.
P01	17.11.25	MG	ISSUE FOR PLANNING	JMM	ED

Project Title: TEN-T PRIORITY ROUTE IMPROVEMENT PROJECT DONEGAL Section 3 - N14 Manorcunningham to Lifford/Strabane/A5 Link		Status: A3
Drawing Title: Proposed Drainage Layout		Rev: P01
Designed: JMM	Date: NOV 2025	NIS Drawing Identifier:
Drawn: MG	Scale @ A1: 2500	NIS Drawing 35
Approved: ED	@ A3: 1:5000	File Identifier:
Checked: JMM	Sheet: 7 OF 10	TT_Y16112-BT-1A-HDR-S3-DR-CD-05120

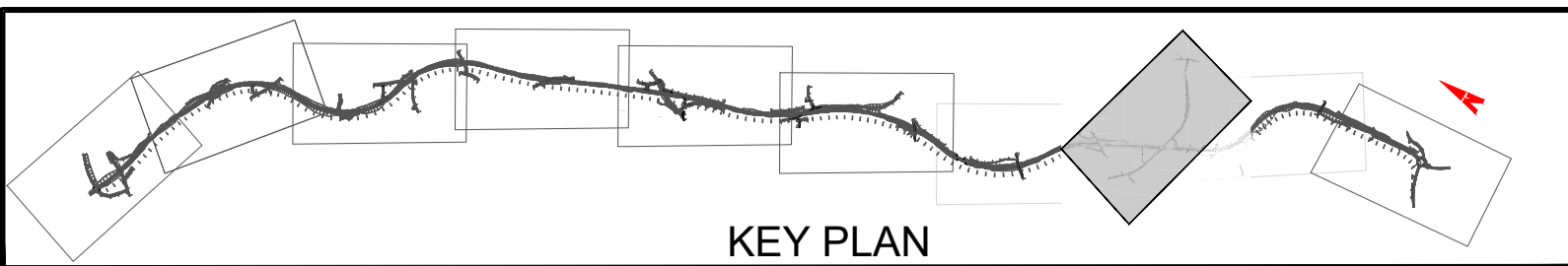
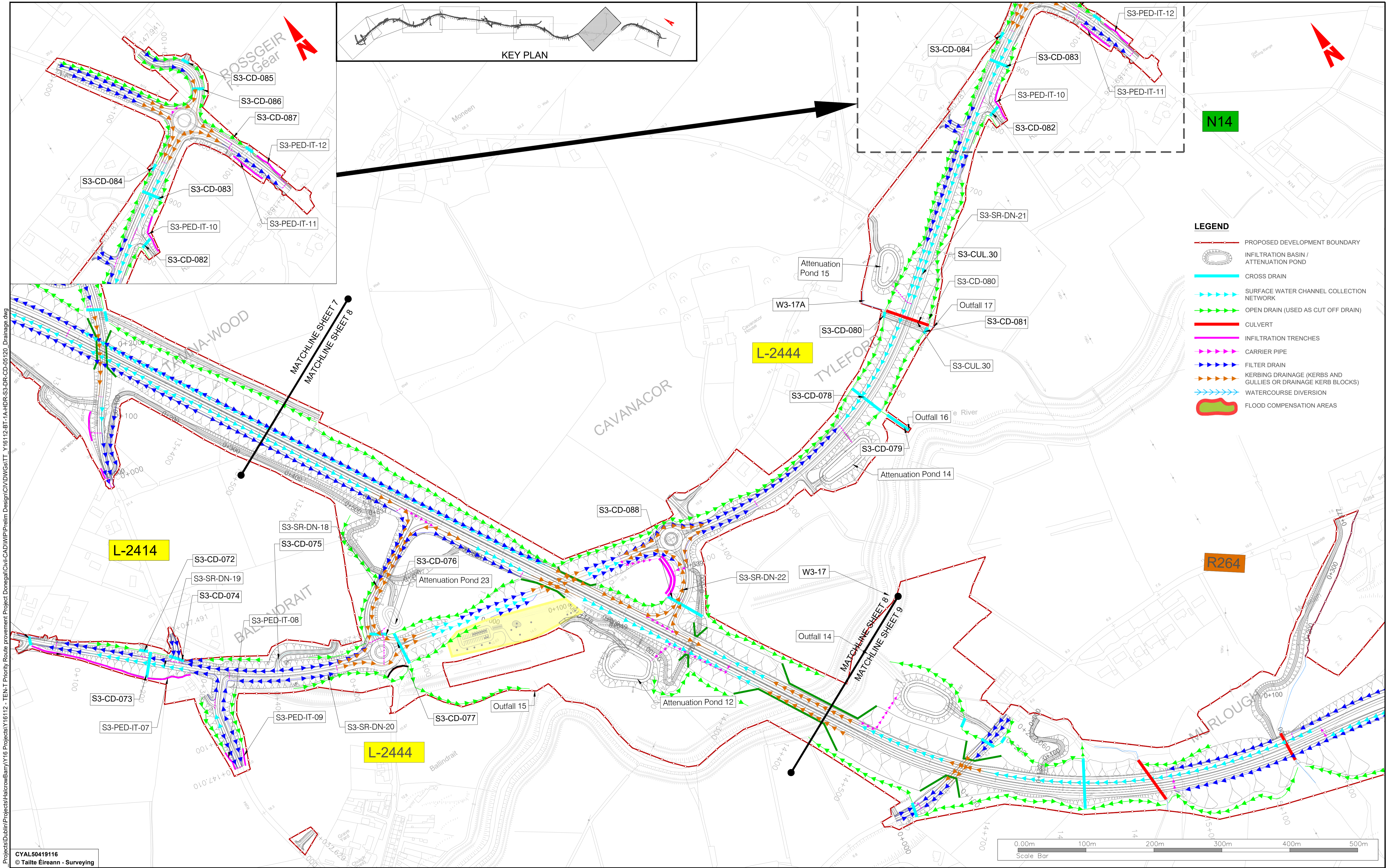

- LEGEND**
- PROPOSED DEVELOPMENT BOUNDARY
 - INFILTRATION BASIN / ATTENUATION POND
 - CROSS DRAIN
 - ▶▶▶▶▶ SURFACE WATER CHANNEL COLLECTION NETWORK
 - ▶▶▶▶▶ OPEN DRAIN (USED AS CUT OFF DRAIN)
 - CULVERT
 - INFILTRATION TRENCHES
 - ▶▶▶▶▶ CARRIER PIPE
 - ▶▶▶▶▶ FILTER DRAIN
 - ▶▶▶▶▶ KERBING DRAINAGE (KERBS AND GULLIES OR DRAINAGE KERB BLOCKS)
 - ▶▶▶▶▶ WATERCOURSE DIVERSION
 - FLOOD COMPENSATION AREAS

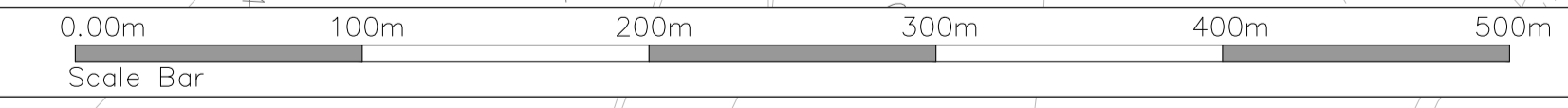

CYAL50419116
© Talte Éireann - Surveying



Notes
DO NOT SCALE. Use figured dimensions only. All levels are referred to Ordnance Survey Datum, Mean Head.
This drawing is the property of Donegal County Council. It is a confidential document and must not be copied, used, or its contents divulged without prior written consent. This document should not be relied on or used in circumstances other than those for which it was originally prepared. Barry Transportation accepts no responsibility for this document to any other party other than the party by whom it was commissioned.

Rev.	Date	Drawn	Description	Chk'd	Appr.
P01	17.11.25	MG	ISSUE FOR PLANNING	JMM	ED

Project Title: TEN-T PRIORITY ROUTE IMPROVEMENT PROJECT DONEGAL Section 3 - N14 Manorcunningham to Lifford/Strabane/A5 Link		Status: A3	
Drawing Title: Proposed Drainage Layout		Rev: P01	
Designed: JMM	Date: NOV 2025	NIS Drawing Identifier: NIS Drawing 35	
Drawn: MG	Scale @ A1: 1:2500 @ A3: 1:5000	File Identifier: TT_Y16112-BT-1A-HDR-S3-DR-CD-05120	
Approved: ED	Sheet: 8 OF 10		
Checked: JMM			

V:\gis\ra\local\ub\01_P\Projects\Dublin\Projects\Harcrow\Barry\16 Projects\Y16112 - TEN-T Priority Route Improvement Project Donegal\Civil\CAD\WIP\Prelim Design\CIV\DWG\BT_Y16112-BT-1A-HDR-S3-DR-CD-05120_Drainage.dwg

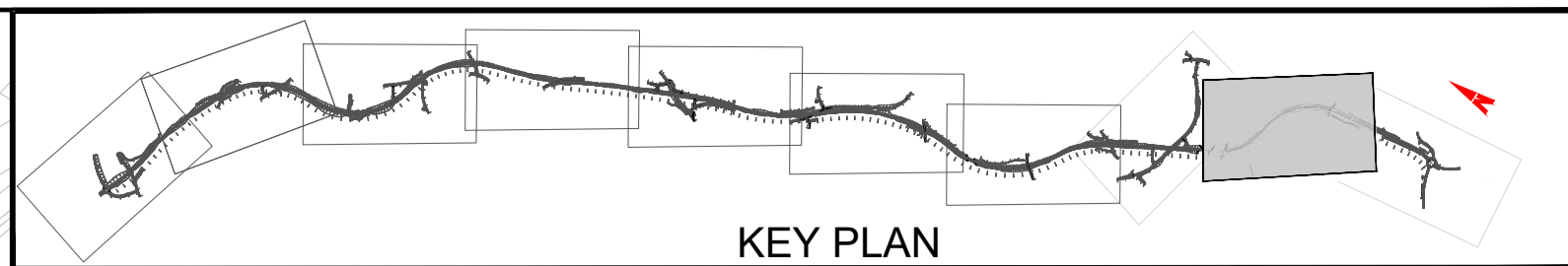
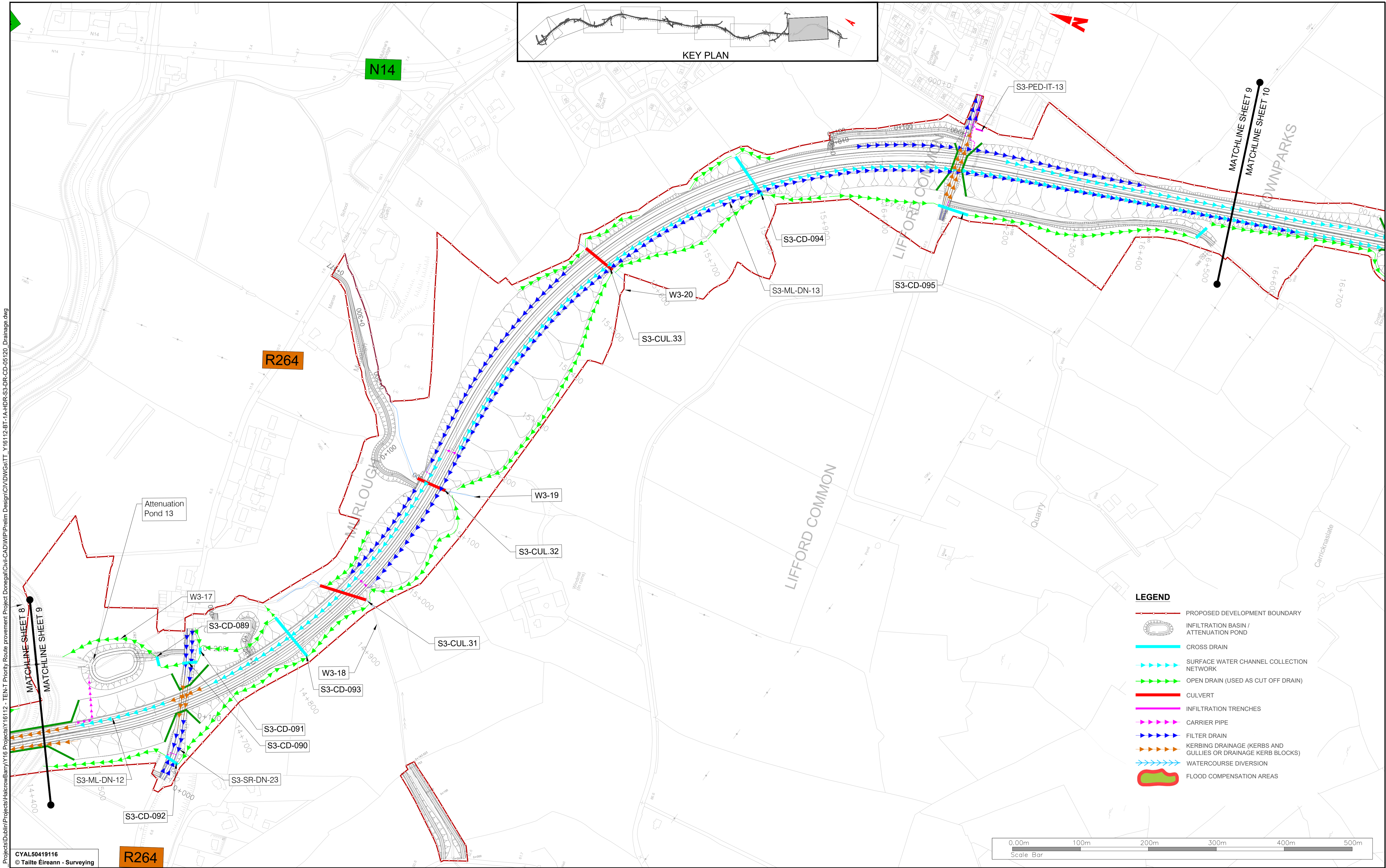

- LEGEND**
- PROPOSED DEVELOPMENT BOUNDARY
 - INFILTRATION BASIN / ATTENUATION POND
 - CROSS DRAIN
 - SURFACE WATER CHANNEL COLLECTION NETWORK
 - OPEN DRAIN (USED AS CUT OFF DRAIN)
 - CULVERT
 - INFILTRATION TRENCHES
 - CARRIER PIPE
 - FILTER DRAIN
 - KERBING DRAINAGE (KERBS AND GULLIES OR DRAINAGE KERB BLOCKS)
 - WATERCOURSE DIVERSION
 - FLOOD COMPENSATION AREAS

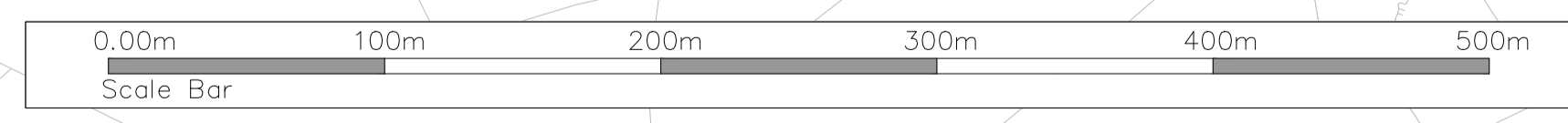

CYAL50419116
© Taitte Éireann - Surveying



Notes
DO NOT SCALE. Use figured dimensions only. All levels are referred to Ordnance Survey Datum, Mean Head.
This drawing is the property of Donegal County Council. It is a confidential document and must not be copied, used, or its contents divulged without prior written consent. This document should not be relied on or used in circumstances other than those for which it was originally prepared. Barry Transportation accepts no responsibility for this document to any other party other than the party by whom it was commissioned.

Rev.	Date	Drawn	Description	Chk'd	Appr.
P01	17.11.25	MG	ISSUE FOR PLANNING	JMM	ED

Project Title: TEN-T PRIORITY ROUTE IMPROVEMENT PROJECT DONEGAL Section 3 - N14 Manorcunningham to Lifford/Strabane/A5 Link		Status: A3
Drawing Title: Proposed Drainage Layout		Rev: P01
Designed: JMM	Date: NOV 2025	NIS Drawing Identifier: NIS Drawing 35
Drawn: MG	Scale @ A1: 1:2500	File Identifier: TT_Y16112-BT-1A-HDR-S3-DR-CD-05120
Approved: ED	@ A3: 1:5000	
Checked: JMM	Sheet: 9 OF 10	

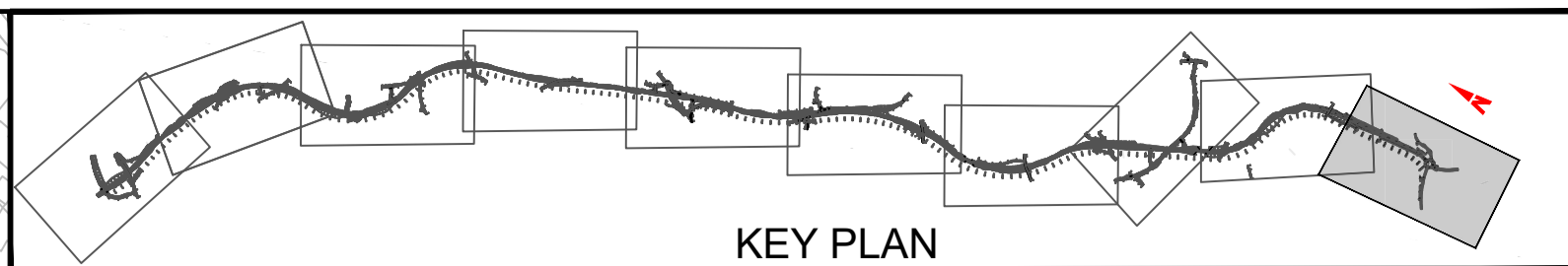
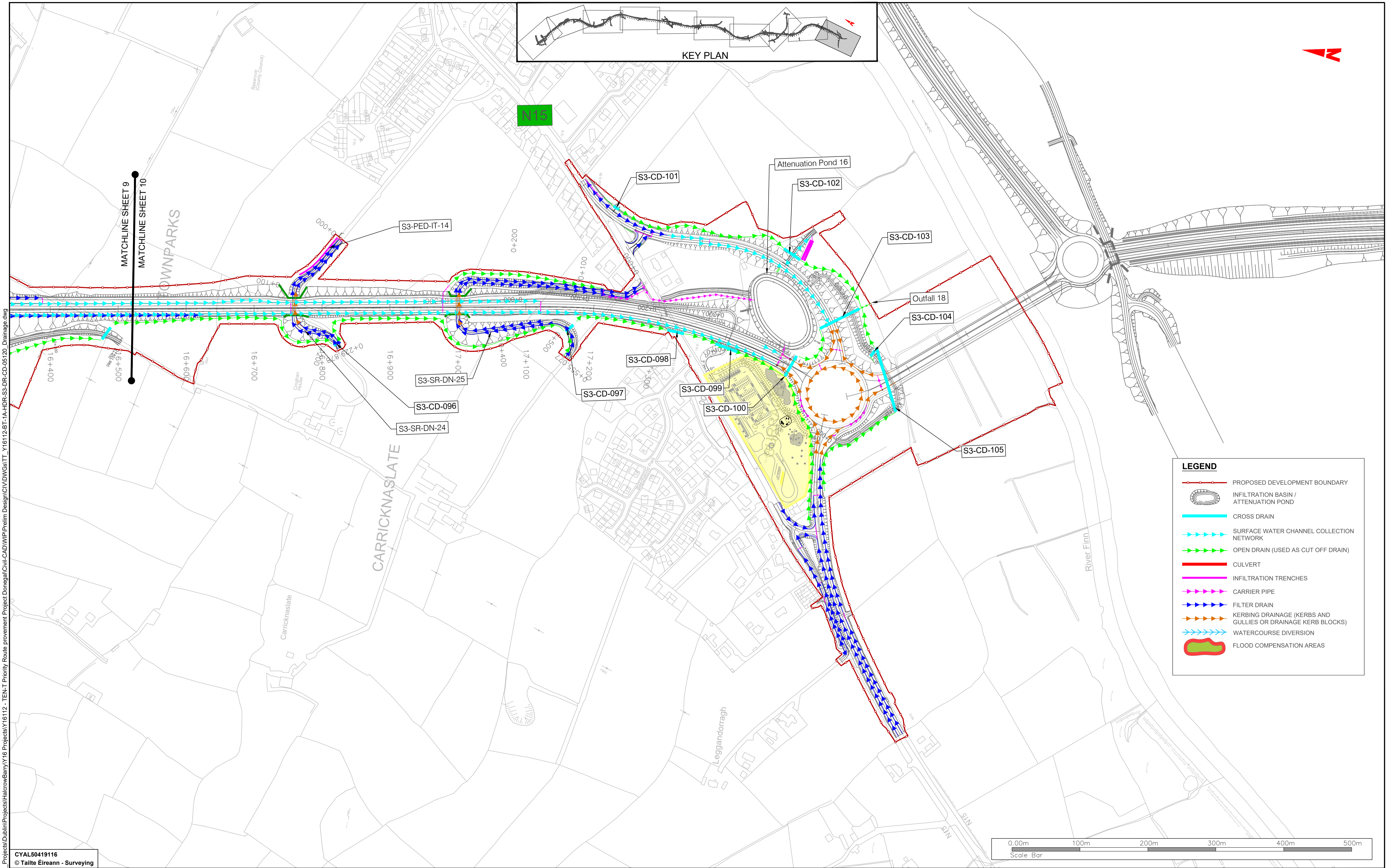

LEGEND

- PROPOSED DEVELOPMENT BOUNDARY
- INFILTRATION BASIN / ATTENUATION POND
- CROSS DRAIN
- SURFACE WATER CHANNEL COLLECTION NETWORK
- OPEN DRAIN (USED AS CUT OFF DRAIN)
- CULVERT
- INFILTRATION TRENCHES
- CARRIER PIPE
- FILTER DRAIN
- KERBING DRAINAGE (KERBS AND GULLIES OR DRAINAGE KERB BLOCKS)
- WATERCOURSE DIVERSION
- FLOOD COMPENSATION AREAS

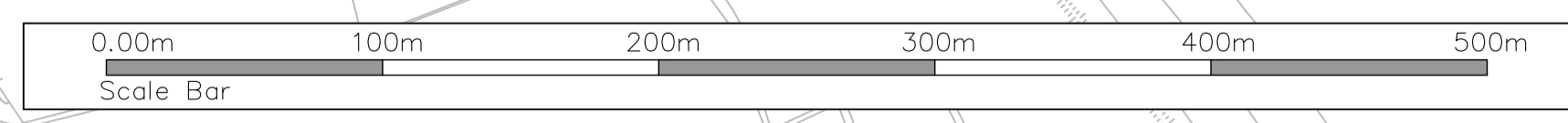

CYAL50419116
© Talte Eireann - Surveying

Notes
DO NOT SCALE, use figured dimensions only. All levels are referred to Ordnance Survey Datum, Mean Head.
This drawing is the property of Donegal County Council. It is a confidential document and must not be copied, used, or its contents divulged without prior written consent. This document should not be relied on or used in circumstances other than those for which it was originally prepared. Barry Transportation accepts no responsibility for this document to any other party other than the party by whom it was commissioned.

Rev.	Date	Drawn	Description	Chk'd	Appr.
P01	17.11.25	MG	ISSUE FOR PLANNING	JMM	ED

Project Title: TEN-T PRIORITY ROUTE IMPROVEMENT PROJECT DONEGAL Section 3 - N14 Manor Cunningham to Lifford/Strabane/AS Link		Status: A3	
Drawing Title: Proposed Drainage Layout		Rev: P01	
Designed: JMM	Date: NOV 2025	NIS Drawing Identifier: NIS Drawing 35	
Drawn: MG	Scale @ A1: 2500	File Identifier: TT_Y16112-BT-1A-HDR-S3-DR-CD-05120	
Approved: ED	@ A3: 1:5000		
Checked: JMM	Sheet: 10 OF 10		