

LEGEND:		
EXISTING NATIONAL ROAD REFERENCE	N13	PARK AND SHARE / CYCLE FACILITY
EXISTING REGIONAL ROAD REFERENCE	R252	FLOOD COMPENSATION AREA
EXISTING LOCAL ROAD REFERENCE	L-1111	DRAINAGE POND
ACTIVE TRAVEL NETWORK STRUCTURE	(Orange line)	PROPOSED DEVELOPMENT BOUNDARY
	(Pink line)	SAC
	(Blue line)	(Blue line)
	(Green line)	(Green line)

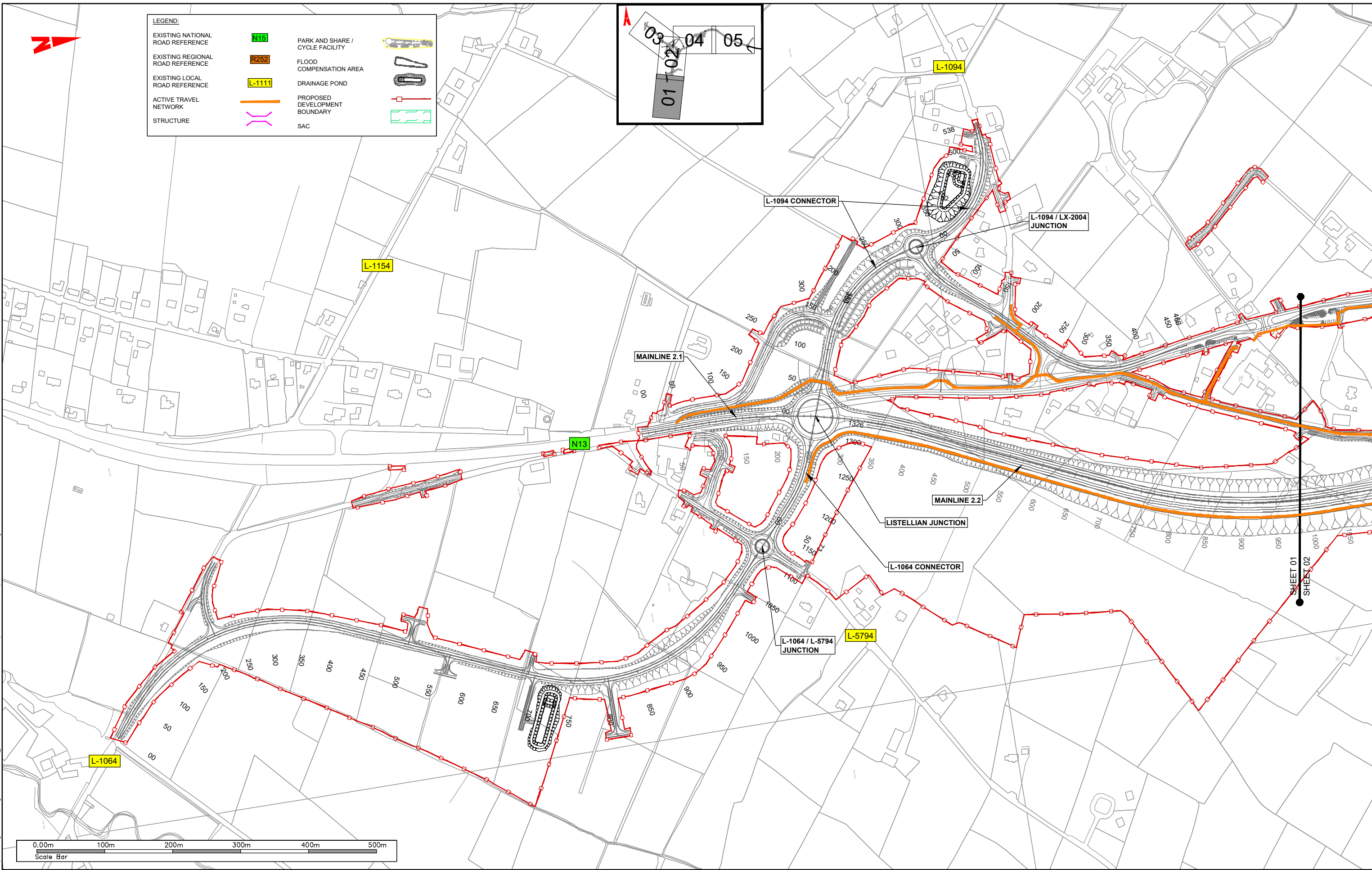

T:\MGT0337 - Ten-T Priority Route Imp - Donegal\B.0 Drawings\Phase 3\DGTT - MGT0337-RPS-P3-S2-DR-C-DG0045 Proposed Road Development Location.dwg

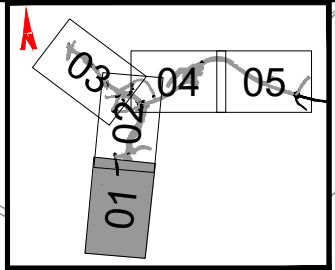
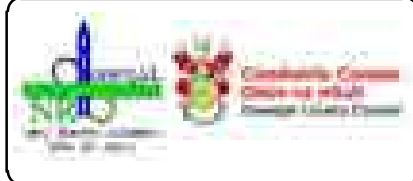
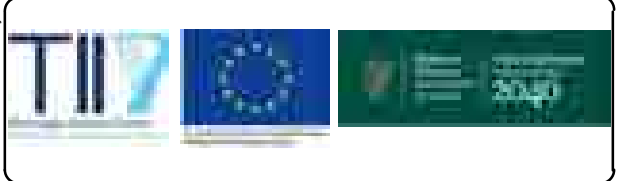

NOTES
 DO NOT SCALE, use figured dimensions only.
 All levels are referred to Ordnance Survey Datum, Malin Head.
 This drawing is the property of the Donegal County Council. It is a confidential document and must not be copied, used, or its contents divulged without prior written consent. This document should not be relied on or used in circumstances other than those for which it was originally prepared. RPS / Barry Transportation accepts no responsibility for this document to any other party other than the party by whom it was commissioned.

Rev.	Date	Drawn	Description	Chk'd	Appr.
P01	08.04.26	DL	ISSUE FOR PLANNING	MC	EC

Project Title: TEN-T Priority Route Improvement Project, Donegal Section 2 - N56/N13 Letterkenny to Manorcunningham		Status: A3
Drawing Title: PROPOSED ROAD DEVELOPMENT LOCATION		Rev: P01
Designed: AM	Date: APR 2026	Model File Identifier: TT_MGT0337-RPS-P3-S2-DR-C-DG0045
Drawn: DL	Scale @ A1: 1:2500	File Identifier: TT_MGT0337-RPS-P3-S2-DR-C-DG0045
Approved: EC	@ A3: 1:5000	
Checked: MC	Sheet: 01 of 07	

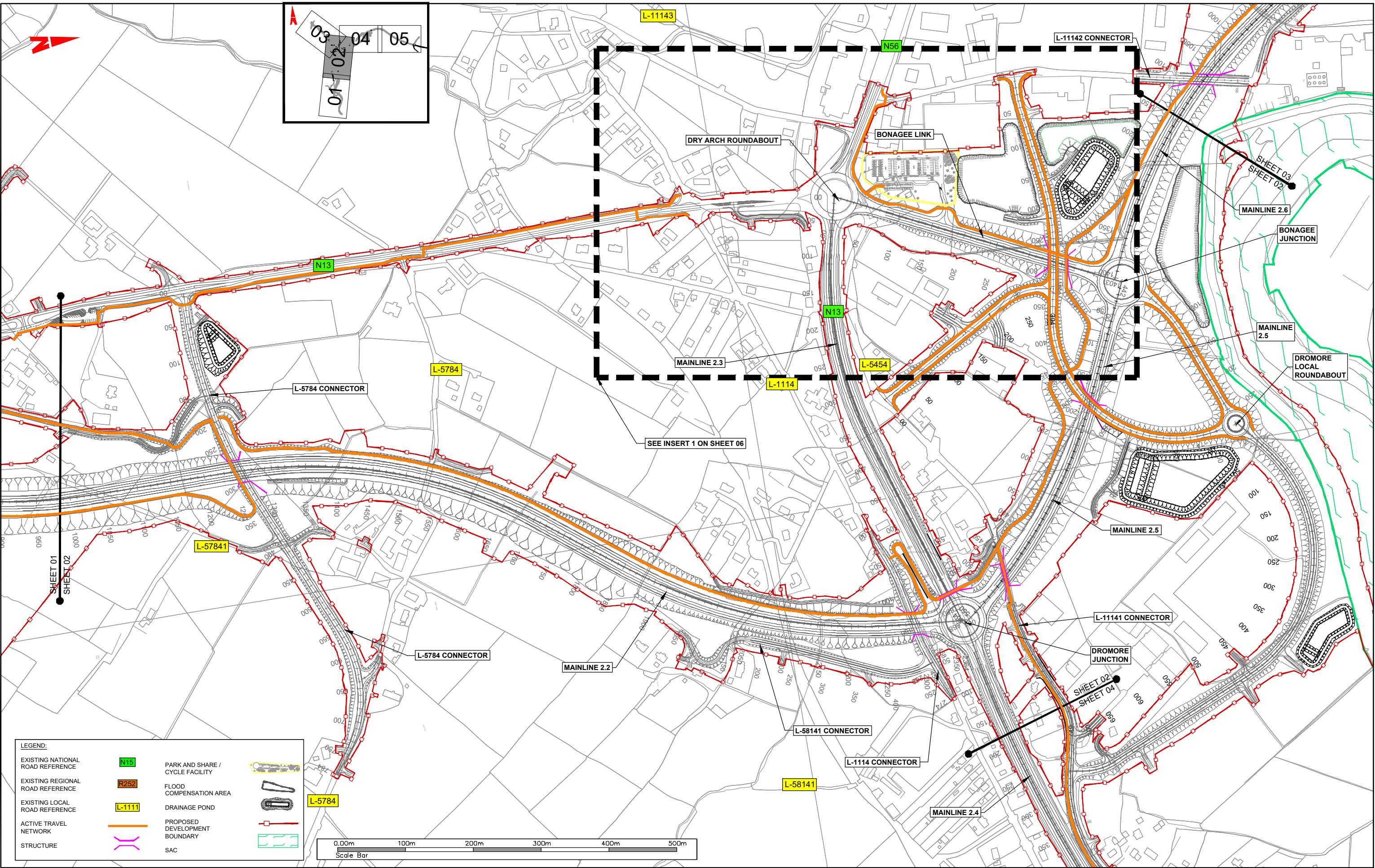

LEGEND:

EXISTING NATIONAL ROAD REFERENCE	N13	PARK AND SHARE / CYCLE FACILITY	
EXISTING REGIONAL ROAD REFERENCE	R252	FLOOD COMPENSATION AREA	
EXISTING LOCAL ROAD REFERENCE	L-1111	DRAINAGE POND	
ACTIVE TRAVEL NETWORK		PROPOSED DEVELOPMENT BOUNDARY	
STRUCTURE		SAC	

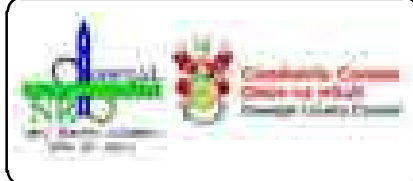
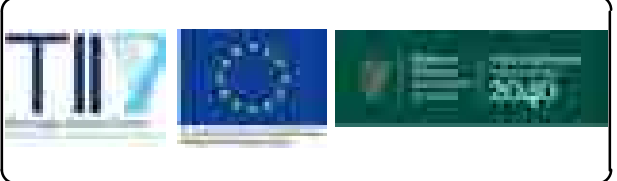
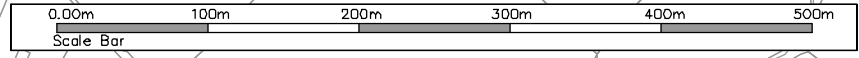

NOTES
 DO NOT SCALE, use figured dimensions only.
 All levels are referred to Ordnance Survey Datum, Malin Head.
 This drawing is the property of the Donegal County Council. It is a confidential document and must not be copied, used, or its contents divulged without prior written consent. This document should not be relied on or used in circumstances other than those for which it was originally prepared. RPS / Barry Transportation accepts no responsibility for this document to any other party other than the party by whom it was commissioned.

Rev.	Date	Drawn	Description	Chk'd	Appr.
P01	08.04.26	DL	ISSUE FOR PLANNING	MC	EC

Project Title: TEN-T Priority Route Improvement Project, Donegal Section 2 - N56/N13 Letterkenny to Manorcunningham		Status: A3
Drawing Title: PROPOSED ROAD DEVELOPMENT LOCATION		Rev: P01
Designed: AM	Date: APR 2026	Model File Identifier: TT_MGT0337-RPS-P3-S2-DR-C-DG0045
Drawn: DL	Scale @ A1: 1:2500	File Identifier: TT_MGT0337-RPS-P3-S2-DR-C-DG0045
Approved: EC	@ A3: 1:5000	
Checked: MC	Sheet: 02 of 07	

T:\MGT0337 - Ten-T Priority Route Imp - Donegal\B.0 Drawings\Phase 3\DGTT - MGT0337-RPS-P3-S2-DR-C-DG0045 Proposed Road Development Location.dwg

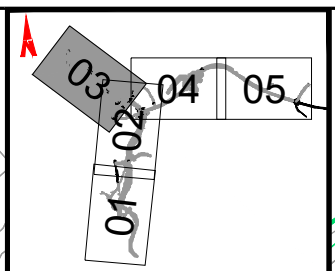
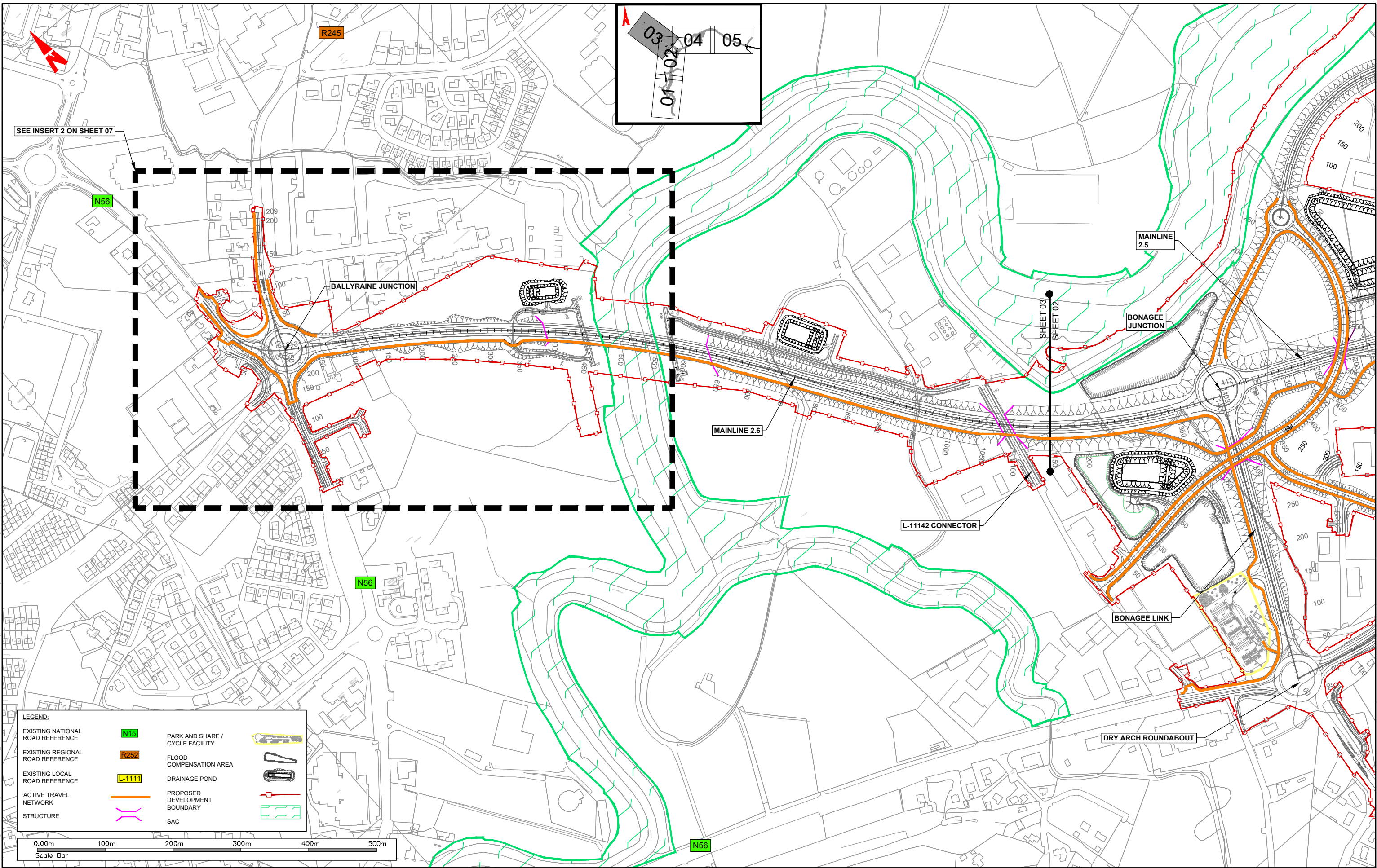

T:\MGT0337 - Ten-T Priority Route Imp - Donegal\B.0 Drawings\Phase 3\DGTT_MGT0337-RPS-P3-S2-DR-C-DG0045 Proposed Road Development Location.dwg

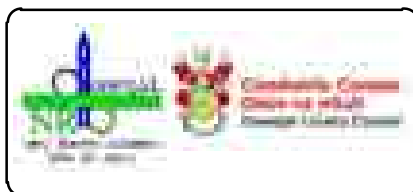
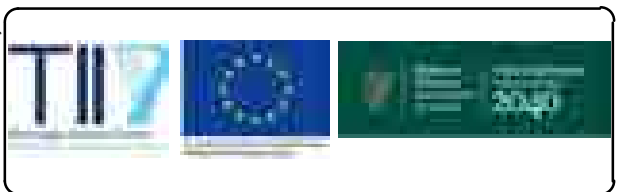

NOTES

DO NOT SCALE, use figured dimensions only.

All levels are referred to Ordnance Survey Datum, Main Head.

This drawing is the property of the Donegal County Council. It is a confidential document and must not be copied, used, or its contents divulged without prior written consent. This document should not be relied on or used in circumstances other than those for which it was originally prepared. RPS / Barry Transportation accepts no responsibility for this document to any other party other than the party by whom it was commissioned.

Rev.	Date	Drawn	Description	Chk'd	Appr.
P01	08.04.26	DL	ISSUE FOR PLANNING	MC	EC

Project Title: TEN-T Priority Route Improvement Project, Donegal Section 2 - N56/N13 Letterkenny to Manorcunningham		Status: A3
Drawing Title: PROPOSED ROAD DEVELOPMENT LOCATION		Rev: P01
Designed: AM	Date: APR 2026	Model File Identifier: TT_MGT0337-RPS-P3-S2-DR-C-DG0045
Drawn: DL	Scale @ A1: 1:2500	File Identifier: TT_MGT0337-RPS-P3-S2-DR-C-DG0045
Approved: EC	@ A3: 1:5000	
Checked: MC	Sheet: 03 of 07	

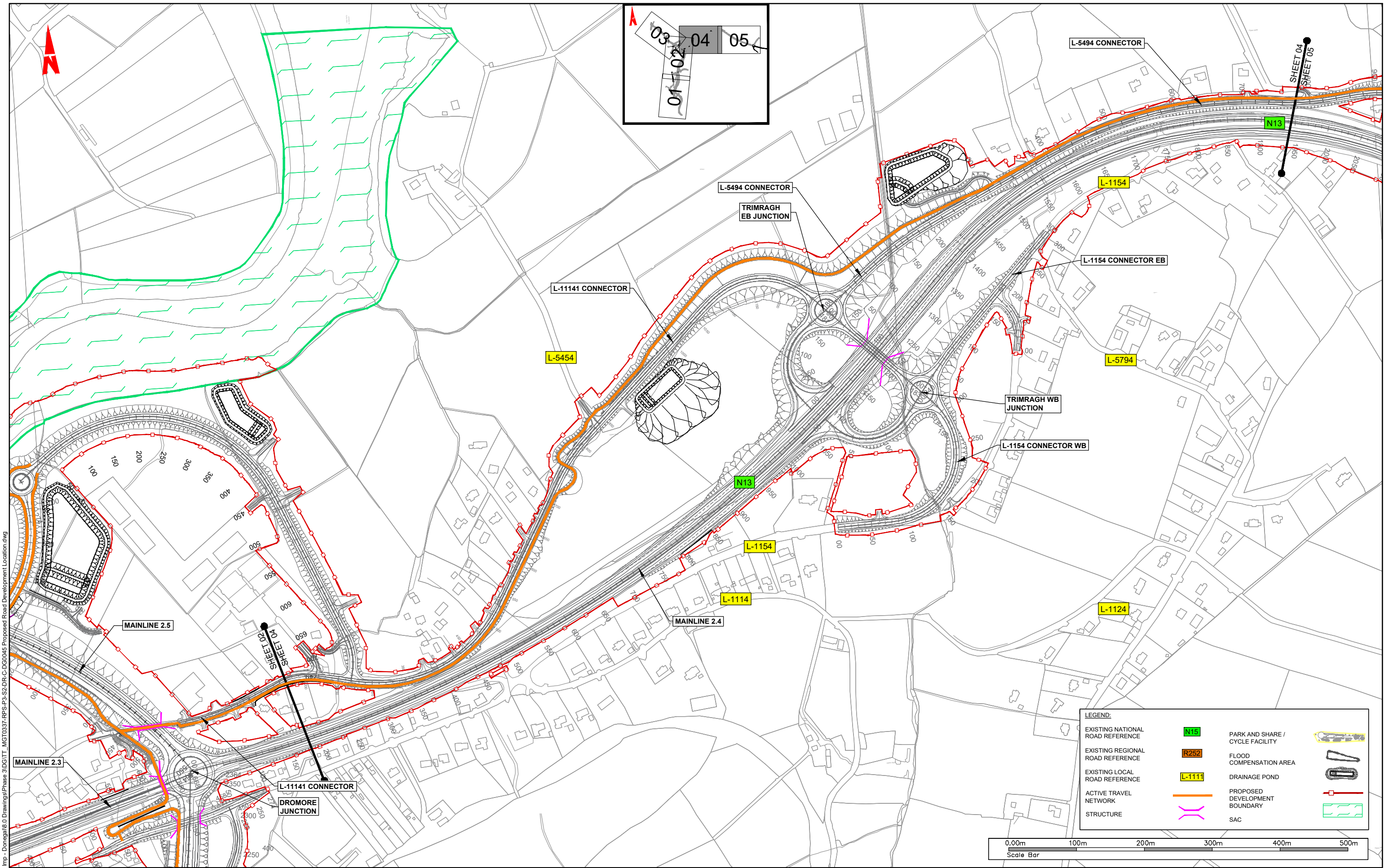

LEGEND:

EXISTING NATIONAL ROAD REFERENCE	N15	PARK AND SHARE / CYCLE FACILITY	
EXISTING REGIONAL ROAD REFERENCE	R252	FLOOD COMPENSATION AREA	
EXISTING LOCAL ROAD REFERENCE	L-1111	DRAINAGE POND	
ACTIVE TRAVEL NETWORK		PROPOSED DEVELOPMENT BOUNDARY	
STRUCTURE		SAC	

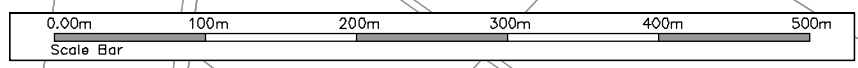

T:\MGT0337 - Ten-T Priority Route Imp - Donegal\B.0 Drawings\Phase 3\DIGIT - MGT0337-RPS-P3-S2-DR-C-DG0045 Proposed Road Development Location.dwg

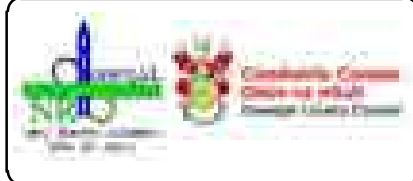
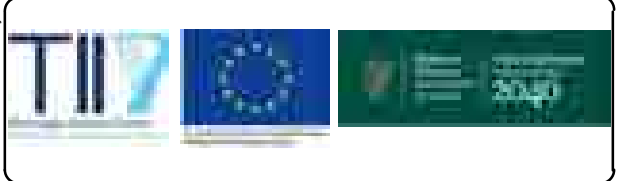

NOTES
 DO NOT SCALE, use figured dimensions only.
 All levels are referred to Ordnance Survey Datum, Main Head.
 This drawing is the property of the Donegal County Council. It is a confidential document and must not be copied, used, or its contents divulged without prior written consent. This document should not be relied on or used in circumstances other than those for which it was originally prepared. RPS / Barry Transportation accepts no responsibility for this document to any other party other than the party by whom it was commissioned.

Rev.	Date	Drawn	Description	Chk'd	Appr.
P01	08.04.26	DL	ISSUE FOR PLANNING	MC	EC

Project Title: TEN-T Priority Route Improvement Project, Donegal Section 2 - N56/N13 Letterkenny to Manorcunningham		Status: A3
Drawing Title: PROPOSED ROAD DEVELOPMENT LOCATION		Rev: P01
Designed: AM	Date: APR 2026	Model File Identifier: TT_MGT0337-RPS-P3-S2-DR-C-DG0045
Drawn: DL	Scale @ A1: 1:2500	File Identifier: TT_MGT0337-RPS-P3-S2-DR-C-DG0045
Approved: EC	@ A3: 1:5000	
Checked: MC	Sheet: 04 of 07	

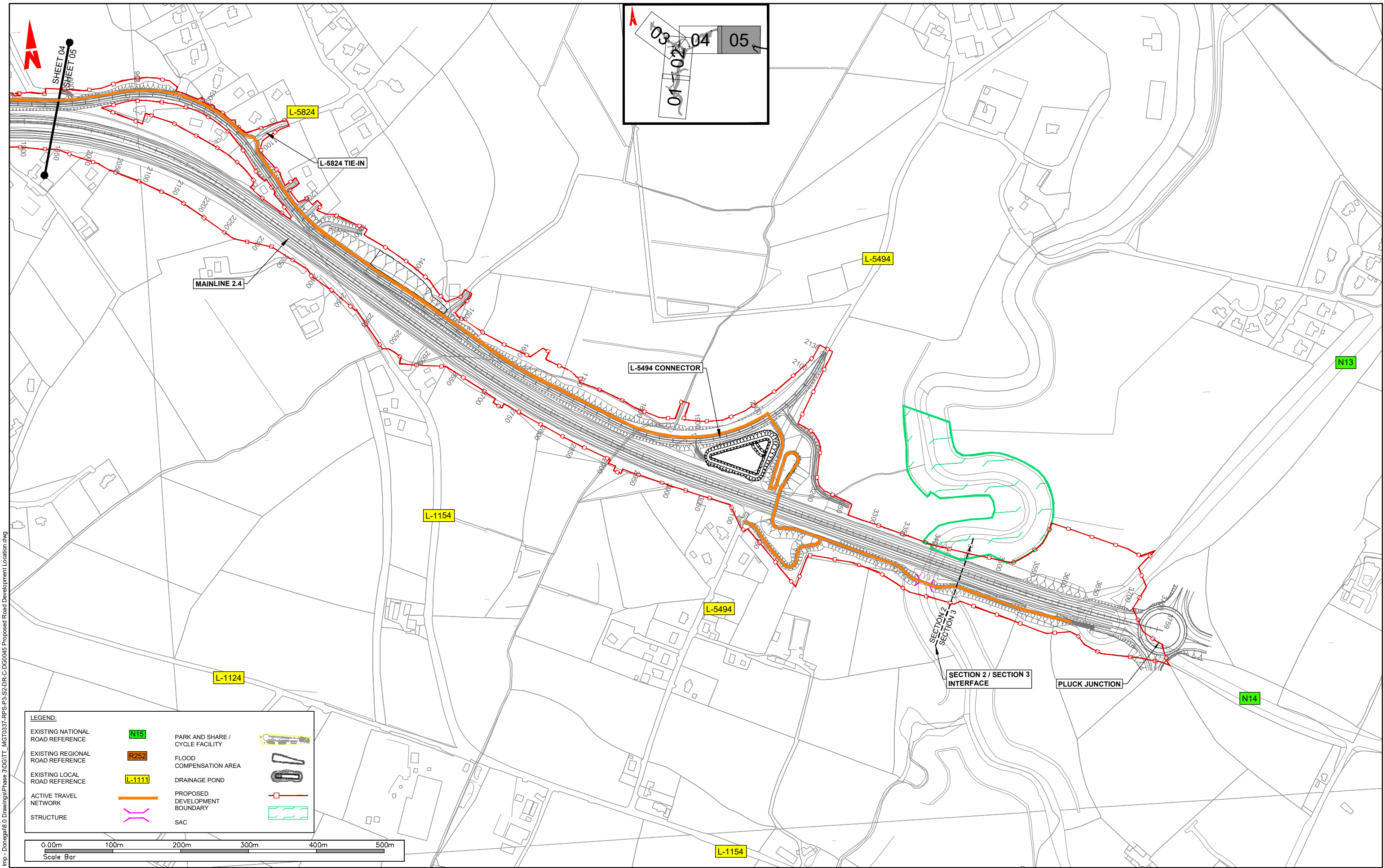

LEGEND:

EXISTING NATIONAL ROAD REFERENCE	N15	PARK AND SHARE / CYCLE FACILITY	
EXISTING REGIONAL ROAD REFERENCE	R252	FLOOD COMPENSATION AREA	
EXISTING LOCAL ROAD REFERENCE	L-1111	DRAINAGE POND	
ACTIVE TRAVEL NETWORK		PROPOSED DEVELOPMENT BOUNDARY	
STRUCTURE		SAC	

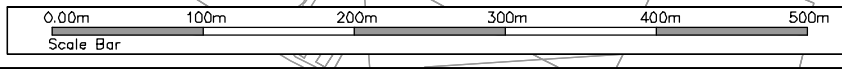

T:\MGT0337 - Ten-T Priority Route Imp - Donegal\B.0 Drawings\Phase 3\DGTT - MGT0337-RPS-P3-S2-DR-C-DG0045 Proposed Road Development Location.dwg

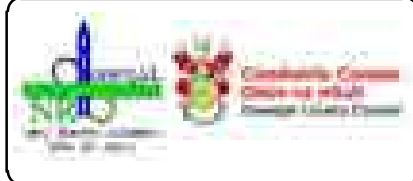
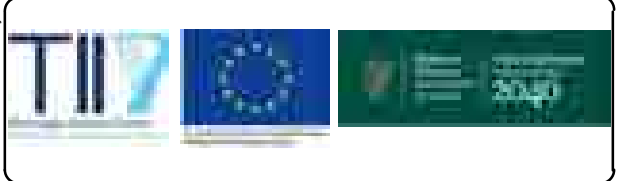

NOTES
 DO NOT SCALE, use figured dimensions only.
 All levels are referred to Ordnance Survey Datum, Malin Head.
 This drawing is the property of the Donegal County Council. It is a confidential document and must not be copied, used, or its contents divulged without prior written consent. This document should not be relied on or used in circumstances other than those for which it was originally prepared. RPS / Barry Transportation accepts no responsibility for this document to any other party other than the party by whom it was commissioned.

Rev.	Date	Drawn	Description	Chk'd	Appr.
P01	08.04.26	DL	ISSUE FOR PLANNING	MC	EC

Project Title: TEN-T Priority Route Improvement Project, Donegal Section 2 - N56/N13 Letterkenny to Manorcunningham		Status: A3
Drawing Title: PROPOSED ROAD DEVELOPMENT LOCATION		Rev: P01
Designed: SS	Date: APR 2026	Model File Identifier: TT_MGT0337-RPS-P3-S2-DR-C-DG0045
Drawn: DL	Scale @ A1: 1:2500	File Identifier: TT_MGT0337-RPS-P3-S2-DR-C-DG0045
Approved: EC	@ A3: 1:5000	
Checked: MC	Sheet: 05 of 07	

INSERT 1

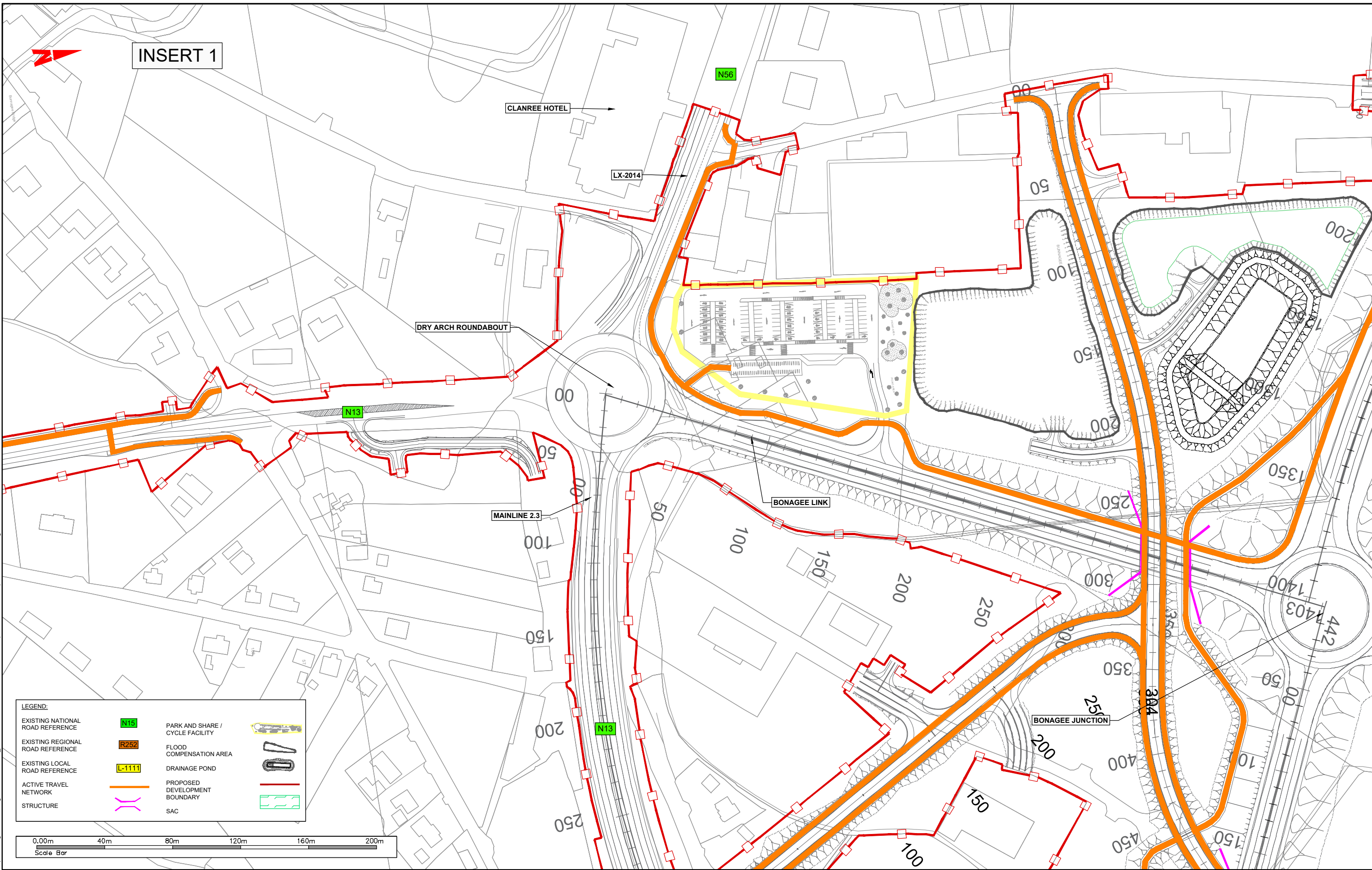

LEGEND:

EXISTING NATIONAL ROAD REFERENCE	N13	PARK AND SHARE / CYCLE FACILITY	
EXISTING REGIONAL ROAD REFERENCE	R252	FLOOD COMPENSATION AREA	
EXISTING LOCAL ROAD REFERENCE	L-1111	DRAINAGE POND	
ACTIVE TRAVEL NETWORK		PROPOSED DEVELOPMENT BOUNDARY	
STRUCTURE		SAC	

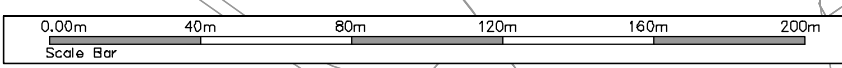

T:\MGT0337 - Ten-T Priority Route Imp - Donegal\B.0 Drawings\Phase 3\DIGIT - MGT0337-RPS-P3-S2-DR-C-DG0045 Proposed Road Development Location.dwg

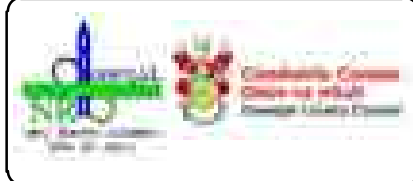
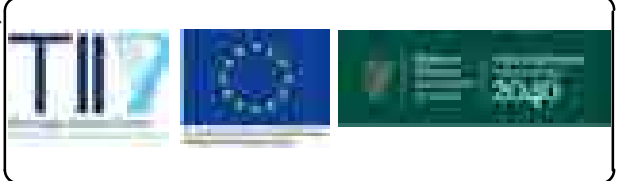

NOTES

DO NOT SCALE, use figured dimensions only.

All levels are referred to Ordnance Survey Datum, Malin Head.

This drawing is the property of the Donegal County Council. It is a confidential document and must not be copied, used, or its contents divulged without prior written consent. This document should not be relied on or used in circumstances other than those for which it was originally prepared. RPS / Barry Transportation accepts no responsibility for this document to any other party other than the party by whom it was commissioned.

Rev.	Date	Drawn	Description	Chk'd	Appr.
P01	08.04.26	DL	ISSUE FOR PLANNING	MC	EC

Project Title: TEN-T Priority Route Improvement Project, Donegal Section 2 - N56/N13 Letterkenny to Manorcunningham		Status: A3
Drawing Title: PROPOSED ROAD DEVELOPMENT LOCATION		Rev: P01
Designed: AM	Date: APR 2026	Model File Identifier: TT_MGT0337-RPS-P3-S2-DR-C-DG0045
Drawn: DL	Scale @ A1: 1:1000	File Identifier: TT_MGT0337-RPS-P3-S2-DR-C-DG0045
Approved: EC	@ A3: 1:2000	
Checked: MC	Sheet: 06 of 07	

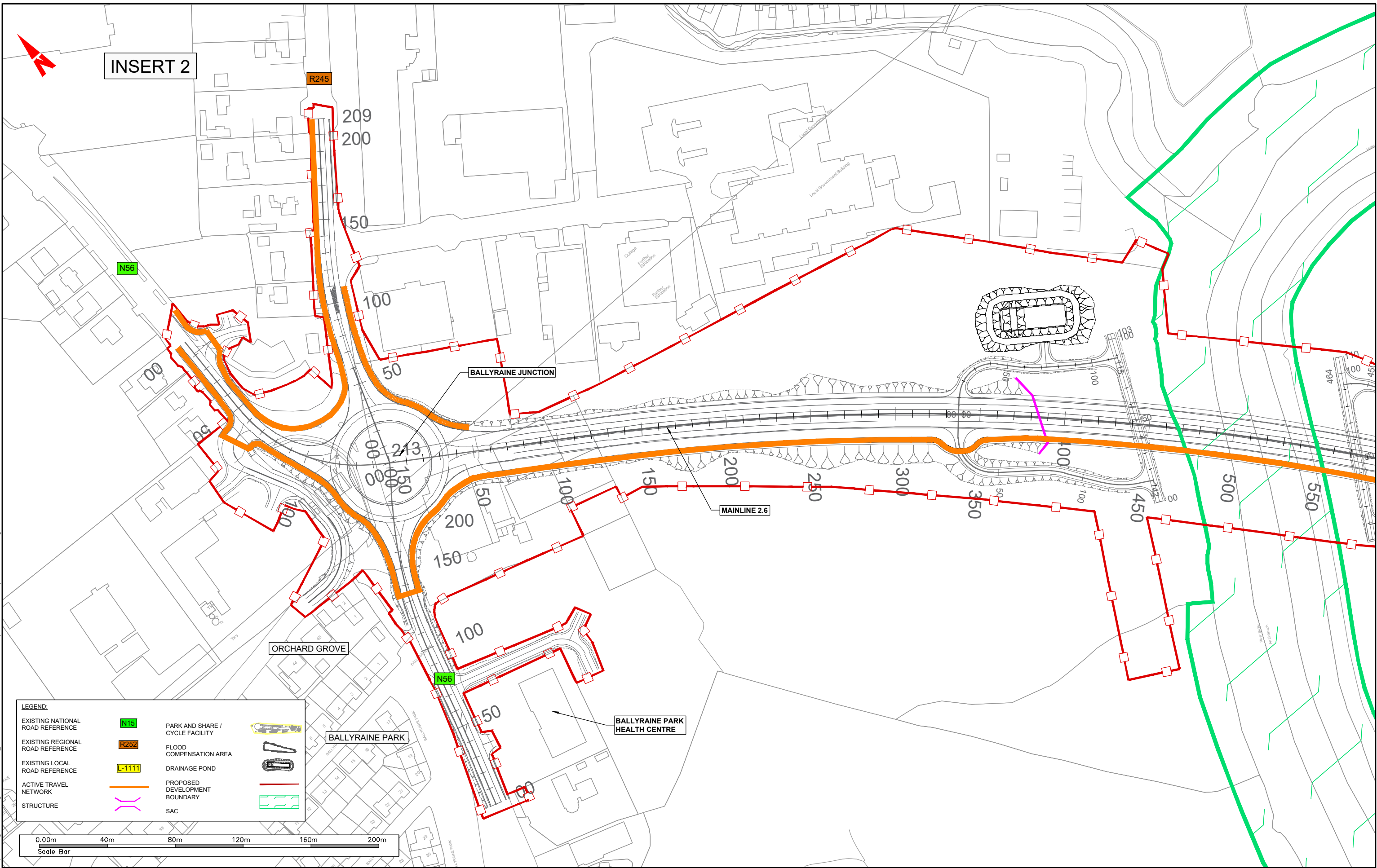

INSERT 2

T:\MGT0337 - Ten-T Priority Route Imp - Donegal\B.0 Drawings\Phase 3\DIGITTT_MGT0337-RPS-P3-S2-DR-C-DG0045 Proposed Road Development Location.dwg

LEGEND:

EXISTING NATIONAL ROAD REFERENCE		PARK AND SHARE / CYCLE FACILITY	
EXISTING REGIONAL ROAD REFERENCE		FLOOD COMPENSATION AREA	
EXISTING LOCAL ROAD REFERENCE		DRAINAGE POND	
ACTIVE TRAVEL NETWORK		PROPOSED DEVELOPMENT BOUNDARY	
STRUCTURE		SAC	

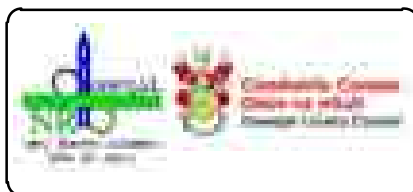
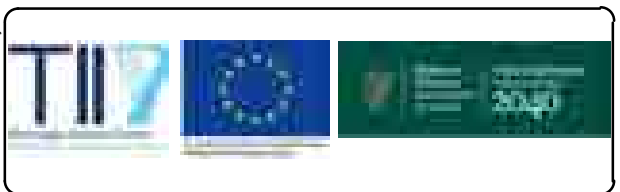

NOTES

DO NOT SCALE, use figured dimensions only.

All levels are referred to Ordnance Survey Datum, Malin Head.

This drawing is the property of the Donegal County Council. It is a confidential document and must not be copied, used, or its contents divulged without prior written consent. This document should not be relied on or used in circumstances other than those for which it was originally prepared. RPS / Barry Transportation accepts no responsibility for this document to any other party other than the party by whom it was commissioned.

Rev.	Date	Drawn	Description	Chk'd	Appr.
P01	08.04.26	DL	ISSUE FOR PLANNING	MC	EC

Project Title: TEN-T Priority Route Improvement Project, Donegal Section 2 - N56/N13 Letterkenny to Manorcunningham		Status: A3
Drawing Title: PROPOSED ROAD DEVELOPMENT LOCATION		Rev: P01
Designed: AM	Date: APR 2026	Model File Identifier: TT_MGT0337-RPS-P3-S2-DR-C-DG0045
Drawn: DL	Scale @ A1: 1:1000	File Identifier: TT_MGT0337-RPS-P3-S2-DR-C-DG0045
Approved: EC	@ A3: 1:2000	
Checked: MC	Sheet: 07 of 07	